

N 1/4 COR SEC 35 REBAR
MARKED "LS 10957" IN CASE
PER RECORD OF SURVEY.
A.F. NO. 200503170089

(S 88°58' W)
N 88°48'52" E

((20.25 CHNS) 1336.50' GLO 1917)

100.00' FUTURE
WATERLINE EASEMENT

S 88°33'40" W
466.69'

INDIAN ROAD

40' ROADWAY
PER ORDER OF
ESTABLISHMENT
DATED AUG. 2,
1960

LOT A
217,800 SQ. FT.
5.0 ACRES

S 87°33'13" W
466.76'

N 87°33'13" E
466.76'

S 01°26'20" E
470.80'

ROAD BUFFER

1337.46 TO CN 1/16

LOT B
217,800 SQ. FT.
5.0 ACRES

S 88°33'40" W
466.69'

N 01°26'20" W
462.59'

ROAD

IRON PIPE PER
R.O.S. BK. 18 PG. 100
FALLS 0.2' SOUTH
OF 1/16th LINE

FOUND REBAR WITH
YELLOW CAP MARKED
"LS 24218" 5.79' SOUTH
OF PROPERTY LINE

(N 88°43' W
S 88°20'29" W
5287.83'

330.67'

1321.95'
((20.10 CHNS) 1326.80' GLO 1874)

FOUND REBAR WITH
CAP MARKED
"LS 32437"

FOUND IRON
PIPE IN CASE
SEE NOTE 5

FROM CALCULATED CN 1/16
CORNER, IRON PIPE IN
CASE FALLS S 1°53'43" W,
6.00', REBAR "LS 24218"
FALLS S 74°20' E, 19.44',
REBAR "LS 32437" FALLS
S 73°11' W, 22.17',
PER RECORD OF SURVEY,
A.F. NO. 200503170089

N 1/2 OF THE NE 1/4
OF SEC. 35

RECORD OF SURVEY
A.F. NO. 200503170089

E 1/16 SEC 35
GLO BRASS CAP
MARKED W 1/16 26/35 1917"
3/4" IRON PIPE MARKED
"LS 6702 0.07' S. AND 0.27' E.
PER RECORD OF SURVEY,
A.F. NO. 200503170089

LEGEND

- DENOTES SET 1/2" REBAR WITH
YELLOW CAP MARKED "SKODJE 19645"
MARCH 1, 2007.
- DENOTES FOUND SURVEY MARKER
AS NOTED
- DENOTES FOUND G.L.O. MONUMENT
AS DESCRIBED HEREON
- () DENOTES RECORD DATA PER G.L.O.
TOWNSHIP PLAT SURVEYED IN 1917.

FROM CALCULATED NE 1/16
CORNER, 2" IRON PIPE FALLS
N 88°45' W, 14.3', BRASS CAP
MARKED "NE 1/16 SEC 35
1977 LS 15650" FALLS N 88°32' W,
13.06', REBAR WITH YELLOW CAP
MARKED "LS 32450" FALLS
S 10°26' W, 3.14', OLD NW FENCE
CORNER FALLS S 41°20' W, 17.3',
PER RECORD OF SURVEY,
A.F. NO. 200503170089

NOTES

- THIS SURVEY WAS PERFORMED IN THE FIELD USING A LEICA TC1105
ELECTRONIC DISTANCE MEASURING THEODOLITE.
- THIS SURVEY WAS PERFORMED WITHOUT THE BENEFIT OF A CURRENT
TITLE REPORT. THIS SURVEY DOES NOT PURPORT TO SHOW ALL
EASEMENTS, RESTRICTIONS, RESERVATIONS, PROVISIONS, COVENANTS
OR CONDITIONS WHICH MAY AFFECT THE PARCELS SHOWN HEREON.
- BASIS OF BEARING: THE CENTERLINE OF SECTION 35, TWP. 34 N., RGE.
2 E., W.M., BETWEEN THE CENTER OF SECTION AND THE CENTER NORTH
1/16 (BEING AN IRON PIPE SET IN CASE PER THE LATTER REFERENCED
RECORD OF SURVEY) THEREON BEARS N 01°35'58" W, AS SHOWN ON
RECORD OF SURVEY FILED IN BOOK 18 OF SURVEY'S, PAGE 100, UNDER
AUDITOR'S FILE NUMBER 960605054, RECORDS OF SKAGIT COUNTY
WASHINGTON, AND ON RECORD OF SURVEY RECORDED UNDER AUDITOR'S FILE
NO. 200503170089
- THIS IS A BOUNDARY SURVEY ONLY. UTILITIES WERE NOT INVESTIGATED.
- THE FOUND IRON PIPE IN CASE AT THE CN 1/16 CORNER AS SHOWN ON
AF#960605054, CORNER HAS NO HISTORY FROM PRIOR SURVEYS OTHER
THAN ON COUNTY ROAD PLAT DATED, AUG. 1958, WHICH SHOWS A
BREAKDOWN OF THE SOUTH HALF OF THE NORTH HALF OF SECTION 35, WITH
NO REFERENCE TO WHAT IF ANYTHING WAS FOUND OR SET. SURVEYS
AF#872429 AND AF#872430, SHOWS THE CN 1/16 SET BY PROPORTIONING
ALONG THE NORTH-SOUTH CENTER LINE OF SECTION 35, PER REVIEW BY
B.L.M., THE PROPER WAY TO REESTABLISH THE SOUTH LINE OF NORTH
HALF OF SECTION 35, IS TO USE THE "THREE MILE RULE" AS SHOWN ON
G.L.O. TOWNSHIP PLAT OF TOWNSHIPS 34 AND 35, DATED SEPT. 19,
1874.

LEGAL DESCRIPTIONS

LEGAL DESCRIPTION SWINOMISH INDIAN TRIBAL COMMUNITY-RESERVED AREA-LOT A
ALL THAT PORTION OF THE NORTH 1/2 OF THE NORTHEAST 1/4 OF SECTION 35,
TOWNSHIP 34 NORTH, RANGE 2 EAST, W.M., AS SHOWN ON RECORD OF SURVEY
UNDER AUDITOR'S FILE NO. 200503170089, MORE PARTICULARLY DESCRIBED AS
FOLLOWS:

COMMENCING AT THE NORTH 1/4 CORNER AS SHOWN ON SAID RECORD OF
SURVEY; THENCE SOUTH 01°29'53" EAST ALONG THE EAST LINE OF SAID 1/4
SECTION A DISTANCE OF 653.18 FEET TO THE PROJECTED NORTH LINE OF A 40
FOOT WIDE ROAD EASEMENT; THENCE NORTH 87°33'13" EAST ALONG THE
PROJECTED ROAD EASEMENT A DISTANCE OF 124.34 FEET TO THE TRUE POINT OF
BEGINNING; THENCE CONTINUING NORTH 87°33'13" EAST ALONG SAID EASEMENT
LINE A DISTANCE OF 466.76 FEET; THENCE NORTH 01°26'20" WEST A DISTANCE
OF 462.59 FEET; THENCE SOUTH 88°33'40" WEST A DISTANCE OF 466.69 FEET;
THENCE SOUTH 01°26'20" EAST A DISTANCE OF 470.80 FEET TO THE TRUE POINT
OF BEGINNING.

SITUATE IN THE COUNTY OF SKAGIT, STATE OF WASHINGTON

LEGAL DESCRIPTION SWINOMISH INDIAN TRIBAL COMMUNITY-RESERVED AREA-LOT B

ALL THAT PORTION OF THE NORTH 1/2 OF THE NORTHEAST 1/4 OF SECTION 35,
TOWNSHIP 34 NORTH, RANGE 2 EAST, W.M., AS SHOWN ON RECORD OF SURVEY
UNDER AUDITOR'S FILE NO. 200503170089, MORE PARTICULARLY DESCRIBED AS
FOLLOWS:

COMMENCING AT THE NORTH 1/4 CORNER AS SHOWN ON SAID RECORD OF
SURVEY; THENCE SOUTH 01°29'53" EAST ALONG THE EAST LINE OF SAID 1/4
SECTION A DISTANCE OF 693.18 FEET TO THE PROJECTED SOUTH LINE OF A 40
FOOT WIDE ROAD EASEMENT; THENCE NORTH 87°33'13" EAST A DISTANCE OF
124.30 FEET TO THE TRUE POINT OF BEGINNING; THENCE CONTINUING NORTH
87°33'13" EAST ALONG SAID EASEMENT LINE A DISTANCE OF 466.76 FEET; THENCE
SOUTH 01°26'20" EAST A DISTANCE OF 470.80 FEET; THENCE SOUTH 88°33'40"
WEST A DISTANCE OF 466.69 FEET; THENCE NORTH 01°26'20" WEST A DISTANCE
OF 462.59 FEET TO THE TRUE POINT OF BEGINNING.

SITUATE IN THE COUNTY OF SKAGIT, STATE OF WASHINGTON.

SOURCE LEGAL DESCRIPTION IS INFORMATION
PROVIDED BY CLIENT

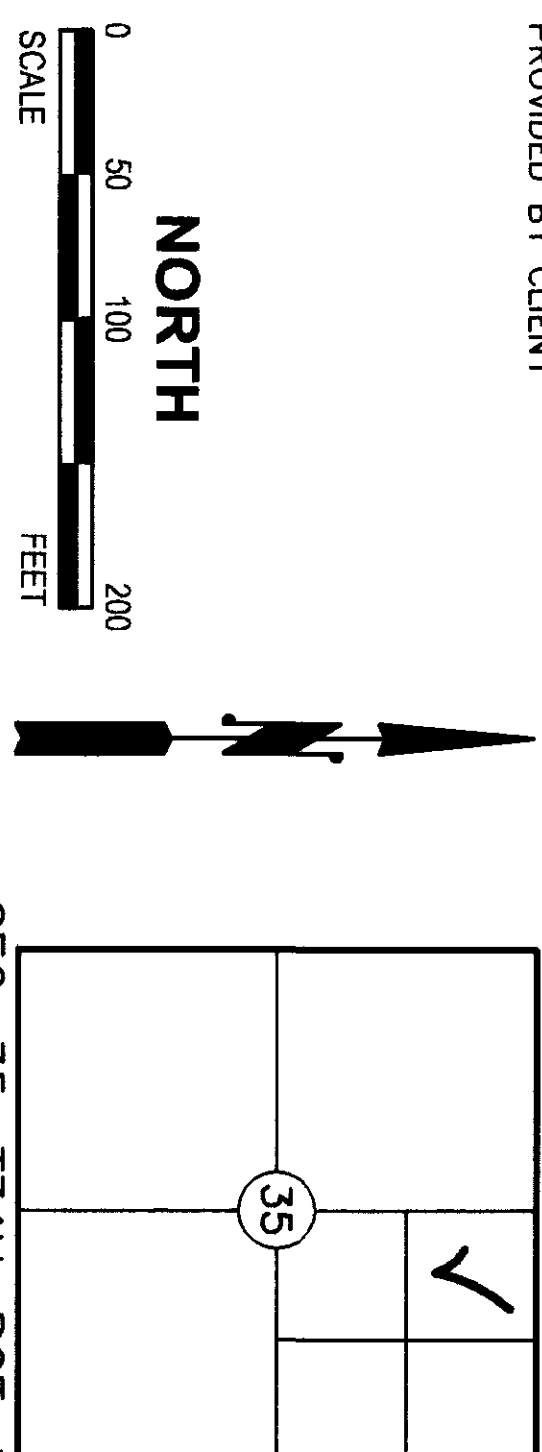

RECORD OF SURVEY

FOR

SWINOMISH INDIAN TRIBAL COMMUNITY

PORTION OF THE NW 1/4 OF THE NE 1/4 OF SECTION 35, TWP. 34 N., RGE. 2 E., W.M.

SKAGIT COUNTY, WASHINGTON

LEONARD, BOUDINOT and SKODJE, INC.

CIVIL ENGINEERS AND LAND SURVEYORS

DWN BY: KWH DATE: 3-5-07
FIELD BOOK: FB 666, PAGE 57

603 SOUTH FIRST ST., MOUNT VERNON, WA 98273 (360)336-5751

SCALE: 1" = 100'
JOB NO: 07007

SURVEYOR'S CERTIFICATE

THIS MAP CORRECTLY REPRESENTS A SURVEY MADE BY
ME OR UNDER MY DIRECTION IN CONFORMANCE WITH THE
REQUIREMENTS OF THE SURVEY RECORDING ACT, AT THE
REQUEST OF

SWINOMISH INDIAN TRIBAL COMMUNITY

JEFFREY A. SKODJE, P.L.S.

CERTIFICATE NO. 19645 DATE 7-22-08

