

AUDITOR'S CERTIFICATE

20080410092  
Skagit County Auditor  
4/11/2008 Page 1 of 1 2:41PM

AT THE REQUEST OF SEMRAU ENGINEERING & SURVEYING P.L.L.C.

J. Yungquist  
SKAGIT COUNTY AUDITOR

Mary Johnson  
DEPUTY

SURVEY DESCRIPTION

LOT 41, SHELTER BAY DIVISION NO. 1, ACCORDING TO THE PLAT THEREOF, RECORDED IN VOLUME 9 OF PLATS, PAGES 80 AND 81, RECORDS OF SKAGIT COUNTY, WASHINGTON, SITUATE IN THE COUNTY OF SKAGIT, STATE OF WASHINGTON.

NOTES

1. INDICATES IRON REBAR SET WITH YELLOW CAP - SURVEY NUMBER SEMRAU 28626
2. THE DESCRIPTION FOR THIS SURVEY IS FROM STATUTORY WARRANTY DEED RECORDED AS AFN 200509210076.
3. FOR ADDITIONAL MERIDIAN AND SURVEY INFORMATION SEE PLAT OF SHELTER BAY DIVISION NO. 1 AS PER PLAT RECORDED IN VOLUME 9 OF PLATS, PAGES 80 AND 81, RECORDS OF SKAGIT COUNTY, WASHINGTON, AND ALSO UNRECORDED SURVEY MAP OF LOTS 40 AND 41 PREPARED BY DON SEMRAU AND ASSOCIATES, AVAILABLE AT THE SHELTER BAY OFFICE, AND ALSO SURVEY MAP OF LOT 39 PREPARED BY LISSE & ASSOCIATES RECORDED AS AFN 200204260010.
4. BASIS OF BEARINGS: PLAT OF SHELTER BAY DIVISION NO. 1.
5. MERIDIAN: PLAT OF SHELTER BAY DIVISION NO. 1.
6. INSTRUMENTATION: LEICA TCA 1105 THEODOLITE DISTANCE METER.
7. ALL DISTANCES ARE SHOWN IN FEET.
8. SURVEY PROCEDURE: STANDARD FIELD TRAVERSE.
9. THIS SURVEY WAS REQUESTED BY GARY AND SANDY FREDERICKSON.
10. THIS SURVEY MAY SHOW OCCUPATIONAL INDICATORS AS PER W.A.C. CHAPTER 332.130, LINES OF OCCUPATION MAY INDICATE AREAS FOR POTENTIAL CLAIMS OF UNWRITTEN OWNERSHIP. THIS BOUNDARY SURVEY HAS ONLY SHOWN THE RELATIONSHIP OF LINES OF OCCUPATION TO THE DEEDED LINES OF RECORD. NO RESOLUTION OF OWNERSHIP BASED ON UNWRITTEN RIGHTS HAS BEEN MADE OR IMPLIED BY THIS SURVEY.
11. EXCEPT AS SPECIFICALLY STATED OR SHOWN ON THIS SURVEY MAP, THIS SURVEY DOES NOT PURPORT TO REFLECT ALL OF THE FOLLOWING WHICH MAY BE APPLICABLE TO THE SUBJECT REAL ESTATE: EASEMENTS, BUILDING SETBACKS LINES, RESTRICTIVE COVENANTS, SUBDIVISION RESTRICTIONS, ZONING OR OTHER LAND-USE REGULATIONS AND ANY OTHER FACTS THAT AN ACCURATE AND CURRENT TITLE SEARCH MAY DISCLOSE.
12. SURVEY MONUMENTATION WITHIN SHELTER BAY IS VERY MINIMAL. THE CONCRETE FOUNDATIONS SHOWN ON THE FACE OF THE RECORDED SURVEY MAPS HAVE NOT BEEN FOUND. THESE ARE BASED UPON A BEST FIT RELATIONSHIP OF EXISTING ROAD SPIKES AND LOCATIONS WHERE FOUND ACCORDING TO CONVERSATIONS WITH FORMER EMPLOYEES OF RUSKIN FISHER & ASSOC., IN THE EARLY 1980'S CORNER PIPES AND CENTERLINE CONTROLS SPIKES WERE SET INDEPENDENT OF EACH OTHER.

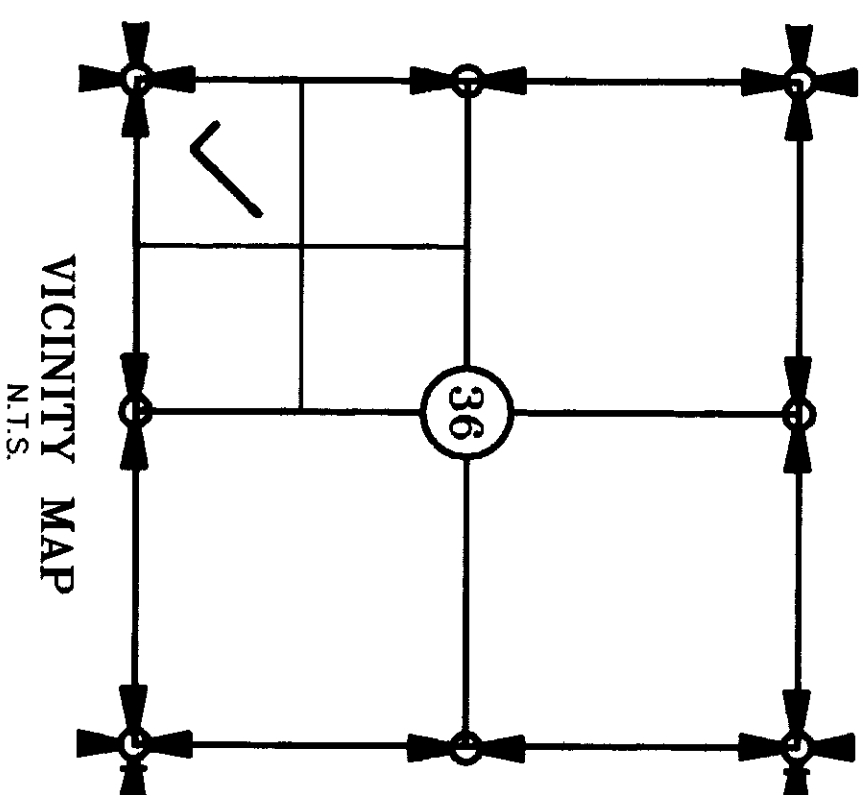

SHEET 1 OF 1 36-34-2

SURVEY OF LOT 41  
SHELTER BAY DIVISION 1  
SKAGIT COUNTY, WASHINGTON  
FOR: GARY AND SANDY FREDERICKSON

FB. 240 Pg. 24-25 SEMRAU ENGINEERING & SURVEYING SCALE: 1" = 20'  
MERIDIAN: PLAT SURVEYING - ENGINEERING - PLANNING  
MOUNT VERNON, WA 98273 360-424-9566 JOB NO. 4818

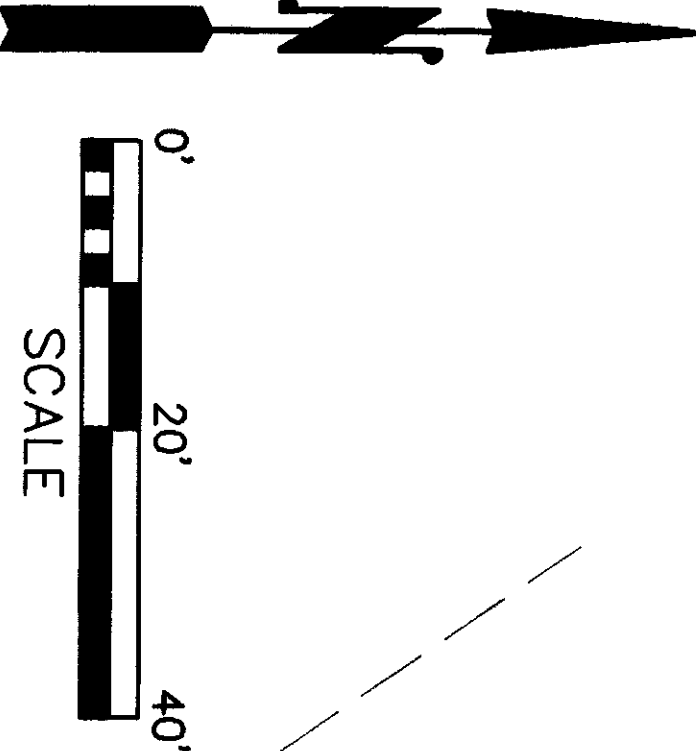

**SURVEYOR'S CERTIFICATE**  
THIS MAP CORRECTLY REPRESENTS A SURVEY MADE BY ME OR UNDER MY DIRECTION IN CONFORMANCE WITH THE REQUIREMENTS OF THE SURVEY RECORDING ACT AT THE REQUEST OF GARY AND SANDY FREDERICKSON.  
JOHN B. SEMRAU, P.E., P.L.S., CERTIFICATE NO. 28626  
SEMRAU ENGINEERING & SURVEYING, P.L.L.C.  
2118 RIVERSIDE DRIVE, SUITE 208  
MOUNT VERNON, WA 98273  
PHONE 360-424-9566

4-11-08

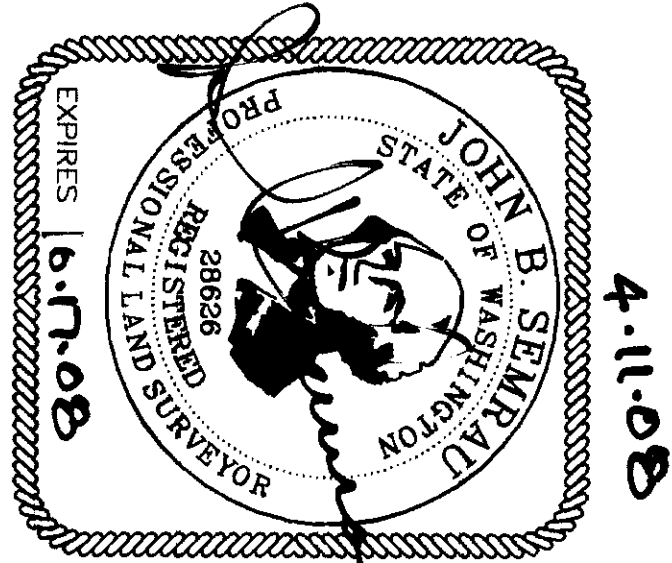

ROS AFN 200204260010

TRACT "E"

FOUND  
RBC LISSE  
NO. 22960

N 85°19'08" W  
40.00'  
N 34°28'15" W  
10.00'  
39.48'  
N 84°36'12" E

R=20'  
Δ=57°15'45"  
L=19.99'

N 55°31'45" E  
225.00'

TRACT "A"  
SKOKOMISH  
(PRIVATE) WAY

EDGE OF PAVEMENT  
N 55°31'45" E

100.00'  
S 34°28'15" E

EXISTING  
CONCRETE  
DRIVE

FOUND I.P. DOWN 1.2'  
N 14°28' E. 0.7'

FOUND  
RBC D.S.  
NO. 9622

FOUND 3/4" I.P.  
S 61°52' E. 0.3'

TRACT "C"