

Return to:



200803270109

Skagit County Auditor

3/27/2008 Page

1 of

2 1:30PM

PROTECTED CRITICAL AREA SITE PLAN

Page 1 of 2

Grantor/Owner:

Gary Henry

Grantee: PUBLIC

Site Address:

13263 & 13301 Deane Drive

Property ID #: P 64852/64853 Assessors Tax Account #:

Legal Description: Sec. 11 Twp. 34 Rng. 1 / Plat Name Lot

Permit/Activity #:

BP08-0022

The PROTECTED CRITICAL AREA (PCA) is to be left undisturbed in its natural state. "With the exception of activities identified as Allowed without Standard review under SCC 14.24.100, any land-use activity that can impair the functions and values of critical areas or their buffers through a development activity or by disturbance of the soil or water, and/or by removal of, or damage to, existing vegetation shall require critical areas review and written authorization pursuant to SCC 14.24." SCC 14.24.060 No clearing, grading, filling, logging or removal of woody material, building, construction or road construction of any kind, planting of non-native vegetation or grazing of livestock is allowed within the PCA areas except as specifically permitted by Skagit County on a case-by-case basis consistent with SCC 14.24.

Representations on this site plan may be approximations only and should not be used for purposes other than for determining general locations of critical areas. Development activities beyond the scope of this plan may require additional studies and approvals.

The above references to "Grantor" and "Grantee" shall not be construed as a transfer of property ownership and are used solely for filing with the County Auditor.

Owner:

Gary C. Henry

Date:

3/27/08

On this day personally appeared before me GARY HENRY known to be the individual described herein and acknowledged to me that he signed the same as his free and voluntary act and deed for the uses and purposes therein mentioned.

residing at

Patricia J. Chambers

Notary Public in and for the State of Washington,

MOUNT VERNON

Date:

3/23/2012

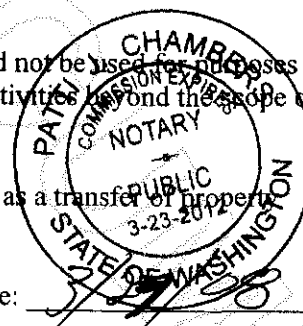

# CRITICAL AREA SITE PLAN

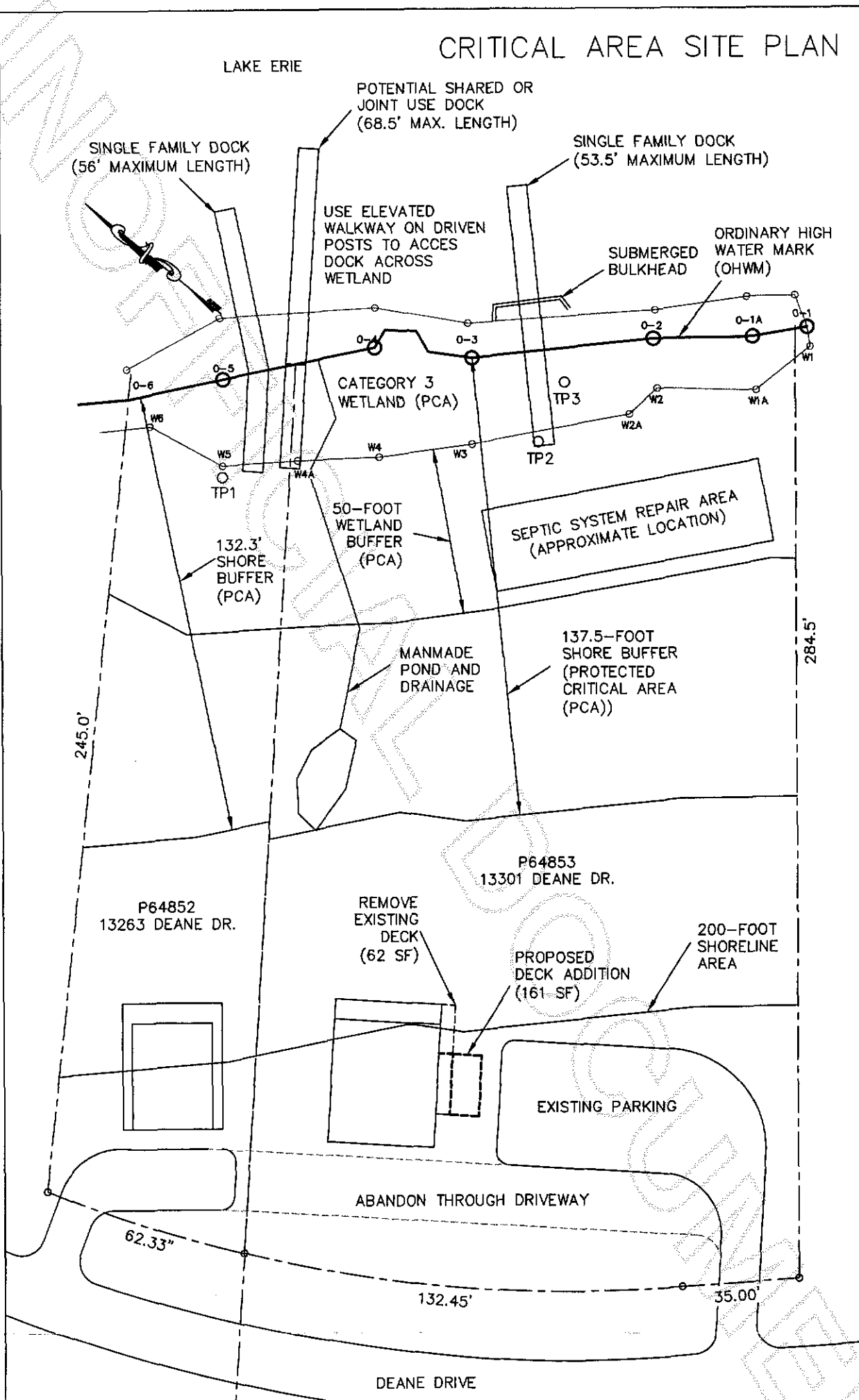

Owners: Gary Henry  
 Address: Deane Drive  
 Parcel: P64852 & P64853  
 Permit:  
 Preparer: Edison Engineering  
 Date: March, 2008  
 Project: 208009

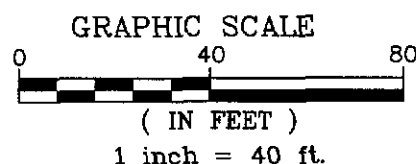

This drawing was created with a compass  
 and tape measure and is approximate.  
**NOT A SURVEY**



200803270109  
 Skagit County Auditor