

CONSENT AND DEDICATION

KNOW ALL PERSONS BY THESE PRESENTS THAT THE UNDERSIGNED OWNERS OF THE LAND HEREBY PLATTED, DECLARE THIS SHORT PLAT AND DEDICATE TO THE USE OF THE PUBLIC FOR ALL STREETS AND AVENUES SHOWN HEREON AND THE USE THEREOF FOR ALL PUBLIC PURPOSES CONSISTENT WITH THE USE THEREOF FOR PUBLIC HIGHWAY PURPOSES. ALSO THE RIGHT TO MAKE ALL NECESSARY SLOPS FOR CUTS AND FILLS UPON THE LOTS AND BLOCKS ON SHOWN HEREON IN THE ORIGINAL REASONABLE GRADING OF ALL SUCH STREETS AND AVENUES SHOWN HEREON.

IAN MUNGE, CITY ATTORNEY, CITY OF ANACORTES

FOR FIDALGO COUNTY INN LLC

FOR COMMOORE MOTOR HOTEL INC.

ACKNOWLEDGMENT

STATE OF WASHINGTON COUNTY OF ON THIS 13th DAY OF February 2008, BEFORE ME, THE UNDERSIGNED, A NOTARY PUBLIC IN AND FOR THE STATE OF WASHINGTON, DULY COMMISSIONED AND SWORN PERSONALLY APPEARED, TO ME KNOWN TO BE THE INDIVIDUAL DESCRIBED IN AND WHO EXECUTED THE WITHIN INSTRUMENT, AND ACKNOWLEDGED THAT THEY SIGNED AND SEALED THE SAME AS THEIR FREE AND VOLUNTARY ACT AND DEED, FOR THE PURPOSES THEREIN MENTIONED.

NOTARY PUBLIC RESIDING AT

MOUNT VERNON, WA

ACKNOWLEDGMENT

STATE OF WASHINGTON COUNTY OF ON THIS 14th DAY OF February 2008, BEFORE ME, THE UNDERSIGNED, A NOTARY PUBLIC IN AND FOR THE STATE OF WASHINGTON, DULY COMMISSIONED AND SWORN PERSONALLY APPEARED, TO ME KNOWN TO BE THE INDIVIDUAL DESCRIBED IN AND WHO EXECUTED THE WITHIN INSTRUMENT, AND ACKNOWLEDGED THAT THEY SIGNED AND SEALED THE SAME AS THEIR FREE AND VOLUNTARY ACT AND DEED, FOR THE PURPOSES THEREIN MENTIONED.

NOTARY PUBLIC RESIDING AT

EDMUNDS, WA

ACKNOWLEDGMENT

STATE OF WASHINGTON COUNTY OF ON THIS 14th DAY OF February 2008, BEFORE ME, THE UNDERSIGNED, A NOTARY PUBLIC IN AND FOR THE STATE OF WASHINGTON, DULY COMMISSIONED AND SWORN PERSONALLY APPEARED, TO ME KNOWN TO BE THE INDIVIDUAL DESCRIBED IN AND WHO EXECUTED THE WITHIN INSTRUMENT, AND ACKNOWLEDGED THAT THEY SIGNED AND SEALED THE SAME AS THEIR FREE AND VOLUNTARY ACT AND DEED, FOR THE PURPOSES THEREIN MENTIONED.

NOTARY PUBLIC RESIDING AT

EDMUNDS, WA

TREASURER'S CERTIFICATE

THIS IS TO CERTIFY THAT ALL TAXES LEVIED, WHICH HAVE BECOME A LIEN UPON THE LANDS HEREIN DESCRIBED, HAVE BEEN FULLY PAID AND DISCHARGED ACCORDING TO THE RECORDS OF MY OFFICE INCLUDING TAXES FOR THE CURRENT YEAR OF 2008, 2007, 2006, 2005, 2004, 2003, 2002, 2001, 2000, 1999, 1998, 1997, 1996, 1995, 1994, 1993, 1992, 1991, 1990, 1989, 1988, 1987, 1986, 1985, 1984, 1983, 1982, 1981, 1980, 1979, 1978, 1977, 1976, 1975, 1974, 1973, 1972, 1971, 1970, 1969, 1968, 1967, 1966, 1965, 1964, 1963, 1962, 1961, 1960, 1959, 1958, 1957, 1956, 1955, 1954, 1953, 1952, 1951, 1950, 1949, 1948, 1947, 1946, 1945, 1944, 1943, 1942, 1941, 1940, 1939, 1938, 1937, 1936, 1935, 1934, 1933, 1932, 1931, 1930, 1929, 1928, 1927, 1926, 1925, 1924, 1923, 1922, 1921, 1920, 1919, 1918, 1917, 1916, 1915, 1914, 1913, 1912, 1911, 1910, 1909, 1908, 1907, 1906, 1905, 1904, 1903, 1902, 1901, 1900, 1899, 1898, 1897, 1896, 1895, 1894, 1893, 1892, 1891, 1890, 1889, 1888, 1887, 1886, 1885, 1884, 1883, 1882, 1881, 1880, 1879, 1878, 1877, 1876, 1875, 1874, 1873, 1872, 1871, 1870, 1869, 1868, 1867, 1866, 1865, 1864, 1863, 1862, 1861, 1860, 1859, 1858, 1857, 1856, 1855, 1854, 1853, 1852, 1851, 1850, 1849, 1848, 1847, 1846, 1845, 1844, 1843, 1842, 1841, 1840, 1839, 1838, 1837, 1836, 1835, 1834, 1833, 1832, 1831, 1830, 1829, 1828, 1827, 1826, 1825, 1824, 1823, 1822, 1821, 1820, 1819, 1818, 1817, 1816, 1815, 1814, 1813, 1812, 1811, 1810, 1809, 1808, 1807, 1806, 1805, 1804, 1803, 1802, 1801, 1800, 1799, 1798, 1797, 1796, 1795, 1794, 1793, 1792, 1791, 1790, 1789, 1788, 1787, 1786, 1785, 1784, 1783, 1782, 1781, 1780, 1779, 1778, 1777, 1776, 1775, 1774, 1773, 1772, 1771, 1770, 1769, 1768, 1767, 1766, 1765, 1764, 1763, 1762, 1761, 1760, 1759, 1758, 1757, 1756, 1755, 1754, 1753, 1752, 1751, 1750, 1749, 1748, 1747, 1746, 1745, 1744, 1743, 1742, 1741, 1740, 1739, 1738, 1737, 1736, 1735, 1734, 1733, 1732, 1731, 1730, 1729, 1728, 1727, 1726, 1725, 1724, 1723, 1722, 1721, 1720, 1719, 1718, 1717, 1716, 1715, 1714, 1713, 1712, 1711, 1710, 1709, 1708, 1707, 1706, 1705, 1704, 1703, 1702, 1701, 1700, 1699, 1698, 1697, 1696, 1695, 1694, 1693, 1692, 1691, 1690, 1689, 1688, 1687, 1686, 1685, 1684, 1683, 1682, 1681, 1680, 1679, 1678, 1677, 1676, 1675, 1674, 1673, 1672, 1671, 1670, 1669, 1668, 1667, 1666, 1665, 1664, 1663, 1662, 1661, 1660, 1659, 1658, 1657, 1656, 1655, 1654, 1653, 1652, 1651, 1650, 1649, 1648, 1647, 1646, 1645, 1644, 1643, 1642, 1641, 1640, 1639, 1638, 1637, 1636, 1635, 1634, 1633, 1632, 1631, 1630, 1629, 1628, 1627, 1626, 1625, 1624, 1623, 1622, 1621, 1620, 1619, 1618, 1617, 1616, 1615, 1614, 1613, 1612, 1611, 1610, 1609, 1608, 1607, 1606, 1605, 1604, 1603, 1602, 1601, 1600, 1599, 1598, 1597, 1596, 1595, 1594, 1593, 1592, 1591, 1590, 1589, 1588, 1587, 1586, 1585, 1584, 1583, 1582, 1581, 1580, 1579, 1578, 1577, 1576, 1575, 1574, 1573, 1572, 1571, 1570, 1569, 1568, 1567, 1566, 1565, 1564, 1563, 1562, 1561, 1560, 1559, 1558, 1557, 1556, 1555, 1554, 1553, 1552, 1551, 1550, 1549, 1548, 1547, 1546, 1545, 1544, 1543, 1542, 1541, 1540, 1539, 1538, 1537, 1536, 1535, 1534, 1533, 1532, 1531, 1530, 1529, 1528, 1527, 1526, 1525, 1524, 1523, 1522, 1521, 1520, 1519, 1518, 1517, 1516, 1515, 1514, 1513, 1512, 1511, 1510, 1509, 1508, 1507, 1506, 1505, 1504, 1503, 1502, 1501, 1500, 1499, 1498, 1497, 1496, 1495, 1494, 1493, 1492, 1491, 1490, 1489, 1488, 1487, 1486, 1485, 1484, 1483, 1482, 1481, 1480, 1479, 1478, 1477, 1476, 1475, 1474, 1473, 1472, 1471, 1470, 1469, 1468, 1467, 1466, 1465, 1464, 1463, 1462, 1461, 1460, 1459, 1458, 1457, 1456, 1455, 1454, 1453, 1452, 1451, 1450, 1449, 1448, 1447, 1446, 1445, 1444, 1443, 1442, 1441, 1440, 1439, 1438, 1437, 1436, 1435, 1434, 1433, 1432, 1431, 1430, 1429, 1428, 1427, 1426, 1425, 1424, 1423, 1422, 1421, 1420, 1419, 1418, 1417, 1416, 1415, 1414, 1413, 1412, 1411, 1410, 1409, 1408, 1407, 1406, 1405, 1404, 1403, 1402, 1401, 1400, 1399, 1398, 1397, 1396, 1395, 1394, 1393, 1392, 1391, 1390, 1389, 1388, 1387, 1386, 1385, 1384, 1383, 1382, 1381, 1380, 1379, 1378, 1377, 1376, 1375, 1374, 1373, 1372, 1371, 1370, 1369, 1368, 1367, 1366, 1365, 1364, 1363, 1362, 1361, 1360, 1359, 1358, 1357, 1356, 1355, 1354, 1353, 1352, 1351, 1350, 1349, 1348, 1347, 1346, 1345, 1344, 1343, 1342, 1341, 1340, 1339, 1338, 1337, 1336, 1335, 1334, 1333, 1332, 1331, 1330, 1329, 1328, 1327, 1326, 1325, 1324, 1323, 1322, 1321, 1320, 1319, 1318, 1317, 1316, 1315, 1314, 1313, 1312, 1311, 1310, 1309, 1308, 1307, 1306, 1305, 1304, 1303, 1302, 1301, 1300, 1299, 1298, 1297, 1296, 1295, 1294, 1293, 1292, 1291, 1290, 1289, 1288, 1287, 1286, 1285, 1284, 1283, 1282, 1281, 1280, 1279, 1278, 1277, 1276, 1275, 1274, 1273, 1272, 1271, 1270, 1269, 1268, 1267, 1266, 1265, 1264, 1263, 1262, 1261, 1260, 1259, 1258, 1257, 1256, 1255, 1254, 1253, 1252, 1251, 1250, 1249, 1248, 1247, 1246, 1245, 1244, 1243, 1242, 1241, 1240, 1239, 1238, 1237, 1236, 1235, 1234, 1233, 1232, 1231, 1230, 1229, 1228, 1227, 1226, 1225, 1224, 1223, 1222, 1221, 1220, 1219, 1218, 1217, 1216, 1215, 1214, 1213, 1212, 1211, 1210, 1209, 1208, 1207, 1206, 1205, 1204, 1203, 1202, 1201, 1200, 1199, 1198, 1197, 1196, 1195, 1194, 1193, 1192, 1191, 1190, 1189, 1188, 1187, 1186, 1185, 1184, 1183, 1182, 1181, 1180, 1179, 1178, 1177, 1176, 1175, 1174, 1173, 1172, 1171, 1170, 1169, 1168, 1167, 1166, 1165, 1164, 1163, 1162, 1161, 1160, 1159, 1158, 1157, 1156, 1155, 1154, 1153, 1152, 1151, 1150, 1149, 1148, 1147, 1146, 1145, 1144, 1143, 1142, 1141, 1140, 1139, 1138, 1137, 1136, 1135, 1134, 1133, 1132, 1131, 1130, 1129, 1128, 1127, 1126, 1125, 1124, 1123, 1122, 1121, 1120, 1119, 1118, 1117, 1116, 1115, 1114, 1113, 1112, 1111, 1110, 1109, 1108, 1107, 1106, 1105, 1104, 1103, 1102, 1101, 1100, 1099, 1098, 1097, 1096, 1095, 1094, 1093, 1092, 1091, 1090, 1089, 1088, 1087, 1086, 1085, 1084, 1083, 1082, 1081, 1080, 1079, 1078, 1077, 1076, 1075, 1074, 1073, 1072, 1071, 1070, 1069, 1068, 1067, 1066, 1065, 1064, 1063, 1062, 1061, 1060, 1059, 1058, 1057, 1056, 1055, 1054, 1053, 1052, 1051, 1050, 1049, 1048, 1047, 1046, 1045, 1044, 1043, 1042, 1041, 1040, 1039, 1038, 1037, 1036, 1035, 1034, 1033, 1032, 1031, 1030, 1029, 1028, 1027, 1026, 1025, 1024, 1023, 1022, 1021, 1020, 1019, 1018, 1017, 1016, 1015, 1014, 1013, 1012, 1011, 1010, 1009, 1008, 1007, 1006, 1005, 1004, 1003, 1002, 1001, 1000, 999, 998, 997, 996, 995, 994, 993, 992, 991, 990, 989, 988, 987, 986, 985, 984, 983, 982, 981, 980, 979, 978, 977, 976, 975, 974, 973, 972, 971, 970, 969, 968, 967, 966, 965, 964, 963, 962, 961, 960, 959, 958, 957, 956, 955, 954, 953, 952, 951, 950, 949, 948, 947, 946, 945, 944, 943, 942, 941, 940, 939, 938, 937, 936, 935, 934, 933, 932, 931, 930, 929, 928, 927, 926, 925, 924, 923, 922, 921, 920, 919, 918, 917, 916, 915, 914, 913, 912, 911, 910, 909, 908, 907, 906, 905, 904, 903, 902, 901, 900, 899, 898, 897, 896, 895, 894, 893, 892, 891, 890, 889, 888, 887, 886, 885, 884, 883, 882, 881, 880, 879, 878, 877, 876, 875, 874, 873, 872, 871, 870, 869, 868, 867, 866, 865, 864, 863, 862, 861, 860, 859, 858, 857, 856, 855, 854, 853, 852, 851, 850, 849, 848, 847, 846, 845, 844, 843, 842, 841, 840, 839, 838, 837, 836, 835, 834, 833, 832, 831, 830, 829, 828, 827, 826, 825, 824, 823, 822, 821, 820, 819, 818, 817, 816, 815, 814, 813, 812, 811, 810, 809, 808, 807, 806, 805, 804, 803, 802, 801, 800, 799, 798, 797, 796, 795, 794, 793, 792, 791, 790, 789, 788, 787, 786, 785, 784, 783, 782, 781, 780, 779, 778, 777, 776, 775, 774, 773, 772, 771, 770, 769, 768, 767, 766, 765, 764, 763, 762, 761, 760, 759, 758, 757, 756, 755, 754, 753, 752, 751, 750, 749, 748, 747, 746, 745, 744, 743, 742, 741, 740, 739, 738, 737, 736, 735, 734, 733, 732, 731, 730, 729, 728, 727, 726, 725, 724, 723, 722, 721, 720, 719, 718, 717, 716, 715, 714, 713, 712, 711, 710, 709, 708, 707, 706, 705, 704, 703, 702, 701, 700, 699, 698, 697, 696, 695, 694, 693, 692, 691, 690, 689, 688, 687, 686, 685, 684, 683, 682, 681, 680, 679, 678, 677, 676, 675, 674, 673, 672, 671, 670, 669, 668, 667, 666, 665, 664, 663, 662, 661, 660, 659, 658, 657, 656, 655, 654, 653, 652, 651, 650, 649, 648, 647, 646, 645, 644, 643, 642, 641, 640, 639, 638, 637, 636, 635, 634, 633, 632, 631, 630, 629, 628, 627, 626, 625, 624, 623, 622, 621, 620, 619, 618, 617, 616, 615, 614, 613, 612, 611, 610, 609, 608, 607, 606, 605, 604, 603, 602, 601, 600, 599, 598, 597, 596, 595, 594, 593, 592, 591, 590, 589, 588, 587, 586, 585, 584, 583, 582, 581, 580, 579, 578, 577, 576, 575, 574, 573, 572, 571, 570, 569, 568, 567, 566, 565, 564, 563, 562, 561, 560, 559, 558, 557, 556, 555, 554, 553, 552, 551, 550, 549, 548, 547, 546, 545, 544, 543, 542, 541, 540, 539, 538, 537, 536, 535, 534, 533, 532, 531, 530, 529, 528, 527, 526, 525, 524, 523, 522, 521, 520, 519, 518, 517, 516, 515, 514, 513, 512, 511, 510, 509, 508, 507, 506, 505, 504, 503, 502, 501, 500, 499, 498, 497, 496, 495, 494, 493, 492, 491, 490, 489, 488, 487, 486, 485, 484, 483, 482, 481, 480, 479, 478, 477, 476, 475, 474, 473, 472, 471, 470, 469, 468, 467, 466, 465, 464, 463, 462, 461, 460, 459, 458, 457, 456, 455, 454, 453, 452, 451, 450, 449, 448, 447, 446, 445, 444, 443, 442, 441, 440, 439, 438, 437, 436, 435, 434, 433, 432, 431, 430, 429, 428, 427, 426, 425, 424, 423, 422, 421, 420, 419, 418, 417, 416, 415, 414, 413, 412, 411, 410, 409, 408, 407, 406, 405, 404, 403, 402, 401, 400, 399, 398, 397, 396, 395, 394, 393, 392, 391, 390, 389, 388, 387, 386, 385, 384, 383, 382, 381, 380, 379, 378, 377, 376, 375, 374, 373, 372, 371, 370, 369, 368, 367, 366, 365, 364, 363, 362, 361, 360, 359, 358, 357, 356, 355, 354, 353, 352, 351, 350, 349, 348, 347, 346, 345, 344, 343, 342, 341, 340, 339, 338, 337, 336, 335, 334, 333, 332, 331, 330, 329, 328, 327, 326, 325, 324, 323, 322, 321, 320, 319, 318, 317, 316, 315, 314, 313, 312, 311, 310, 309, 308, 307, 306, 305, 304, 303, 302, 301, 300, 299, 298, 297, 296, 295, 294, 293, 292, 291, 290, 289, 288, 287, 286, 285, 284, 283, 282, 281, 280, 279, 278, 277, 276, 275, 274, 273, 272, 271, 270, 269, 268, 267, 266, 265, 264, 263, 262, 261, 260, 259, 258, 257, 256, 255, 254, 253, 252, 251, 250, 249, 248, 247, 246, 245, 244, 243, 242, 241, 240, 239, 238, 237, 236, 235, 234, 233, 232, 231, 230, 229, 228, 227, 226, 225, 224, 223, 222, 221, 220, 219, 218, 217, 216, 215, 214, 213, 212, 211, 210, 209, 208, 207, 206, 205, 204, 203, 202, 201, 200, 199, 198, 197, 196, 195, 194, 193, 192, 191, 190, 189, 188, 187, 186, 185, 184, 183, 182, 181, 180, 179, 178, 177, 176, 175, 174, 173, 172, 171, 170, 169, 168, 167, 166, 165, 164, 163, 162, 161, 160, 159, 158, 157, 156, 155, 154, 153, 152, 151, 150, 149, 148, 147, 146, 145, 144, 143, 142, 141, 140, 139, 138, 137, 136, 135, 134, 133, 132, 131, 130, 129, 128, 127, 126, 125, 124, 123, 122, 121, 120, 119, 118, 117, 116, 115, 114, 113, 112, 111, 110, 109, 108, 107, 106, 105, 104, 103, 102, 101, 100, 99, 98, 97, 96, 95, 94, 93, 92, 91, 90, 89, 88, 87, 86, 85, 84, 83, 82, 81, 80, 79, 78, 77, 76, 75, 74, 73, 72, 71, 70, 69, 68, 67, 66, 65, 64, 63, 62, 61, 60, 59, 58, 57, 56, 55, 54, 53, 52, 51, 50, 49, 48, 47, 46, 45, 44, 43, 42, 41, 40, 39, 38, 37, 36, 35, 34, 33, 32, 31, 30, 29, 28, 27, 26, 25, 24, 23, 22, 21, 20, 19, 18, 17, 16, 15, 14, 13, 12, 11, 10, 9, 8, 7, 6, 5, 4, 3, 2, 1, 0.

DEPUTY TREASURER

I CERTIFY THAT ALL TAXES HERETOFORE LEVIED AND WHICH HAVE BECOME A LIEN UPON THE LANDS DESCRIBED ABOVE HAVE BEEN FULLY PAID AND DISCHARGED ACCORDING TO THE RECORDS OF MY OFFICE UP TO AND INCLUDING THE YEAR 2007.

CERTIFIED THIS 11 DAY OF February 2008

NOTES-CONTINUED

- 9) MAILBOX LOCATIONS SHALL BE REVIEWED AND APPROVED BY THE CITY PUBLIC WORKS DEPARTMENT.
- 10) STREET LIGHTING SHALL BE ENERGY EFFICIENT AND LOCATED AS REQUIRED BY THE CITY ENGINEER.
- 11) ALL EASEMENTS SHALL BE SURVEYED AND SHOWN ON DRAWINGS.
- 12) PRIOR TO SHORT PLAT APPROVAL ALL INFRASTRUCTURE IMPROVEMENTS SHALL BE COMPLETED AS REQUIRED BY THE PUBLIC WORKS DIRECTOR.
- 13) STREET ADDRESSES-SEE SHEET 1 OF THIS SHORT PLAT.
- 14) A FULL CITY STANDARD CUL-DE-SAC SHALL BE PROVIDED TO ACCOMMODATE FIRE APPARATUS ACCESS.
- 15) ALL NECESSARY EASEMENTS FOR THE GAS LINE SHALL BE PROVIDED AT LOTS 2, 3, AND 6.
- 16) THE WETLANDS DESCRIBED IN THE ATSI REPORT DATED DECEMBER 8, 2006, SHALL BE REEVALUATED AT THE TIME OF CONSTRUCTION BY A QUALIFIED PROFESSIONAL WETLAND SCIENTIST TO DETERMINE EXACT LOCATIONS, REQUIRED BUFFERS AND MITIGATION, IF NEEDED, PER CITY ORDINANCES (POSSIBLE SEPTIC DRAIN FIELDS).
- 17) CURB, GUTTER, AND SIDEWALKS SHALL BE PROVIDED ON BOTH SIDES OF THE PROPOSED ROADWAY AS REQUIRED BY THE PUBLIC WORKS DEPARTMENT.
- 18) FIRE HYDRANTS, FIRE FLOW AND FIRE APPARATUS ACCESS SHALL BE PROVIDED AS REQUIRED BY THE CHIEF.
- 19) SEPTIC DRAIN FIELDS SHALL BE ABANDONED IN A MANNER ACCEPTABLE TO THE SNAKE COUNTY HEALTH DEPARTMENT.
- 20) THE EXISTING OLD BROOK LANE ACCESS SHALL BE FULLY DEVELOPED WITH PAVING GUTTER AND SIDEWALKS AS REQUIRED BY THE PUBLIC WORKS DIRECTOR.
- 21) A LANDSCAPING PLAN CORRESPONDING WITH CITY ORDINANCES SHALL BE PROVIDED FOR REVIEW AND APPROVAL BY THE PLANNING DIRECTOR PRIOR TO CONSTRUCTION TAKING PLACE ON SITE.
- 22) THE CUL-DE-SAC SHALL BE SIGNED "NO PARKING".
- 23) THIS APPROVAL WILL EXPIRE THREE YEARS FROM THE DATE OF APPROVAL IF THE SHORT PLAT IS NOT SIGNED AND RECORDED.
- 24) PAGES 8-10 OF THESE FINDINGS SHALL BE RECORDED WITH THE SHORT PLAT DRAWING.

EXCEPTIONS:

- A. RELINQUISHMENT OF RIGHT OF ACCESS TO STATE HIGHWAY AND OF LIGHT, VIEW AND AIR, UNDER THE TERMS OF DEED TO THE STATE OF WASHINGTON.
RECORDED: SEPTEMBER 19, 1956
AUDITOR'S NO.: 541730
- B. EASEMENT AND THE TERMS AND CONDITIONS THEREOF:
GRANTEE: CASCADE NATURAL GAS CORPORATION
PURPOSE: GAS PIPELINE
AREA AFFECTED: NOT DISCLOSED ON THE RECORD
RECORDED: MAY 3, 1957
AUDITOR'S NO.: 550963
NOT SHOWN ON MAP
- C. EASEMENT AND THE TERMS AND CONDITIONS THEREOF:
GRANTEE: PUGET SOUND POWER & LIGHT COMPANY
PURPOSE: ONE GUY STUB AND ONE GUY WITH A SPAN GUY OVERHAND
AREA AFFECTED: NOT DISCLOSED ON THE RECORD, BEING DESCRIBED AS "AS SURVEYED, STAKED AND AGREED UPON BY BOTH PARTIES."
DATED: SEPTEMBER 10, 1957
RECORDED: SEPTEMBER 11, 1957
AUDITOR'S NO.: 553954
NOT SHOWN ON MAP
- D. EASEMENT AND THE TERMS AND CONDITIONS THEREOF:
GRANTEE: PUBLIC UTILITY DISTRICT NO. 1 OF SNAKE COUNTY
PURPOSE: RIGHT TO LAY AND MAINTAIN WATER LINE, TOGETHER WITH INGRESS AND EGRESS THEREFROM
AREA AFFECTED: A PORTION OF THE EAST BOUNDARY OF PROPERTY HEREIN DESCRIBED
DATED: MAY 5, 1966
RECORDED: MAY 27, 1966
AUDITOR'S NO.: 683418
- E. AN EASEMENT AFFECTING THE PORTION OF SAID PREMISES AND FOR THE PURPOSES STATED HEREIN, AND INCIDENTAL PURPOSES:
FOR: WATER PIPELINE AND APPURTENANCES
IN FAVOR OF: THE CITY OF OAK HARBOR
RECORDED: FEBRUARY 22, 1972
AUDITOR'S NO.: 764355
A STRIP OF LAND PRIMARILY 25- FEET WIDE RUNNING ALONG THE EASTERLY SIDE OF THE SUBJECT PROPERTY

EXCEPTIONS CONTINUED:

- F. AN EASEMENT AFFECTING THE PORTION OF SAID PREMISES AND FOR THE PURPOSES STATED HEREIN, AND INCIDENTAL PURPOSES
FOR: DRAINAGE, ROAD AND UTILITIES
IN FAVOR OF: OWNERS OF RECORD OF TRACTS 1 AND 2 OF SHORT PLAT NO. 34-77
RECORDED: AUGUST 31, 1978
AUDITOR'S NO.: 886636
AFFECTS: AS DELINEATED ON THE FACE OF SHORT PLAT NO. 90-45
- H. EASEMENTS SHOWN ON FACE OF SHORT PLAT NO. 90-45.
FOR: INGRESS, EGRESS AND DRAINAGE
AFFECTS: AS SHOWN ON MAP
- I. EASEMENT AND THE TERMS AND CONDITIONS THEREOF:
GRANTEE: PUGET SOUND POWER & LIGHT COMPANY, A WASHINGTON
PURPOSE: ONE OR MORE ELECTRIC TRANSMISSION AND/OR DISTRIBUTION LINES
RIGHT-OF WAY NO. 1: FOR OVERHEAD FACILITY PURPOSES AS DESCRIBED IN PARAGRAPH 1-A BELOW. THAT CERTAIN 20-FOOT WIDE DRAINAGE AND UTILITY EASEMENT AS DELINEATED ON THE FACE OF THE ABOVE-DESCRIBED SHORT PLAT. RIGHT OF WAY NO. 2: FOR UNDERGROUND FACILITY PURPOSES AS DESCRIBED IN PARAGRAPH 1-B BELOW. A RIGHT-OF- WAY 5 FEET IN WIDTH, HAVING 2 1/2 FEET OF SUCH WIDTH ON EACH SIDE OF A CENTERLINE DESCRIBED AS FOLLOWS: BEGINNING AT THE NORTHWEST CORNER OF THE ABOVE DESCRIBED LOT 1; THENCE SOUTH 00°13'00" WEST ALONG THE WEST LINE OF SAID LOT, 282 FEET TO THE POINT OF BEGINNING; THENCE SOUTH 88°57'00" EAST, 200 FEET; THENCE APPROXIMATELY NORTH 61° EAST, 55 FEET TO THE EAST LINE OF SAID LOT AND THE TERMINUS OF THIS DESCRIPTION, SAID TERMINUS ALSO BEING AN EXISTING PUGET POWER UTILITY POLE..
DATED: DECEMBER 8, 1994
RECORDED: DECEMBER 22, 1994
AUDITOR'S NO.: 941220063
- J. EASEMENT AND TERMS AND CONDITIONS THEREOF:
DISCLOSED BY: SHORT PLAT
PURPOSE: INGRESS, EGRESS AND UTILITIES
AREA AFFECTED: EASTERLY 30 FEET OF LOT 2
- K. EASEMENT AND TERMS AND CONDITIONS THEREOF:
DISCLOSED BY: SHORT PLAT
PURPOSE: ROAD AND UTILITIES
AREA AFFECTED: WESTERLY 50 FEET OF LOT 2
- L. MATTERS DISCLOSED BY RECORD OF SURVEY:
FILED: JANUARY 24, 1991
VOL./Pg.: 9/308
AUDITOR'S NO.: 9101240033
- M. MATTERS DISCLOSED BY RECORD OF SURVEY:
FILED: FEBRUARY 23, 1999
VOL./Pg.: 21/149
AUDITOR'S NO.: 9902230014
- N. SIGN LICENSE AGREEMENT AND THE TERMS AND CONDITIONS THEREOF:
BETWEEN: FLOYD AND MARY WILLETTTE, HUSBAND AND WIFE
AND: CITY OF ANACORTES, A WASHINGTON MUNICIPAL CORPORATION
TERM: 20 YEARS FROM THE DATE OF MUTUAL EXECUTION
DATED: DECEMBER 30, 1996
RECORDED: DECEMBER 31, 1996
AUDITOR'S NO.: 9612310033
CITY HEREBY GRANTS TO LICENSEE A REVOCABLE LICENSE OVER, UNDER AND ACROSS TO OPERATE, THE CITY PROPERTY TO ALLOW LICENSEE, ALL AT LICENSEE'S EXPENSE TO OPERATE, MAINTAIN, AND REPLACE THE EXISTING ADVERTISING SIGN ON THE CITY PROPERTY.
- AREA AFFECTED:
A PORTION OF LOT 4, SNAKE COUNTY SHORT PLAT NO. 90-45, RECORDED JANUARY 24, 1991, UNDER AUDITOR'S FILE NO. 9101240033. RECORDS OF SNAKE COUNTY, WASHINGTON, ACCORDING TO THE PLAT THEREOF RECORDED IN VOLUME 9 OF SHORT PLATS, PAGE 308, BEING A PORTION OF THE NORTHEAST 1/4 OF THE SOUTHWEST 1/4, AND GOVERNMENT LOT 3, SECTION 5, TOWNSHIP 34 NORTH, RANGE 2 EAST, W.M. AND DESCRIBED AS FOLLOWS: BEGINNING AT THE SOUTHEAST CORNER OF SAID LOT 4; THENCE NORTH 00° 13' 00" EAST ALONG THE EASTERMOST PROPERTY LINE A DISTANCE OF 150.00 FEET TO AN ANGLE POINT, AND THE TRUE POINT OF BEGINNING; THENCE NORTH 88° 57' 00" WEST A DISTANCE OF 32.00 FEET; THENCE SOUTH 00° 13' 00" WEST A DISTANCE OF 32.00 FEET; THENCE SOUTH 88° 57' 00" EAST A DISTANCE OF 25.00 FEET; TO THE TRUE POINT OF BEGINNING, SITUATED IN SNAKE COUNTY, WASHINGTON.
- O. TERMS AND CONDITIONS OF SPECIAL USE PERMIT SPU PLO2-0624 AND SHORELINE SUBSTANTIAL DEVELOPMENT PERMIT SMDP PLO2-0622, AS DISCLOSED BY INSTRUMENT RECORDED JUNE 24, 2003, UNDER AUDITOR'S FILE NO. 200306240101.
- P. EASEMENT(S) AS DISCLOSED BY THAT INSTRUMENT RECORDED OCTOBER 19, 2005, UNDER SNAKE COUNTY AUDITOR'S FILE NO. 200510190085 (SEE INSTRUMENT FOR FULL PARTICULARS).
- Q. MATTERS DISCLOSED, AND/OR DELINEATED BY THAT SURVEY RECORDED UNDER SNAKE COUNTY AUDITOR'S FILE NO. 200508290249.
- R. EASEMENT AND THE TERMS AND CONDITIONS THEREOF:
GRANTEE: CITY OF ANACORTES
PURPOSE: UTILITY EASEMENT AGREEMENT
AREA AFFECTED: PORTION OF SUBJECT PROPERTY
DATED: JULY 29, 2005
RECORDED: AUGUST 30, 2005
AUDITOR'S NO.: 200508300145

NAMES OF APPLICANTS:

FIDALGO COUNTRY INN LLC
COMMODORE MOTOR HOTEL INC.
120 W. DAYTON, STE B6
EDMONDS, WA, 98020

CITY OF ANACORTES
P.O. BOX 547
ANACORTES, WA 98221

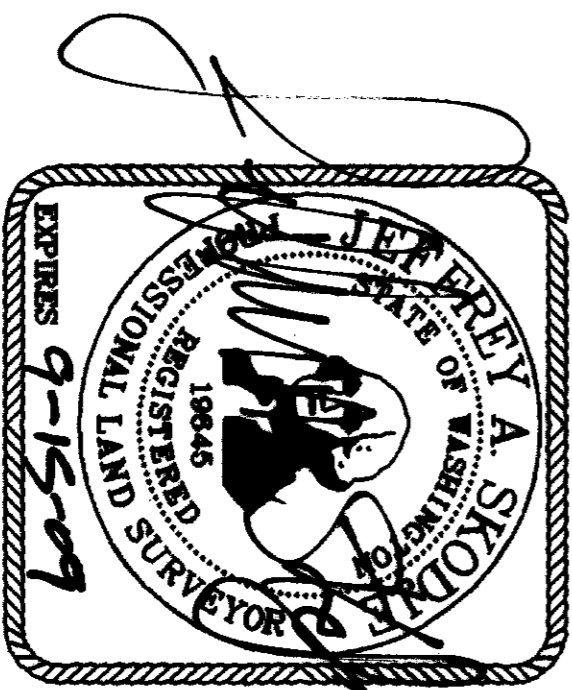

SHORT PLAT NUMBER: ANA 06-011

SHORT PLAT

DATE: DEC., 2007

SHEET 2 OF 3

FOR
CITY OF ANACORTES
PORTION OF THE W 1/2 OF SECTION 5, TWP. 34 N., RGE. 2 E., W.M.
SNAKE COUNTY, WASHINGTON

LEONARD, BOUDINOT and SKODJE INC.
ONE JENNIFER AND LEO SKODJE
P.O. BOX 1226, MOUNT VERNON, WA 98273 (509) 236-5751

FIELD BOOK 631/Pg. 30
DWG. BY RWH
C.D. BY JAS

SCALE: N/A
JOB NO. 06030

PLAT AREA
382299 SQ. FT.
8.8 ACRES

50' CASCADE NAT. GAS CO.
EASEMENT AF NO. 775332

SP 18-85

| NUMBER | DIRECTION | DISTANCE |
|--------|---------------|----------|
| L1 | N 01°37'57" E | 63.82' |
| L2 | N 14°26'10" W | 18.16' |
| L3 | N 01°37'58" E | 73.16' |
| L4 | S 14°26'10" E | 96.24' |
| L5 | S 01°37'57" W | 19.87' |
| L6 | N 87°33'28" W | 110.00' |
| L7 | S 14°26'10" E | 108.82' |
| L8 | N 01°37'58" E | 120.00' |
| L9 | S 87°33'28" E | 40.01' |
| L10 | N 01°37'58" E | 9.58' |
| L11 | S 14°26'10" E | 58.94' |
| L12 | N 14°26'10" W | 32.18' |
| L13 | N 87°33'28" W | 50.53' |
| L14 | N 01°37'58" E | 2.23' |

CURVE TABLE

| NUMBER | DELTA ANGLE | RADIUS | ARC LENGTH |
|--------|-------------|--------|------------|
| C1 | 08°41'26" | 475.00 | 72.05 |
| C2 | 07°22'40" | 475.00 | 61.16 |
| C3 | 11°08'30" | 45.00 | 92.79 |
| C4 | 54°22'45" | 25.00 | 23.73 |
| C5 | 09°22'51" | 525.00 | 85.96 |
| C6 | 89°11'25" | 25.00 | 38.92 |
| C7 | 06°41'15" | 525.00 | 61.28 |
| C8 | 146°43'03" | 45.00 | 115.23 |
| C9 | 37°55'29" | 25.00 | 16.55 |
| C10 | 22°18'51" | 205.00 | 79.84 |

ADDRESSES:

LOT 1 - 7603 SOUTH FIDALGO BAY ROAD
LOT 2 - 7609 SOUTH FIDALGO BAY ROAD
LOT 3 - 7613 SOUTH FIDALGO BAY ROAD
LOT 4 - 7617 SOUTH FIDALGO BAY ROAD
LOT 5 - 7602 SOUTH FIDALGO BAY ROAD
LOT 6 - 7608 SOUTH FIDALGO BAY ROAD
LOT 7 - 7612 SOUTH FIDALGO BAY ROAD
LOT 8 - 7618 SOUTH FIDALGO BAY ROAD
LOT 9 - 7622 SOUTH FIDALGO BAY ROAD

STATE ROUTE 20
N 01°37'58" E

8" HIGH PRESSURE GAS LINE
GAS LINE MARKER

STATE ROUTE 20

50' WIDE INGRESS, EGRESS AND UTILITIES EASEMENT PER SP 90-45

0 50 100

CENTER OF SECTION 5-34-2
FOUND 1 1/2" IRON PIPE
AUG. 2, 1999
F.B. 588, PG. 69

NAMES OF APPLICANTS:
FIDALGO COUNTRY INN LLC
COMMODORE MOTOR HOTEL INC.
120 W. DAYTON, STE B6
EDMONDS, WA. 98020
CITY OF ANACORTES
P.O. BOX 547
ANACORTES, WA. 98221

LEGEND

REBAR WITH CAP MARKED SKODJE "LS 99645"
SET THIS SURVEY

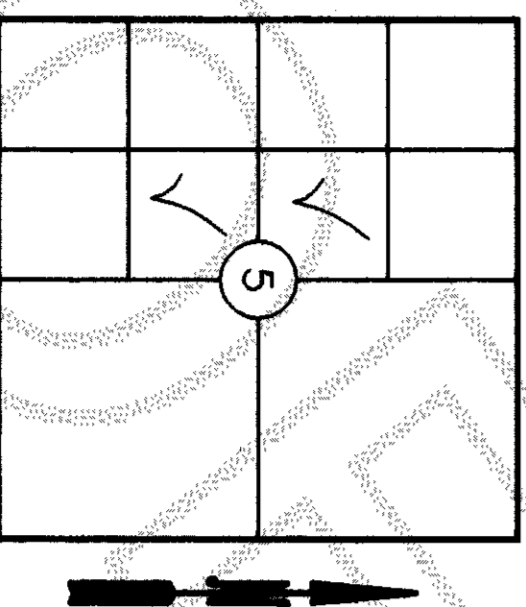

SEC. 5, T34N, R2E, W.M.
NO SCALE

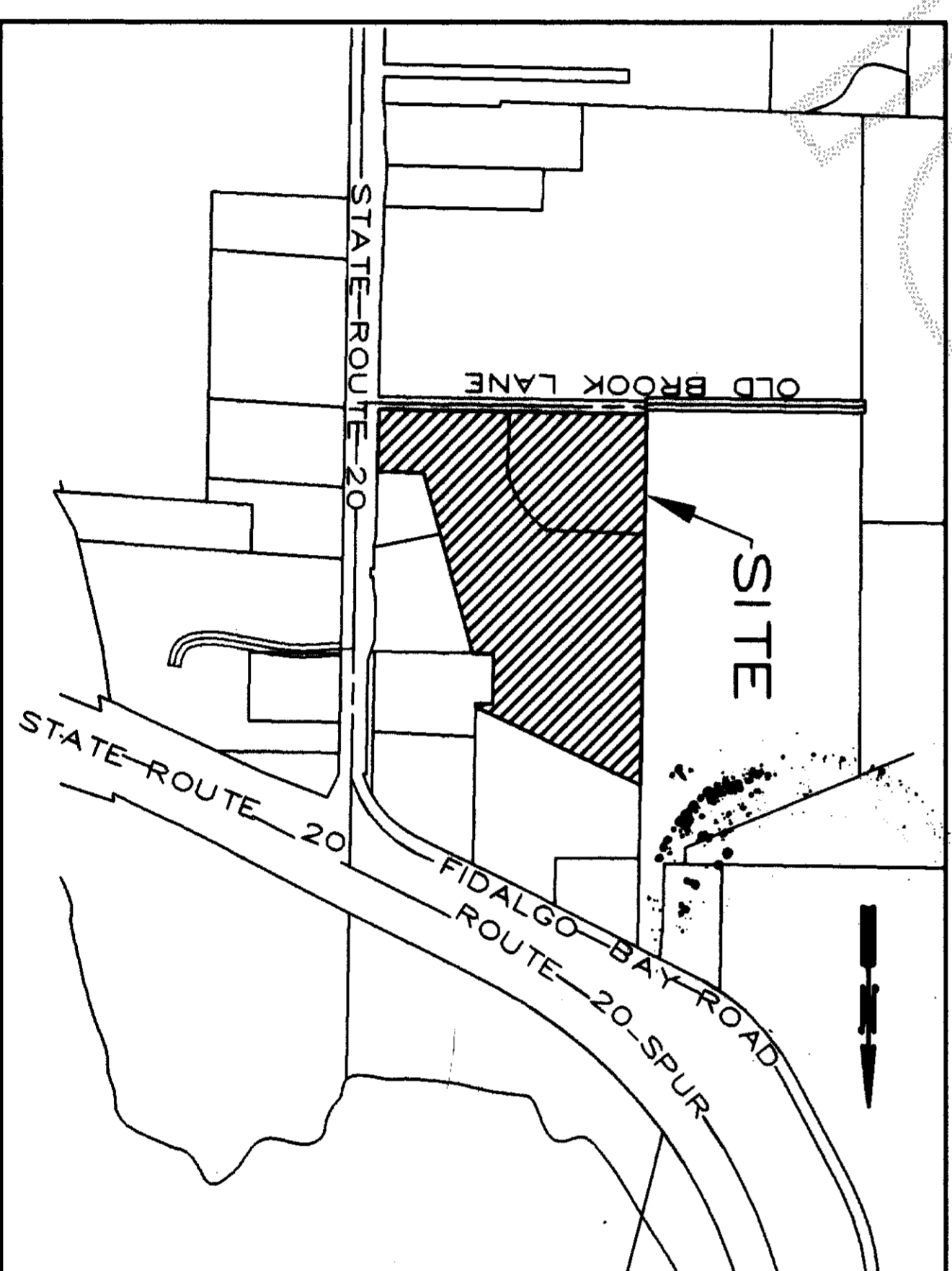

NO SCALE



SHORT PLAT NUMBER: ANA 06-011

DATE: DEC. 2007

SHORT PLAT

FOR
CITY OF ANACORTES
PORTION OF THE W 1/2 OF SECTION 5, TWP. 34 N., RGE. 2 E., W.M.
SKAGIT COUNTY, WASHINGTON

LEONARD, BOUDINOT and SKODJE INC.

FIELD BOOK 631/PG. 30
DWM, BT, RWH, CC, BT, JAS

SCALE: 1"=100'
JOB NO. 060350

2/29/2008 Page 3 of 3 2:31PM

200802290164
Skagit County Auditor