

FOUND 2" ALUMINUM PIPE
MONUMENT WITH 3" FOREST
SERVICE CAP 0.3' ABOVE GROUND
LEVEL ON 1/5/01.

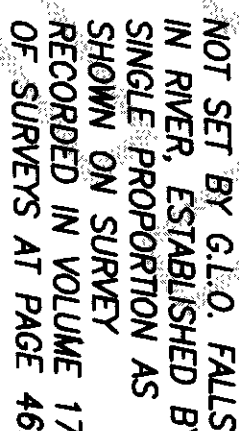

200802070121
Skagit County Auditor

J. Youngquist Megan Wenz
County Auditor or Deputy Auditor

John L. Abenroth CERT#17651
Date 1/23/2008

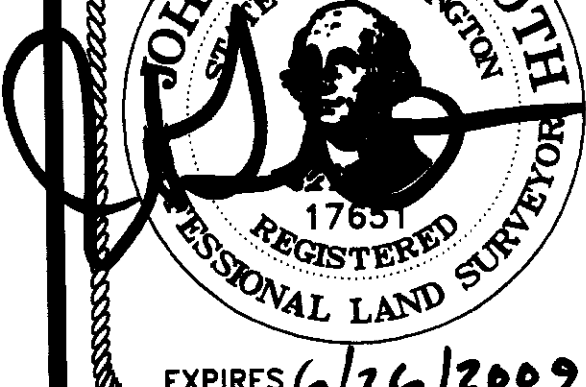

PARCEL "A": JUDGMENT AND DECREE QUITE TITLE CASE NO. 05-2-00671-7
 THAT PORTION OF COVENANT LOT 4 SECTION 13, TOWNSHIP 35 NORTH, RANGE 10 EAST, W.M., DESCRIBED AS FOLLOWS:

PARCEL A: JUDGMENT AND DECREE QUITE TITLE CASE NO. 05-2-00671-7. THAT PORTION OF GOVERNMENT LOT 4, SECTION 13, TOWNSHIP 35 NORTH, RANGE 10 EAST, W.M., DESCRIBED AS FOLLOWS: BEGINNING AT THE POINT WHERE THE NORTH LINE OF SAID LOT 4 INTERSECTS THE CENTERLINE OF THE COUNTY ROAD, THENCE IN A SOUTHWESTERLY DIRECTION 900 FEET ALONG THE CENTER OF SAID COUNTY ROAD; THENCE IN A SOUTHWESTERLY DIRECTION ALONG A LINE, WHICH IF PROJECTED TO THE NORTHWEST WOULD INTERSECT THE NORTHWEST CORNER OF LOT 4, TO THE BANK OF THE SKAGIT RIVER; THENCE NORTHEASTERLY ALONG THE BANK OF THE SKAGIT RIVER TO THE NORTH LINE OF SAID SUBDIVISION; THENCE WEST ALONG SAID NORTH LINE TO POINT OF BEGINNING.

EXCEPT THAT PORTION THEREOF LYING NORTHWESTERLY OF THE SOUTHERLY LINE OF STATE HIGHWAY,

AND EXCEPT THE FOLLOWING DESCRIBED TRACTS:

AND EXCEPT THE FOLLOWING DESCRIBED PARCELS:

- 1) BEGINNING AT A POINT WHERE THE NORTH LINE OF SAID GOVERNMENT LOT 4 INTERSECTS THE COUNTY ROAD, NOW THE STATE HIGHWAY; THENCE SOUTH 60°42'30" WEST 365 FEET; THENCE SOUTH 30°38' EAST 201 FEET, MORE OR LESS, TO THE NORTHEAST BANK OF THE SKAGIT RIVER; THENCE NORTHEASTERLY ALONG THE NORTHERN BANK OF THE SKAGIT RIVER TO THE NORTH LINE OF SAID GOVERNMENT LOT 4; THENCE WEST TO THE POINT OF BEGINNING.
- 2) BEGINNING AT THE POINT WHERE THE NORTH LINE OF SAID LOT 4 INTERSECTS THE CENTERLINE OF THE COUNTY ROAD; THENCE IN A SOUTHWESTERLY DIRECTION 900 FEET ALONG THE CENTER OF SAID COUNTY ROAD; THENCE IN A SOUTHEASTERLY DIRECTION ALONG A LINE, WHICH IF PROJECTED TO THE NORTHWEST WOULD INTERSECT THE NORTHWEST CORNER OF LOT 4, TO THE SOUTHEASTERLY LINE OF SAID COUNTY ROAD AND THE TRUE POINT OF BEGINNING OF THIS CORNER OF LOT 4, THENCE CONTINUING SOUTHEASTERLY ALONG SAID PROJECTED LINE TO THE BANK OF THE SKAGIT RIVER; THENCE NORTHEAST ALONG THE BANK OF THE SKAGIT RIVER, A DISTANCE OF 150 FEET; THENCE NORTHWESTERLY TO A POINT ON THE SOUTHEASTERLY LINE OF SAID COUNTY ROAD THAT IS 273 FEET NORTHWESTERLY OF THE TRUE POINT OF BEGINNING; THENCE SOUTHWESTERLY ALONG THE SOUTHEASTERLY LINE OF SAID COUNTY ROAD, 273 FEET TO THE TRUE POINT OF BEGINNING.

PARCEL "B": A.F.#200210280170
A TRACT OF LAND IN GOVERNMENT LOT 4, SECTION 13, TOWNSHIP 35 NORTH, RANGE 10 EAST, W.M., MORE PARTICULARLY
DESCRIBED AS FOLLOWS:
AND LOT 4, INTERSECTING THE CENTERLINE OF THE COUNTY ROAD:

DESCRIBED AS FOLLOWS:
BEGINNING AT THE POINT WHERE THE NORTH LINE OF SAID LOT 4 INTERSECTS THE CENTERLINE OF THE COUNTY ROAD; THENCE IN A SOUTHWESTERLY DIRECTION 900 FEET ALONG THE CENTER OF SAID COUNTY ROAD; THENCE IN A SOUTHWESTERLY DIRECTION 900 FEET IF PROJECTED TO THE NORTHWEST WOULD INTERSECT THE NORTHWEST CORNER OF LOT 4; TO THE SOUTHWESTERLY LINE OF SAID COUNTY ROAD AND THE TRUE POINT OF BEGINNING OF THIS DESCRIPTION; THENCE CONTINUING SOUTHWESTERLY ALONG SAID PROJECTED LINE TO THE BANK OF THE SKAGIT RIVER; THENCE NORTHEASTLY ALONG THE BANK OF THE SKAGIT RIVER A DISTANCE OF 150 FEET; THENCE NORTHWESTERLY TO A POINT ON THE SOUTHWESTERLY LINE OF SAID COUNTY ROAD THAT IS 273 FEET NORTHERLY OF THE TRUE POINT OF BEGINNING; THENCE SOUTHWESTERLY ALONG THE SOUTHWESTERLY LINE OF SAID COUNTY ROAD 273 FEET TO THE TRUE POINT OF BEGINNING.

1. BASIS-OF-BEARINGS - ASSUMED S89°58'41"E ON THE NORTH LINE OF THE NORTHWEST QUARTER OF SECTION 13.

2. THIS SURVEY WAS ACCOMPLISHED BY FIELD TRAVERSE USING 5 SECOND OR BETTER DIGITAL ELECTRONIC TOTAL STATION, AND MEETS OR EXCEEDS THE STANDARDS CONTAINED IN WAC 352-150-090.
3. BOUNDARY SURVEYS REFLECT INFORMATION DISCOVERED BY THE SURVEYOR IN THE NORMAL COURSE OF WORK AND DO NOT NECESSARILY SHOW EVERY POSSIBLE CONDITION AFFECTING THE PROPERTY, EASEMENTS, RESTRICTIONS, AND OTHER ENCUMBRANCES MAY EXIST.

SET 1/2" x 18" REINFORCING ROD WITH
YELLOW PLASTIC CAP MARKED "SKA
SURV 17651" AND WHITE 2" x 2"
WITNESS STAKE.

○ FOUND REINFORCING ROD WITH YELLOW PLASTIC CAP L.S.#21591 AND SET WHITE 2" X 2" WITNESS STAKE.

ORDINARY HIGH WATER LINE OF THE SKAGIT RIVER

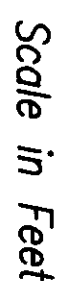

806 Metcalf St., Sedro-Woolley, WA 98284 Phone: (360) 855-2121 FAX: (360) 855-1658