

SURVEY DESCRIPTION

LOT 2 AND THE SOUTHERLY 10 FEET, AS MEASURED AT RIGHT ANGLES TO THE SOUTH LINE OF TRACT 1, OF THE PLAT OF "DRIFTWOOD TRACTS OF GUEMES ISLAND, SKAGIT CO., WASH.", AS PER PLAT RECORDED IN VOLUME 6 OF PLATS, PAGE 15, RECORDS OF SKAGIT COUNTY, WASHINGTON, SUBJECT TO AND TOGETHER WITH EASEMENTS, RESERVATIONS, RESTRICTIONS, COVENANTS, LIENS, LEASES, COURT CAUSES AND OTHER INSTRUMENTS OF RECORD.

SITUATE IN THE COUNTY OF SKAGIT, STATE OF WASHINGTON.

NOTES

- INDICATES REBAR SET AND CAPPED WITH YELLOW CAP INSCRIBED LIGSER 22460.
  - INDICATES EXISTING REBAR OR IRON PIPE FOUND.
- SURVEY DESCRIPTION IS FROM STATUTORY WARRANTY DEED DATED NOVEMBER 13, 2007 AND RECORDED UNDER SKAGIT COUNTY AUDITOR'S FILE NO. 20071120011.
- FOR ADDITIONAL MERIDIAN AND SURVEY INFORMATION SEE PLAT OF "DRIFTWOOD TRACTS OF GUEMES ISLAND, SKAGIT CO., WASH.", RECORDED IN VOLUME 6 OF PLATS, PAGE 15, AND RECORD OF SURVEY MAPS RECORDED UNDER AUDITOR'S FILE NUMBERS 8408300044, 901150003, 9202180064 AND 200003140052, ALL IN RECORDS OF SKAGIT COUNTY, WASHINGTON.
- BASIS OF BEARING: EXISTING FOUND SURVEY CONTROL POINTS IN THE CENTERLINE OF WEST SHORE DRIVE PER PREVIOUS SURVEYS REFERENCED IN NOTE 3.  
BEARING = SOUTH 12°31'00" WEST
- MERIDIAN: ASSUMED
- INSTRUMENTATION: LEICA TCR105A THEODOLITE DISTANCE METER
- SURVEY PROCEDURE: STANDARD FIELD TRAVERSE
- THIS SURVEY WAS PERFORMED AT THE REQUEST OF MARIAN J. THOMAS, A SINGLE INDIVIDUAL, FOR THE DELINEATION AND STAKING OF THE DESCRIBED PROPERTY, AS SHOWN HEREON.
- EXCEPT AS SPECIFICALLY STATED OR SHOWN ON THIS SURVEY MAP, THIS SURVEY DOES NOT PURPORT TO REFLECT ANY OF THE FOLLOWING, WHICH MAY BE APPLICABLE TO THE SUBJECT REAL ESTATE: EASEMENTS, BUILDING SETBACK LINES, RESTRICTIVE COVENANTS, SUBDIVISION RESTRICTIONS, ZONING, LIMITS OF TIDE/LAND OWNERSHIP, OR OTHER LAND-USE REGULATIONS AND FACTS THAT AN ACCURATE AND CURRENT TITLE SEARCH MAY DISCLOSE.
- THIS SURVEY HAS SHOWN OCCUPATIONAL INDICATORS (WOOD LANDSCAPE BORDER) AS PER WAC CHAPTER 332-130. LINES OF OCCUPATION MAY INDICATE AREAS FOR POTENTIAL CLAIMS OF UNWRITTEN OWNERSHIP. THIS BOUNDARY SURVEY HAS ONLY SHOWN THE RELATIONSHIP OF LINES OF OCCUPATION TO THE DEEDED LINES OF RECORD. NO RESOLUTION OF OWNERSHIP BASED ON UNWRITTEN RIGHTS HAS BEEN MADE OR IMPLIED BY THIS SURVEY.
- ALL DISTANCES SHOWN HEREON ARE IN FEET.
- THE LINE OF VEGETATION SHOWN HEREON REPRESENTS THE APPROXIMATE LINE OF ORDINARY HIGH TIDE THAT SHOULD BE UTILIZED FOR BUILDING SETBACK MEASUREMENT PURPOSES.

SURVEYOR'S CERTIFICATE

THIS MAP CORRECTLY REPRESENTS A SURVEY MADE BY ME OR UNDER MY DIRECTION IN CONFORMANCE WITH THE REQUIREMENTS OF THE SURVEY RECORDING ACT AT THE REQUEST OF MARIAN J. THOMAS, A SINGLE INDIVIDUAL, IN JANUARY 2008.



DATE: Feb 4, 2008

BRUCE G. LIGSER, PLS, CERTIFICATE NO. 22460  
LIGSER & ASSOCIATES, PLLC  
380 MILWAUKEE STREET  
P.O. BOX 1104  
MOUNT VERNON, WA 98273  
PHONE (360) 419-7442  
FAX (360) 419-0581  
E-MAIL BRUCE@LIGSER.COM

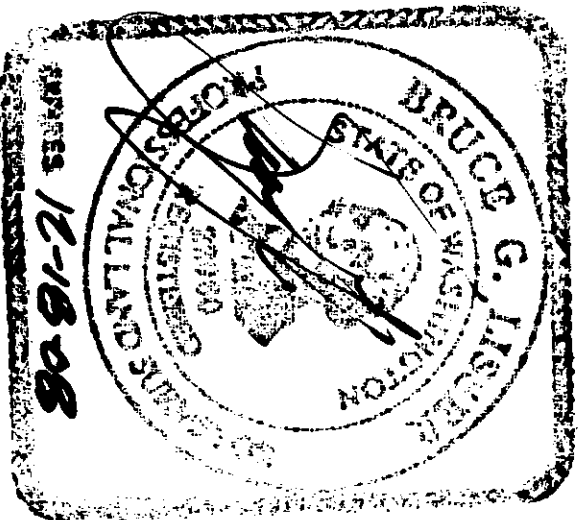

AUDITORS CERTIFICATE

FILED FOR RECORD AT THE REQUEST OF LIGSER & ASSOCIATES, PLLC.

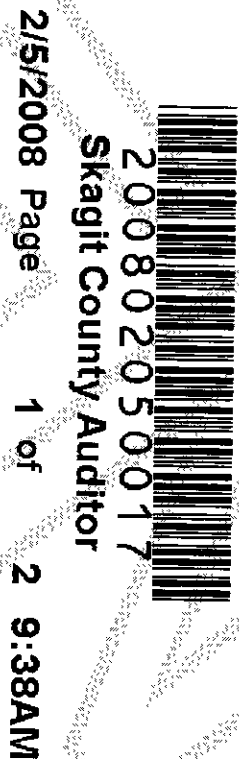

200802050017  
Skagit County Auditor  
2/5/2008 Page 1 of 2 9:38AM

J. Youngquist  
SKAGIT COUNTY AUDITOR

Armenian  
DEPUTY

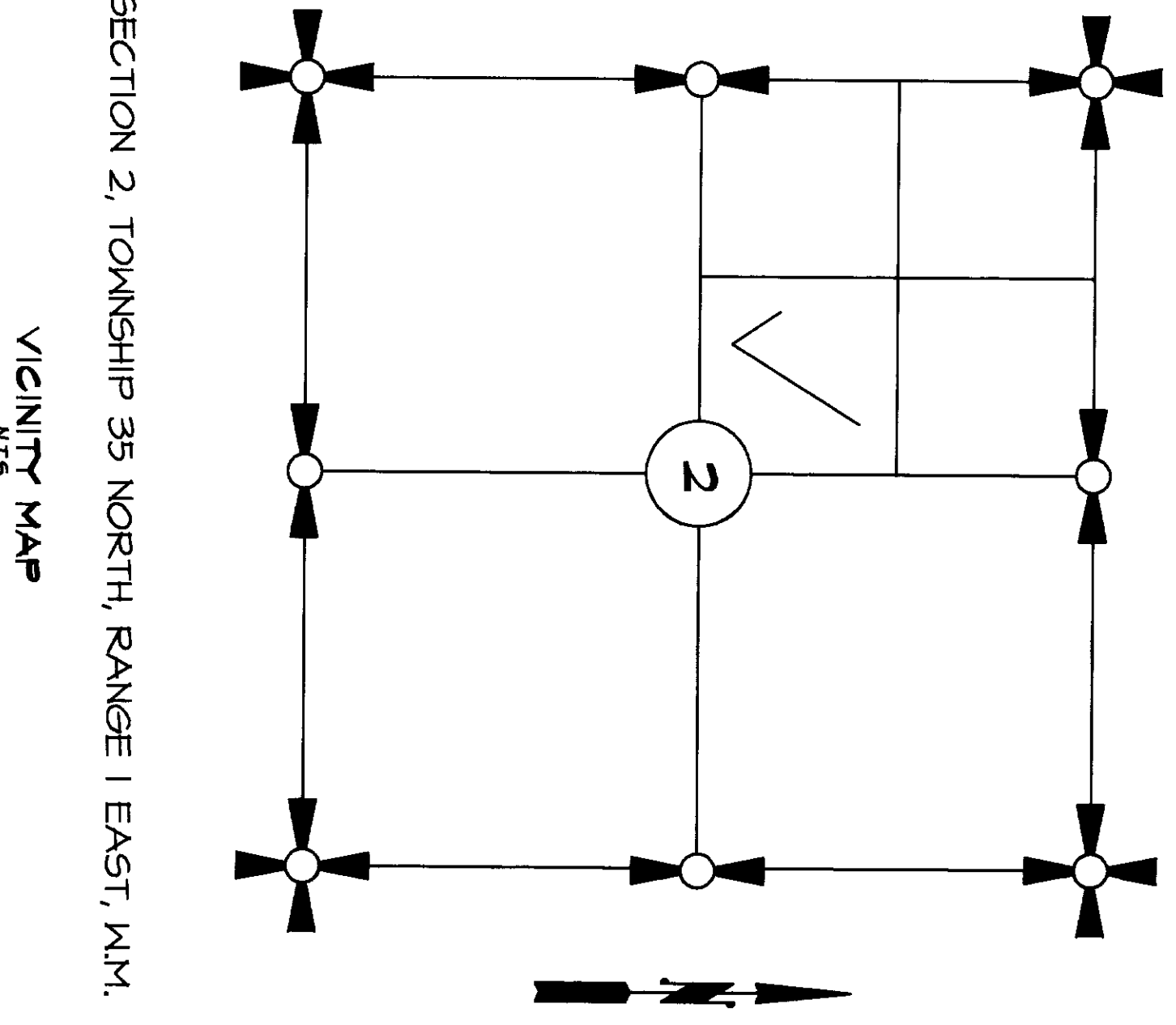

SHEET 1 OF 2

DATE: 2/5/08

SURVEY IN A PORTION OF GOVT LOT 4 SECTION 2, TOWNSHIP 35 NORTH, RANGE 1 EAST N.M., DRIFTWOOD TRACTS OF GUEMES ISLAND FOR: MARIAN THOMAS			
FB 245 PG 44	LIGSER & ASSOCIATES, PLLC	SCALE: N/A	
MERIDIAN: ASSUMED	SURVEYING & LAND-USE CONSULTATION MOUNT VERNON, WA 98273 360-419-7442	DRAWING: 08-007RDS	

