

**Lot 144, SURVEY OF SHELTER BAY, DIVISION NO. 2**  
**SURVEY in a portion of the SW 1/4 of**  
**Section 36, T. 34 N., R. 2 E. WM**

AUDITOR'S CERTIFICATE  
 200801090087  
 Skagit County Auditor  
 1/9/2008 Page 1 of 1 2:08PM  
**J. Youngquist**  
 COUNTY AUDITOR OR DEPUTY AUDITOR

**LEGAL DESCRIPTION**

LOT 144, "REVISED MAP OF SHELTER BAY DIV. 2, TRIBAL AND ALLOTTED LAND OF SWINOMISH INDIAN RESERVATIONS", AS RECORDED MARCH 17, 1970, IN VOLUME 43, PAGE 833 THROUGH 838, OF OFFICIAL RECORDS OF SKAGIT COUNTY, WASHINGTON, UNDER AUDITOR'S FILE NO. 737013, SITUATED IN SKAGIT COUNTY, WASHINGTON, TOGETHER WITH THE FOLLOWING DESCRIBED PARCEL: BEGINNING AT THE SOUTHERNMOST CORNER OF LOT 144; THENCE SOUTH, 53°30' 00" WEST TO THE LINE OF THE MEAN HIGH TIDE; THENCE NORTHWESTERLY ALONG THE LINE OF THE MEAN HIGH TIDE TO THE INTERSECTION WITH A LINE PROJECTED SOUTH 53°30' 00" WEST FROM THE WESTERMOST CORNER OF LOT 144; THENCE NORTH 53°30' 00" WEST TO THE WESTERMOST CORNER OF LOT 144; THENCE SOUTH, 36°30' 00" EAST A DISTANCE OF 70.00 FEET TO THE POINT OF BEGINNING, SUBJECT TO EASEMENT OF RECORD.

**NOTE**

1. SURVEY DESCRIPTION IS PER AUDITOR FILE NO. 200207010199
2. SURVEYOR MADE NO INVESTIGATION OR INDEPENDENT RESEARCH FOR EASEMENTS OF RECORD, ENCUMBRANCES, RESTRICTIVE COVENANTS, OWNERSHIP, TITLE EVIDENCE OR ANY OTHER FACTS THAT AN ACCURATE AND CURRENT TITLE SEARCH MAY DISCLOSE.

**SURVEY PROCEDURE**

FIELD TRAVERSE  
 LINEAR AND ANGULAR MEASUREMENTS MEET OR EXCEED STANDARDS SET IN WAC 332-130-090

**SURVEY INSTRUMENTATION**

TRIMBLE S-6 SERIAL 92710977, STD DEV 3", EDM +/- (3MM +2PPM).

**BASIS OF BEARING**

"REVISED MAP OF SHELTER BAY DIV. 2, TRIBAL AND ALLOTTED LAND OF SWINOMISH INDIAN RESERVATIONS", AS RECORDED MARCH 17, 1970, IN VOLUME 43, PAGE 833 THROUGH 838, OF OFFICIAL RECORDS OF SKAGIT COUNTY, WASHINGTON, UNDER AUDITOR'S FILE NO. 737013, SITUATED IN SKAGIT COUNTY, WASHINGTON.

**LEGEND**

- EXISTING REBAR
- EXISTING IRON PIPE
- 5/8" REBAR SET WITH YELLOW CAP MARKED DES LS 28023
- ▲ FOUND RAILROAD SPIKE

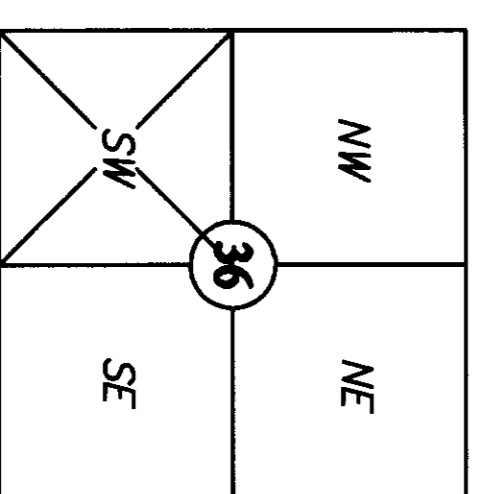
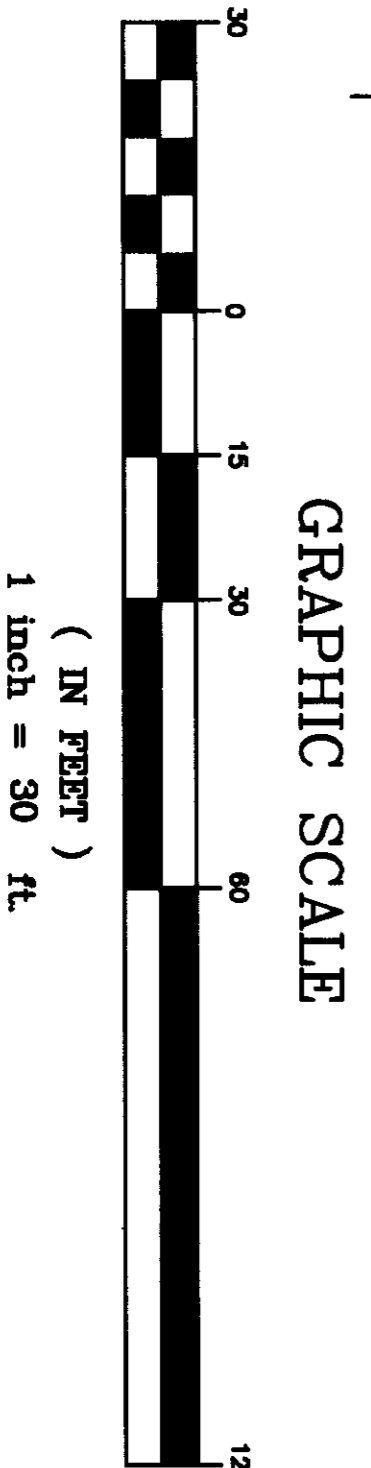
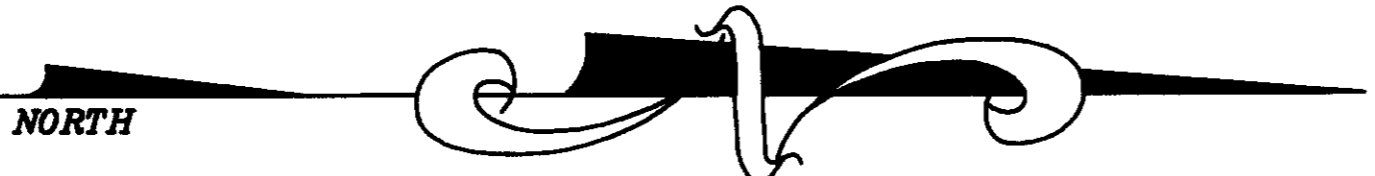

Section 36, T. 34 N., R. 2 E  
 Skagit County, Washington

**RECORD OF SURVEY**

Lot 144, SURVEY OF SHELTER BAY, DIVISION NO. 2  
 SURVEY in a portion of the SW 1/4 of  
 Section 36, T. 34 N., R. 2 E. WM  
 for:

**CLAUS DASSEL**

In Burlington, Washington

PROJECT 06045  
 DRAWING 06045  
 DRAWN BY RLY  
 CHECKED BY DES  
 DATE DEC 2007  
**SHEET 1 OF 1**

**NORTHWEST DATUM & DESIGN**  
 CIVIL ENGINEERING AND SURVEYING SOLUTIONS

1128 E. FAIRHAVEN AVE  
 BURLINGTON, WASHINGTON 98233  
 PH: (360) 755-0434 FAX: (360) 755-0464



**SURVEYOR'S CERTIFICATE**  
 THIS MAP CORRECTLY REPRESENTS A SURVEY MADE BY ME OR UNDER MY DIRECTION IN CONFORMANCE WITH THE REQUIREMENTS OF THE SURVEY RECORDING ACT AT THE REQUEST OF:  
 IN DATE 20.09  
 CERTIFICATE NO. 28023

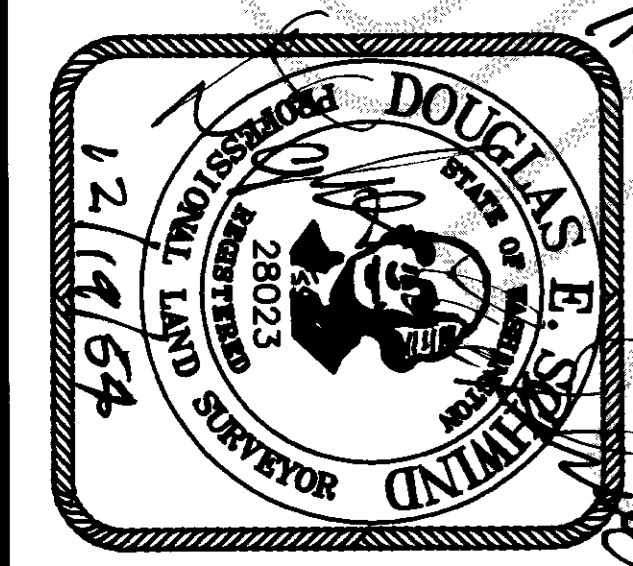

**SURVEYOR'S CERTIFICATE**  
 THIS MAP CORRECTLY REPRESENTS A SURVEY MADE BY ME OR UNDER MY DIRECTION IN CONFORMANCE WITH THE REQUIREMENTS OF THE SURVEY RECORDING ACT AT THE REQUEST OF:  
 IN DATE 20.09  
 CERTIFICATE NO. 28023