

Cased Monument  
Street Intersection Per Plat  
of Pleasant View, AFN  
200505250134 bears  
S05°56'58"E 0.93

N00°34'33"E  
47.64

200712070026  
Skagit County Auditor  
12/7/2007 Page 1 of 1 11:11:00AM

Skagit County Auditor  
Auditor's Certificate

Jennyquist  
Auditor's Certificate

28th Street

(A) Cased Monument (typical)  
N89°24'42"W  
227.90

Rebar & Cap,  
LS 21591

Monument found  
disturbed. Set  
Rebar & Cap,  
LS 24535

N00°00'16"W  
0.34

S89°20'19"E  
147.53

Water Valve

Catch  
Basin

Rebar & Cap,  
LS 24535

107.07

Rebar & Cap, LS 21591,  
Record Corner Bears  
S83°02'42"E 0.19

N89°24'42"W  
94.40

16th Line and west boundary of  
"Pleasant Slope Addition" per  
Volume 18, Surveys, Page 19

Block 179, per "Map  
of the City of  
Anacortes, Volume  
2, Plats, Page 5

Block 15, Lots 17 through 20  
E58674  
10650 Sq. Ft.  
0.24 Ac.

sidewalk

pavement

Light

### Property Description

Auditor's File Number 9308270054, Parcel C

Lots 17 through 20, inclusive, Block 15, "Pleasant Slope Addition to the City of Anacortes," as per plat recorded in Volume 1 of Plats, page 40, records of Skagit County, Washington.

Situate in the City of Anacortes, County of Skagit, State of Washington.

(No easements in the property have been disclosed at the time of survey.)

### Basis of Bearings

Volume 18, Surveys, Page 19

N00°35'18"E  
296.17

D Avenue

29th Street

(B) S00°35'18"W  
19.00

S89°24'32"E  
231.15

N00°00'14"W  
58.15 (Plat)

Rebar & Cap, LS 21591,  
Southwest corner Lot 20  
bears N80°14'40"W 0.34

105.91

Rebar & Cap,  
LS 24535

N89°20'19"W

105.91

Rebar & Cap,  
LS 24535

105.91

Rebar & Cap,  
LS 24535

105.91

Rebar & Cap,  
LS 24535

105.91

Rebar & Cap,  
LS 24535

105.91

Rebar & Cap,  
LS 24535

105.91

Rebar & Cap,  
LS 24535

105.91

Rebar & Cap,  
LS 24535

### Survey Notes

This survey has been prepared from a closed random traverse using an electronic instrument measuring angles to 3 seconds of arc and distances rounded to hundredths of feet.

The purpose of this survey has been to locate, describe and to set monuments to mark the existing lines and corners of the above described property.

Boundaries of the surveyed parcel are based on the following:

1. Monuments labeled A, B, C and D.
2. Dimensions and method of boundary determinations shown on Volume 18, Surveys, Page 19.
3. As noted the monuments found along E Avenue agree with the record north-south alignment but appear to be displaced north.

### Record of Survey



Graphic Scale  
0 15 30 60  
1 inch = 30 feet

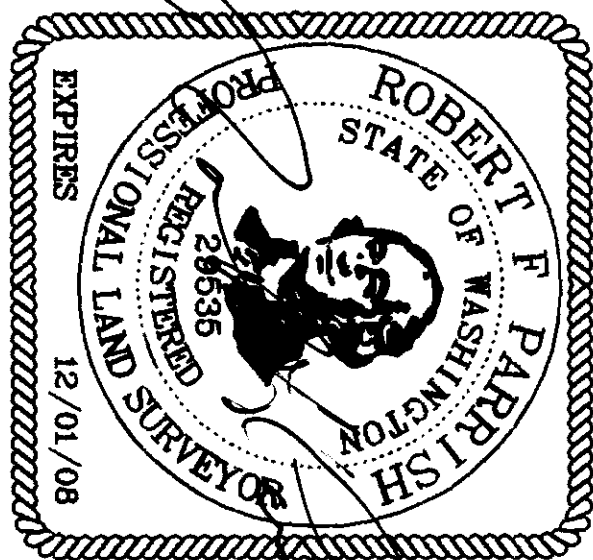

### Surveyor's Certificate

This map correctly represents a survey made by me or under my direction in conformance with the requirements of the Survey Recording Act at the request of Rick and Michelle Guttormson owners of property in Skagit County, Washington in November, 2007.

Signature of Surveyor

Certificate No. 24535

FILE NAME: 710-389			
SCALE: 1" = 50'			
DATE OF PLAN: 11-8-07			
DRAWN BY: RFP			
F.B. No. 19			
QUARTER	SECTION	TOWNSHIP	RANGE
SW	24	35N	1E

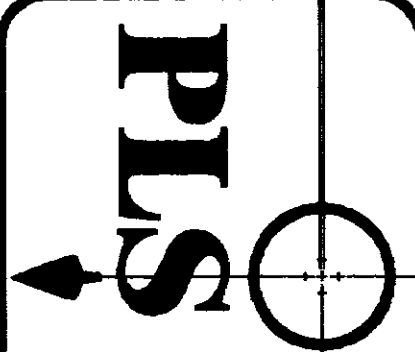

Parish Land Surveying, Inc.  
Rick and Michelle  
Guttormson  
142 Blossom Lane, Port Townsend, Wa. 98368  
Anacortes (360) 588-1467 email parishland@parishland.com