

Return Name & Address:



200710050129

Skagit County Auditor

10/5/2007 Page 1 of 2 3:27PM

SKAGIT COUNTY PLANNING & DEVELOPMENT SERVICES

**LOT OF RECORD CERTIFICATION**

File Number: PL\_07-0796

Applicant Name: \_ Eagle's Nest Community, Inc.

Property Owner Name: same

Having reviewed the information provided by the applicant, the Department hereby finds that the parcel(s) bearing Skagit County Parcel Number(s):

P#(s): \_126665; 330202-0-000-2300; within a Ptn of the SE ¼ of Sec. 2 Twp. 33, Rge 2.  
Tract B, eagles Nest Short Plat 116-77, AF 858833.

Lot Size: \_approximately 2.7 acres

**1. CONVEYANCE**

- ☒ **IS**, a Lot of Record as defined in Skagit County Code (SCC) 14.04.020 or owned by an innocent purchaser who has met the requirements described in SCC 14.18.000(9) and RCW 58.17.210 and therefore IS eligible for conveyance.
- ☐ **IS NOT**, a Lot of Record as defined in SCC 14.04.020 or owned by an innocent purchaser who has met the requirements described in SCC 14.18.000(9) and RCW 58.17.210 and therefore IS NOT eligible for conveyance or development.

**2. DEVELOPMENT**

- ☒ **IS**, the minimum lot size required for the Urban Growth Area to LaConner zoning district in which the lot is located and therefore IS eligible to be considered for development permits.
- IS NOT**, the minimum lot size required for the \_\_\_\_\_ zoning districts in which the lot is located, but does meet an exemption listed in SCC 14.16.850(4)(c)(vii)(A) and therefore IS eligible to be considered for development permits.
- IS NOT**, the minimum lot size required for the \_\_\_\_\_ zoning district in which the lot is located, does not meet an exemption listed in SCC 14.16.850(4)(c) and therefore IS NOT eligible to be considered for certain development permits.

Authorized Signature: \_\_\_\_\_

See attached map for Lot of Record boundaries.

Date: \_10/05/2007

**ATTENTION**

THIS MAP CONTAINS A PARCEL ACCOUNT  
THAT HAS BEEN PLACED WITH THE  
BEST AVAILABLE INFORMATION. THE  
EXACT LOCATION OF THIS PARCEL  
IS UNKNOWN.

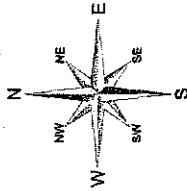

Scale in feet

These maps were created from on-site public records and existing map sources, not from field surveys. Map features from all sources have been adjusted to achieve a "best fit" registration to the Osmersburg Forests map. While great care was taken in this process, many from different sources may not be perfectly aligned. The maps may vary slightly on the location of map features. The resulting positions of map features to one another results from combining different map sources without field "ground truthing."

	DATE	INIT.
DRAWN BY	7-25-95	LHS
REVISED	10/04/06	RS
PLOTTED	10/04/06	RS
MAP PRODUCED BY SKAGIT COUNTY MAPPING SERVICES		

Section 2  
T 33 N R 02 E

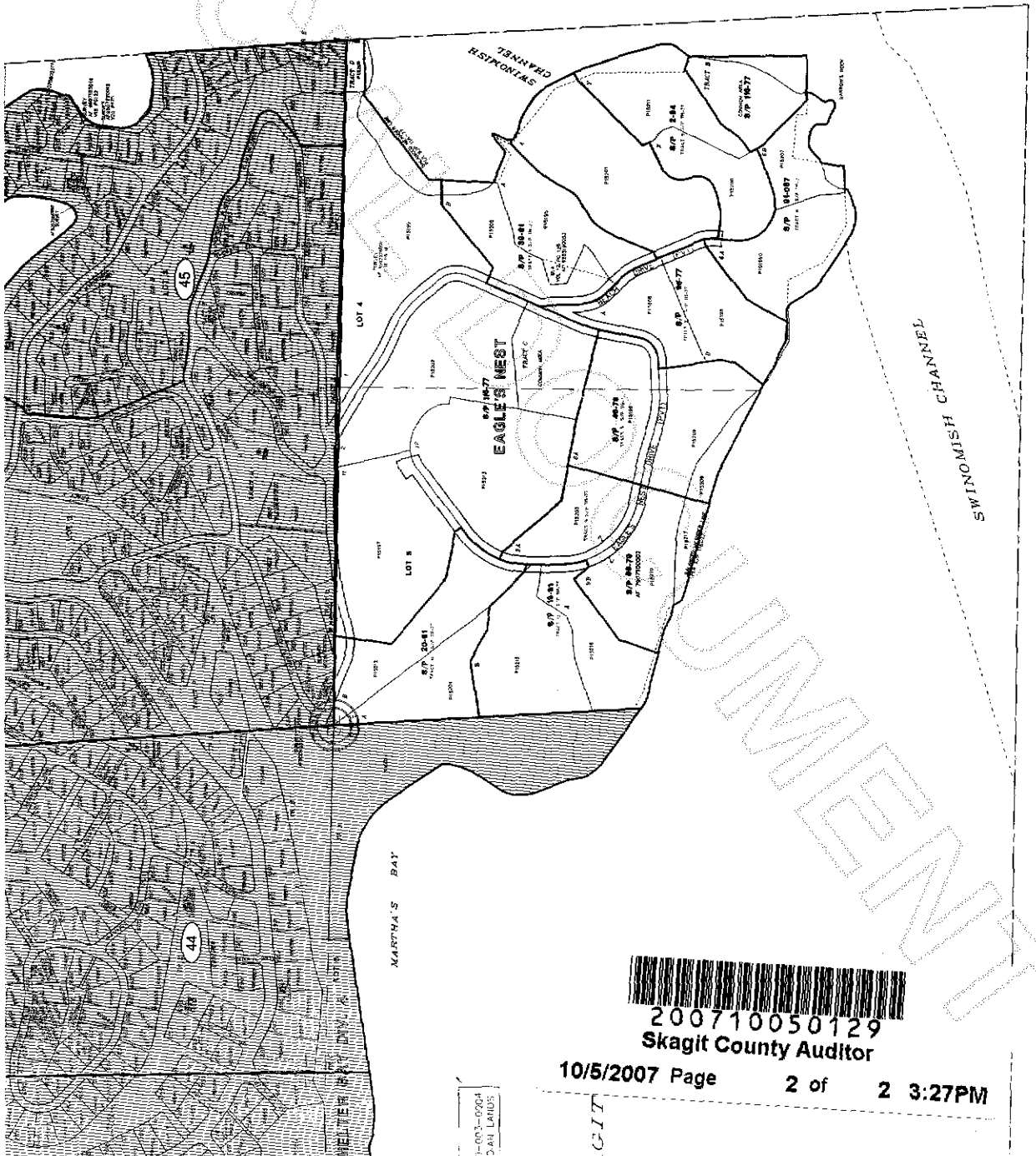

10/5/2007 Page

2 of

**2 3:27PM**

0-003-0204  
DAN LANDS