

Return Name & Address:



200710050128

Skagit County Auditor

10/5/2007 Page 1 of 2 3:27PM

SKAGIT COUNTY PLANNING & DEVELOPMENT SERVICES

LOT OF RECORD CERTIFICATION

File Number: PL_07-0795

Applicant Name: _ Eagle's Nest Community, Inc.

Property Owner Name: same

Having reviewed the information provided by the applicant, the Department hereby finds that the parcel(s) bearing Skagit County Parcel Number(s):

P#(s): _126666; 330202-0-000-2400; within a Ptn of the SE ¼ of Sec. 2 Twp. 33, Rge 2.
Tract C, eagles Nest Short Plat 116-77, AF 858833.

Lot Size: _approximately 2.3 acres

1. CONVEYANCE

- ☒ **IS**, a Lot of Record as defined in Skagit County Code (SCC) 14.04.020 or owned by an innocent purchaser who has met the requirements described in SCC 14.18.000(9) and RCW 58.17.210 and therefore IS eligible for conveyance.
- ☐ **IS NOT**, a Lot of Record as defined in SCC 14.04.020 or owned by an innocent purchaser who has met the requirements described in SCC 14.18.000(9) and RCW 58.17.210 and therefore IS NOT eligible for conveyance or development.

2. DEVELOPMENT

- ☒ **IS**, the minimum lot size required for the Urban Growth Area to LaConner zoning district in which the lot is located and therefore IS eligible to be considered for development permits.

IS NOT, the minimum lot size required for the _____ zoning districts in which the lot is located, but does meet an exemption listed in SCC 14.16.850(4)(c)(vii)(A) and therefore IS eligible to be considered for development permits.

IS NOT, the minimum lot size required for the _____ zoning district in which the lot is located, does not meet an exemption listed in SCC 14.16.850(4)(c) and therefore IS NOT eligible to be considered for certain development permits.

Authorized Signature: _____

David Roeder

Date: _10/05/2007

See attached map for Lot of Record boundaries.

THIS MAP CONTAINS A PARCEL ACCOUNT THAT HAS BEEN PLACED WITH THE BEST AVAILABLE INFORMATION. THE EXACT LOCATION OF THIS PARCEL IS UNKNOWN.

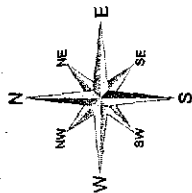

Scale in feet



These maps were created from available public records and existing map sources, not from field surveys. Map features from all sources have been adjusted to achieve a "best fit" realization to the Ownership Parcel map. While great care was taken in this process, maps from different sources rarely agree as to the precise location of geographic features. The relative positioning of map features to one another may differ slightly from the results to one another resulting from combining different maps without field "ground truthing".

	DATE	INIT.
DRAWN BY	7-25--95	LHS
REVISED	10/04/06	RS
PLOTTED	10/04/06	RS
MAP PRODUCED BY ERACIT		

Section 2

T 33 N R 02 E

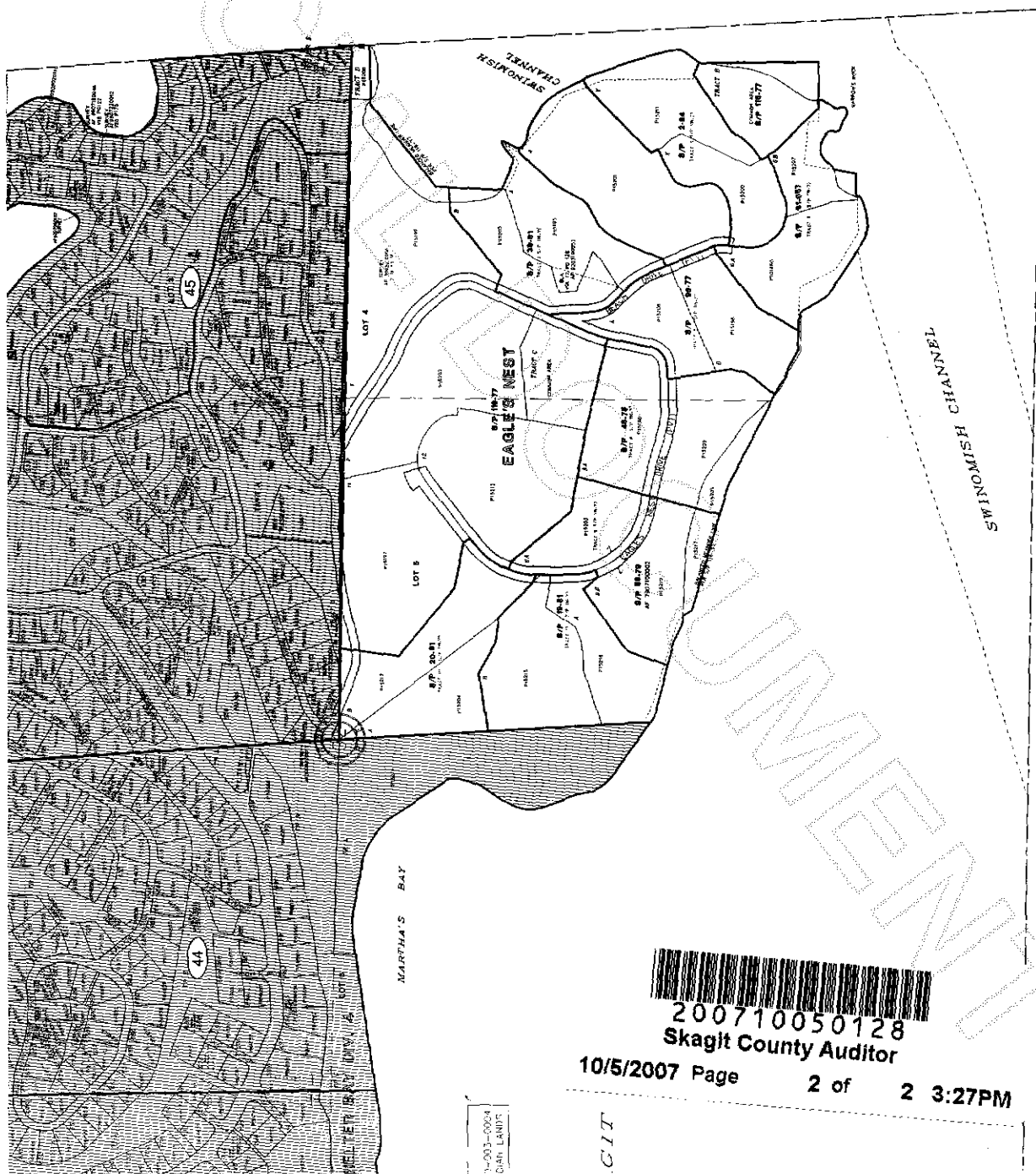

10/5/2007 Page

2 of

2 3:27PM

CIT

CLARK LANDS
1-203-0004