

FOUND 2" IRON PIPE WITH
PLUG AND NAIL ON 4/22/04.

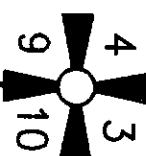

Notes

1. BASIS-OF-BEARINGS - ASSUMED S00°32'37"W ON THE WEST LINE OF THE NORTHWEST QUARTER OF SECTION 10.
2. THIS SURVEY WAS ACCOMPLISHED BY FIELD TRAVERSE USING: 5 SECOND OR BETTER DIGITAL ELECTRONIC TOTAL STATION, AND MEETS OR EXCEEDS THE STANDARDS CONTAINED IN WAC 332-130-090.
3. THE PROPERTY DESCRIBED HEREIN HAS BEEN COMBINED OR AGGREGATED WITH CONTIGUOUS PROPERTY OWNED BY THE GRANTEE. THIS LOT BOUNDARY LINE ADJUSTMENT IS NOT FOR THE PURPOSE OF CREATING ADDITIONAL LOTS. THIS LOT BOUNDARY LINE ADJUSTMENT IS MADE FOR THE SOLE PURPOSE OF ADJUSTING THE BOUNDARIES OF LOTS 1 AND 2, BLOCK 5, EVERETT'S SECOND ADDITION TO CONCRETE AS SHOWN HEREIN.

RECORD OF SURVEY FOR BOUNDARY LINE ADJUSTMENT OF LOTS IN BLOCK 5 OF THE PLAT OF EVERETT'S SECOND ADDITION TO CONCRETE, (in the SW1/4 of the NW1/4 of Section 10, Twp. 35 N., Rng. 8 E., W.M.)

Legal Descriptions Before Boundary Line Adjustment

LOT 1 BEFORE BOUNDARY LINE ADJUSTMENT

LOT 1, BLOCK 5, EVERETT'S SECOND ADDITION TO CONCRETE, SKAGIT COUNTY, WASH., AS PER PLAT RECORDED IN VOLUME 4 OF PLATS, PAGE 13, RECORDS OF SKAGIT COUNTY, WASHINGTON.

LOT 2 BEFORE BOUNDARY LINE ADJUSTMENT

LOT 2, BLOCK 5, EVERETT'S SECOND ADDITION TO CONCRETE, SKAGIT COUNTY, WASH., AS PER PLAT RECORDED IN VOLUME 4 OF PLATS, PAGE 13, RECORDS OF SKAGIT COUNTY, WASHINGTON.

Legal Descriptions After Boundary Line Adjustment

LOT 1 AFTER BOUNDARY LINE ADJUSTMENT

LOT 1 AND LOT 2, BLOCK 5, EVERETT'S SECOND ADDITION TO CONCRETE, SKAGIT COUNTY, AS PER PLAT RECORDED IN VOLUME 4 OF PLATS AT PAGE 13, RECORDS OF SKAGIT COUNTY, WASHINGTON.

EXCEPT BEGINNING AT THE SOUTHEAST CORNER OF LOT 1, BLOCK 5, OF SAID EVERETT'S SECOND ADDITION TO CONCRETE, THENCE N 89°42'18" W ALONG THE SOUTH LINE OF SAID LOT 1, A DISTANCE OF 20.00 FEET; THENCE N 45°17'25" E, A DISTANCE OF 14.14 FEET; THENCE N 00°17'08" E, A DISTANCE OF 55.00 FEET; THENCE N 89°42'18" W, A DISTANCE OF 90.25 FEET; THENCE N 00°32'37" E, A DISTANCE OF 65.74 FEET TO A POINT ON A NON-TANGENT CURVE FROM WHICH THE RADIUS POINT BEARS N 08°21'58" E, A DISTANCE OF 75.00 FEET; THENCE EASTERLY ALONG SAID CURVE THROUGH A CENTRAL ANGLE OF 80°41'17" AND AN ARC DISTANCE OF 105.57 FEET; THENCE S 89°42'18" E, A DISTANCE OF 64.43 FEET TO THE POINT OF CURVATURE OF A CURVE TO THE RIGHT HAVING A RADIUS OF 25.00 FEET; THENCE EASTERLY, SOUTHEASTERLY, AND SOUTHERLY ALONG SAID CURVE THROUGH A CENTRAL ANGLE OF 89°59'26" AND AN ARC DISTANCE OF 39.27 FEET TO A POINT ON THE EAST LINE OF SAID LOT 1 WHICH IS 105.00 FEET FROM THE SOUTHEAST CORNER THEREOF; THENCE S 01°17'08" W ALONG THE EAST LINE OF SAID LOT 1, A DISTANCE OF 105.00 FEET TO THE POINT OF BEGINNING OF THIS DESCRIPTION.

LOT 2 AFTER BOUNDARY LINE ADJUSTMENT

BEGINNING AT THE SOUTHEAST CORNER OF LOT 1, BLOCK 5, EVERETT'S SECOND ADDITION TO CONCRETE, SKAGIT COUNTY, AS PER PLAT RECORDED IN VOLUME 4 OF PLATS AT PAGE 13, RECORDS OF SKAGIT COUNTY, WASHINGTON; THENCE N 89°42'18" W ALONG THE SOUTH LINE OF SAID LOT 1, A DISTANCE OF 20.00 FEET; THENCE N 45°17'25" E, A DISTANCE OF 14.14 FEET; THENCE N 00°17'08" E, A DISTANCE OF 55.00 FEET; THENCE N 89°42'18" W, A DISTANCE OF 90.25 FEET; THENCE N 00°32'37" E, A DISTANCE OF 65.74 FEET TO A POINT ON A NON-TANGENT CURVE FROM WHICH THE RADIUS POINT BEARS N 08°21'58" E, A DISTANCE OF 75.00 FEET; THENCE EASTERLY ALONG SAID CURVE THROUGH A CENTRAL ANGLE OF 80°41'17" AND AN ARC DISTANCE OF 105.57 FEET; THENCE S 89°42'18" E, A DISTANCE OF 64.43 FEET TO THE POINT OF CURVATURE OF A CURVE TO THE RIGHT HAVING A RADIUS OF 25.00 FEET; THENCE EASTERLY, SOUTHEASTERLY, AND SOUTHERLY ALONG SAID CURVE THROUGH A CENTRAL ANGLE OF 89°59'26" AND AN ARC DISTANCE OF 39.27 FEET TO A POINT ON THE EAST LINE OF SAID LOT 1 WHICH IS 105.00 FEET FROM THE SOUTHEAST CORNER THEREOF; THENCE S 01°17'08" W ALONG THE EAST LINE OF SAID LOT 1, A DISTANCE OF 105.00 FEET TO THE POINT OF BEGINNING OF THIS DESCRIPTION.

Consent

THE UNDERSIGNED AGREE THAT THE BOUNDARY LINE ADJUSTMENT SET FORTH HEREIN IS MADE WITH THE FREE CONSENT AND IN ACCORDANCE WITH THE TERMS OF THE OWNERS

Richard Johnson

Acknowledgments

STATE OF WASHINGTON, COUNTY OF SKAGIT
I CERTIFY THAT I KNOW OR HAVE SATISFACTORY EVIDENCE THAT RICHARD JOHNSON, SIGNED THIS INSTRUMENT AND ACKNOWLEDGED IT TO BE HIS FREE AND VOLUNTARY ACT FOR THE USES AND PURPOSES MENTIONED IN THE INSTRUMENT.

NOTARY SIGNATURE *[Signature]* TITLE **Notary**

DATE **AUG. 22, 2007** MY APPOINTMENT EXPIRES **NOV. 1, 2007**

Approvals

THE WITHIN AND FOREGOING BOUNDARY LINE ADJUSTMENT HAS BEEN EXAMINED AND IS HEREBY APPROVED THIS **13th** DAY OF **AUGUST**, 2007

[Signature]
LARRY L. JOHNSON, Notary Public

FOUND CONCRETE MONUMENT WITH BRASS PIN IN CASE & COVER AT RETZLE AVENUE AND MAIN STREET ON 11/19/79.

FOUND CONCRETE MONUMENT WITH BRASS PIN 1.8" DEEP ON 12/7/79.

FOUND 1" IRON PIPE WITH PLUG AND NAIL IN CASE AND COVER AT SUPERIOR AVENUE AND MAIN STREET ON 11/19/79.

Legend

- 1/2" x 18" REINFORCING ROD WITH YELLOW PLASTIC CAP MARKED "SKA SURV. 17651" AND WHITE 2" x 2" WITNESS STAKE TO BE SET.

PROPERTY LINES BEFORE BOUNDARY LINE ADJUSTMENT
PROPERTY LINES AFTER BOUNDARY LINE ADJUSTMENT

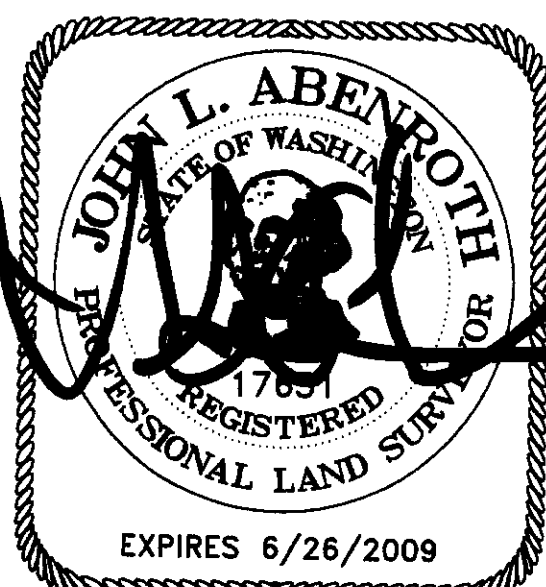
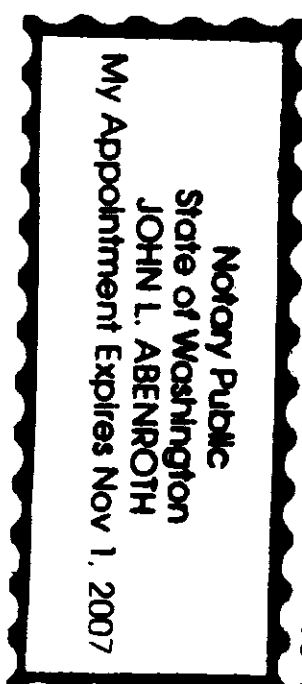

SURVEYOR'S CERTIFICATE
This map correctly represents a survey made by me or under my direction in conformance with the Survey Recording Act in August 2007 at the request of Richard Johnson.

John L. Abernethy CERT#17651
Date **8/10/07**

AUDITOR'S CERTIFICATE



200708140131
Skagit County Auditor
8/14/2007 Page 1 of 1 2:27PM

[Signature]
County Auditor or Deputy Auditor



806 Metcalf St., Sedro-Woolley, WA 98284 Phone: (360) 855-2121 FAX: (360) 855-1658

DATE	REVISION	BY	JOB#	DRAWN	STN	CHECKED	JLG	DATE	SCALE	SHEET
			206080A					07AUG07	1" = 50'	1 OF 1

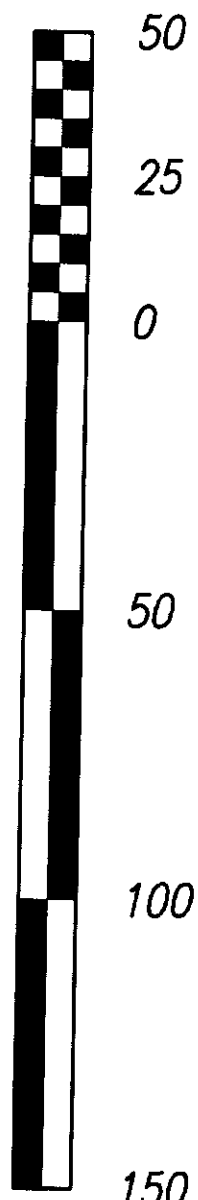

Scale in Feet