

EMPIRE CONDOMINIUMS, A CONDOMINIUM
SURVEY MAP AND PLANS
PORTION OF THE W 1/2 OF SECTION 18, T.35 N. R.2 E. WM

AUDITORS CERTIFICATE
FILED FOR RECORD AT THE REQUEST OF SOUND DEVELOPMENT GROUP, LLC

J. Youngquist
SKAGIT COUNTY AUDITOR
DEPUTY

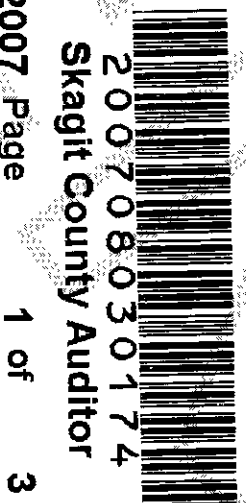

200708030174
Skagit County Auditor
8/3/2007 Page 1 of 3 3:57PM

DEDICATION

KNOW ALL PERSONS BY THESE PRESENTS THAT THE UNDERSIGNED KING SQUARED, LLC, THE OWNER OF THE LEASHOOLD INTEREST IN THE PROPERTY SHOWN, HEREBY DECLARES THIS SURVEY MAP AND PLANS FOR CONDOMINIUM PURPOSES AND NOT FOR ANY PUBLIC PURPOSES.

THE UNDERSIGNED FURTHER CERTIFIES THAT ALL STRUCTURAL COMPONENTS AND MECHANICAL SYSTEMS OF ALL BUILDINGS CONTAINING ANY UNITS HEREBY CREATED ARE SUBSTANTIALLY COMPLETED.

THIS SURVEY MAP AND PLANS AND ANY PORTION THEREOF ARE RESTRICTED BY LAW AND THE DECLARATION FOR "EMPIRE CONDOMINIUMS" CONDOMINIUM, RECORDED UNDER SKAGIT COUNTY AUDITORS FILE NO. 200-1080501-15, SKAGIT COUNTY WASHINGTON.

Walter D. King II
KING SQUARED, LLC
BY: *Walter D. King II* MANAGING MEMBER

ACKNOWLEDGMENT FOR SURVEYOR

STATE OF WASHINGTON)
COUNTY OF Skagit) SS.

I CERTIFY THAT I KNOW OR HAVE SATISFACTORY EVIDENCE THAT DENNIS J. ALBRIGHT IS THE PERSON WHO APPEARED BEFORE ME AND SAID PERSON ACKNOWLEDGED THAT HE SIGNED THIS INSTRUMENT AND ACKNOWLEDGED IT TO BE HIS FREE AND VOLUNTARY ACT FOR THE USES AND PURPOSES MENTIONED IN THE INSTRUMENT.

DATED Aug 1, 2007.

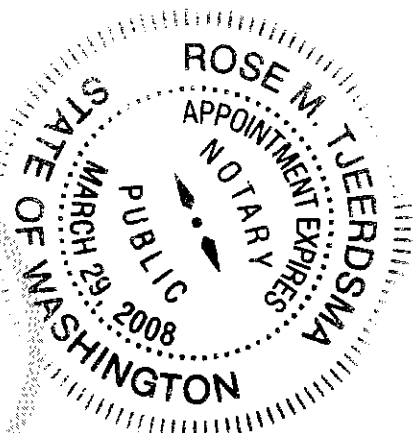

Rose M. Tiesedra
NOTARY PUBLIC IN AND FOR THE STATE OF WASHINGTON
(NOTARY NAME TO BE PRINTED)
RESIDING AT Burlington
MY APPOINTMENT EXPIRES 3/23/2008

SURVEYOR'S CERTIFICATE

THIS MAP CORRECTLY REPRESENTS A SURVEY MADE BY ME OR UNDER MY DIRECTION IN CONFORMANCE WITH THE REQUIREMENTS OF THE SURVEY RECORDING ACT AT THE REQUEST OF KING SQUARED, LLC.

I HEREBY CERTIFY THAT THIS SURVEY MAP AND PLANS FOR "EMPIRE CONDOMINIUMS, A CONDOMINIUM ARE BASED UPON AN ACTUAL SURVEY OF THE PROPERTY HEREIN DESCRIBED; THAT THE BEARINGS AND DISTANCES ARE CORRECTLY SHOWN; THAT ALL INFORMATION REQUIRED BY RCW 64.34.232 IS SUPPLIED HEREIN; AND THAT ALL HORIZONTAL AND VERTICAL BOUNDARIES OF SUCH UNITS ARE SUBSTANTIALLY COMPLETED IN ACCORDANCE WITH SAID PLANS.

Dennis J. Albright
DENNIS J. ALBRIGHT, PLS DATE 8-1-07
REGISTERED PROFESSIONAL LAND SURVEYOR
CERTIFICATE NO. 17652

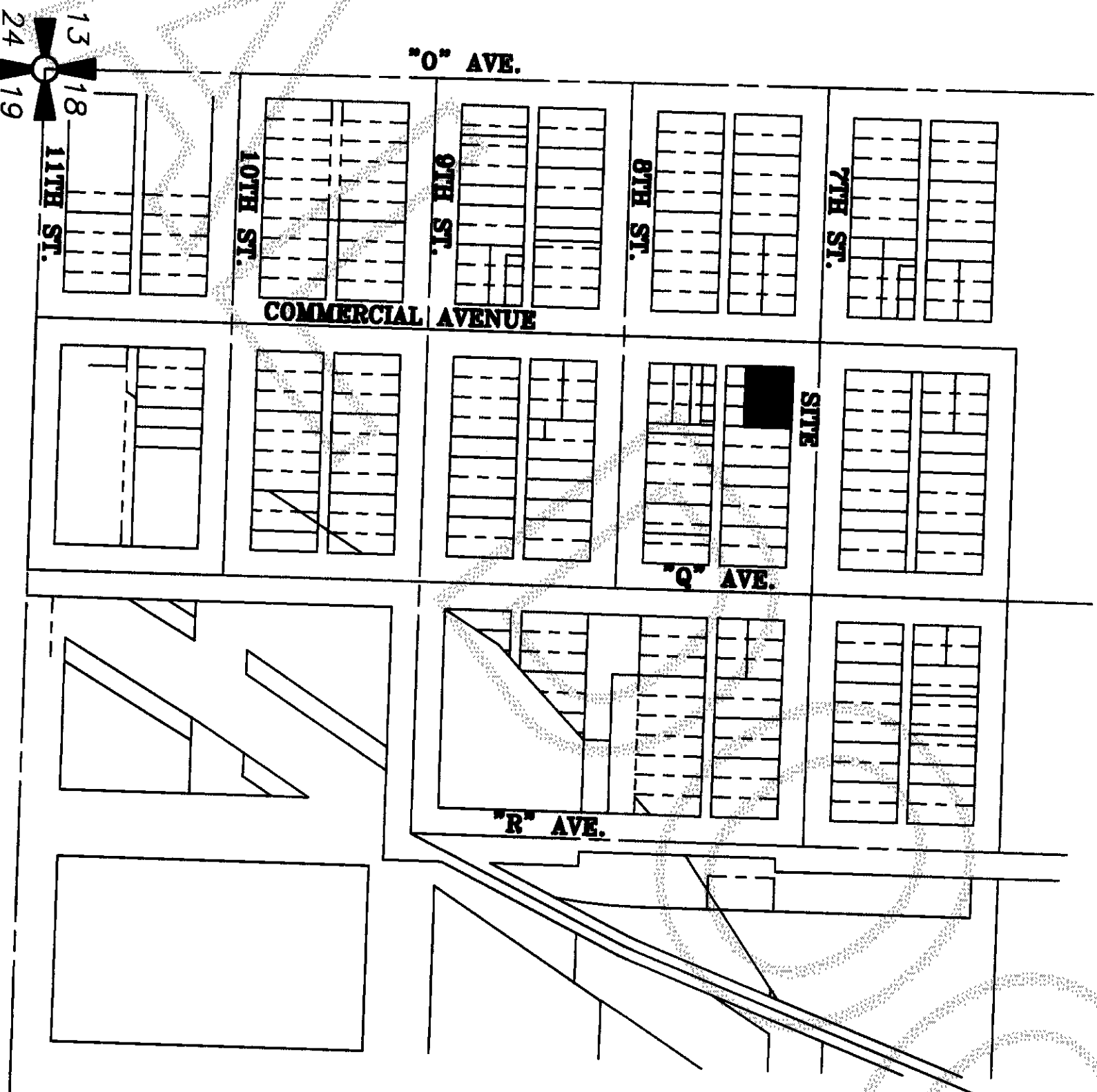

VICINITY MAP

PORTION OF THE W 1/2 OF SECTION 18, T.35 N. R.2 E. WM

LEGAL DESCRIPTION

THE NORTH 70 FEET OF LOTS 8, 9 AND 10, BLOCK 21, "MAP OF THE CITY OF ANACORTES, SKAGIT COUNTY, WASHINGTON", AS PER PLAT RECORDED IN VOLUME 2 OF PLATS, PAGE 4, RECORDS OF SKAGIT COUNTY WASHINGTON.

SITUATE IN THE CITY OF ANACORTES, COUNTY OF SKAGIT, STATE OF WASHINGTON.

(LEGAL DESCRIPTION IS BASED ON TITLE REPORT FROM LAND TITLE COMPANY OF SKAGIT COUNTY, POLICY NO. 124915-SAE, DATED MARCH 1, 2007)

ACKNOWLEDGMENT

STATE OF WASHINGTON)
COUNTY OF Skagit) SS.

ON THIS 3rd DAY OF August, 2007, PERSONALLY APPEARED BEFORE ME Linda Dale King II, TO ME KNOWN TO BE A MANAGING MEMBER OF THE LIMITED LIABILITY COMPANY THAT ENJOINED THE WITHIN AND FOREGOING INSTRUMENT, AND, ACKNOWLEDGED THE SAID INSTRUMENT TO BE THE FREE AND VOLUNTARY ACT AND DEED OF SAID LIMITED LIABILITY COMPANY, FOR THE USES AND PURPOSES THEREIN MENTIONED AND ON OATH STATED THAT (HE) / SHE WAS AUTHORIZED TO EXECUTE THE SAID INSTRUMENT.

IN WITNESS WHEREOF, I HAVE HEREUNTO SET MY HAND AND OFFICIAL SEAL THIS 3rd DAY OF August, 2007.

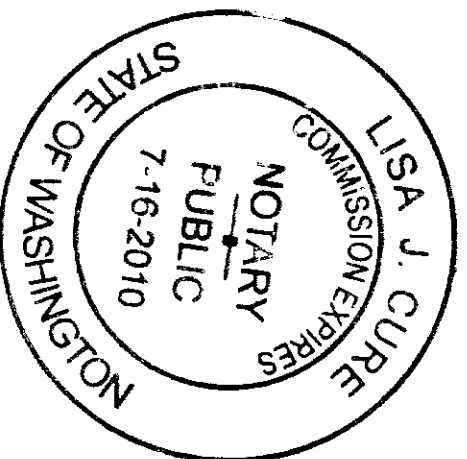

Lisa J. Cure
NOTARY PUBLIC IN AND FOR THE STATE OF WASHINGTON
(NOTARY NAME TO BE PRINTED)
RESIDING AT Bow
MY APPOINTMENT EXPIRES 7/16/2010

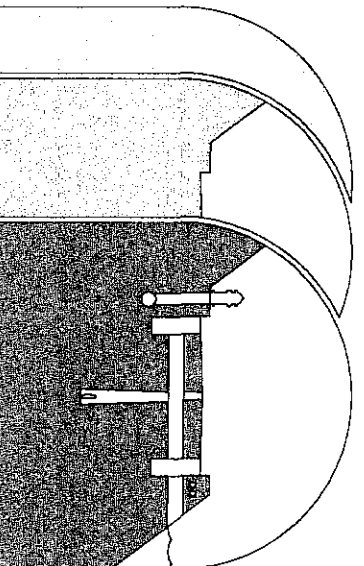
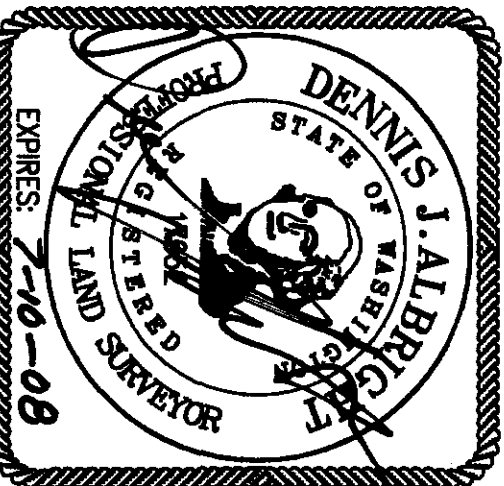

Sound Development Group
ENGINEERING, SURVEYING & LAND DEVELOPMENT SERVICES
1111 CLEVELAND AVE., SUITE 202
MOUNT VERNON, WA 98233
Tel: 360-404-2010 Fax: 360-404-2013

EMPIRE CONDOMINIUMS

A CONDOMINIUM
KING SQUARED, LLC
IN A PORTION OF THE W 1/2 OF SECTION 18, TOWNSHIP 35 NORTH, RANGE 2 EAST, W.M., CITY OF ANACORTES, SKAGIT COUNTY, WASHINGTON

DATE: 7-17-07 BY: DJA SCALE:
PROJECT NO. 050-07 032-07-SURV.DWG F.B.

EMPIRE CONDOMINIUMS, A CONDOMINIUM

SURVEY MAP AND PLANS

PORTION OF THE W 1/2 OF SECTION 18, T.35 N, R.2 E, WM

PROJECT BENCHMARK
TOP OF MONUMENT IN CASE,
ELEVATION = 22.0 NAVD88

8/3/2007 Page 2 of 3 3:57PM
200708030174
Skagit County Auditor

FOUND MONUMENT
IN CASE

379.87'
588'09.00"E

7TH STREET

POSITION FALLS
ON MANHOLE,
ESTABLISHED
INTERSECTION
USING R.P.'S

BLDG. COR.
IS 0.3 N
OF CALC.
POSITION

BLDG. COR.
IS 0.2 N
AND 0.3 E
OF CALC.
POSITION

BASIS OF BEARING

ASSUMED S 88°09'00" E BETWEEN THE FOUND MONUMENTS
ALONG 7TH STREET AS SHOWN HEREON.

INSTRUMENT NOTE

THIS SURVEY WAS ACCOMPLISHED BY FIELD TRAVERSE
WITH A "LEICA TORR 1105" AND A TRIMBLE 5800 DUAL
FREQUENCY GPS RECEIVER. STANDARD ERROR DISTANCE
±1.20M (±1.1 PPM), AND MEETS OR EXCEEDS
STANDARDS AS SET FORTH IN W.A.C. CH. 332.

RESEARCH

SURVEY RECORDED UNDER APR'S 9512060050, 8701200033 AND
200703230099.

VERTICAL DATUM

THE VERTICAL DATUM IS BASED ON GPS OBSERVATIONS DONE ON
3-22-07 AND SUBMITTED TO OPUS ON 3-23-07. WE FOUND
THIS POINT TO HAVE AN ELEVATION OF 15.07' (NAVD88)

THE VERTICAL DATUM FOR THIS PROJECT IS NAVD88 (VERTCON
CONVERSION IS NAVD88 - 3.78 = NAVD29. WE HELD THE
RESULTS OBTAINED FROM OPUS FOR OUR BASE ELEVATION OF
15.07' (NAVD88).

SURVEY NOTES

1. ALL CORNERS SHOWN WERE VISITED IN MAY OF 2007.

COMMERCIAL AVE.

295.56'
N01°52'28"E

40'

N01°52'28"E
99.79'

11

12

13

14

15

16

17

18

19

20

S01°53'21"W
99.89'

40'

"Q" AVE.

295.80'
S01°53'21"W

16'

588'07'55"E

588'07'55"E

299.83'

299.83'

16'

S01°53'21"W
99.89'

40'

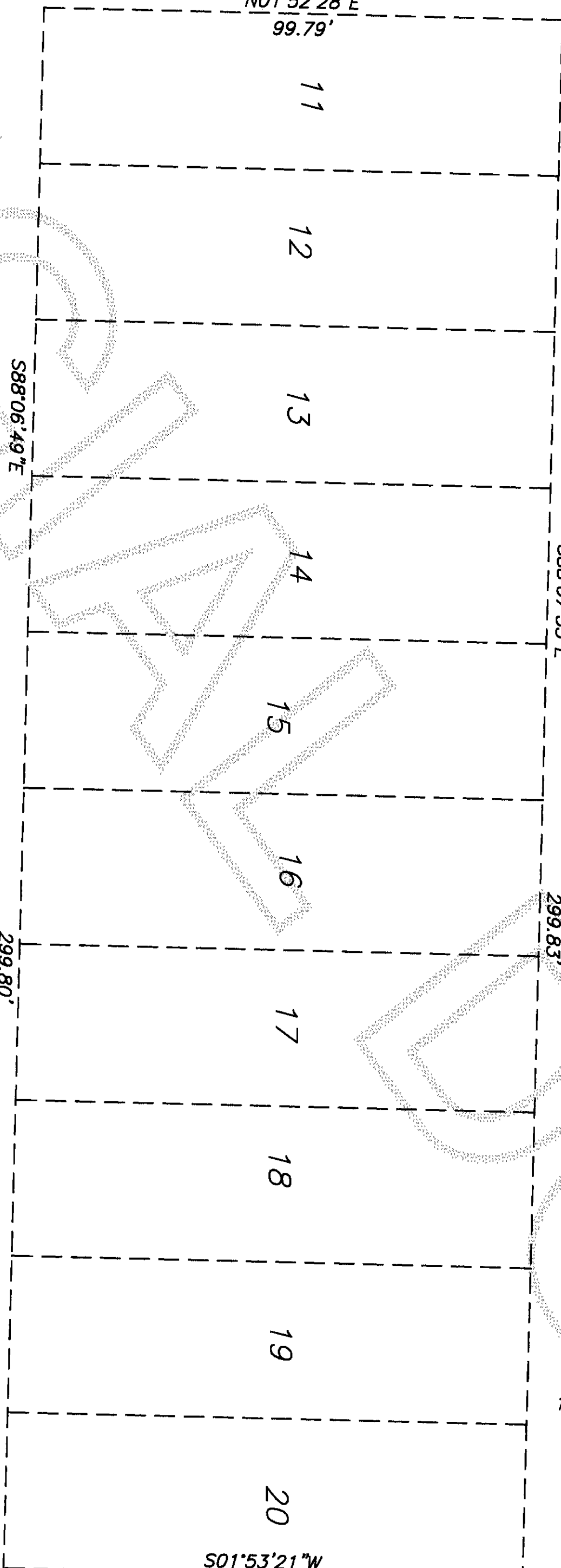

POSITION FALLS
ON MANHOLE,
ESTABLISHED
INTERSECTION
USING R.P.'S

588'06'49"E

8TH STREET

379.79'

COMPUTED
POSITION

9TH STREET

S01°53'21"W
295.80'

FOUND MONUMENT
IN CASE

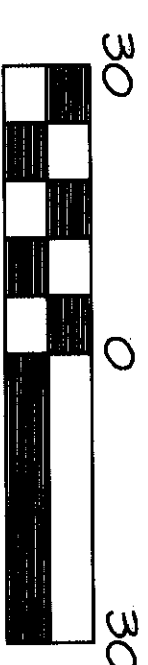

Scale 1" = 30'

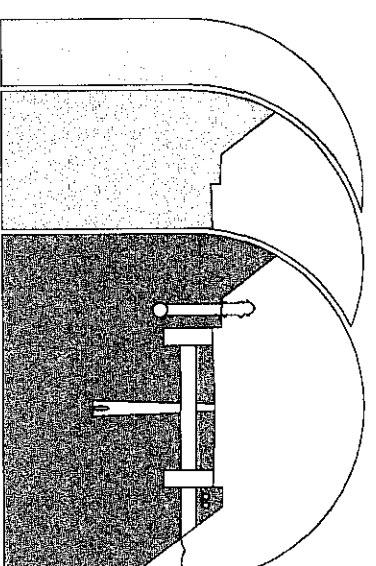
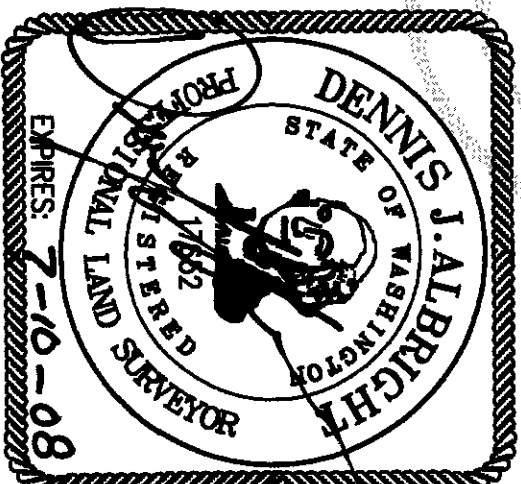

Sound Development Group

ENGINEERING, SURVEYING & LAND DEVELOPMENT SERVICES
1111 CLEVELAND AVE., SUITE 202
MOUNT VERNON, WA 98233
Tel: 360-404-2010 Fax: 360-404-2013

EMPIRE CONDOMINIUMS

A CONDOMINIUM
KING SQUARED, LLC

IN A PORTION OF THE W 1/2 OF SECTION 18, TOWNSHIP
35 NORTH, RANGE 2 EAST, W.M., CITY OF ANACORTES,
SKAGIT COUNTY, WASHINGTON

EMPIRE CONDOMINIUMS, A CONDOMINIUM

SURVEY MAP AND PLANS

PORTION OF THE W 1/2 OF SECTION 18, T.36 N, R.2 E. WM



200708030174
Skegit County Auditor
8/3/2007 Page 3 of 3 3:57PM

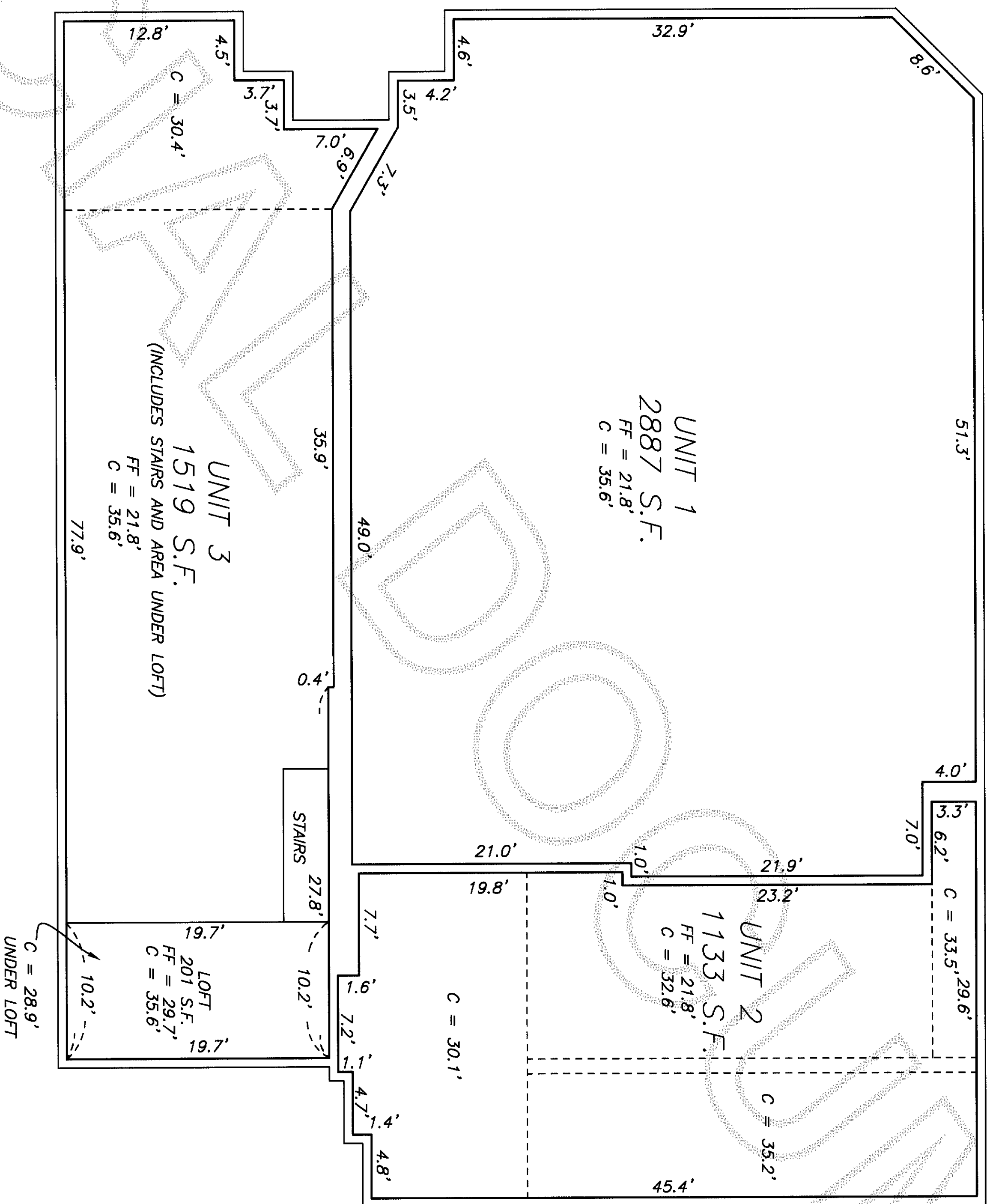

LEGEND
LCE LIMITED COMMON ELEMENT
CE COMMON ELEMENT
C CEILING ELEVATION
FF FINISHED FLOOR ELEVATION

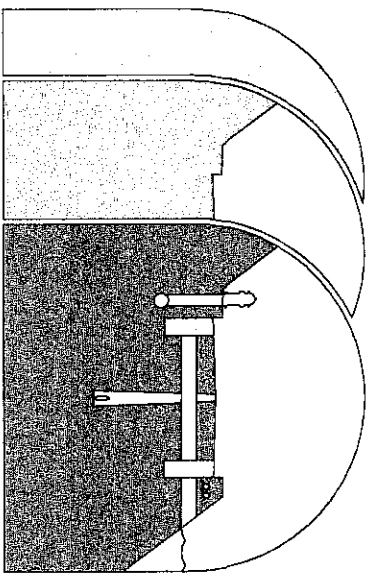
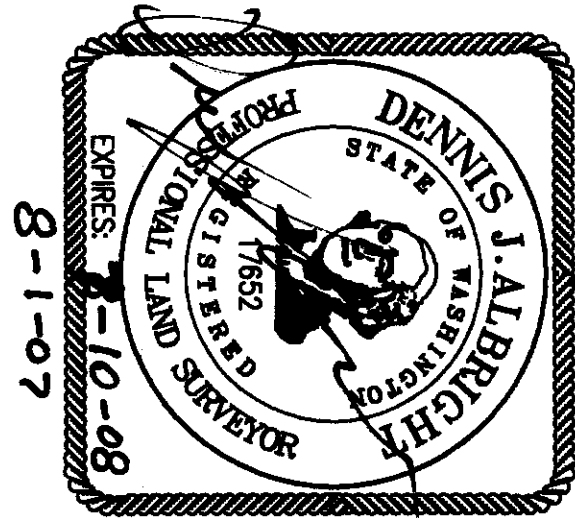
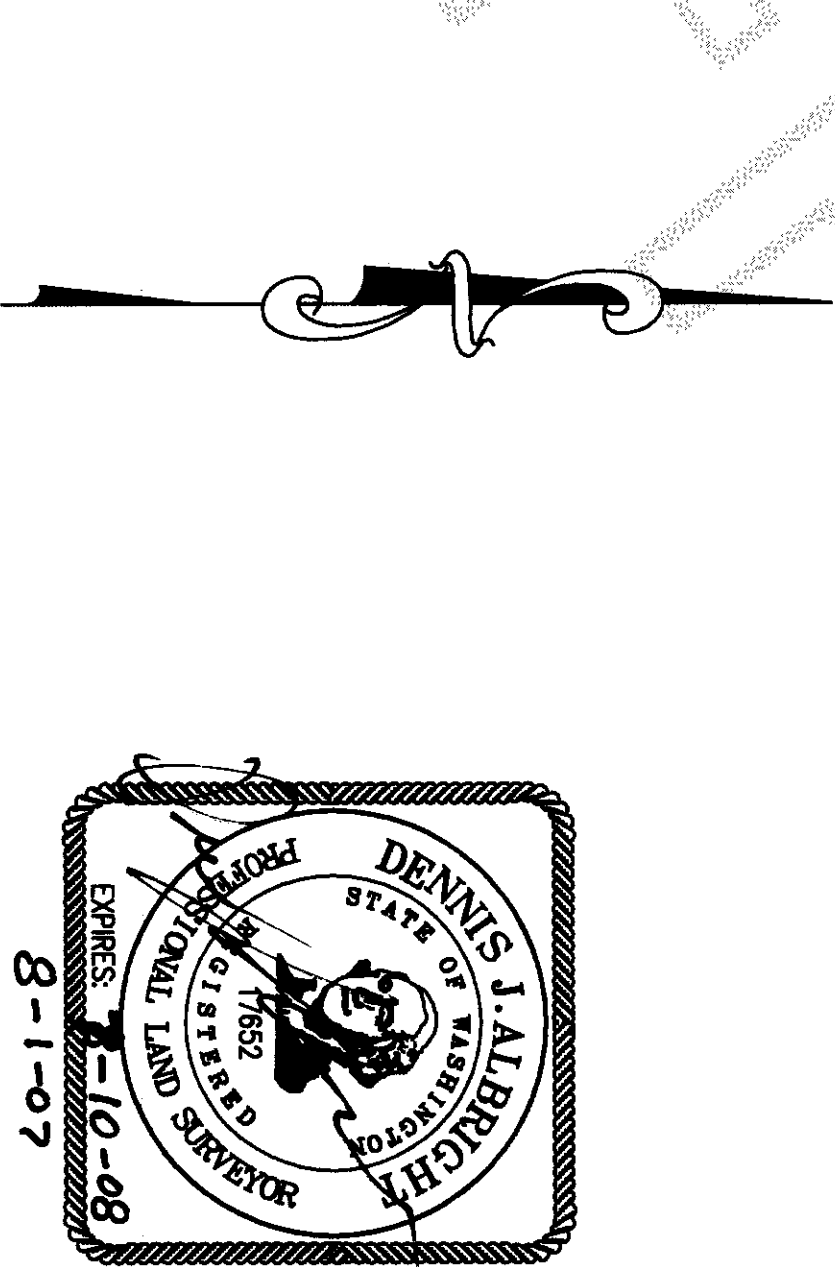

Sound Development Group

ENGINEERING, SURVEYING & LAND DEVELOPMENT SERVICES
1111 CLEVELAND AVE., SUITE 202
MOUNT VERNON, WA 98233
Tel: 360-404-2010 Fax: 360-404-2013

EMPIRE CONDOMINIUMS

A CONDOMINIUM
KING SQUARED, LLC

IN A PORTION OF THE W 1/2 OF SECTION 18, TOWNSHIP
35 NORTH, RANGE 2 EAST, W.M., CITY OF ANACORTES,
SKAGIT COUNTY, WASHINGTON

DATE: 8-1-07 BY: DJA
PROJECT NO. 050-07 032-07-SURV.DWG F.B. 32/47