

Survey in the NE1/4 of the NW1/4 of Section 33, Twp. 35 N., Rng. 3 E., W.M.

Short Plat No. PL06-0901

FOUND CONCRETE MONUMENT WITH PUNCHED BRASS CAP WITH IN CASE AND COVER AT THE INTERSECTION OF THE JOSH WILSON ROAD AND FARM TO MARKET ROAD ON 5/2/06.

Legend

- FOUND 1/2" X 18" REINFORCING ROD WITH YELLOW PLASTIC CAP MARKED "SKA SURV 17651" (SET DURING SHORT PLAT NO. 19-90 FILED IN A.F.#9005210034) AND SET WHITE 2" X 2" WITNESS STAKE.
- SET 1/2" X 18" REINFORCING ROD WITH YELLOW PLASTIC CAP MARKED "SKA SURV 17651" AND WHITE 2" X 2" WITNESS STAKE, EXCEPT AS NOTED.
- * SET 1/2" X 18" REINFORCING ROD WITH YELLOW PLASTIC CAP MARKED "SKA SURV 17651" AND 3/8" X 48" WHITE FIBERGLASS POST WITH LABEL MARKED "PCA".
- ⊙ SOIL LOG HOLE
- WL — WL — PROTECTED CRITICAL AREA BOUNDARY.
- ▨ LIMITS OF WETLANDS
- — — PROPOSED ACCESS LOCATIONS.

Minimum Setback Requirements

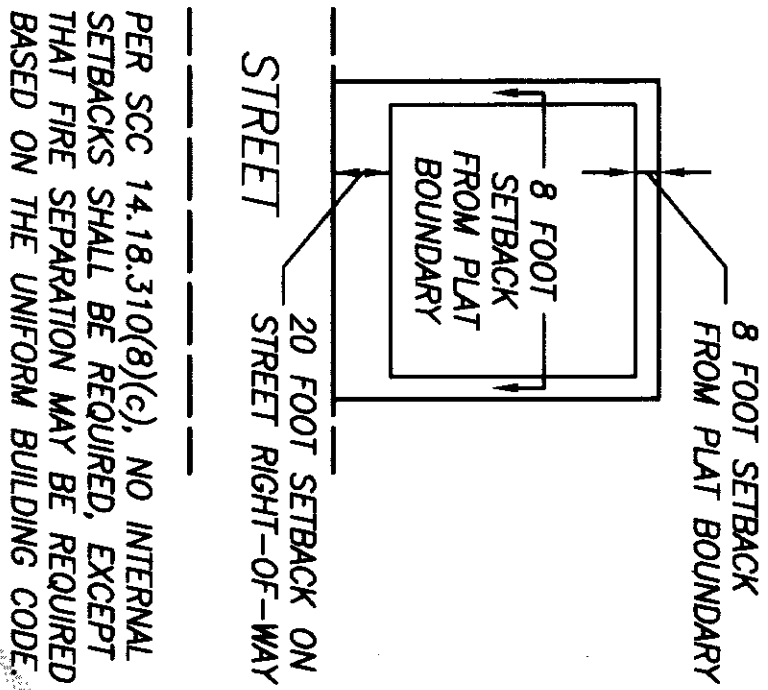

Curve Table

#	RADIUS	DELTA	LENGTH
C1	25.00'	115°29'36"	50.39'

Line Table

#	BEARING	DISTANCE
L1	S63°15'33"W	13.86'
L2	N27°15'00"W	25.96'
L3	N45°29'01"E	49.02'
L4	N08°13'49"W	18.64'
L5	N38°48'05"W	60.51'
L6	N23°30'01"E	51.28'
L7	S40°58'20"W	56.48'
L8	S73°08'16"E	40.37'
L9	S78°51'16"E	31.21'

#	BEARING	DISTANCE
L10	N89°56'18"E	67.55'
L11	S39°05'15"E	55.78'
L12	S29°59'30"E	43.05'
L13	S38°02'09"E	51.77'
L14	S84°41'03"E	43.28'
L15	S05°28'58"W	61.23'
L16	N63°15'33"E	81.24'
L17	N64°44'47"E	71.42'
L18	N00°09'47"W	58.06'
L19	N23°32'04"W	85.55'

Address Range

FROM 12434 TO 18867 JOSH WILSON ROAD

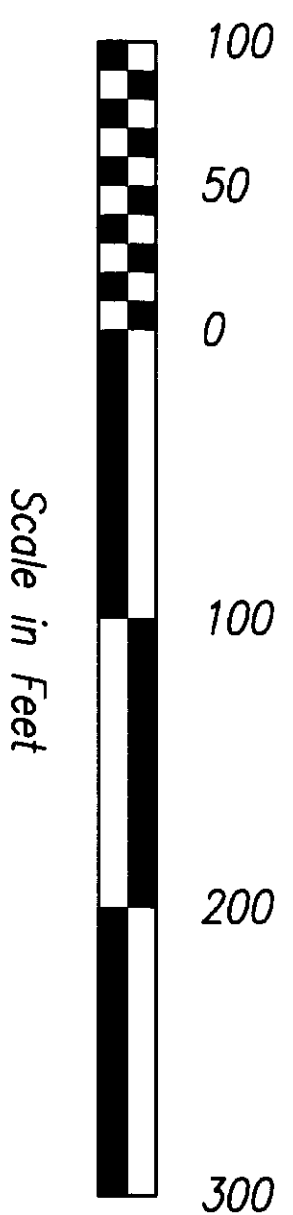

Scale in Feet

S88°46'08"E 2626.98'

1313.49'

CENTER OF SECTION 33 AS SHOWN ON SHORT PLAT NO. 19-90 FILED IN A.F.#9005210034.

Short Plat (CARD) for Ron Van Luyen

COPYRIGHT 2007 SKAGIT SURVEYORS, INC.



806 Metcalf St., Sedro-Woolley, WA 98284 Phone: (360) 855-2121 FAX: (360) 855-1658

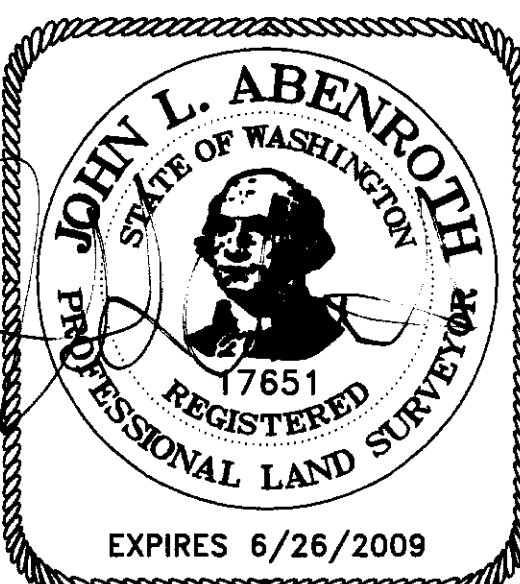

SURVEYOR'S CERTIFICATE

This map correctly represents a survey made by me or under my direction in conformance with the Survey Recording Act in January 200 at the request of Ron Van Luyen.

John L. Abenroth CERT#17651
Date 6/25/07

AUDITOR'S CERTIFICATE

200708010045
Skagit County Auditor

8/1/2007 Page 1 of 2 211:28AM

County Auditor or Deputy Auditor

Notes

1. SHORT PLAT NUMBER AND DATE OF APPROVAL SHALL BE INCLUDED IN ALL DEEDS AND CONTRACTS.
2. BASIS-OF-BEARINGS – SHORT PLAT NO. 19-90 FILED IN A.F.#9005210034.
3. ZONING/COMPREHENSIVE PLAN DESIGNATION – RURAL RESERVE (RRV)
4. SEWER – INDIVIDUAL ON-SITE SEWAGE DISPOSAL SYSTEMS.
5. THIS SURVEY WAS ACCOMPLISHED BY FIELD TRAVERSE USING: 5 SECOND OR BETTER DIGITAL ELECTRONIC TOTAL STATION, AND MEETS OR EXCEEDS THE STANDARDS CONTAINED IN WAC 332-130-090.
6. NO BUILDING PERMIT SHALL BE ISSUED FOR ANY RESIDENTIAL AND/OR COMMERCIAL STRUCTURES WHICH ARE NOT, AT THE TIME OF APPLICATION, DETERMINED TO BE WITHIN AN OFFICIAL DESIGNATED BOUNDARY OF A SKAGIT COUNTY FIRE DISTRICT.
7. A SKAGIT COUNTY ADDRESS RANGE HAS BEEN APPLIED TO THE ROAD SYSTEM IN THIS SUBDIVISION. AT THE TIME OF APPLICATION FOR BUILDING AND/OR ACCESS PERMITS, SKAGIT COUNTY GIS WILL ASSIGN INDIVIDUAL ADDRESSES IN ACCORDANCE WITH THE PROVISIONS OF SKAGIT COUNTY CODE 15.24. CHANGE IN LOCATION OF ACCESS, MAY NECESSITATE A CHANGE OF ADDRESS, CONTACT SKAGIT COUNTY PLANNING AND DEVELOPMENT SERVICES.
8. WATER – WATER WILL BE SUPPLIED BY P.U.D. # 1 OF SKAGIT COUNTY. ALL NEW AND EXISTING WATER WELLS ON THE SUBJECT PROPERTY OR ON ADJACENT PROPERTIES ARE REQUIRED TO HAVE 100-FOOT RADIUS WELL PROTECTION ZONES TO GUARD AGAINST WASTE AND CONTAMINATION. SOME EXAMPLES OF SOURCES OF POTENTIAL CONTAMINATION INCLUDE: SEPTIC SYSTEMS; MANURE LAGOONS; SEWAGE LAGOONS; INDUSTRIAL LAGOONS; LANDFILLS; HAZARDOUS WASTE SITES; SEA-SALT INTRUSION AREAS; CHEMICAL OR PETROLEUM STORAGE AREAS; PIPELINES USED TO CONVEY MATERIALS WITH CONTAMINATION POTENTIAL; LIVESTOCK BARNS; AND LIVESTOCK FEED LOTS.
9. ALL RUNOFF FROM IMPERVIOUS SURFACES AND ROOF DRAINS SHALL BE DIRECTED SO AS NOT TO ADVERSELY EFFECT ADJACENT PROPERTIES.
10. SUBJECT PROPERTY MAY BE ENCUMBERED BY EASEMENTS OR RESTRICTIONS CONTAINED IN DOCUMENTS FILED IN A.F.#759929; A.F.#8912110001; A.F.#9005210034; A.F.#9010290102; A.F.#9209280005; A.F.#9809250008; A.F.#200109100105; A.F.#200411090163; A.F.#200512210101; A.F.#200601040052; A.F.#200601060116; A.F.#200608100008; A.F.#200609190104.
11. THE TOTAL ACREAGE IN THIS SHORT SUBDIVISION IS 9.63 ACRES, (10.00 ACRES TO ROAD CENTERLINE).
12. A LOT OF RECORD CERTIFICATION HAS BEEN ISSUED FOR ALL LOTS INCLUDED IN THIS LAND DIVISION. BY VIRTUE OF RECORDING THIS LAND DIVISION AND ISSUANCE OF THE LOT CERTIFICATION, ALL LOTS HEREIN SHALL BE CONSIDERED LOTS OF RECORD FOR CONVEYANCE AND DEVELOPMENT PURPOSES UNLESS OTHERWISE RESTRICTED. SEE A.F.# 200108010046.
13. SEE PROTECTED CRITICAL AREAS EASEMENT AGREEMENT FILED IN A.F.# 200708010047.

Vicinity Sketch

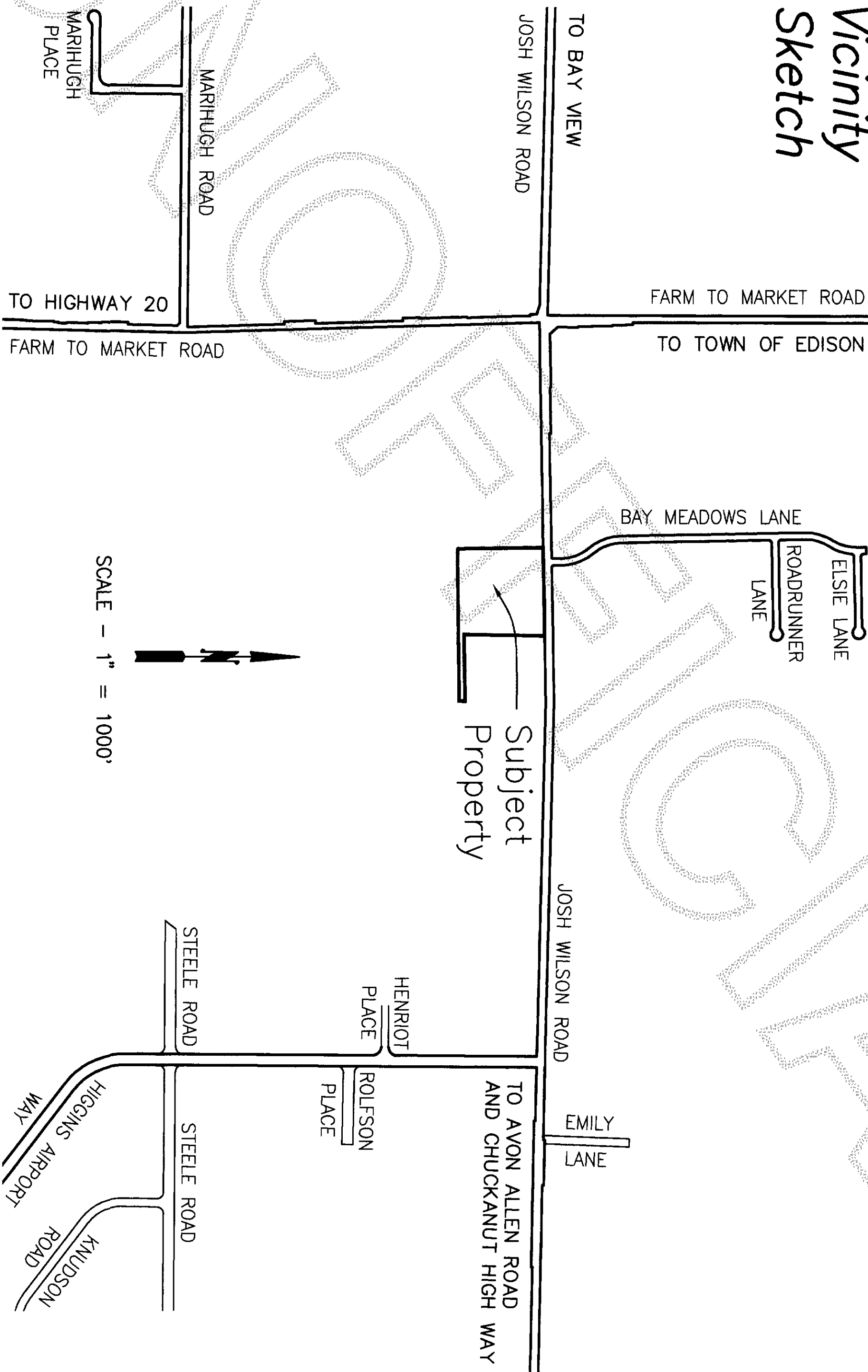

Legal Description

PARCEL "A": LOT 2, SHORT PLAT NO. 19-90, APPROVED MAY 21, 1990 AND RECORDED MAY 21, 1990 IN VOLUME 9 OF SHORT PLATS, PAGE 229, UNDER AUDITOR'S FILE NO. 9005210034, RECORDS OF SKAGIT COUNTY, WASHINGTON, (BEING A PORTION OF THE NORTHEAST 1/4 OF THE NORTHWEST 1/4 OF SECTION 33, TOWNSHIP 35 NORTH, RANGE 3 EAST, W.M.

PARCEL "B": THE SOUTH 43.00 FEET OF THE EAST 482.50 FEET OF THE NORTH 1/2 OF THE NORTHEAST 1/4 OF THE NORTHWEST 1/4 OF SECTION 33, TOWNSHIP 35 NORTH, RANGE 3 EAST, W.M.

Consent

KNOW ALL MEN BY THESE PRESENTS THAT WE THE UNDERSIGNED SUBDIVIDERS HEREBY CERTIFY THAT THIS SHORT PLAT IS MADE AS OUR FREE AND VOLUNTARY ACT AND DEED.

Ronald T. Van Loven Kathy F. Van Loven
RONALD T. VAN LOVEN KATHY F. VAN LOVEN

Acknowledgments

STATE OF WASHINGTON, COUNTY OF SKAGIT
I CERTIFY THAT I KNOW OR HAVE SATISFACTORY EVIDENCE THAT RONALD T. VAN LOVEN AND KATHY F. VAN LOVEN, (H/W), SIGNED THIS INSTRUMENT AND ACKNOWLEDGED IT TO BE THEIR FREE AND VOLUNTARY ACT FOR THE USES AND PURPOSES MENTIONED IN THE INSTRUMENT.

NOTARY SIGNATURE [Signature] TITLE NOTARY
DATE June 25, 2007 MY APPOINTMENT EXPIRES 11/1/2007

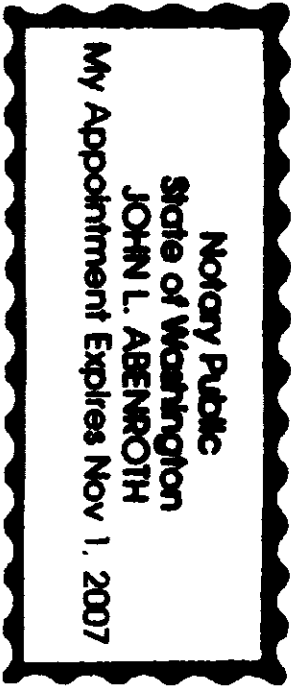

Treasurer's Certificate

THIS IS TO CERTIFY THAT ALL TAXES HERETOFORE LEVIED AND WHICH HAVE BECOME A LIEN ON THE LANDS HEREIN DESCRIBED HAVE BEEN FULLY PAID AND DISCHARGED ACCORDING TO THE RECORDS OF MY OFFICE UP TO AND INCLUDING THE YEAR 2007.

[Signature] 7/26/07
SKAGIT COUNTY TREASURER DATE

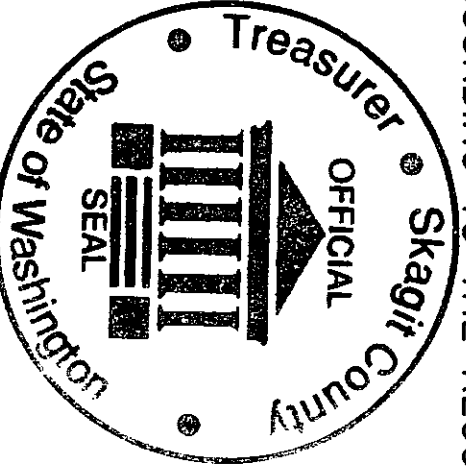

Approvals

THE WITHIN AND FOREGOING SHORT PLAT IS APPROVED IN ACCORDANCE WITH THE PROVISIONS OF SKAGIT COUNTY CODE TITLE 14.18 (LAND DIVISIONS) THIS 1st DAY OF August 2007.

[Signature] [Signature]
SHORT PLAT ADMINISTRATOR COUNTY ENGINEER

THE WITHIN AND FOREGOING SHORT PLAT IS APPROVED IN ACCORDANCE WITH THE PROVISIONS OF SKAGIT COUNTY CODE TITLE 12.05 (ON-SITE SEWAGE) AND 12.48 (WATER) THIS 28 DAY OF June 2007.

[Signature]
SKAGIT COUNTY HEALTH OFFICER

Owner/Developer

RON AND KATHY VAN LOVEN
14410 JOSH WILSON ROAD
BURLINGTON, WA. 98233



806 Metcalf St., Sedro-Woolley, WA 98284 Phone: (360) 855-2121 FAX: (360) 855-1658

SURVEYOR'S CERTIFICATE

This map correctly represents a survey made by me or under my direction in conformance with the Survey Recording Act in January 2007 at the request of Ron Van Loven.

John L. Abenroth CERT#17651
Date 6/25/07

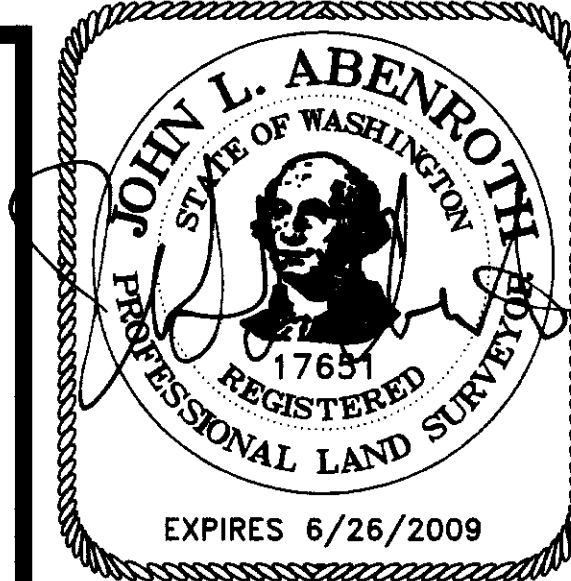

AUDITOR'S CERTIFICATE



8/1/2007 Page 2 of 2 211:26AM

[Signature]
County Auditor or Deputy Auditor