

SURVEYOR'S CERTIFICATE
THIS MAP CORRECTLY REPRESENTS A SURVEY MADE BY ME OR UNDER MY DIRECTION IN CONFORMANCE WITH THE REQUIREMENTS OF THE SURVEY RECORDING ACT AT THE REQUEST OF:
David B. Tiersland in *July, 2007*
CERTIFICATE NO. *28023*

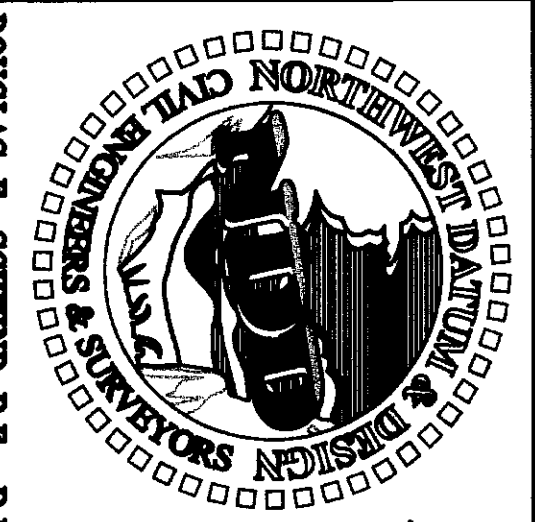

NORTHWEST DATUM & DESIGN
CIVIL ENGINEERING AND SURVEYING SOLUTIONS
1128 E. FAIRHAVEN AVE
BURLINGTON, WASHINGTON 98233
PH: (360) 755-0434 FAX: (360) 755-0464

DAVID B TIERSLAND
1966 REXVILLE GRANGE ROAD
Mount Vernon, Washington 98273

REXVILLE SHORT PLAT
SURVEY in a portion of the NE 1/4 of
Section 9, T. 33 N., R. 3 E. 1W

SHORT PLAT NO. PL07-0159

Section 9, T. 33 N., R. 3 E.
Skagit County, Washington

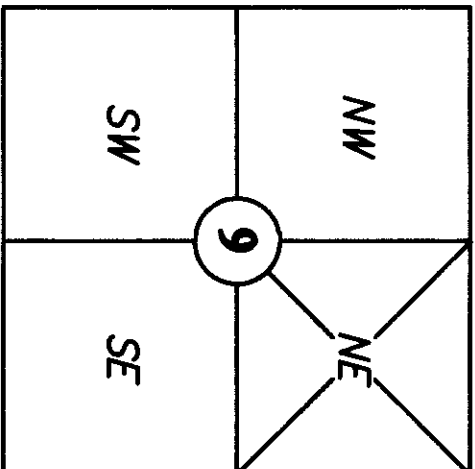

VICINITY MAP - NOT TO SCALE

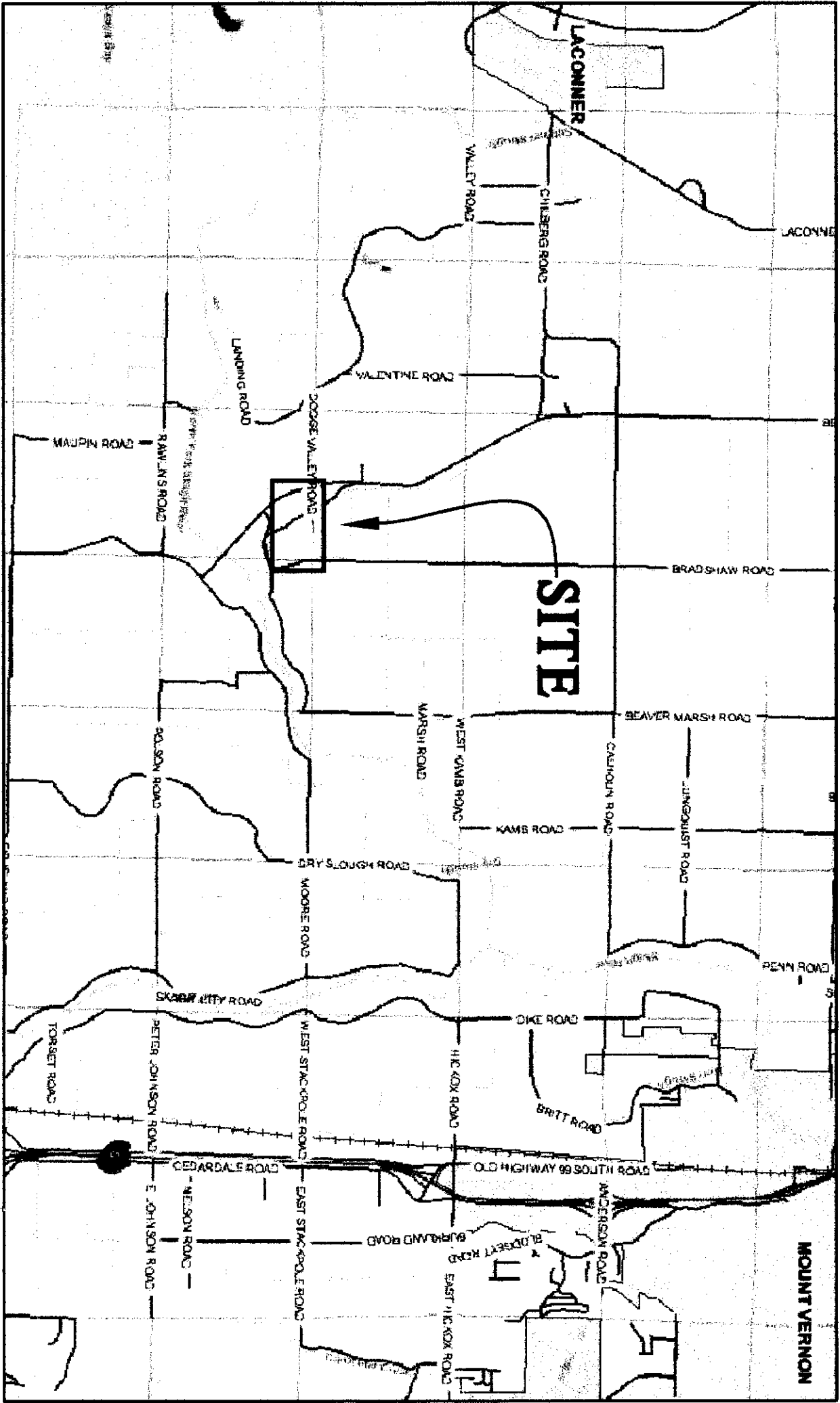

LINE TABLE		
LINE	LENGTH	BEARING
L1	188.20	N12°52'39"W
L2	80.50	N30°47'04"W
L3	153.83	N44°00'18"W
L4	133.75	N04°30'38"W
L5	85.66	N16°20'30"E
L6	69.66	N39°32'39"E
L7	76.02	S21°20'51"W
L8	100.00	S01°08'20"W
L9	28.13	S27°57'23"E
L10	143.11	S58°37'19"E
L11	143.75	S64°28'05"E
L12	64.47	N68°42'44"E
L13	96.05	N63°50'55"E
L14	64.77	S78°41'36"E
L15	112.14	S58°42'03"E
L16	58.04	S75°14'54"E
L17	131.05	S50°55'37"E
L18	63.14	S40°38'28"E
L19	24.34	S87°14'50"E
L20	38.86	S87°14'50"E
L21	104.97	N25°59'19"E
L22	115.00	N01°08'20"E
L23	69.30	S89°39'58"W
L24	160.95	S20°20'02"E
L25	119.55	S49°35'02"E
L26	79.24	S89°28'05"E
L27	119.55	S49°35'02"E
L28	218.40	S20°20'02"E

- LEGEND
- EXISTING SECTION CORNER MONUMENT IN CASE
 - EXISTING 1/4 CORNER MONUMENT IN CASE
 - EXISTING 1/16 CORNER
 - 5/8" REBAR SET WITH YELLOW CAP MARKED DES IS 28023

CURVE TABLE		
CURVE	LENGTH	RADIUS
C1	307.84	603.00
C2	114.65	543.00
C3	98.28	543.00
C4	111.24	603.00
C5	126.21	603.00
C6	271.21	543.00

WETLAND AREAS - CATEGORY III		
REGULATED	NON-REGULATED	BUFFER AREA
201,845 SF	2,092 SF	318,887 SF

PROPERTY AREA TABLE		
LOT	GROSS AREA	NET AREA
LOT 1 AG	1,953,803 SF / 44.85 AC	1,899,797 SF / 43.61 AC
LOT 2 RRV	435,599 SF / 10.00 AC	402,023 SF / 9.23 AC
LOT 3 RRV	562,358 SF / 12.91 AC	507,841 SF / 11.66 AC
LOT 3 RRV	819,354 SF / 18.81 AC	741,949 SF / 17.03 AC
AG	61,644 SF / 1.42 AC	38,218 SF / 0.88 AC
TOTAL	3,397,157 SF / 77.99 AC	3,187,805 SF / 73.18 AC

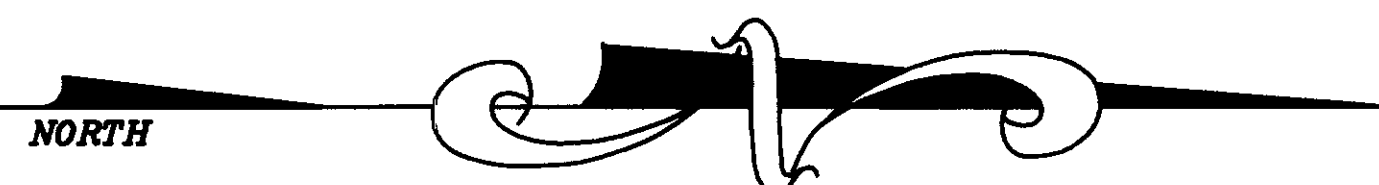
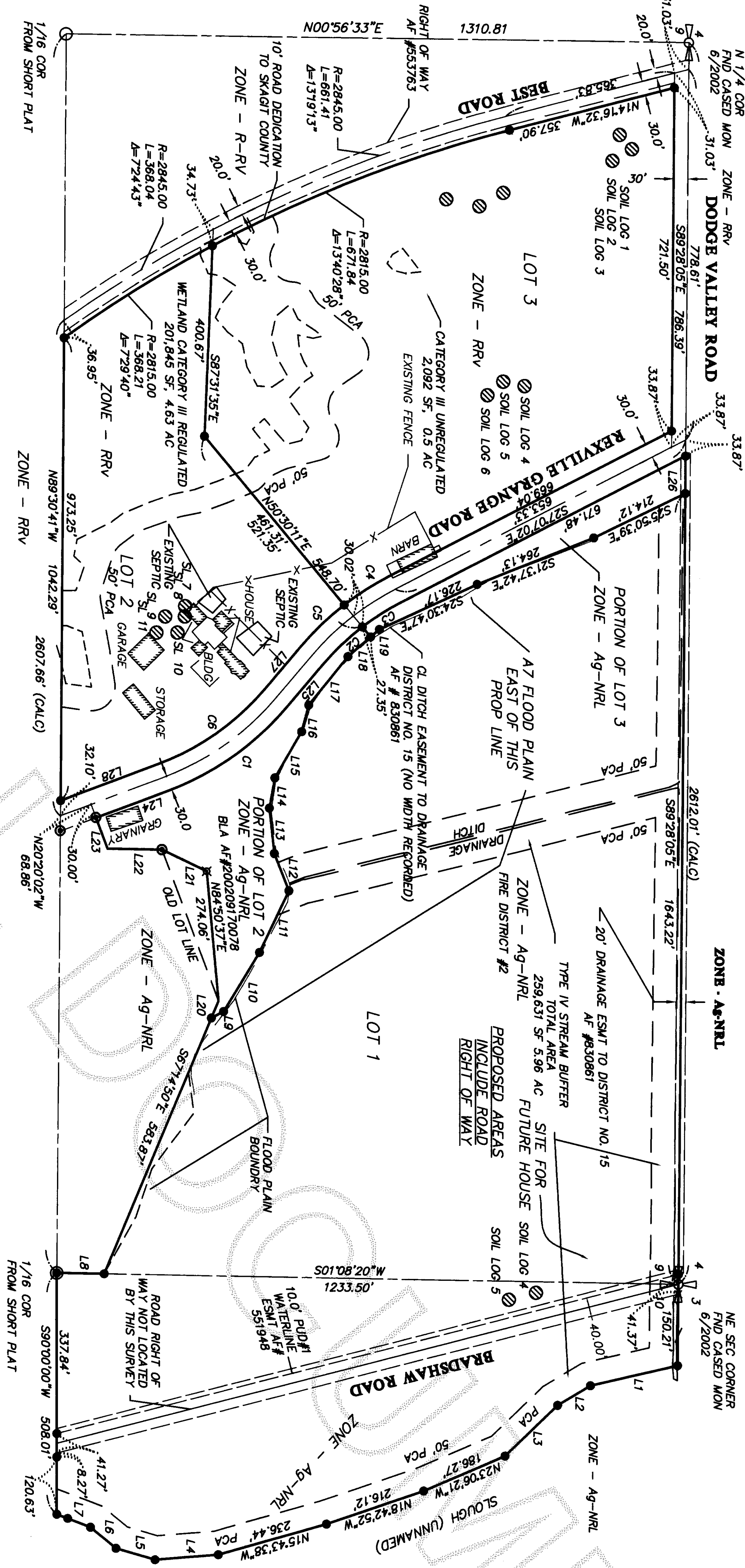

AUDITOR'S CERTIFICATE
200707260070
Skagit County Auditor
7/26/2007 Page 1 of 311:38AM
Jonathan Howard
COUNTY AUDITOR OR DEPUTY AUDITOR

SURVEY INSTRUMENTATION
TRIMBLE S-6
SERIAL 92710977, STD DEV 3",
EDM ± (3MM +2PPM),
SURVEYING PROCEDURE
FIELD TRAVERSE.
LINEAR AND ANGULAR MEASUREMENTS MEET OR EXCEED STANDARDS SET IN WAC 332-130-090
BASIS OF BEARING
SECTION CORNER MONUMENTATION SEC. 9,
T. 33N., R. 3E., 1W., SKAGIT COUNTY,
WASHINGTON.

PROJECT 03018a
DRAWING 03018a.dwg
DRAWN BY bz
CHECKED BY des
DATE July 2007
SHEET 1 OF 3

LEGAL DESCRIPTION

LOT 2 OF SHORT PLAT NO. 92-033, APPROVED DECEMBER 14, 1992, RECORDED DECEMBER 18, 1992, IN VOLUME 10 OF SHORT PLATS, PAGES 160 AND 161, UNDER AUDITOR'S FILE NO. 9212180014, RECORDS OF SKAGIT COUNTY, WASHINGTON, BEING A PORTION OF THE NORTH 1/4 OF SECTION 9 AND OF THE NORTHWEST 1/4 OF THE NORTHWEST 1/4 OF SECTION 10, ALL IN TOWNSHIP 33 NORTH, RANGE 3 EAST, WM.; EXCEPT THAT PORTION OF LOT 2 OF SAID SHORT PLAT, DESCRIBED AS FOLLOWS:
BEGINNING AT THE NORTHEAST CORNER OF SAID LOT 1; THENCE NORTH 67°4'50" WEST, ALONG THE NORTH LINE OF SAID LOT 1 A DISTANCE OF 822.23 FEET TO THE TRUE POINT OF BEGINNING; THENCE SOUTH 69° 35'42" WEST A DISTANCE OF 340.08 FEET; THENCE NORTH 25°39'19" EAST A DISTANCE OF 104.51 FEET; THENCE NORTH 80°50'37" EAST A DISTANCE OF 274.06 FEET TO THE TRUE POINT OF BEGINNING.
SITUATE IN THE COUNTY OF SKAGIT, STATE OF WASHINGTON.

OWNER'S CERTIFICATION

KNOW ALL MEN BY THESE PRESENTS THAT WE, THE UNDERSIGNED OWNERS OF THE LAND HEREBY PLATED, DECLARE THIS SHORT PLAT AS THEIR FREE AND VOLUNTARY ACT FOR THE USES SHOWN HEREIN.

DAVID B. TIERSLAND

David B. Tiersland
DATE

Populic Snellie
KEY BANK NATIONAL ASSOCIATION
Theque line Snoyridge, AVE

Renée J. Mueller
Met Gate Electronic Registration
Systems, INC. (MEGS)
Renée J. Mueller - Assist. Secretary

ACKNOWLEDGMENT

OHIO

STATE OF WASHINGTON
COUNTY OF SKAGIT
THIS IS TO CERTIFY THAT ON THIS 13th DAY OF May 2009, BEFORE ME, THE UNDERSIGNED, A NOTARY PUBLIC, PERSONALLY APPEARED *Populic Snellie* TO ME KNOWN TO BE THE *Assistant Vice President* OF KEY BANK NATIONAL ASSOCIATION, A WASHINGTON CORPORATION, WHICH CORPORATION HAS EXECUTED THE FOREGOING INSTRUMENT AND EACH OF THE SAID NAMED OFFICERS ACKNOWLEDGED THE SAID INSTRUMENT TO BE THE FREE AND VOLUNTARY ACT AND DEED OF THE CORPORATION OF WHICH HE IS AN OFFICER, AND ON OATH STATED THAT HE WAS AUTHORIZED TO EXECUTE THE SAID INSTRUMENT AND THAT THE SEAL AFFIXED IS THE CORPORATE SEAL OF SAID CORPORATION.

WITNESS MY HAND AND OFFICIAL SEAL THE DAY AND YEAR FIRST ABOVE WRITTEN.

Paula S. Conrad

OHIO

NOTARY PUBLIC IN AND FOR THE STATE OF WASHINGTON, RESIDING AT

Easton, Ohio

MY COMMISSION EXPIRES

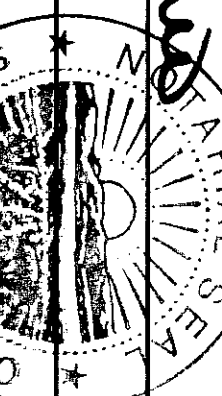

ACKNOWLEDGMENT

STATE OF ~~Washington~~ *Kentucky*
COUNTY OF ~~Skagit~~ *Daniels County*
THIS IS TO CERTIFY THAT ON THIS 19 DAY OF Dec 2006, BEFORE ME, THE UNDERSIGNED, A NOTARY PUBLIC, PERSONALLY APPEARED *Renée J. Mueller* TO ME KNOWN TO BE THE *Assistant Secretary* OF *MEGS* A ~~Washington~~ *Kentucky* CORPORATION, WHICH CORPORATION HAS EXECUTED THE FOREGOING INSTRUMENT AND EACH OF THE SAID NAMED OFFICERS ACKNOWLEDGED THE SAID INSTRUMENT TO BE THE FREE AND VOLUNTARY ACT AND DEED OF THE CORPORATION OF WHICH HE IS AN OFFICER, AND ON OATH STATED THAT HE WAS AUTHORIZED TO EXECUTE THE SAID INSTRUMENT AND THAT THE SEAL AFFIXED IS THE CORPORATE SEAL OF SAID CORPORATION.

WITNESS MY HAND AND OFFICIAL SEAL THE DAY AND YEAR FIRST ABOVE WRITTEN.

Paula S. Conrad

NOTARY PUBLIC IN AND FOR THE STATE OF *Kentucky* RESIDING AT

Daniels County - Owensboro, Kentucky

MY COMMISSION EXPIRES *5/13/2009*

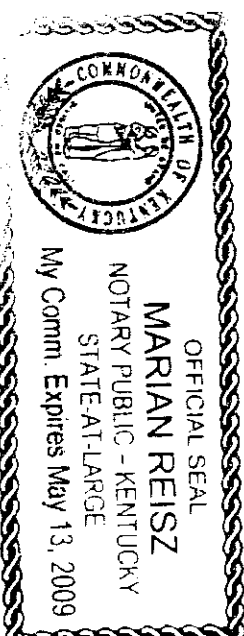

ACKNOWLEDGMENT

STATE OF WASHINGTON
COUNTY OF SKAGIT
THIS IS TO CERTIFY THAT ON THIS 30th DAY OF October 2006, BEFORE ME, THE UNDERSIGNED, A NOTARY PUBLIC, PERSONALLY APPEARED DAVID B. TIERSLAND, TO ME KNOWN TO BE THE INDIVIDUAL WHO EXECUTED THE WITHIN AND FORGOING INSTRUMENTS, AND ACKNOWLEDGED TO ME THAT HE SIGNED AND SEALED THE SAME AS HIS FREE AND VOLUNTARY ACT AND DEED FOR THE USES AND PURPOSES THEREIN MENTIONED.

WITNESS MY HAND AND OFFICIAL SEAL THE DAY AND YEAR FIRST ABOVE WRITTEN.

David B. Tiersland

NOTARY PUBLIC IN AND FOR THE STATE OF WASHINGTON, RESIDING AT

MA. Vernon, WA

MY COMMISSION EXPIRES *May 13, 2009*



ACKNOWLEDGMENT

STATE OF WASHINGTON
COUNTY OF SKAGIT
THIS IS TO CERTIFY THAT ON THIS 30th DAY OF October 2006, BEFORE ME, THE UNDERSIGNED, A NOTARY PUBLIC, PERSONALLY APPEARED GAYLE B. TIERSLAND, TO ME KNOWN TO BE THE INDIVIDUAL WHO EXECUTED THE WITHIN AND FORGOING INSTRUMENTS, AND ACKNOWLEDGED TO ME THAT HE SIGNED AND SEALED THE SAME AS HIS FREE AND VOLUNTARY ACT AND DEED FOR THE USES AND PURPOSES THEREIN MENTIONED.

WITNESS MY HAND AND OFFICIAL SEAL THE DAY AND YEAR FIRST ABOVE WRITTEN.

David B. Tiersland

NOTARY PUBLIC IN AND FOR THE STATE OF WASHINGTON, RESIDING AT

MA. Vernon, WA

MY COMMISSION EXPIRES *May 13, 2009*

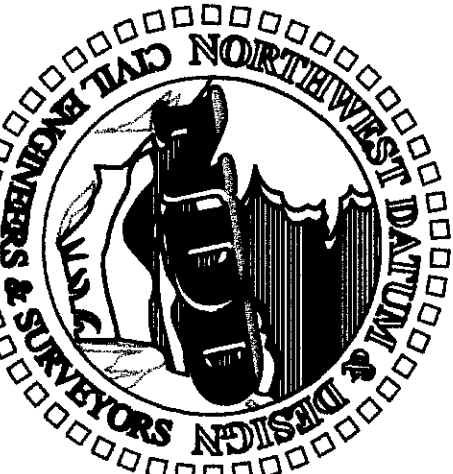
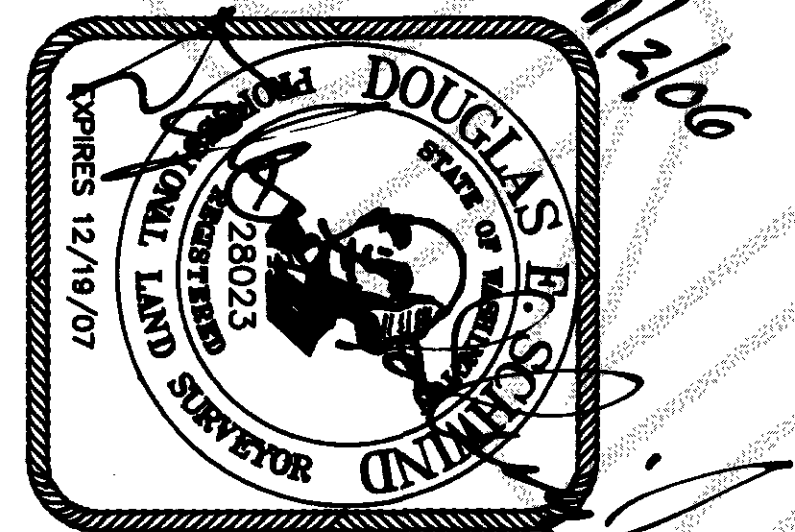
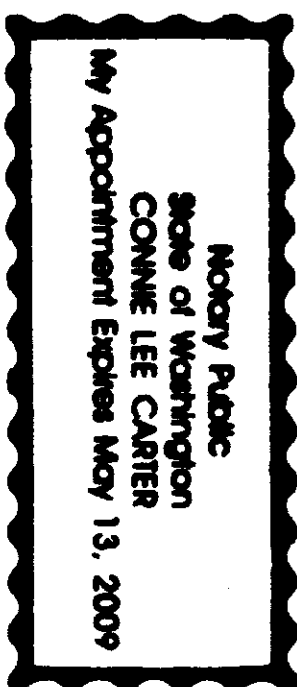

NORTHWEST DATUM & DESIGN
CIVIL ENGINEERING AND SURVEYING SOLUTIONS

1128 E. FAIRHAVEN AVE
BURLINGTON, WASHINGTON 98233
PH: (360) 755-0434 FAX: (360) 755-0464

SHORT PLAT NO. PL06-0757

REXVILLE SHORT PLAT

SURVEY in a portion of the NE 1/4 of
Section 9, T. 33 N., R. 3 E. WM

DAVID B TIERSLAND

In Mount Vernon, Washington

NOTES

1. THE SHORT PLAT NUMBER AND DATE OF APPROVAL SHALL BE INCLUDED IN ALL DEEDS AND CONTRACTS.
 2. NO BUILDING PERMIT SHALL BE ISSUED FOR ANY RESIDENTIAL AND/OR COMMERCIAL STRUCTURES WHICH ARE NOT AT THE TIME OF APPLICATION, DETERMINED TO BE WITHIN AS OFFICIAL DESIGNATED BOUNDARY OF SKAGIT COUNTY FIRE DISTRICT.
 3. CHANGE IN LOCATION OF ACCESS, MAY NECESSITATE CHANGE OF ADDRESS, CONTACT SKAGIT COUNTY PLANNING & DEVELOPMENT SERVICES.
 4. IN NO CASE SHALL THE COUNTY ACCEPT A DEDICATION OR ANY OBLIGATION AS TO ANY SUCH ROAD, STREET, AND/OR ALLEY UNTIL THE SAME AND ALL ROADS, STREETS AND/OR ALLEYS CONNECTING TO THE SAME TO THE FULL, CURRENT COUNTY ROAD SYSTEM HAVE BEEN BROUGHT UP TO FULL COUNTY ROAD STANDARDS AND A RIGHT-OF-WAY DEED HAS BEEN TRANSFERRED TO AND ACCEPTED BY THE COUNTY.
 5. ALL RUNOFF FROM IMPERVIOUS SURFACES, ROOF DRAINS SHALL BE DIRECTED SO AS NOT TO ADVERSELY AFFECT ADJACENT PROPERTIES
 6. THIS PARCEL LIES WITHIN AN AREA OR WITHIN 500 FEET OF AREA DESIGNATED AS A NATURAL RESOURCE LANDS (AGRICULTURAL, FOREST AND MINERAL RESOURCE LANDS OF LONG-TERM COMMERCIAL SIGNIFICANCE) IN SKAGIT COUNTY. A VARIETY OF NATURAL RESOURCE LAND COMMERCIAL ACTIVITIES OCCUR OR MAY OCCUR IN THE AREA THAT MAY NOT BE COMPATIBLE WITH NON-RESOURCE USES AND MAY BE INCONVENIENT OR CAUSE DISCOMFORT TO AREA RESIDENTS. THIS MAY ARISE FROM THE USE OF CHEMICALS, OR FROM SPRAYING, PRUNING, HARVESTING, OR MINERAL EXTRACTION WITH ASSOCIATED ACTIVITIES, WHICH OCCASIONALLY GENERATES TRAFFIC, DUST, SMOKE, NOISE AND ODOR. SKAGIT COUNTY HAS ESTABLISHED NATURAL RESOURCE MANAGEMENT OPERATIONS AS A PRIORITY USE ON DESIGNATED NATURAL RESOURCE LANDS, AND AREA RESIDENTS SHOULD BE PREPARED TO ACCEPT SUCH INCOMPATIBILITIES, INCONVENIENCES, OR DISCOMFORT FROM NORMAL, NECESSARY NATURAL RESOURCE LAND OPERATIONS WHEN PERFORMED IN COMPLIANCE WITH BEST MANAGEMENT PRACTICES AND LOCAL, STATE AND FEDERAL LAW. IN THE CASE OF MINERAL LANDS, APPLICATION MIGHT BE MADE FOR MINING-RELATED ACTIVITIES INCLUDING EXTRACTION, WASHING, CRUSHING, STOCKPILING, BLASTING, TRANSPORTING AND RECYCLING OF MINERALS. IN ADDITION, GREATER SETBACKS THAN TYPICAL MAY BE REQUIRED FROM THE RESOURCE AREA, CONSISTENT WITH SCC 14.16.810. CONTACT THE SKAGIT COUNTY PLANNING AND PERMIT CENTER FOR DETAILS
 7. LOTS 2 AND 3 CONTAIN TWO DIFFERENT ZONING DESIGNATIONS. NO FURTHER LAND DIVISION BASED ON ZONING SHALL OCCUR ON THESE LOTS
 8. ALL AGRICULTURAL ACTIVITY MUST COMPLY WITH SCC 14.24
 9. PROTECTED CRITICAL AREA EASEMENT RECORDED UNDER AUDITOR'S FILE ~~NO. 200707250070~~ USES OF THE PCAE SHALL BE IN ACCORDANCE TO SCC 14.24. CONDITIONS SPECIFIED IN THE ABOVE MENTIONED AUDITOR'S FILE AND ANY COVENANTS, CONDITIONS AND RESTRICTIONS FILED WITH THIS SHORT PLAT.
 10. LAND OWNERS OF THIS PLAT SHALL BEAR THE RESPONSIBILITY TO MAINTAIN THE DRAINAGE FACILITIES OF ROADWAYS, CULVERTS, DITCHES, EROSION CONTROL, APRONS, LININGS AND CHECKDAMS. MAINTENANCE COST SHALL BE BORNE EQUALLY BY ALL LAND OWNERS ON A PRORATA BASIS.
 11. A LOT OF RECORD CERTIFICATION HAS BEEN ISSUED FOR ALL LOTS INCLUDED IN THIS LAND DIVISION. BY WRITIE OF RECORD FOR CONVEYANCE AND ISSUANCE OF THE LOT CERTIFICATION, ALL LOTS HEREIN SHALL BE CONSIDERED LOTS OF SEE ~~AF 200707250070~~
 12. LOT 1 IS LOCATED WITHIN AN A-7 FLOOD HAZARD ZONE PER FIRM MAP 530151 0425C DATED JANUARY 3, 1985. ANY DEVELOPMENT WILL NEED TO COMPLY WITH THE PROVISIONS OF SCC 14.34 FLOOD DAMAGE PREVENTION.
- SETBACKS - SHALL BE PER SCC 14.16.320 (5) (c) & (b) AND SCC 14.16.400 (i)

ZONING RRV
FRONT: 35 FEET
SIDE: 8 FEET IN AN INTERIOR LOT
REAR: 25 FEET
ZONING AG-NRL
RESIDENTIAL
FRONT: 35' MINIMUM, 200' MAXIMUM
SIDE: 8' ADJACENT TO A PROPERTY LINE
REAR: 35'
NON-RESIDENTIAL
FRONT: 35'
SIDE: 15'
REAR: 35'

ZONING: AG-NRL, RRV
WATER: SKAGIT COUNTY PUD #1
SEWER: PRIVATE DRAINFIELDS
POWER: PUGET SOUND & ENERGY COMPANY
GAS: CASCADE NATURAL GAS CORPORATION
CABLE TV: AT&T BROADBAND
TELEPHONE: VERIZON NORTHWEST

ADDRESSES

A SKAGIT COUNTY ADDRESS RANGE HAS BEEN APPLIED TO THE ROAD SYSTEM IN THIS SUBDIVISION. AT THE TIME OF APPLICATION FOR BUILDING AND/OR ACCESS, SKAGIT COUNTY GIS WILL ASSIGN INDIVIDUAL ADDRESSES IN ACCORDANCE WITH THE PROVISIONS OF SKAGIT COUNTY CODE 15.24

A LIST OF ROAD NAMES AND ADDRESS RANGES WITHIN THE SUBDIVISION SHALL ALSO BE DISPLAYED. THIS INFORMATION WILL BE PROVIDED BY SKAGIT COUNTY GIS. PLEASE REFER TO EXAMPLE BELOW.

ROAD NAME	BEGINNING RANGE	ENDING RANGE
BEST ROAD	13782	15001
BROADSHAW ROAD	13626	13275
DODGE VALEY ROAD	12800	14751
REXVILLE GRANGE ROAD	18686	19321

THE EXISTING ADDRESSES OF 19166 AND 19174 REXVILLE GRANGE ROAD WILL REMAIN THE SAME UNLESS THERE IS A CHANGE OF ACCESS

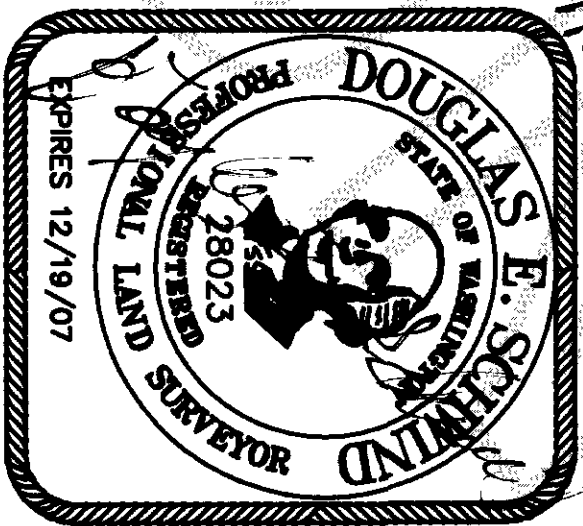

NORTHWEST DATUM & DESIGN
CIVIL ENGINEERING AND SURVEYING SOLUTIONS

1128 E. FAIRHAVEN AVE
BURLINGTON, WASHINGTON 98233
PH: (360) 755-0434 FAX: (360) 755-0464

COUNTY TREASURER'S CERTIFICATE

THIS IS TO CERTIFY THAT ALL TAXES HERETOFORE LEVIED AND WHICH HAVE BECOME A LIEN UPON THE LANDS HEREIN DESCRIBED HAVE BEEN FULLY PAID AND DISCHARGED ACCORDING TO THE RECORDS OF MY OFFICE, UP TO AND INCLUDING THE YEAR OF 2007.

David Dwyer 7-24-07
SKAGIT COUNTY TREASURER DEPUTY



PLANNING DEPARTMENT APPROVAL

EXAMINED AND APPROVED THIS 25th DAY OF July 2007

Pat Dwyer
PLANNING DIRECTOR

COUNTY ENGINEERS APPROVAL

EXAMINED AND APPROVED THIS 18 DAY OF July 2007

W. B. Schindl
COUNTY ENGINEER

COUNTY HEALTH OFFICER

EXAMINED AND APPROVED THIS 19 DAY OF July 2007

W. B. Schindl
COUNTY HEALTH OFFICER

SHORT PLAT NO. PL07-0159

REXVILLE SHORT PLAT

SURVEY in a portion of the NE 1/4 of
Section 9, T. 33 N., R. 3 E. WM

for:

DAVID B TIERSLAND
19166 REXVILLE GRANGE ROAD
Mount Vernon, Washington 98273

PROJECT 03018a
DRAWING 03018a.dwg
DRAWN BY bz
CHECKED BY des
DATE July 2007
SHEET 3 OF 3