

SURVEY DESCRIPTION

PARCEL "A"

LOT 5 AND THE SOUTH 15 FEET OF LOT 6 OF "REYNOLDS ADD," AS PER PLAT RECORDED IN VOLUME 5 OF PLATS, PAGE 23, RECORDS OF SKAGIT COUNTY, WASHINGTON.

PARCEL "B"

THAT PORTION OF THE SOUTHWEST 1/4 OF THE SOUTHEAST 1/4 OF SECTION 20, TOWNSHIP 34 NORTH, RANGE 4 EAST, N.M., DESCRIBED AS FOLLOWS, BEGINNING AT THE SOUTHEAST CORNER OF LOT 5 OF "REYNOLDS ADD," AS PER PLAT RECORDED IN VOLUME 5 OF PLATS, PAGE 23, RECORDS OF SKAGIT COUNTY, WASHINGTON, WHICH IS 274 FEET NORTH OF THE NORTH LINE OF DIGBY ROAD;

THENCE EAST 132 FEET, MORE OR LESS, TO A POINT 16 RODS WEST OF THE EAST LINE OF SAID SOUTHWEST 1/4 OF THE SOUTHEAST 1/4; THENCE NORTH 40 FEET; THENCE WEST 132 FEET, MORE OR LESS, TO A POINT ON THE EAST LINE OF LOT 6, SAID "REYNOLDS ADD," SAID POINT BEING 15 FEET NORTH OF THE SOUTH LINE OF SAID LOT 6;

THENCE SOUTH 40 FEET TO THE POINT OF BEGINNING.

SITUATE IN THE CITY OF MOUNT VERNON, COUNTY OF SKAGIT, STATE OF WASHINGTON.

ALL OF THE ABOVE SUBJECT TO AND TOGETHER WITH EASEMENTS, RESERVATIONS, RESTRICTIONS, COVENANTS, LIENS, LEASES, COURT CAUSES AND OTHER INSTRUMENTS OF RECORD.

NOTES

- INDICATES REBAR SET AND CAPPED WITH YELLOW CAP INSCRIBED LISSER 22460.  
○ INDICATES EXISTING REBAR OR IRON PIPE FOUND.
- SURVEY DESCRIPTION IS FROM STATUTORY WARRANTY DEED DATED APRIL 9, 1985 AND RECORDED UNDER SKAGIT COUNTY AUDITOR'S FILE NO. B504090040.
- FOR ADDITIONAL MERIDIAN AND SURVEY INFORMATION SEE PLAT OF REYNOLDS ADDITION AS PER PLAT RECORDED IN VOLUME 5 OF PLATS, PAGE 23; PLAT OF BROADWAY ADDITION TO MOUNT VERNON AS PER PLAT RECORDED IN VOLUME 6 OF PLATS, PAGE 7 AND MOUNT VERNON SHORT PLAT LU-05-101 RECORDED UNDER AUDITOR'S FILE NO. 200605120054, IN RECORDS OF SKAGIT COUNTY, WASHINGTON.
- BASIS OF BEARING: MONUMENT CENTERLINE OF EAST BROADWAY STREET BETWEEN 16TH AND 18TH STREETS  
BEARING = NORTH 88° 24'30" WEST
- MERIDIAN: ASSUMED
- INSTRUMENTATION: LEICA TCR105A THEODOLITE DISTANCE METER
- SURVEY PROCEDURE: STANDARD FIELD TRAVERSE
- THIS SURVEY WAS PERFORMED AT THE REQUEST OF DENNIS LIND AND JULIE LIND HUSBAND AND WIFE, FOR THE DELINEATION AND STAKING OF THE DESCRIBED PROPERTY, AS SHOWN.
- EXCEPT AS SPECIFICALLY STATED OR SHOWN ON THIS SURVEY MAP, THIS SURVEY DOES NOT PURPORT TO REFLECT ANY OF THE FOLLOWING, WHICH MAY BE APPLICABLE TO THE SUBJECT REAL ESTATE: EASEMENTS, BUILDING SETBACK LINES, RESTRICTIVE COVENANTS, SUBDIVISION, RESTRICTIONS, ZONING OR OTHER LAND-USE REGULATIONS AND ANY OTHER FACTS THAT AN ACCURATE AND CURRENT TITLE SEARCH MAY DISCLOSE.
- THIS SURVEY HAS SHOWN OCCUPATIONAL INDICATORS (FENCES, AND CONCRETE WALL) AS PER IAC CHAPTER 332.130. LINES OF OCCUPATION MAY INDICATE AREAS FOR POTENTIAL CLAIMS OF UNWRITTEN OWNERSHIP. THIS BOUNDARY SURVEY HAS ONLY SHOWN THE RELATIONSHIP OF LINES OF OCCUPATION TO THE DEEDED LINES OF RECORD. NO RESOLUTION OF OWNERSHIP BASED ON UNWRITTEN RIGHTS HAS BEEN MADE OR IMPLIED BY THIS SURVEY.
- ALL DISTANCES SHOWN HEREON ARE IN FEET.

SURVEYOR'S CERTIFICATE

THIS MAP CORRECTLY REPRESENTS A SURVEY MADE BY ME OR UNDER MY DIRECTION IN CONFORMANCE WITH THE REQUIREMENTS OF THE SURVEY RECORDING ACT AT THE REQUEST OF DENNIS A. LIND AND JULIE H. LIND, HUSBAND AND WIFE IN JUNE 2007.

BRUCE G. LISSER, PLS, CERTIFICATE NO. 22460 DATE: June 22, 2007

LISSER & ASSOCIATES, PLLC  
330 WISCONSIN STREET  
P.O. BOX 1104  
MOUNT VERNON, WA 98273  
PHONE (360) 419-1442  
FAX (360) 419-0561  
E-MAIL BRUCE@LISSER.COM

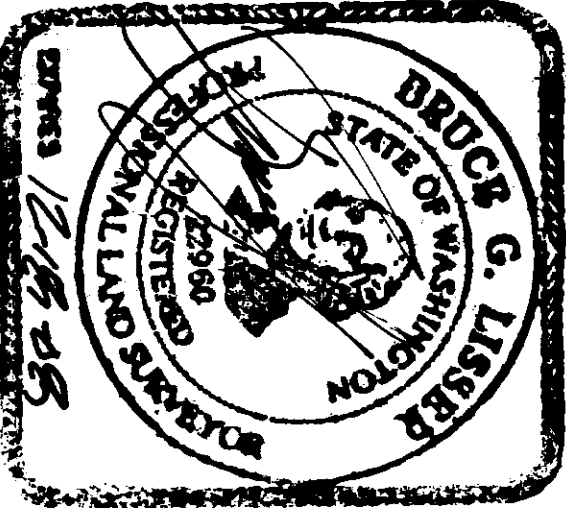

AUDITOR'S CERTIFICATE

FILED FOR RECORD AT THE REQUEST OF LISSER & ASSOCIATES, PLLC.

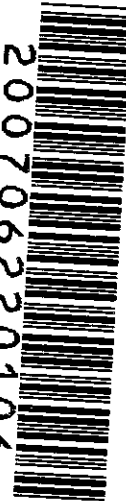

200706220106  
Skagit County Auditor  
6/22/2007 Page 1 of 2 1:50PM

J. H. Hognquist  
SKAGIT COUNTY AUDITOR

James J. Savala  
IDENTITY

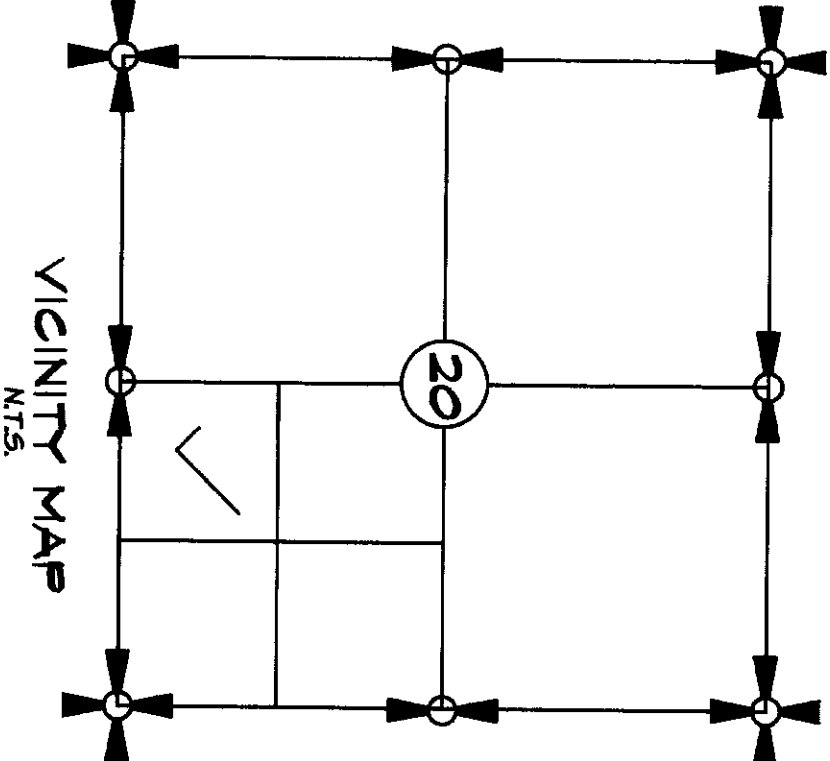

SHEET 1 OF 2

DATE: 6/20/07

SURVEY IN A PORTION OF  
THE SOUTHWEST 1/4 OF THE SOUTHEAST 1/4 OF  
SECTION 20, TOWNSHIP 34 NORTH, RANGE 4 EAST, N.M.  
PLAT OF REYNOLDS ADDITION  
CITY OF MOUNT VERNON, SKAGIT COUNTY, WASHINGTON

FOR: DENNIS AND JULIE LIND

FB 204	PG 44	LISSER & ASSOCIATES, PLLC	SCALE: N/A
MERIDIAN: ASSUMED		SURVEYING & LAND-USE CONSULTATION MOUNT VERNON, WA 98273 360-419-1442	DRAWING: 07-051

