

REVISED DESCRIPTIONS

TRACT "A"

Parcel 1 LOT 1, EXCEPT THE EAST 5 FEET THEREOF, BLOCK 6, SIMLK BEACH, SKAGIT CO., WASH. AS PER PLAT RECORDED IN VOLUME 4 OF PLATS, PAGE 51, RECORDS OF SKAGIT COUNTY, WASHINGTON.

Parcel 2 THE WESTERLY 1/2 OF THE FOLLOWING DESCRIBED PROPERTY:
LOT 2 AND THE EAST 5 FEET OF LOT 1, BLOCK 6, SIMLK BEACH, SKAGIT CO., WASH. AS PER PLAT RECORDED IN VOLUME 4 OF PLATS, PAGE 51, RECORDS OF SKAGIT COUNTY, WASHINGTON.

Parcel 3 THAT PORTION OF GOVERNMENT LOT 1, SECTION 8, TOWNSHIP 34 NORTH, RANGE 2 EAST, W.M., DESCRIBED AS FOLLOWS:
BEGINNING AT THE NORTHWEST CORNER OF LOT 1, BLOCK 6, SIMLK BEACH, SKAGIT CO., WASH. AS PER PLAT RECORDED IN VOLUME 4 OF PLATS, PAGE 51, RECORDS OF SKAGIT COUNTY, WASHINGTON;
THENCE SOUTH 73°50'50" WEST 37.91 FEET ALONG THE WESTERLY EXTENSION OF THE NORTHERLY LINE OF SAID LOT 1;
THENCE SOUTH 00°21'10" EAST 145.00 FEET PARALLEL, WITH THE WEST LINE OF SAID LOT 1;
THENCE NORTH 77°01'44" EAST 135.75 FEET TO THE SOUTHERLY EXTENSION OF THE EAST LINE OF THAT CERTAIN PARCEL, C DESCRIBED IN AUDITOR'S FILE NO. 200112190124, RECORDS OF SKAGIT COUNTY, WASHINGTON (ALSO SHOWN AS PARCEL 2 ABOVE);
THENCE NORTH 00°21'10" WEST 30.00 FEET ALONG SAID SOUTHERLY EXTENSION TO THE SOUTHEAST CORNER THEREOF AND THE SOUTH LINE OF LOT 2, BLOCK 6, SIMLK BEACH, SKAGIT CO., WASH.;
THENCE WESTERLY ALONG THE SOUTH LINE OF SAID LOT 2, TO THE SOUTHEAST CORNER OF SAID LOT 1;
THENCE WESTERLY AND NORTHERLY ALONG THE SOUTHERLY AND WESTERLY LINES OF SAID LOT 1 TO THE POINT OF BEGINNING.

SITUATE IN THE COUNTY OF SKAGIT, STATE OF WASHINGTON.

TRACT "B"

THAT PORTION OF GOVERNMENT LOT 1, SECTION 8, TOWNSHIP 34 NORTH, RANGE 2 EAST, W.M., DESCRIBED AS FOLLOWS:
BEGINNING AT THE NORTHWEST CORNER OF LOT 1, BLOCK 6, SIMLK BEACH, SKAGIT CO., WASH. AS PER PLAT RECORDED IN VOLUME 4 OF PLATS, PAGE 51, RECORDS OF SKAGIT COUNTY, WASHINGTON;
THENCE SOUTH 73°50'50" WEST 37.91 FEET ALONG THE WESTERLY EXTENSION OF THE NORTHERLY LINE OF SAID LOT 1 TO THE TRUE POINT OF BEGINNING;
THENCE CONTINUE SOUTH 73°50'50" WEST 180.00 FEET;
THENCE SOUTH 00°21'10" EAST 135.00 FEET PARALLEL, WITH THE WEST LINE OF SAID LOT 1;
THENCE NORTH 76°57'14" EAST 177.54 FEET TO A POINT THAT IS SOUTH 00°21'10" EAST FROM THE TRUE POINT OF BEGINNING;
THENCE NORTH 00°21'10" WEST 145.00 FEET TO THE TRUE POINT OF BEGINNING.

SITUATE IN THE COUNTY OF SKAGIT, STATE OF WASHINGTON.

TRACT "C"

THAT PORTION OF GOVERNMENT LOT 1, SECTION 8, TOWNSHIP 34 NORTH, RANGE 2 EAST, W.M., LYING SOUTHERLY OF THE SATTERLEE ROAD AND LYING EASTERLY OF THE FOLLOWING DESCRIBED LINE:
BEGINNING AT THE NORTHWEST CORNER OF LOT 1, BLOCK 6, SIMLK BEACH, SKAGIT CO., WASH. AS PER PLAT RECORDED IN VOLUME 4 OF PLATS, PAGE 51, RECORDS OF SKAGIT COUNTY, WASHINGTON;
THENCE SOUTH 73°50'50" WEST 819.85 FEET ALONG THE SOUTHERLY MARGIN OF SAID SATTERLEE ROAD AND THE WESTERLY EXTENSION OF THE NORTHERLY LINE OF SAID LOT 1 TO THE TRUE POINT OF BEGINNING OF SAID LINE;
THENCE SOUTH 16°11'14" EAST TO THE SOUTHERLY LINE OF SAID GOVERNMENT LOT 1 AND THE TERMINUS OF SAID LINE.

EXCEPT THAT PORTION PLATTED AS SIMLK BEACH, SKAGIT CO., WASH. AS PER PLAT RECORDED IN VOLUME 4 OF PLATS, PAGE 51, RECORDS OF SKAGIT COUNTY, WASHINGTON, AND

ALSO EXCEPT THAT PORTION OF GOVERNMENT LOT 1, SECTION 8, TOWNSHIP 34 NORTH, RANGE 2 EAST, W.M., DESCRIBED AS FOLLOWS:
BEGINNING AT THE NORTHWEST CORNER OF LOT 1, BLOCK 6, SIMLK BEACH, SKAGIT CO., WASH. AS PER PLAT RECORDED IN VOLUME 4 OF PLATS, PAGE 51, RECORDS OF SKAGIT COUNTY, WASHINGTON;
THENCE SOUTH 73°50'50" WEST 37.91 FEET ALONG THE WESTERLY EXTENSION OF THE NORTHERLY LINE OF SAID LOT 1;
THENCE SOUTH 00°21'10" EAST 145.00 FEET PARALLEL, WITH THE WEST LINE OF SAID LOT 1;
THENCE NORTH 77°01'44" EAST 135.75 FEET TO THE SOUTHERLY EXTENSION OF THE EAST LINE OF THAT CERTAIN PARCEL, C DESCRIBED IN AUDITOR'S FILE NO. 200112190124, RECORDS OF SKAGIT COUNTY, WASHINGTON;
THENCE NORTH 00°21'10" WEST 30.00 FEET ALONG SAID SOUTHERLY EXTENSION TO THE SOUTHEAST CORNER THEREOF AND THE SOUTH LINE OF LOT 2, BLOCK 6, SIMLK BEACH, SKAGIT CO., WASH.;
THENCE WESTERLY ALONG THE SOUTH LINE OF SAID LOT 2, TO THE SOUTHEAST CORNER OF SAID LOT 1;
THENCE WESTERLY AND NORTHERLY ALONG THE SOUTHERLY AND WESTERLY LINES OF SAID LOT 1 TO THE POINT OF BEGINNING, AND

ALSO EXCEPT THAT PORTION OF GOVERNMENT LOT 1, SECTION 8, TOWNSHIP 34 NORTH, RANGE 2 EAST, W.M., DESCRIBED AS FOLLOWS:
BEGINNING AT THE NORTHWEST CORNER OF LOT 1, BLOCK 6, SIMLK BEACH, SKAGIT CO., WASH. AS PER PLAT RECORDED IN VOLUME 4 OF PLATS, PAGE 51, RECORDS OF SKAGIT COUNTY, WASHINGTON;
THENCE SOUTH 73°50'50" WEST 37.91 FEET ALONG THE WESTERLY EXTENSION OF THE NORTHERLY LINE OF SAID LOT 1 TO THE TRUE POINT OF BEGINNING;
THENCE CONTINUE SOUTH 73°50'50" WEST 180.00 FEET;
THENCE SOUTH 00°21'10" EAST 135.00 FEET PARALLEL, WITH THE WEST LINE OF SAID LOT 1;
THENCE NORTH 76°57'14" EAST 177.54 FEET TO A POINT THAT IS SOUTH 00°21'10" EAST FROM THE TRUE POINT OF BEGINNING;
THENCE NORTH 00°21'10" WEST 145.00 FEET TO THE TRUE POINT OF BEGINNING.

SITUATE IN THE COUNTY OF SKAGIT, STATE OF WASHINGTON.

BOUNDARY LINE ADJUSTMENT

REVIEWED AND APPROVED IN ACCORDANCE WITH SCC CHAPTER 14.18.700 ON

May 10, 2005
Sharon B. Bledsoe
SKAGIT COUNTY PLANNING & SURVEYING
Senior Planner

TRACT "D"

GOVERNMENT LOT 2, SECTION 8, TOWNSHIP 34 NORTH, RANGE 2 EAST, W.M.,

EXCEPT ROADS,

ALSO EXCEPT THE PLAT OF SIMLK HIGHLANDS, DIV. 1, AS PER PLAT RECORDED IN VOLUME 10 OF PLATS, PAGE 15, RECORDS OF SKAGIT COUNTY, WASHINGTON,

ALSO EXCEPT THAT PORTION LYING SOUTHERLY OF THE EASTERLY PROJECTION OF THE SOUTHERLY LINE OF TRACT "B" OF SAID PLAT OF SIMLK HIGHLANDS, DIV. 1, AS PER PLAT RECORDED IN VOLUME 10 OF PLATS, PAGE 15, RECORDS OF SKAGIT COUNTY, WASHINGTON,

ALSO EXCEPT THE PLAT OF SIMLK BEACH, AS PER PLAT RECORDED IN VOLUME 4 OF PLATS, PAGE 51, RECORDS OF SKAGIT COUNTY, WASHINGTON,

ALSO EXCEPT THE PLAT OF BEACH VIEW ADDITION TO SIMLK BEACH, AS PER PLAT RECORDED IN VOLUME 5 OF PLATS, PAGE 6, RECORDS OF SKAGIT COUNTY, WASHINGTON,

ALSO EXCEPT THAT PORTION OF SAID GOVERNMENT LOT 2, DESCRIBED AS FOLLOWS:

BEGINNING AT THE MOST SOUTHERLY CORNER OF LOT 1, BLOCK 1, SIMLK BEACH, AS PER PLAT RECORDED IN VOLUME 4 OF PLATS, PAGE 51, RECORDS OF SKAGIT COUNTY, WASHINGTON;
THENCE NORTH 31°22'54" EAST ALONG THE SOUTHEASTERLY LINE OF SAID LOT 1, A DISTANCE OF 43.30 FEET TO THE TRUE POINT OF BEGINNING;
THENCE SOUTH 58°37'08" EAST A DISTANCE OF 11.80 FEET;
THENCE NORTH 23°22'52" EAST A DISTANCE OF 31.00 FEET;
THENCE NORTH 58°37'08" WEST A DISTANCE OF 7.5 FEET TO THE SOUTHEASTERLY LINE OF SAID LOT 1;
THENCE SOUTH 31°22'52" WEST ALONG THE SOUTHEASTERLY LINE OF SAID LOT 1, A DISTANCE OF 30.70 FEET TO THE TRUE POINT OF BEGINNING.

ALSO EXCEPT THAT PORTION OF SAID GOVERNMENT LOT 2, DESCRIBED AS FOLLOWS:

BEGINNING AT THE MOST SOUTHERLY CORNER OF LOT 1, BLOCK 1, "SIMLK BEACH", AS PER PLAT RECORDED IN VOLUME 4 OF PLATS, AT PAGE 51, RECORDS OF SKAGIT COUNTY, WASHINGTON,
THENCE NORTH 31°22'54" EAST ALONG THE SOUTHEASTERLY LINE OF SAID LOT 1, A DISTANCE OF 43.30 FEET;
THENCE SOUTH 58°37'06" EAST, A DISTANCE OF 11.80 FEET TO THE POINT OF BEGINNING OF THIS DESCRIPTION;
THENCE CONTINUING SOUTH 58°37'06" EAST, A DISTANCE OF 17.80 FEET;
THENCE NORTH 37°26'57" EAST, A DISTANCE OF 75.28 FEET;
THENCE NORTH 58°37'06" WEST, A DISTANCE OF 37.55 FEET TO THE SOUTHEASTERLY LINE OF SAID LOT 1;
THENCE SOUTH 31°22'54" WEST ALONG THE SOUTHEASTERLY LINE OF SAID LOT 1, A DISTANCE OF 44.16 FEET;
THENCE SOUTH 58°37'06" EAST, A DISTANCE OF 7.5 FEET;
THENCE SOUTH 23°22'52" WEST, A DISTANCE OF 31.00 FEET TO THE POINT OF BEGINNING OF THIS DESCRIPTION,

ALSO EXCEPT THAT PORTION OF SAID GOVERNMENT LOT 2, SECTION 8, TOWNSHIP 34 NORTH, RANGE 2 EAST, W.M., LYING WESTERLY AND NORTHWESTERLY OF THE FOLLOWING DESCRIBED LINE:
BEGINNING AT THE NORTHEAST CORNER OF LOT 28, BEACH VIEW ADDITION TO SIMLK BEACH, AS PER PLAT RECORDED IN VOLUME 5 OF PLATS, PAGE 6, RECORDS OF SKAGIT COUNTY, WASHINGTON;
THENCE SOUTHERLY 15 FEET ALONG THE EASTERLY LINE OF SAID LOT 28 TO THE SOUTHWEST CORNER OF MASHEE STREET AS SHOWN ON SAID BEACH VIEW ADDITION TO SIMLK BEACH AND THE TRUE POINT OF BEGINNING OF SAID LINE;
THENCE SOUTH 04°40'57" WEST 470 FEET, MORE OR LESS, TO THE NORTHERLY LINE OF TRACT "B", PLAT OF SIMLK HIGHLANDS, DIV. 1, AS PER PLAT THEREOF RECORDED IN VOLUME 10 OF PLATS, PAGE 15, RECORDS OF SKAGIT COUNTY, WASHINGTON, AND THE TERMINUS OF SAID LINE.

ALSO EXCEPT ANY PORTION OF GOVERNMENT LOT 2, SECTION 8, TOWNSHIP 34 NORTH, RANGE 2 EAST, W.M., LYING NORTHERLY OF SATTERLY ROAD.

ALSO EXCEPT THAT PORTION OF GOVERNMENT LOT 2, SECTION 8, TOWNSHIP 34 NORTH, RANGE 2 EAST, W.M., DESCRIBED AS FOLLOWS:
BEGINNING AT THE NORTHEAST CORNER OF LOT 1, BLOCK 5, SIMLK BEACH, SKAGIT CO., WASH. AS PER PLAT RECORDED IN VOLUME 4 OF PLATS, PAGE 51, RECORDS OF SKAGIT COUNTY, WASHINGTON;
THENCE SOUTHERLY AND WESTERLY ALONG THE EASTERLY AND SOUTHERLY LINES OF SAID LOT 1, BLOCK 5, TO THE SOUTHWEST CORNER OF SAID LOT 1, BLOCK 5;
THENCE SOUTH 28°04'32" EAST 60.00 FEET;
THENCE NORTH 54°24'15" EAST 172.06 FEET;
THENCE NORTH 02°26'04" WEST 220.00 FEET TO THE SOUTHERLY MARGIN OF SATTERLEE ROAD;
THENCE NORTHWESTERLY ALONG SAID SOUTHERLY MARGIN TO THE NORTHEAST CORNER OF THE ALLEY ALONG THE EASTERLY SIDE OF SAID BLOCK 5;

THENCE SOUTHERLY ALONG THE EASTERLY LINE OF SAID ALLEY TO THE SOUTHEASTERLY CORNER THEREOF;
THENCE WESTERLY ALONG SAID ALLEY TO THE POINT OF BEGINNING.

TOGETHER WITH THAT PORTION OF GOVERNMENT LOT 1, SECTION 8, TOWNSHIP 34 NORTH, RANGE 2 EAST, W.M., LYING SOUTHERLY OF THE SATTERLEE ROAD AND LYING WESTERLY OF THE FOLLOWING DESCRIBED LINE:
BEGINNING AT THE NORTHWEST CORNER OF LOT 1, BLOCK 5, SIMLK BEACH, SKAGIT CO., WASH. AS PER PLAT RECORDED IN VOLUME 4 OF PLATS, PAGE 51, RECORDS OF SKAGIT COUNTY, WASHINGTON;
THENCE SOUTH 73°50'50" WEST 819.85 FEET ALONG THE SOUTHERLY MARGIN OF SAID SATTERLEE ROAD AND THE WESTERLY EXTENSION OF THE NORTHERLY LINE OF SAID LOT 1 TO THE TRUE POINT OF BEGINNING OF SAID LINE;
THENCE SOUTH 16°11'14" EAST TO THE SOUTHERLY LINE OF SAID GOVERNMENT LOT 1 AND THE TERMINUS OF SAID LINE.

SITUATE IN THE COUNTY OF SKAGIT, STATE OF WASHINGTON.

TRACT "E"

LOT 1, BLOCK 5, SIMLK BEACH, SKAGIT CO., WASH. AS PER PLAT RECORDED IN VOLUME 4 OF PLATS, PAGE 51, RECORDS OF SKAGIT COUNTY, WASHINGTON, AND

THAT PORTION OF GOVERNMENT LOT 2, SECTION 8, TOWNSHIP 34 NORTH, RANGE 2 EAST, W.M., DESCRIBED AS FOLLOWS:
BEGINNING AT THE NORTHEAST CORNER OF SAID LOT 1, BLOCK 5,
THENCE SOUTHERLY AND WESTERLY ALONG THE EASTERLY AND SOUTHERLY LINES OF SAID LOT 1, BLOCK 5, TO THE SOUTHWEST CORNER OF SAID LOT 1, BLOCK 5;

THENCE SOUTH 28°04'32" EAST 60.00 FEET;
THENCE NORTH 54°24'15" EAST 172.06 FEET;
THENCE NORTH 02°26'04" WEST 220.00 FEET TO THE SOUTHERLY MARGIN OF SATTERLEE ROAD;
THENCE NORTHWESTERLY ALONG SAID SOUTHERLY MARGIN TO THE NORTHEAST CORNER OF THE ALLEY ALONG THE EASTERLY SIDE OF SAID BLOCK 5;
THENCE SOUTHERLY ALONG THE EASTERLY LINE OF SAID ALLEY TO THE SOUTHEASTERLY CORNER THEREOF;
THENCE WESTERLY ALONG SAID ALLEY TO THE POINT OF BEGINNING.

AUDITOR'S CERTIFICATE



200705300077
Skagit County Auditor

5/30/2007 Page 1 of 2 1:35PM

AT THE REQUEST OF SEMRAU ENGINEERING & SURVEYING P.L.L.C.,

J. J. J. J.
SKAGIT COUNTY AUDITOR

Myra L. J.
DEPUTY

NOTES

1. INDICATES IRON REBAR SET WITH YELLOW CAP - SURVEY NUMBER SEMRAU 28626.
2. THE DESCRIPTION FOR THIS SURVEY IS FROM QUIT CLAIM DEED AF NO. 9612190027 BOUNDARY LINE ADJUSTMENT, AF NO. 199911120061, AND SUBDIVISION GUARANTEES BY LAND TITLE CO. ORDER NO. 114860-P, DATED DECEMBER 16, 2004, AND ORDER NO. 114860-PA, DATED JANUARY 4, 2005.
3. BASIS OF BEARING: MONUMENTS FOUND IN GIBRALTER ROAD ON N-S CENTERLINE OF SECTION 9-34-2. BEARING = S 02°25'30" E.
4. ALL DISTANCES ARE SHOWN IN FEET.
5. INSTRUMENTATION: LEICA TCA 1105 THEODOLITE DISTANCE METER.
6. SURVEY PROCEDURE: STANDARD FIELD TRAVERSE.
7. THIS SURVEY WAS REQUESTED BY MORGAN-TURNER PROPERTIES, LP
8. THIS SURVEY MAY SHOW OCCUPATIONAL INDICATORS AS PER W.A.C. CHAPTER 332.130. LINES OF OCCUPATION MAY INDICATE AREAS FOR POTENTIAL CLAIMS OF UNWRITTEN OWNERSHIP. THIS BOUNDARY SURVEY HAS ONLY SHOWN THE RELATIONSHIP OF LINES OF OCCUPATION TO THE DEEDED LINES OF RECORD. NO RESOLUTION OF OWNERSHIP BASED ON UNWRITTEN RIGHTS HAS BEEN MADE OR IMPLIED BY THIS SURVEY.
9. EXCEPT AS SPECIFICALLY STATED OR SHOWN ON THIS SURVEY MAP, THIS SURVEY DOES NOT purPORT TO REFLECT ALL OF THE FOLLOWING WHICH MAY BE APPLICABLE TO THE SUBJECT REAL ESTATE: EASEMENTS, BUILDING SETBACKS LINES, RESTRICTIVE COVENANTS, SUBDIVISION RESTRICTIONS, ZONING OR OTHER LAND-USE REGULATIONS AND ANY OTHER FACTS.
10. THIS PROPERTY IS SUBJECT TO EASEMENTS, RESERVATIONS, RESTRICTIONS, COVENANTS, LIENS AND OTHER INSTRUMENTS OF RECORD INCLUDING BUT NOT LIMITED TO THOSE INSTRUMENTS DESCRIBED IN THE TITLE REPORTS MENTIONED IN NOTE NUMBER 2 ABOVE AND BEING RECORDED UNDER SKAGIT COUNTY AUDITOR'S FILE NUMBERS 8412260009, 208005, 231907, RESTRICTIVE COVENANTS IN DEEDS FROM SIMLK BEACH DEVELOPMENT COMPANY, 9704110097, 199911120061, 200409290083 AND 784016.

SURVEYOR'S CERTIFICATE

THIS MAP CORRECTLY REPRESENTS A SURVEY MADE BY ME OR UNDER MY DIRECTION IN CONFORMANCE WITH THE REQUIREMENTS OF THE SURVEY RECORDING ACT AT THE REQUEST OF MORGAN-TURNER PROPERTIES, L.L.P.

J. B. J. B.
JOHN B. SEMRAU, P.E., P.L.S., CERTIFICATE NO. 28626
SEMRAU ENGINEERING & SURVEYING, P.L.L.C.
2118 RIVERSIDE DRIVE SUITE 104
MOUNT VERNON, WA 98273
PHONE 360-424-9566

DATE: 5-30-07

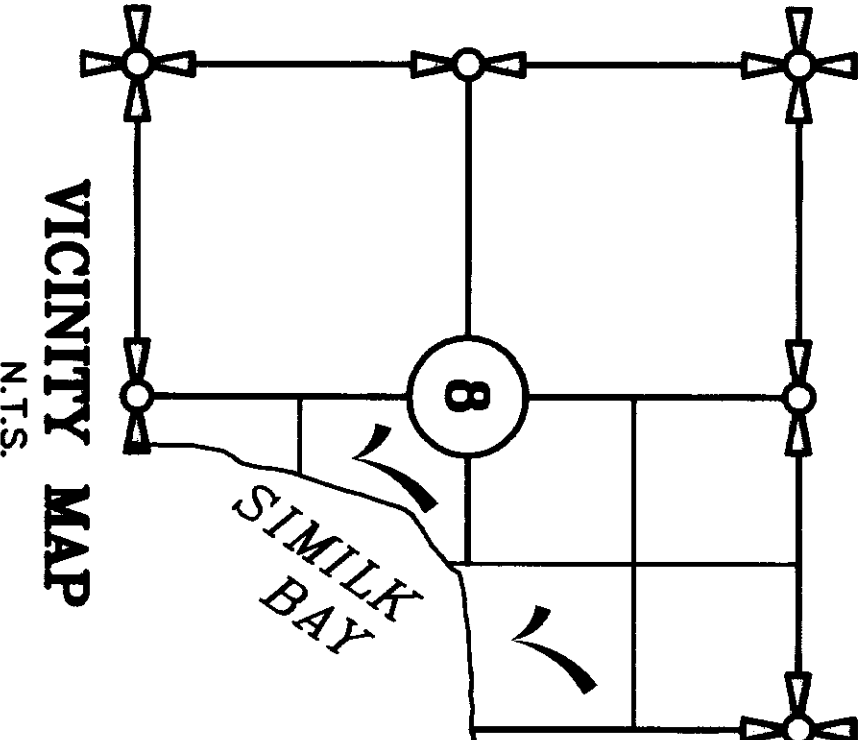
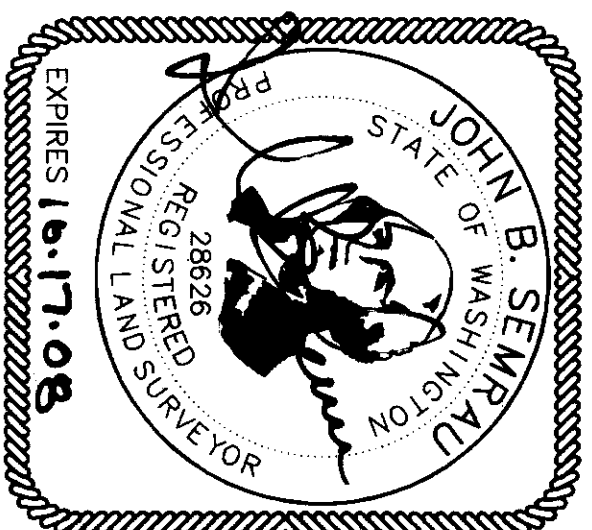

SHEET 1 OF 2

RE-SURVEY OF TRACTS A, B, C, D AND E,
OF BOUNDARY LINE ADJUSTMENT,
AUDITOR'S FILE NO. 200505110080,
IN A PORTION OF GOVERNMENT LOTS 1 AND 2
SECTION 8, T. 34 N., R. 2 E., W.M.
SKAGIT COUNTY, WASHINGTON
FOR: MORGAN-TURNER PROPERTIES, L.L.P.

FB.	PG.	SEMRAU ENGINEERING & SURVEYING	SCALE: 1" = 100'
MERIDIAN:	ASSUMED	SURVEYING • PLANNING	JOB NO. . 4478
		MOUNT VERNON, WA 98273	360-424-9566



SURVEY INFORMATION SHOWN HEREON MAY BE DIFFERENT THAN DIMENSIONS AND BEARINGS SHOWN ON BOUNDARY LINE ADJUSTMENT RECORDED AS AUDITOR'S FILE NO. 200505110080. RECORDS OF SKAGIT COUNTY, WASHINGTON, THE DESCRIPTIONS SHOWN HEREON HAVE BEEN REVISED TO REFLECT THE FIELD CONDITIONS.

1" = 50'

SHEET 2 OF 2

DRAWING FILE: 4478BLA-2.DWG 5/30/07

RE-SURVEY OF TRACTS A, B, C, D AND E,
OF BOUNDARY LINE ADJUSTMENT,
AUDITOR'S FILE NO. 200505110080,
IN A PORTION OF GOVERNMENT LOTS 1 AND 2
SECTION 8, T. 34 N., R. 2 E., W.M.
SKAGIT COUNTY, WASHINGTON
FOR: MORGAN-TURNER PROPERTIES, L.L.P.

FB. Pg.	SEMARU ENGINEERING & SURVEYING SURVEYING • ENGINEERING • PLANNING MOUNT VERNON, WA 98273 360-424-9566	SCALE: 1" = 100'
MERIDIAN: ASSUMED		JOB NO. 4478