

Return to:

JOHN COOPER



200705020088

Skagit County Auditor

5/2/2007 Page 1 of 2 1:38PM

PROTECTED CRITICAL AREA SITE PLAN

Page 1 of 2

Grantor/Owner: W. PAUL BORGEN

Grantee: PUBLIC

Site Address: 17444 BRITT ROAD

Property ID #: P 29249 Assessors Tax Account #: 340431-0-003-0105

Legal Description: Sec. 31 Twp. 34 Rng. 4 / Plat Name _____ Lot _____

Permit/Activity #: PL07-0327

The PROTECTED CRITICAL AREA (PCA) is to be left undisturbed in its natural state. "With the exception of activities identified as Allowed without Standard review under SCC 14.24.100, any land-use activity that can impair the functions and values of critical areas or their buffers through a development activity or by disturbance of the soil or water, and/or by removal of, or damage to, existing vegetation shall require critical areas review and written authorization pursuant to SCC 14.24." SCC 14.24.060 No clearing, grading, filling, logging or removal of woody material, building, construction or road construction of any kind, planting of non-native vegetation or grazing of livestock is allowed within the PCA areas except as specifically permitted by Skagit County on a case-by-case basis consistent with SCC 14.24.

Representations on this site plan may be approximations only and should not be used for purposes other than for determining general locations of critical areas. Development activities beyond the scope of this plan may require additional studies and approvals.

The above references to "Grantor" and "Grantee" shall not be construed as a transfer of property ownership and are used solely for filing with the County Auditor.

Owner: [Signature] Date: 5/1/07

On this day personally appeared before me W. Paul Borgen known to be the individual described herein and acknowledged to me that he signed the same as his free and voluntary act and deed for the uses and purposes therein mentioned.

Melissa A. Shroyer Notary Public in and for the State of Washington, residing at Burlington, WA Date: 05/1/07



PROTECTED CRITICAL AREA SITE PLAN

Page 2 of 2

Applicant: Borgee

Permit #: AL07-0327

Parcel #: A29249

Site Address: 17459 BRITT RD, MT. VERMONT

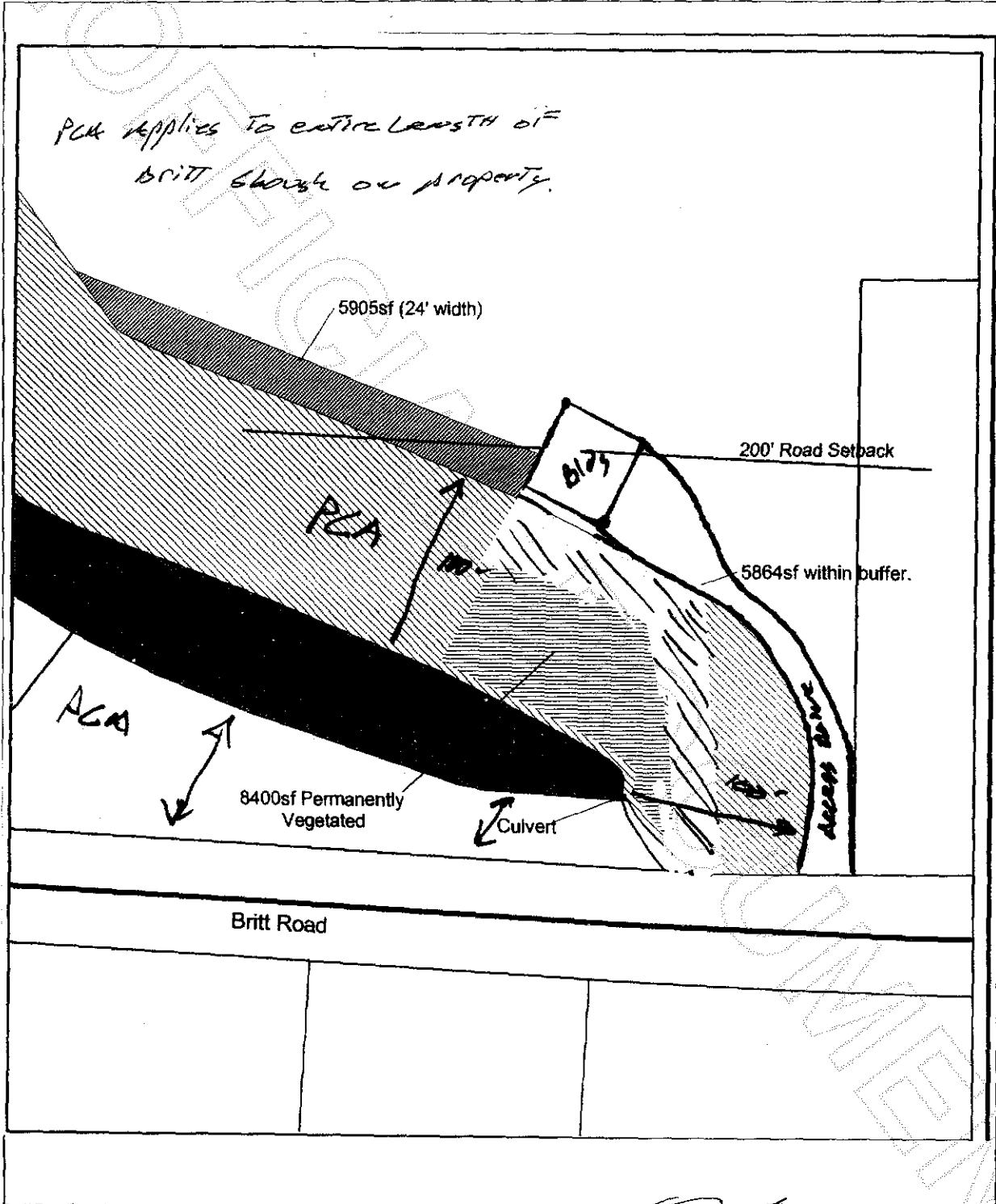

[Signature]
Skagit County CAO Staff Signature

4-20-07
Date

[Signature] 4/20/07
Applicant Signature



200705020088
Skagit County Auditor