

Return Name & Address:



200704120125  
Skagit County Auditor

4/12/2007 Page 1 of 2 2:26PM

SKAGIT COUNTY PLANNING & DEVELOPMENT SERVICES

**PLAT LOT OF RECORD CERTIFICATION**

File Number: BP07-0388/SW07-0198

Applicant Name: Wendell & Kathleen Phillips

Property Owner Name: Wendell & Kathleen Phillips

The Department hereby finds that Lot(s) 7 of Carmelo Estates recorded on Sept. 15<sup>th</sup>, 1977 under AF# 864778.

Parcel Number(s): P32824

**1. CONVEYANCE**

- ☒ **IS/ARE**, Lot(s) of Record as defined in Skagit County Code (SCC) 14.04.020 and therefore **IS/ARE** eligible for conveyance.

**2. DEVELOPMENT**

- ☒ **IS/ARE**, the minimum lot size required for the Rural Intermediate (RI) zoning district in which the lot(s) is/are located and therefore **IS/ARE** eligible to be considered for development permits.
- ☐ **IS/ARE NOT**, the minimum lot size required for the \_\_\_\_\_ zoning district in which the lot(s) is/are located, but does meet an exemption listed in SCC 14.16.850(4)(c) \_\_\_\_\_ and therefore **IS/ARE** eligible to be considered for development permits.

Authorized Signature: \_\_\_\_\_

*Tina Wright*  
See attached map for Lot of Record boundaries.

Date: 04/11/07

Lot Certification

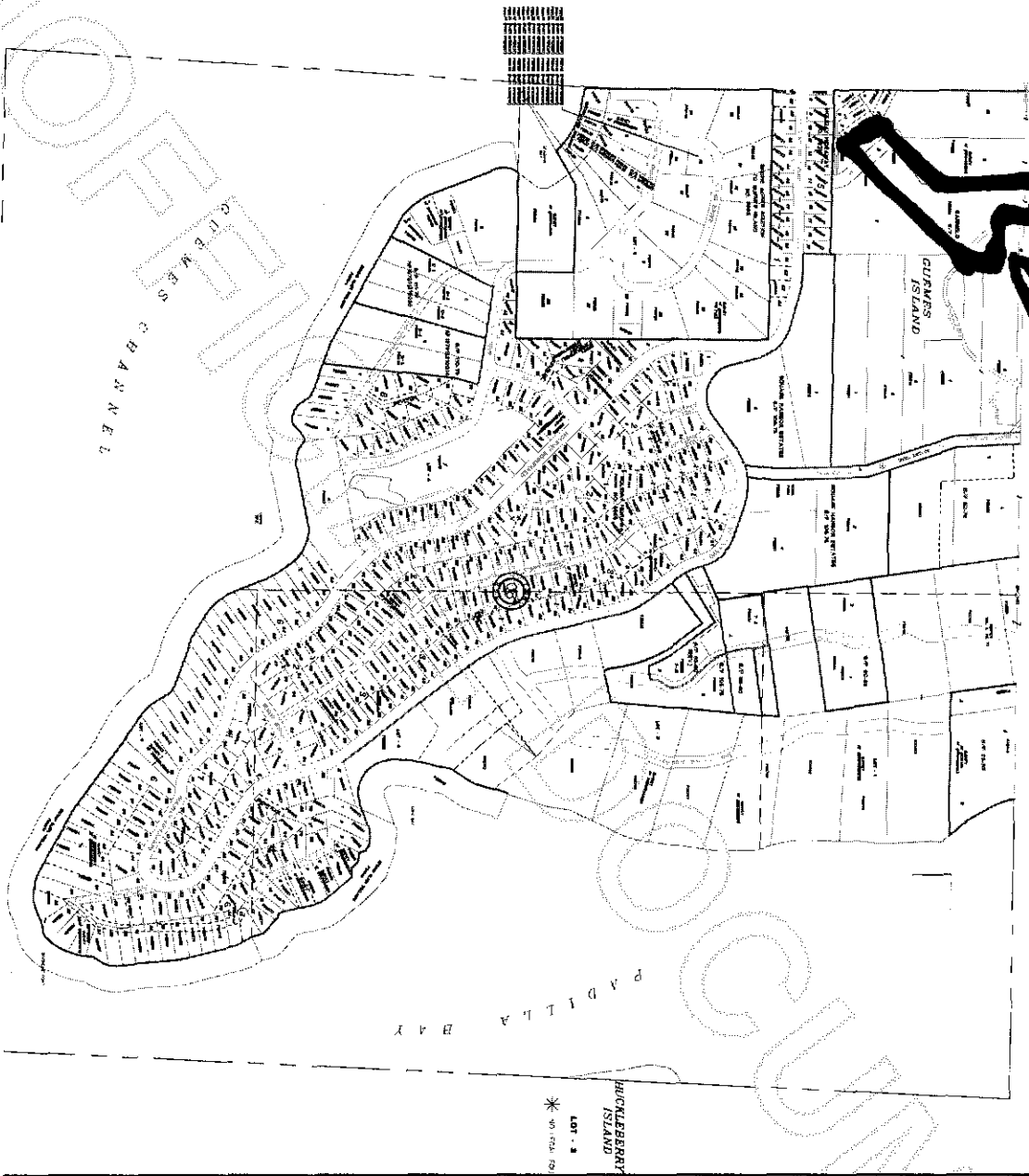

SKAGIT COUNTY

1	2	3	4	5	6	7	8	9	10	11	12
13	14	15	16	17	18	19	20	21	22	23	24
25	26	27	28	29	30	31	32	33	34	35	36

T 33 N R 02 E

**\* ATTENTION \***  
 THIS MAP CONTAINS A LARGE NUMBER OF LOTS. THE LOTS ARE IDENTIFIED BY A NUMBER IN THE CORNER OF THE LOT.

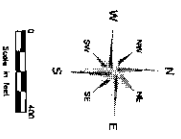

**\* THIS MAP IS NOT A SUBSTITUTE FOR FIELD SURVEY \***  
 This map was prepared from a survey of the land shown. It is not a substitute for a field survey. The survey was conducted by a licensed surveyor and the map was prepared by a licensed mapmaker. The map is not a substitute for a field survey.

DATE	INT.
DRAWN BY	1/1/78
REVIEWED	1/1/78
PLOTTED	1/1/78

Section 8



200704120125  
 Skagit County Auditor