

Return to:



200701090103

Skagit County Auditor

1/9/2007 Page 1 of 2 1:25PM

PROTECTED CRITICAL AREA SITE PLAN

Page 1 of 2

Grantor/Owner: DANIEL & MARTHA WALL

Grantee: PUBLIC

Site Address: 9343 SAMISH ISLANDS ROAD

Property ID #: P 47247

Assessors Tax Account #: 360227-0-048-0009

Legal Description: Sec. 27 Twp. 36 Rng. 2 / Plat Name - Lot -

Permit/Activity #: SPCL 1217

The PROTECTED CRITICAL AREA (PCA) is to be left undisturbed in its natural state. "With the exception of activities identified as Allowed without Standard review under SCC 14.24.100, any land-use activity that can impair the functions and values of critical areas or their buffers through a development activity or by disturbance of the soil or water, and/or by removal of, or damage to, existing vegetation shall require critical areas review and written authorization pursuant to SCC 14.24." SCC 14.24.060 No clearing, grading, filling, logging or removal of woody material, building, construction or road construction of any kind, planting of non-native vegetation or grazing of livestock is allowed within the PCA areas except as specifically permitted by Skagit County on a case-by-case basis consistent with SCC 14.24.

Representations on this site plan may be approximations only and should not be used for purposes other than for determining general locations of critical areas. Development activities beyond the scope of this plan may require additional studies and approvals.

The above references to "Grantor" and "Grantee" shall not be construed as a transfer of property ownership and are used solely for filing with the County Auditor.

Owner: Martha Wall

Date: 1-8-07

On this day personally appeared before me MARTHA WALL known to be the individual described herein and acknowledged to me that SITE signed the same as ITEL free and voluntary act and deed for the uses and purposes therein mentioned.

Shawnee Bosman, Notary Public in and for the State of Washington,

residing at MOUNT WENDELL WA

Date: 1/08/07

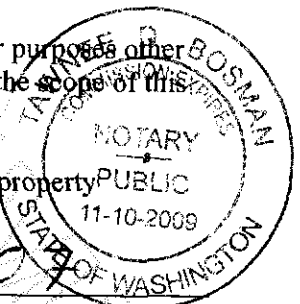

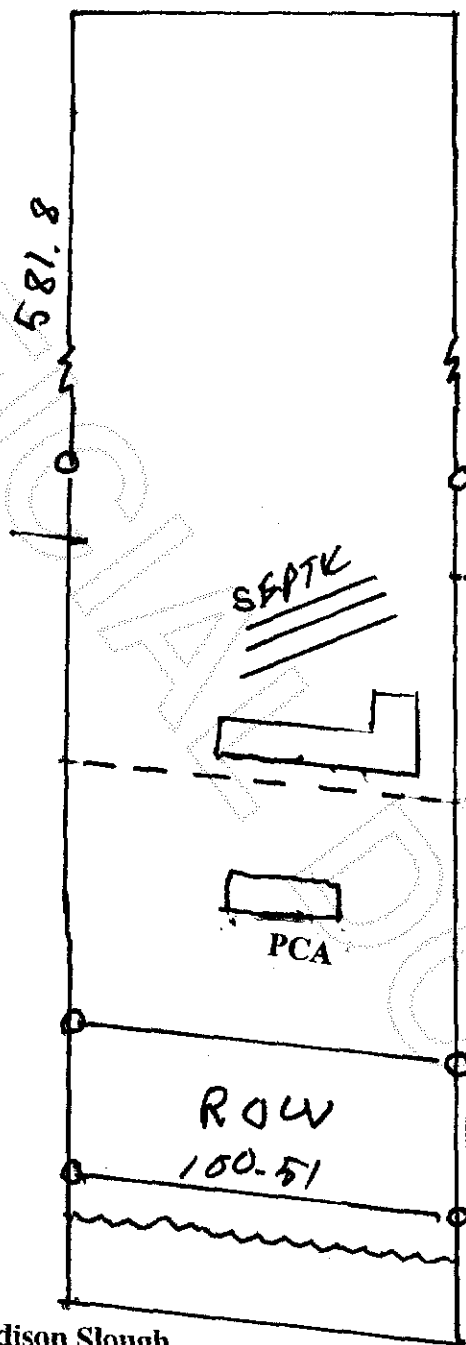

F&W Assessment
October 4, 2006

Wall Property, Edison Slough
Rupert Schmitt, Consultant, 802-C 24th Street,
Anacortes, WA 98221

Scale: 1 inch=50 feet 

Hand Measured; not to surveyors standards

↑ N



200701090103
Skagit County Auditor

1/9/2007 Page

2 of

2 1:25PM

 1/8/07