

Return to:



200701020118
Skagit County Auditor

1/2/2007 Page 1 of 2 1:43PM

PROTECTED CRITICAL AREA SITE PLAN

This PCA replaces AF#200005010190

Page 1 of 2

Grantor/Owner: Cheryl Greaver

Grantee: PUBLIC

Site Address: 7260 State Route 9

Property ID #: P36271

Assessors Tax Account #: 350412-1-017-0018

Legal Description: Sec. 12 Twp. 35 Rng. 04 / Plat Name: --- Lot: ---

Permit/Activity #: PL06-1016/BP06-1397

The PROTECTED CRITICAL AREA (PCA) is to be left undisturbed in its natural state. "With the exception of activities identified as Allowed without Standard review under SCC 14.24.100, any land-use activity that can impair the functions and values of critical areas or their buffers through a development activity or by disturbance of the soil or water, and/or by removal of, or damage to, existing vegetation shall require critical areas review and written authorization pursuant to SCC 14.24." SCC 14.24.060 No clearing, grading, filling, logging or removal of woody material, building, construction or road construction of any kind, planting of non-native vegetation or grazing of livestock is allowed within the PCA areas except as specifically permitted by Skagit County on a case-by-case basis consistent with SCC 14.24.

Representations on this site plan may be approximations only and should not be used for purposes other than for determining general locations of critical areas. Development activities beyond the scope of this plan may require additional studies and approvals.

The above references to "Grantor" and "Grantee" shall not be construed as a transfer of property ownership and are used solely for filing with the County Auditor.

Owner: _____ Date: 1-2-07

On this day personally appeared before me CHERYL GREAVER known to me as her the individual described herein and acknowledged to me that she signed the same as her and voluntary act and deed for the uses and purposes therein mentioned.

Patti J. Chambers, Notary Public in and for the State of Washington, residing at MOUNT VERNON Date: 1/2/07

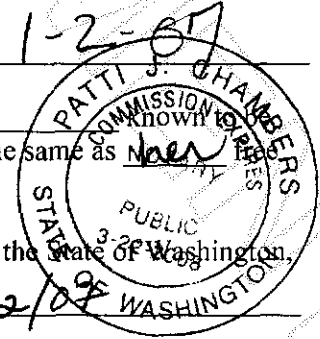

UNAPPROVED

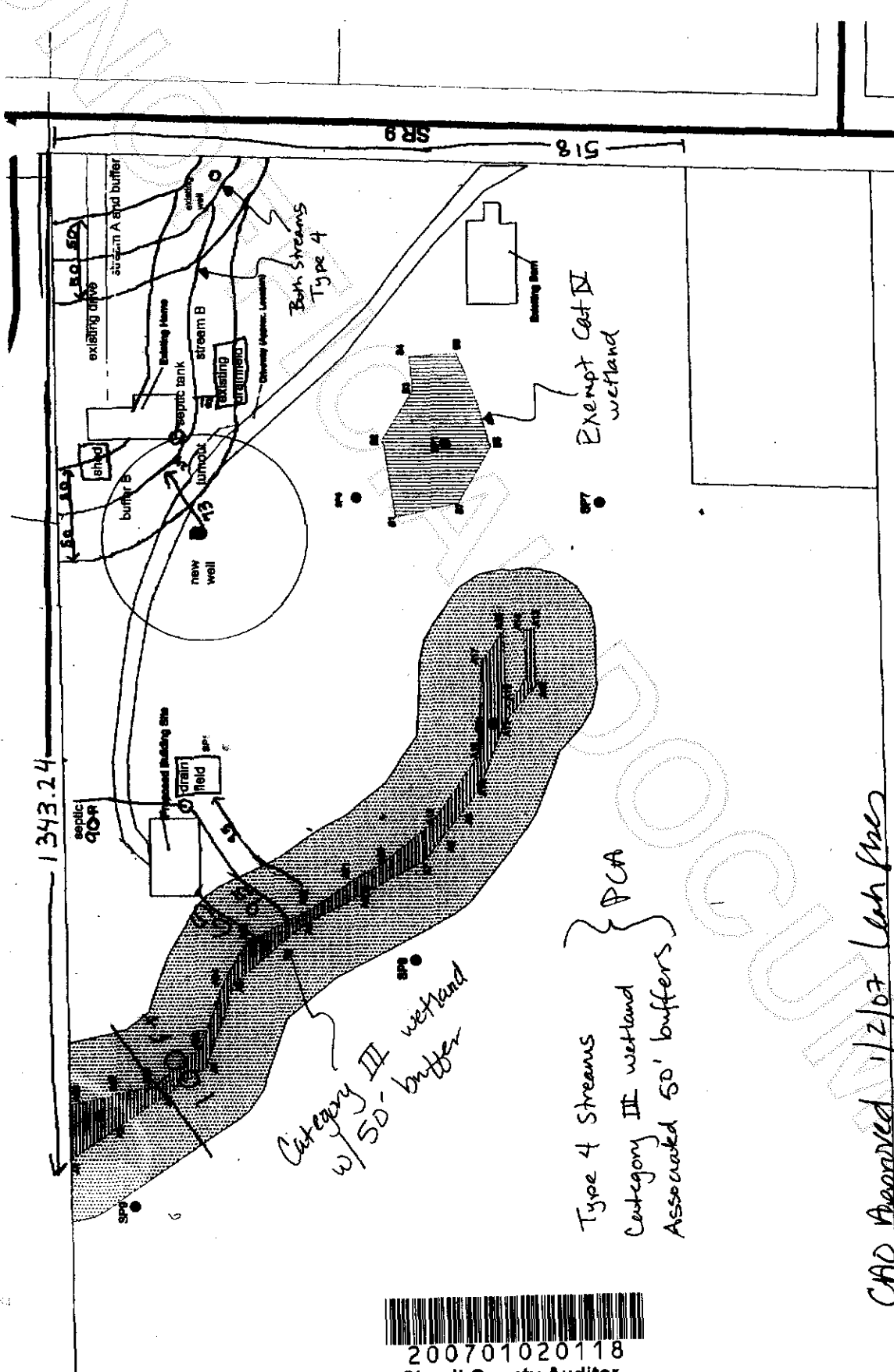

Category III wetland w/ 50' buffer

Type 4 Streams
Category III wetland
Associated 50' buffers
PCA

Exempt Cat IV wetland

Both Streams Type 4

stream A and buffer

existing drive

existing Home

stream B

septic tank

existing drainfield

new well

shed

buffer B

new well

septic tank

drain field

septic tank

existing building site

SR 9

518

1343.24



200701020118
Skagit County Auditor

CAD Approved 1/2/07 Leah Ples



- Roads
- Parcels
- Wetland A
- Wetland B
- 50' Wetland Buffer
- Project Property
- Soil PN / Data Point
- Wetland Flags (A1-28, B1-9)

Disclaimer: This map is for reference use only and is not intended to replace a professional survey if required.

Greaver Site Map P.C.A

P# 36271

7260 Hwy 9 Sedro Woolley