

rebar & cap, LS 9685
found per AFN 200304290016

200512010100
Skagit County Auditor
12/1/2006 Page 1 of 1 1:00PM

Nanna Burnett by Audrey Swada
Auditor's Certificate

Land Description

Auditor's File Number (AFN 4312130116)
The east 10 feet of Lot 16, Block 4, E. Kellogg's Addition to the City of Anacortes, according to the plat thereof recorded in Volume 1, of Plats, page 39, records of Skagit County, Washington.
Subject to a non-exclusive easement reserved by the Grantor as the owner of the adjoining property for ingress and egress over the existing driveway which is located on the southernmost portion of the above-described property. The northern most portion of said easement being approximately 10 feet to the north of the southern boundary of said property.
P 51844
Lots 17 through 20, Block 4, E. Kellogg's Addition to the City of Anacortes, according to the plat thereof recorded in Volume 1 of Plats, page 39, records of Skagit County, Washington.
P51845
Lots 1 through 3, Block 4, E. Kellogg's Addition to the City of Anacortes, according to the plat thereof recorded in Volume 1 of Plats, page 39, records of Skagit County, Washington.

Survey Notes

This survey has been prepared from a closed random traverse using an electronic instrument measuring angles to 3 seconds of arc and distances rounded to hundredths of feet.
The purpose of this survey has been to locate, describe and to set monuments to mark the existing lines and corners of the above described property.

brass disk with
punch hole, down
12" no monument
case

Rebar & Cap, LS 24535
(unless otherwise noted)

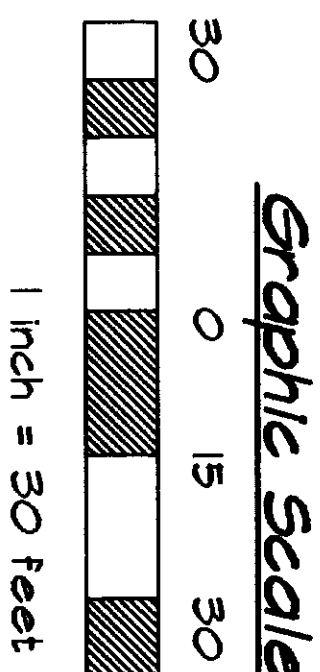

Basis of Bearings

Survey per AFN
200304290016

edge of pavement

rebar & cap LS 28023
(not of record)

1/2" diameter
pipe (not
of record)

Record of Survey

prepared at the request of

Earl R. & Doris M. Hillis

Property located within the Northeast Quarter of Section 23,
Township 35 North, Range 1 East, 11W, City of Anacortes,
Fidalgo Island, Skagit County, Washington

JOB NO.: 605-312
CADD BY: RP
CHK BY:
BK REF: 21
SCALE: 1" = 30'
DATE: 10-15-06

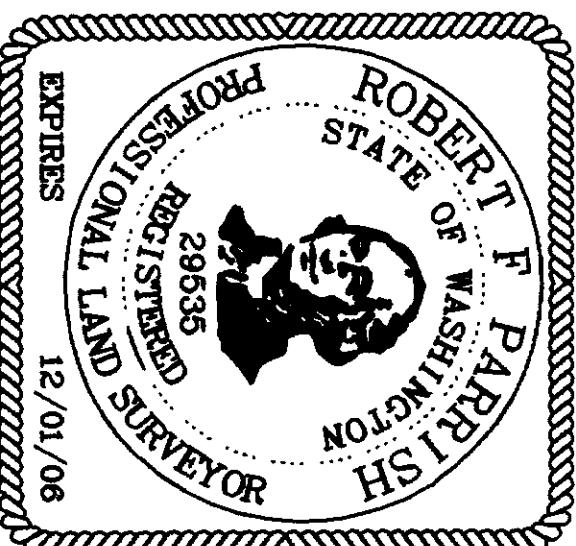

Surveyor's Certificate
This map correctly represents a survey made by me or under my direction in conformance with the requirements of the survey recording act at the request of Earl R. and Doris M. Hillis of Skagit County, in October, 2006.
certificate no.
LS 24535
Robert F. Parrish

Parrish Land Surveying

142 BLOSSOM LANE, PORT TOWNSEND, WA. 98368
ANACORTES (360) 588-1467 - parrish@rockland.com