

NOTES

- - INDICATES IRON REBAR SET WITH YELLOW CAP - SURVEY NUMBER SEMRAU 28626.  
○ - INDICATES EXISTING REBAR OR IRON PIPE FOUND.  
⊗ - INDICATES EXISTING REBAR REMOVED.
- SURVEY DESCRIPTION, EXCEPTIONS, REFERENCE INSTRUMENTS AND MAPS ARE FROM THE RECORDS OF SKAGIT COUNTY, WASHINGTON, AND FROM LAND TITLE COMPANY OF SKAGIT COUNTY FOR STEWART TITLE NATIONAL, TITLE SERVICES, ORDER NO. 114246-S, DATED NOVEMBER 10, 2004, AND STATUTORY WARRANTY DEED RECORDED UNDER AUDITOR'S FILE NOS. 200506240097 AND 200602030109, RECORDS OF SKAGIT COUNTY WASHINGTON, AND FROM INFORMATION AND FACTS NOTED ON "SPORTSMAN PLAZA BINDING SITE PLAN", RECORDED UNDER AUDITOR'S FILE NO. 200601130002, RECORDS OF SKAGIT COUNTY, WASHINGTON.
- BASIS OF BEARINGS: EXISTING SECTION CORNER MONUMENTS AT THE SOUTHWEST CORNER AND WEST 1/4 CORNER OF SECTION 8, TOWNSHIP 34 NORTH RANGE 4 EAST, WM, AND SHOWN HEREON AND ON PREVIOUS SURVEY'S RECORDED UNDER AUDITOR'S FILE NOS. 9709040030, 9806260013 AND 9807220013.  
BEARING = N 00°54'05" W.
- ALL DISTANCES ARE SHOWN IN FEET.
- INSTRUMENTATION: LEICA TCA 1105 THEODOLITE DISTANCE METER.
- SURVEY PROCEDURE: STANDARD FIELD TRAVERSE.
- THIS SURVEY WAS REQUESTED BY SHDP ASSOCIATES, LLC.
- THIS SURVEY MAY SHOW OCCUPATIONAL INDICATORS AS PER WAC CHAPTER 332.130. LINES OF OCCUPATION MAY INDICATE AREAS FOR POTENTIAL CLAIMS OF UNWRITTEN OWNERSHIP. THIS TOPOGRAPHIC SURVEY HAS ONLY SHOWN THE RELATIONSHIP OF LINES OF OCCUPATION TO THE DEEDED LINES OF RECORD. NO RESOLUTION OF OWNERSHIP BASED ON UNWRITTEN RIGHTS HAS BEEN MADE OR IMPLIED BY THIS SURVEY.
- EXCEPT AS SPECIFICALLY STATED OR SHOWN ON THIS SURVEY MAP, THIS SURVEY DOES NOT PURPORT TO REFLECT ALL OF THE FOLLOWING WHICH MAY BE APPLICABLE TO THE SUBJECT REAL ESTATE: EASEMENTS, BUILDING SETBACKS LINES, RESTRICTIVE COVENANTS, SUBDIVISION RESTRICTIONS, ZONING OR OTHER LAND-USE REGULATIONS AND ANY OTHER FACTS.

LOT AREA AND ADDRESS INFORMATION  
PARCEL 1 207,997 SQ. FT.  
PARCEL 2 43,564 SQ. FT.

PROPOSED DESCRIPTIONS

PARCEL 1

PARCEL 1 OF SPORTSMAN'S PLAZA BINDING SITE PLAN RECORDED ON 01/13/2006, UNDER AUDITOR'S FILE NO. 200601130002, RECORDS OF SKAGIT COUNTY, WASHINGTON.

EXCEPT THAT PORTION THEREOF DESCRIBED AS FOLLOWS:

BEGINNING AT THE NORTHWEST CORNER OF PARCEL 2, SAID SPORTSMAN'S PLAZA BINDING SITE PLAN, THENCE NORTH 89°05'55" EAST 237.77 FEET ALONG THE LINE BETWEEN SAID PARCELS 1 AND 2 TO A CORNER OF SAID PARCELS 1 AND 2;  
THENCE SOUTH 00°54'05" EAST 20.62 FEET ALONG THE LINE BETWEEN SAID PARCELS 1 AND 2 TO THE TRUE POINT OF BEGINNING;  
THENCE CONTINUE SOUTH 00°54'05" EAST 23.51 FEET ALONG SAID LINE BETWEEN PARCELS 1 AND 2 TO A CORNER OF SAID PARCELS 1 AND 2;  
THENCE NORTH 89°05'55" EAST 16.17 FEET ALONG THE LINE BETWEEN SAID PARCELS 1 AND 2 TO A CORNER OF SAID PARCELS 1 AND 2;  
THENCE NORTH 00°54'05" WEST 11.26 FEET TO A POINT THAT IS SOUTH 53°45'54" EAST FROM THE TRUE POINT OF BEGINNING;  
THENCE NORTH 53°45'54" WEST 20.29 FEET TO THE TRUE POINT OF BEGINNING.

TOGETHER WITH THAT PORTION OF PARCEL 2 OF SPORTSMAN'S PLAZA BINDING SITE PLAN RECORDED ON 01/13/2006, UNDER AUDITOR'S FILE NO. 200601130002, RECORDS OF SKAGIT COUNTY WASHINGTON, SAID PORTION BEING DESCRIBED AS FOLLOWS:

BEGINNING AT THE NORTHWEST CORNER OF SAID PARCEL 2, THENCE NORTH 89°05'55" EAST 210.54 FEET ALONG THE LINE BETWEEN SAID PARCEL 2 AND PARCEL 1, SAID SPORTSMAN'S PLAZA BINDING SITE PLAN, TO THE TRUE POINT OF BEGINNING, THENCE CONTINUE NORTH 89°05'55" EAST 27.23 FEET ALONG SAID LINE TO A CORNER OF SAID PARCELS 1 AND 2;  
THENCE SOUTH 00°54'05" EAST 20.62 FEET ALONG THE LINE BETWEEN SAID PARCELS 1 AND 2 TO A POINT THAT IS SOUTH 53°45'54" EAST FROM THE TRUE POINT OF BEGINNING;  
THENCE NORTH 53°45'54" WEST 34.16 FEET TO THE TRUE POINT OF BEGINNING.

SITUATE IN THE COUNTY OF SKAGIT, STATE OF WASHINGTON.

PARCEL 2

PARCEL 2 OF SPORTSMAN'S PLAZA BINDING SITE PLAN RECORDED ON 01/13/2006, UNDER AUDITOR'S FILE NO. 200601130002, RECORDS OF SKAGIT COUNTY, WASHINGTON.

EXCEPT THAT PORTION THEREOF DESCRIBED AS FOLLOWS:

BEGINNING AT THE NORTHWEST CORNER OF SAID PARCEL 2, THENCE NORTH 89°05'55" EAST 210.54 FEET ALONG THE LINE BETWEEN SAID PARCEL 2 AND PARCEL 1, SAID SPORTSMAN'S PLAZA BINDING SITE PLAN, TO THE TRUE POINT OF BEGINNING, THENCE CONTINUE NORTH 89°05'55" EAST 27.23 FEET ALONG SAID LINE TO A CORNER OF SAID PARCELS 1 AND 2;  
THENCE SOUTH 00°54'05" EAST 20.62 FEET ALONG THE LINE BETWEEN SAID PARCELS 1 AND 2 TO A POINT THAT IS SOUTH 53°45'54" EAST FROM THE TRUE POINT OF BEGINNING;  
THENCE NORTH 53°45'54" WEST 34.16 FEET TO THE TRUE POINT OF BEGINNING.

TOGETHER WITH THAT PORTION OF PARCEL 1 OF SPORTSMAN'S PLAZA BINDING SITE PLAN RECORDED ON 01/13/2006, UNDER AUDITOR'S FILE NO. 200601130002, RECORDS OF SKAGIT COUNTY WASHINGTON, SAID PORTION BEING DESCRIBED AS FOLLOWS:

BEGINNING AT THE NORTHWEST CORNER OF PARCEL 2, SAID SPORTSMAN'S PLAZA BINDING SITE PLAN, THENCE NORTH 89°05'55" EAST 237.77 FEET ALONG THE LINE BETWEEN SAID PARCELS 1 AND 2 TO A CORNER OF SAID PARCELS 1 AND 2;  
THENCE SOUTH 00°54'05" EAST 20.62 FEET ALONG THE LINE BETWEEN SAID PARCELS 1 AND 2 TO THE TRUE POINT OF BEGINNING;  
THENCE CONTINUE SOUTH 00°54'05" EAST 23.51 FEET ALONG SAID LINE BETWEEN PARCELS 1 AND 2 TO A CORNER OF SAID PARCELS 1 AND 2;  
THENCE NORTH 89°05'55" EAST 16.17 FEET ALONG THE LINE BETWEEN SAID PARCELS 1 AND 2 TO A CORNER OF SAID PARCELS 1 AND 2;  
THENCE NORTH 00°54'05" WEST 11.26 FEET TO A POINT THAT IS SOUTH 53°45'54" EAST FROM THE TRUE POINT OF BEGINNING;  
THENCE NORTH 53°45'54" WEST 20.29 FEET TO THE TRUE POINT OF BEGINNING.

SITUATE IN THE COUNTY OF SKAGIT, STATE OF WASHINGTON.

AUDITOR'S CERTIFICATE



200611080142  
Skagit County Auditor

11/8/2006 Page 1 of 2 3:42PM

AT THE REQUEST OF SEMRAU ENGINEERING & SURVEYING, P.L.L.C.

N. Brunmet  
SKAGIT COUNTY AUDITOR

DEPUTY  
M. Brunmet

EXISTING DESCRIPTIONS

PARCEL 1 OF SPORTSMAN'S PLAZA BINDING SITE PLAN RECORDED ON 01/13/2006, UNDER AUDITOR'S FILE NO. 200601130002, RECORDS OF SKAGIT COUNTY, WASHINGTON.

SITUATE IN THE COUNTY OF SKAGIT, STATE OF WASHINGTON.

PARCEL 2 OF SPORTSMAN'S PLAZA BINDING SITE PLAN RECORDED ON 01/13/2006, UNDER AUDITOR'S FILE NO. 200601130002, RECORDS OF SKAGIT COUNTY, WASHINGTON.

SITUATE IN THE COUNTY OF SKAGIT, STATE OF WASHINGTON.

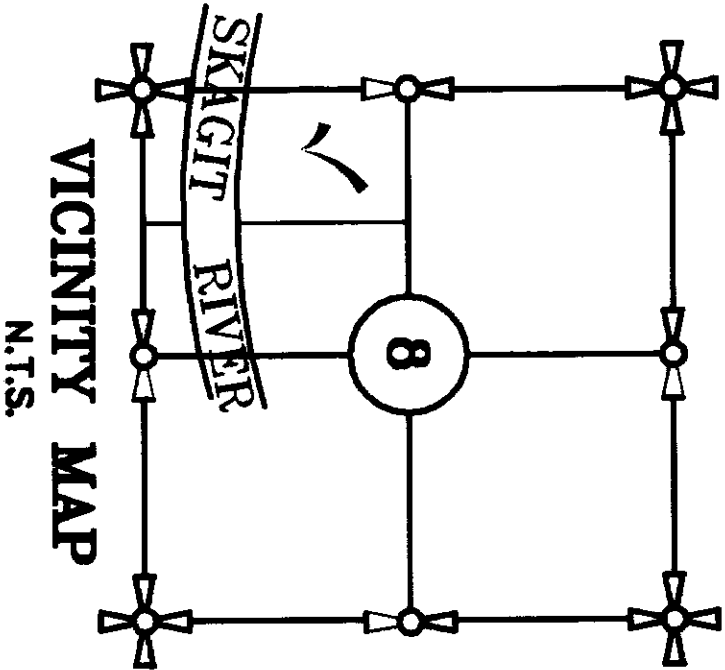

APPROVED

REVIEWED AND APPROVED IN ACCORDANCE WITH BURLINGTON MUNICIPAL CODE

CITY OF BURLINGTON, WASHINGTON

BY: Margaret J. Jule

TITLE: Planning Director

DATE: 9/28/06

SHEET 1 OF 2

SURVEYOR'S CERTIFICATE

THIS MAP CORRECTLY REPRESENTS A SURVEY MADE BY ME OR UNDER MY DIRECTION IN CONFORMANCE WITH THE REQUIREMENTS OF THE SURVEY RECORDING ACT AT THE REQUEST OF SHDP ASSOCIATES, LLC.

JOHN B. SEMRAU, P.E., P.L.S.  
SEMRAU ENGINEERING & SURVEYING, P.L.L.C.  
2118 RIVERSIDE DRIVE, SUITE 208  
MOUNT VERNON, WA 98273  
PHONE 360-424-9566

9.28.06

DATE:

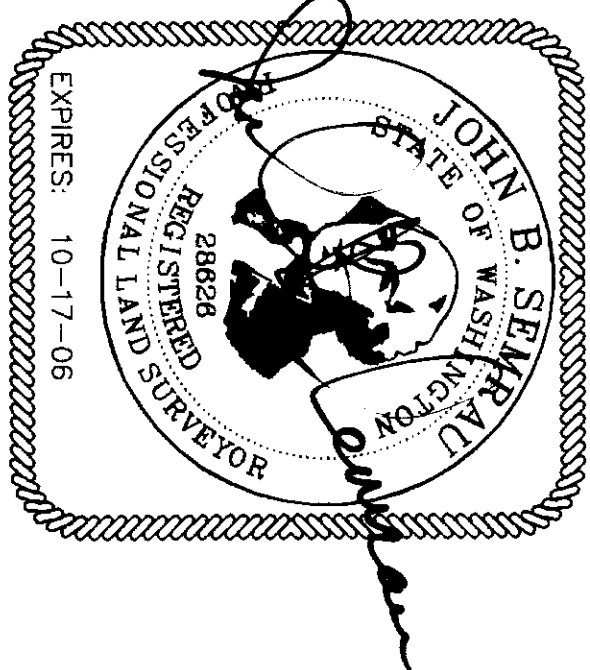

BOUNDARY LINE ADJUSTMENT

BLA 7-06

SPORTSMAN'S PLAZA BINDING SITE PLAN  
SOUTHWEST 1/4 OF SECTION 8, T. 34 N., R. 4 E., W.M.  
BURLINGTON, WASHINGTON  
FOR: SHDP ASSOCIATES, LLC

FB	Pg	SEMRAU ENGINEERING & SURVEYING, P.L.L.C.	SCALE: N/A
MERIDIAN: ASSUMED		SURVEYING ENGINEERING PLANNING MOUNT VERNON, WA 98273 360-424-9566	JOB NO. 4611

