

Survey in the SE1/4 of the SW1/4 of Section 22, Twp. 33 N., Rng. 5 E., W.M.

N89°25'57"W 2920.62'

1284.50'

CENTER OF SECTION AS SHOWN ON SURVEY FILED IN A.F.#98103000140.

22

FOUND 2" IRON PIPE AND 4"x4" WOODEN POST 1" WEST OF BRIDGE OVER DITCH. PIPE IS IN DITCH IN 4' OF WATER 12/18/96.

1327.51'

210°22'

S89°29'56"E 343.32'

1284.50'

N00°58'04"E 1327.14'

S89°29'56"E 1275.52'

S01°21'22"W 1325.75'

565.35'

S89°29'56"E 1275.52'

685.88'

Legend

- Set 1/2" X 18" reinforcing rod with yellow plastic cap marked "SKA SURV 17651" and white 2" X 2" witness stake.
- Set yellow plastic cap marked "SKA SURV 17651" on existing 1/2" reinforcing rod, and set white 2" X 2" witness stake.

Nelson Legal Description

The southeast 1/4 of the southwest 1/4 of Section 22, Township 33 North, Range 5 East, W.M., less Road and Railway, less the north 510 feet of the east 710 feet, and less the following:
Beginning at the intersection of the center line of the Lake Cavanaugh County road with the east line of said subdivision; thence north along the east line of said subdivision 351 feet; thence west parallel with the south line of said subdivision 750 feet; thence south parallel with the east line of said subdivision to the center line of the aforementioned County road; thence easterly along said center line to the point of beginning;
EXCEPT that portion lying southerly of the northerly right of way line of the Lake Cavanaugh County road.

Rave Legal Description

The north 510 feet of the east 710 feet of the east 1/2 of the southeast 1/4 of the southwest 1/4 of Section 22, Township 33 North, Range 5 East, W.M.

RAVE
8.05 ACRES

691.03'

N89°29'56"W

N01°09'59"E 35.70'

S01°09'59"W 510.03'

AUDITOR'S CERTIFICATE

200608070040
Skagit County Auditor

8/7/2006 Page 1 of 1 9:53AM

N. Brummett by: *Shannon*
County Auditor or Deputy Auditor

SURVEYOR'S CERTIFICATE

This map correctly represents a survey made by me or under my direction in conformance with the Survey Recording Act in March 2006 at the request of Matt Rave and Betty Nelson.

John L. Abenroth CERT#17651
Date 7/25/06

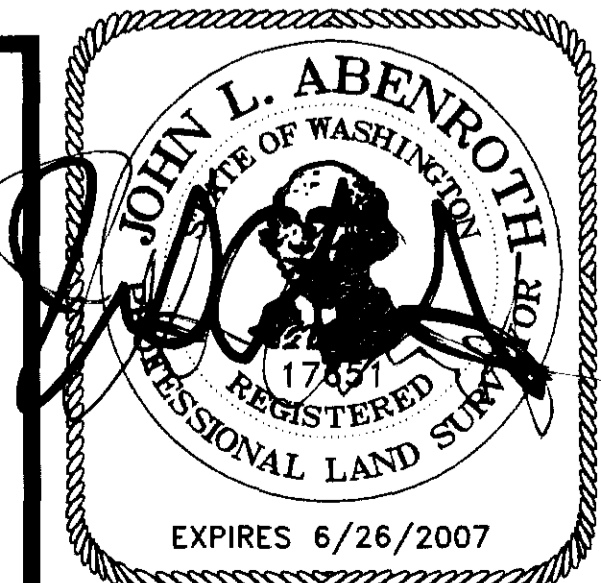

S00°36'31"W 2655.01'

1327.51'

N00°58'04"E 1327.15'

S01°21'22"W 1325.76'

1021.11'

NELSON
20.93 ACRES
(NORTH OF ROAD)

N01°44'43"E 267.84'

NELSON
2,812 S.F.

S01°13'39"E 228.94'

N00°54'00"E 394.54'

PETER BURNS ROAD
N01°44'43"E 2648.86'

COPYRIGHT 2004 SKAGIT SURVEYORS, INC.

Notes

1. Basis-of-bearings - Assumed S89°34'00"E on the south line of the southwest quarter of section 22.
2. This survey was accomplished by field traverse using 3 second or better digital electronic total station, and meets or exceeds the standards contained in WAC 332-130-090.

#	BEARING	DISTANCE
L1	N01°21'22"E	10.01'
L2	S89°56'38"W	48.46'
L3	S89°34'00"E	20.21'
L4	S89°34'00"E	22.15'
L5	S01°21'22"W	50.98'
L6	S01°21'22"W	60.79'

#	RADIUS	DELTA	LENGTH
C1	542.96'	0726'08"	70.46'
C2	542.96'	18°09'03"	172.01'
C3	789.49'	08°34'10"	118.08'
C4	739.49'	00°21'31"	4.63'
C5	607.60'	07°43'50"	81.98'
C6	741.25'	17°22'00"	224.68'
C7	691.25'	17°22'00"	209.52'

FOUND CONCRETE MONUMENT WITH BRASS CAP ON 8/12/04.

335.00'

1266.55'

183.27'

128.64'

96.55'

118.85'

119.85'

98.31'

224.96'

96.31'

98.31'

163.63'

125.80'

125.80'

140.18'

305.05'

43.09'

224.75'

334.08'

30'

22

21

28

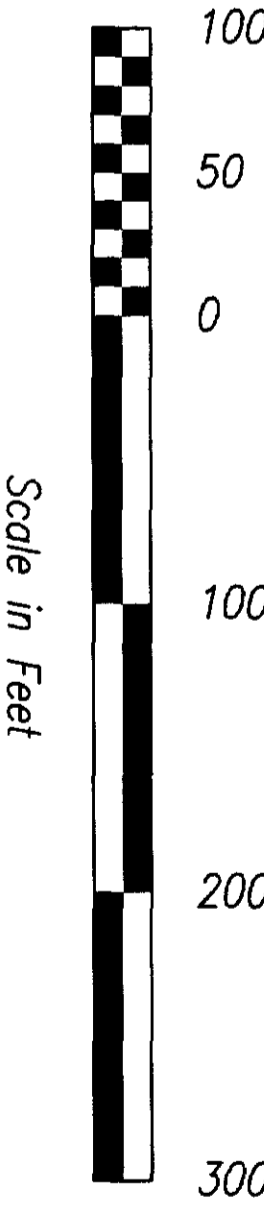

Scale in Feet

1266.55'

183.27'

128.64'

96.55'

118.85'

119.85'

98.31'

224.96'

96.31'

98.31'

163.63'

125.80'

125.80'

140.18'

305.05'

43.09'

224.75'

334.08'

30'

22

21

28

DATE

REVISION

BY

JOB# 205039

DRAWN

CHECKED

DATE 28MAR06

SCALE 1" = 100'

SHEET 1 OF 1

Survey for Matt Rave and Betty Nelson

806 Metcalf St., Sedro-Woolley, WA 98284 Phone: (360) 855-2121 FAX: (360) 855-1658