

Return Name & Address:

Sanfi Acres LLC

103 N. Township Street

Sedro-Woolley, WA 98284



200605030146

Skagit County Auditor

5/3/2006 Page

1 of

2 2:55PM

SKAGIT COUNTY PLANNING & DEVELOPMENT SERVICES

LOT OF RECORD CERTIFICATION

File Number: PL 06 - 0237

Applicant Name: Sanfi Acres LLC

Property Owner Name: Sanfi Acres LLC

Having reviewed the information provided by the applicant, the Department hereby finds that the parcel(s) bearing Skagit County Parcel Number(s):

P#(s): 18381

Lot Size: 20 acres Description: N1/2 SW1/4 SW1/4 33-33-5

1. CONVEYANCE

- ☒ **IS**, a Lot of Record as defined in Skagit County Code (SCC) 14.04.020 or owned by an innocent purchaser who has met the requirements described in SCC 14.18.000(9) and RCW 58.17.210 and therefore IS eligible for conveyance. (per AF# 9011080054)
- ☐ **IS NOT**, a Lot of Record as defined in SCC 14.04.020 or owned by an innocent purchaser who has met the requirements described in SCC 14.18.000(9) and RCW 58.17.210 and therefore IS NOT eligible for conveyance or development.

2. DEVELOPMENT

- ☐ **IS**, the minimum lot size required for the _____ zoning district in which the lot is located and therefore IS eligible to be considered for development permits.
- ☐ **IS NOT**, the minimum lot size required for the _____ zoning district in which the lot is located, but does meet an exemption listed in SCC 14.16.850(4)(c) _____ and therefore IS eligible to be considered for development permits.
- ☒ **IS NOT**, the minimum lot size required for the IF-NRL zoning district in which the lot is located, does not meet an exemption listed in SCC 14.16.850(4)(c) and therefore IS NOT eligible to be considered for certain development permits.

Authorized Signature: Arac Roden

Date: 4/25/2006

See attached map for Lot of Record boundaries.

SKAGIT COUNTY

5	6	7	8	9	10	11	12
13	14	15	16	17	18	19	20
21	22	23	24	25	26	27	28
29	30	31	32	33	34	35	36

T 33 N R 05 E

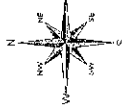

THIS MAP IS NOT A SUBSTITUTE FOR FIELD SURVEY.
IT IS THE PROPERTY OF THE COUNTY OF SKAGIT AND IS LOANED TO YOU FOR YOUR INFORMATION ONLY. IT IS NOT TO BE REPRODUCED OR COPIED IN ANY MANNER WITHOUT THE WRITTEN PERMISSION OF THE COUNTY OF SKAGIT. ANY REPRODUCTION OR COPIING OF THIS MAP WITHOUT THE WRITTEN PERMISSION OF THE COUNTY OF SKAGIT IS A VIOLATION OF THE SKAGIT COUNTY MAP ACT AND IS SUBJECT TO A FINE OF UP TO \$500.00 AND/OR IMPRISONMENT FOR UP TO 6 MONTHS.

DATE	INIT
DRAWN BY	11/2/06
REVIEWED	12/2/06
PLOTTED	12/2/06
DATE PRINTED	12/2/06
PROJECT	PL06-0226

Section 33
T 33 N R 05 E

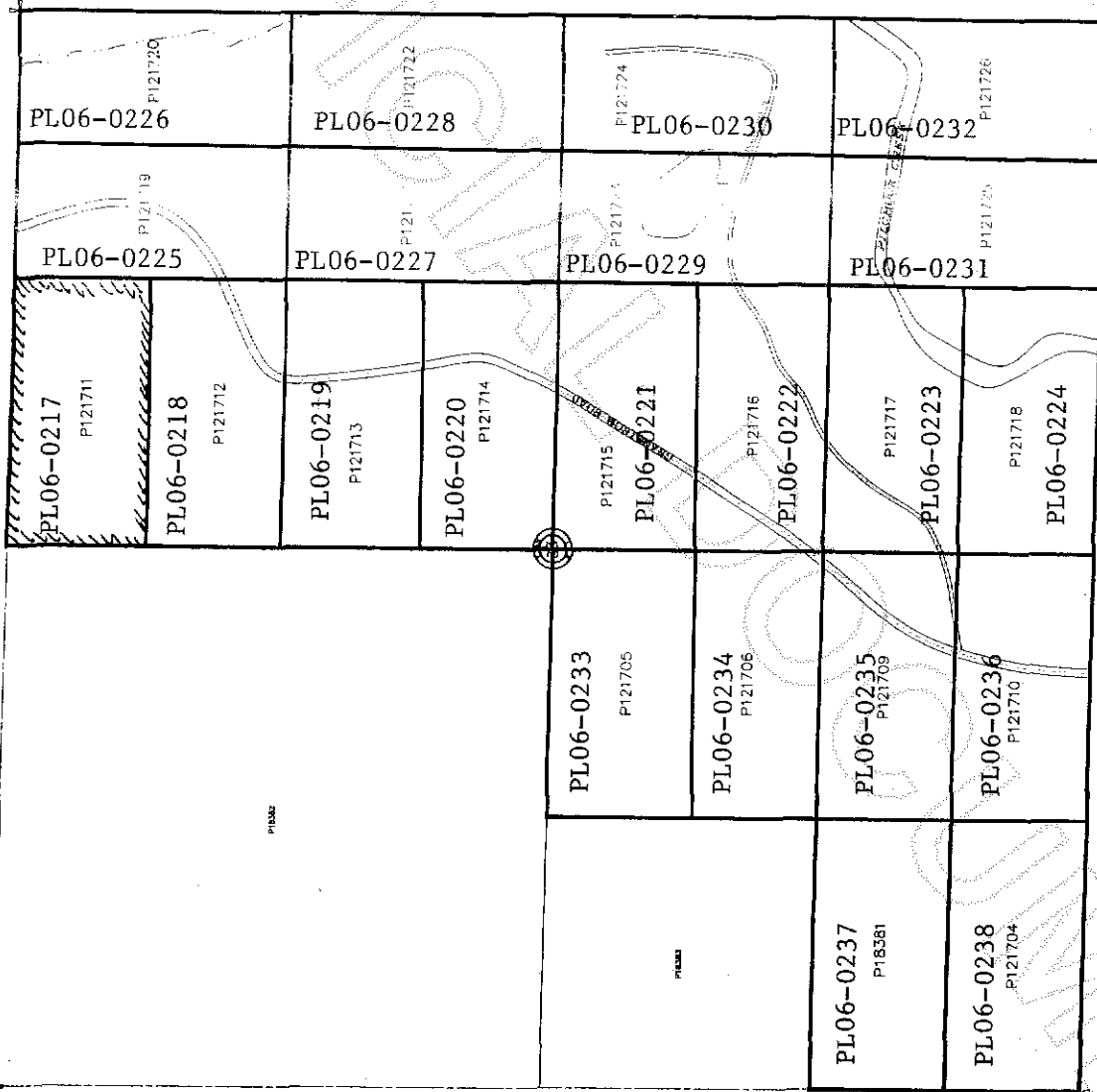

200605030146
Skagit County Auditor

5/3/2006 Page

2 of

2 2:55PM