

Return Name & Address:

Sanfi Acres LLC

103 N. Township Street

Sedro-Woolley, WA 98284



200605030145

Skagit County Auditor

5/3/2006 Page

1 of

2 2:55PM

SKAGIT COUNTY PLANNING & DEVELOPMENT SERVICES

LOT OF RECORD CERTIFICATION

File Number: PL 06 - 0236

Applicant Name: Sanfi Acres LLC

Property Owner Name: Sanfi Acres LLC

Having reviewed the information provided by the applicant, the Department hereby finds that the parcel(s) bearing Skagit County Parcel Number(s):

P#(s): 121710

Lot Size: 20 acres Description: S1/2 SE1/4 SW1/4 33-33-5

1. CONVEYANCE

- ☒ **IS**, a Lot of Record as defined in Skagit County Code (SCC) 14.04.020 or owned by an innocent purchaser who has met the requirements described in SCC 14.18.000(9) and RCW 58.17.210 and therefore IS eligible for conveyance. ( *per AF#* 9011080054 )
- ☐ **IS NOT**, a Lot of Record as defined in SCC 14.04.020 or owned by an innocent purchaser who has met the requirements described in SCC 14.18.000(9) and RCW 58.17.210 and therefore IS NOT eligible for conveyance or development.

2. DEVELOPMENT

- ☐ **IS**, the minimum lot size required for the \_\_\_\_\_ zoning district in which the lot is located and therefore IS eligible to be considered for development permits.
- ☒ **IS NOT**, the minimum lot size required for the IF-NRL zoning district in which the lot is located, but does meet an exemption listed in SCC 14.16.850(4)(c) and therefore IS eligible to be considered for development permits. viii (D)
- ☐ **IS NOT**, the minimum lot size required for the \_\_\_\_\_ zoning district in which the lot is located, does not meet an exemption listed in SCC 14.16.850(4)(c) and therefore IS NOT eligible to be considered for certain development permits.

Authorized Signature: [Signature]

Date: 4/25/2006

See attached map for Lot of Record boundaries.

# SKAGIT COUNTY

6	5	4	3	2	1
7	8	9	10	11	12
18	17	16	15	14	13
24	23	22	21	20	19
26	25	24	23	22	21
32	31	30	29	28	27
34	33	32	31	30	29
36	35	34	33	32	31

T 33 N R 05 E

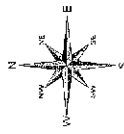

THIS MAP WAS PREPARED BY THE SKAGIT COUNTY ENGINEERING DEPARTMENT. IT IS THE PROPERTY OF SKAGIT COUNTY AND IS LOANED TO YOU FOR YOUR INFORMATION. IT IS NOT TO BE REPRODUCED OR COPIED IN ANY MANNER WITHOUT THE WRITTEN PERMISSION OF SKAGIT COUNTY. THE ENGINEER HAS CONDUCTED A VISUAL CHECK OF THE MAP AND HAS FOUND IT TO BE CORRECT. THE USER OF THIS MAP IS RESPONSIBLE FOR THE ACCURACY OF THE INFORMATION CONTAINED HEREIN.

DATE	INIT
DRAWN BY	AD
REVISED	AD
PLOTTED	AD
CHECKED	AD
APPROVED	AD

Section 33  
T 33 N R 05 E

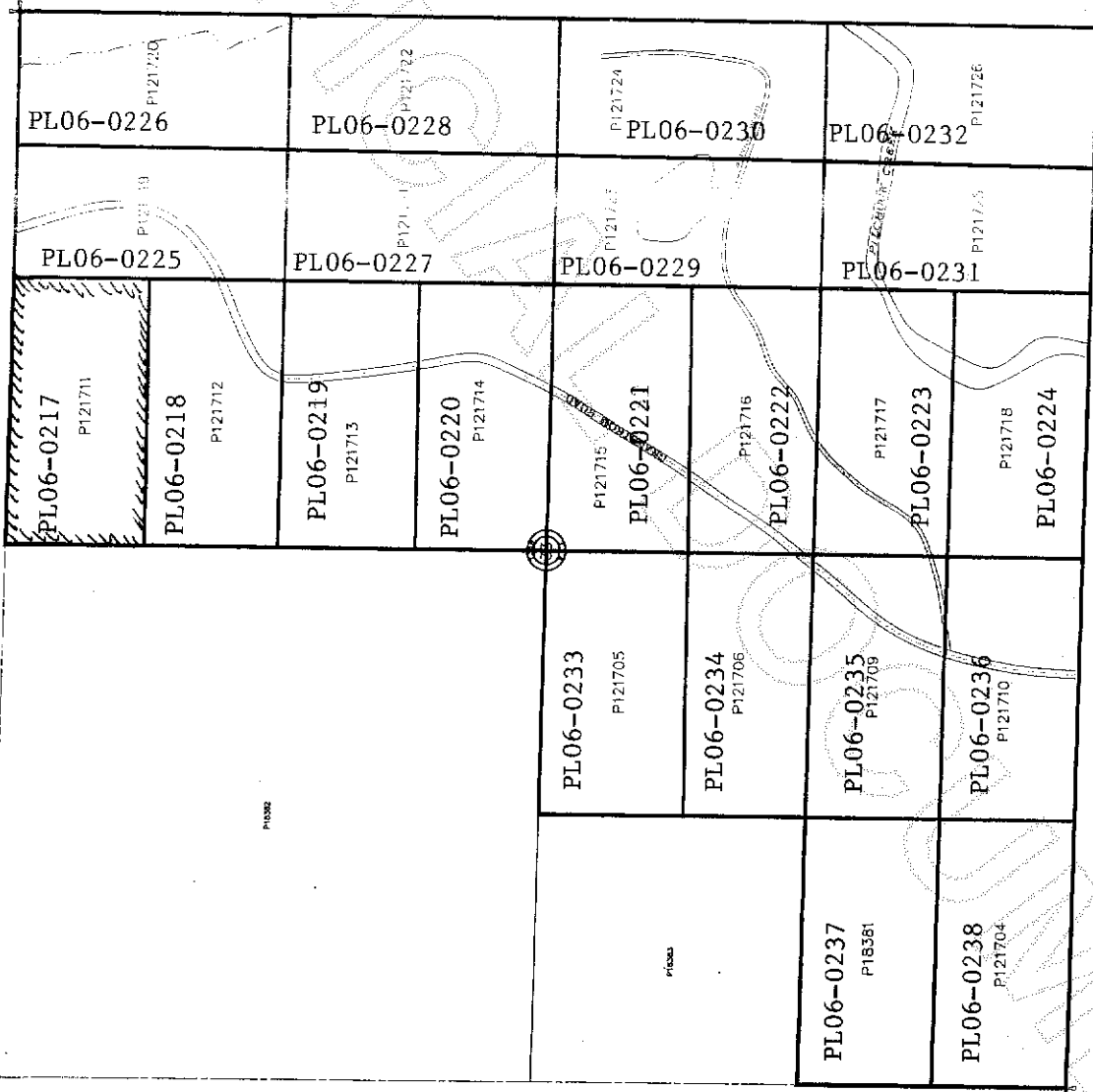

200605030145  
Skagit County Auditor