

Return Name & Address:

Sanfi Acres LLC

103 N. Township Street

Sedro-Woolley, WA 98284



200605030139

Skagit County Auditor

5/3/2006 Page

1 of

2 2:54PM

SKAGIT COUNTY PLANNING & DEVELOPMENT SERVICES

**LOT OF RECORD CERTIFICATION**

File Number: PL 06 - 0230

Applicant Name: Sanfi Acres LLC

Property Owner Name: Sanfi Acres LLC

Having reviewed the information provided by the applicant, the Department hereby finds that the parcel(s) bearing Skagit County Parcel Number(s):

P#(s): 121724

Lot Size: 20 acres Description: E1/2 NE1/4 SE1/4 33-33-5

**1. CONVEYANCE**

- ☒ **IS**, a Lot of Record as defined in Skagit County Code (SCC) 14.04.020 or owned by an innocent purchaser who has met the requirements described in SCC 14.18.000(9) and RCW 58.17.210 and therefore IS eligible for conveyance. ( *per AF#* 9011080054 )
- ☐ **IS NOT**, a Lot of Record as defined in SCC 14.04.020 or owned by an innocent purchaser who has met the requirements described in SCC 14.18.000(9) and RCW 58.17.210 and therefore IS NOT eligible for conveyance or development.

**2. DEVELOPMENT**

- ☐ **IS**, the minimum lot size required for the \_\_\_\_\_ zoning district in which the lot is located and therefore IS eligible to be considered for development permits.
- ☐ **IS NOT**, the minimum lot size required for the \_\_\_\_\_ zoning district in which the lot is located, but does meet an exemption listed in SCC 14.16.850(4)(c) \_\_\_\_\_ and therefore IS eligible to be considered for development permits.
- ☒ **IS NOT**, the minimum lot size required for the IF-NRL zoning district in which the lot is located, does not meet an exemption listed in SCC 14.16.850(4)(c) and therefore IS NOT eligible to be considered for certain development permits.

Authorized Signature: Arac Roden

Date: 4/25/2006

See attached map for Lot of Record boundaries.

# SKAGIT COUNTY

6	5	4	3	2	1
7	8	9	10	11	12
13	14	15	16	17	18
19	20	21	22	23	24
25	26	27	28	29	30
31	32	33	34	35	36

T 33 N R 05 E

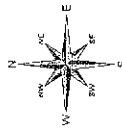

THIS MAP IS NOT A SUBSTITUTE FOR FIELD SURVEY.  
 THE SKAGIT COUNTY ENGINEER'S OFFICE  
 HAS REVIEWED THIS MAP FOR CONFORMANCE  
 WITH THE REQUIREMENTS OF THE  
 WASHINGTON STATE ENGINEERING  
 BOARD AND THE SKAGIT COUNTY  
 ENGINEERING BOARD.  
 DATE: 10/1/06  
 BY: [Signature]  
 FOR: [Signature]

DATE	INIT.
DRAWN BY	10/1/06
REVISED	10/1/06
PLOTTED	10/1/06
MAP PREPARED BY	10/1/06
CHECKED BY	10/1/06

Section 33  
 T 33 N R 05 E

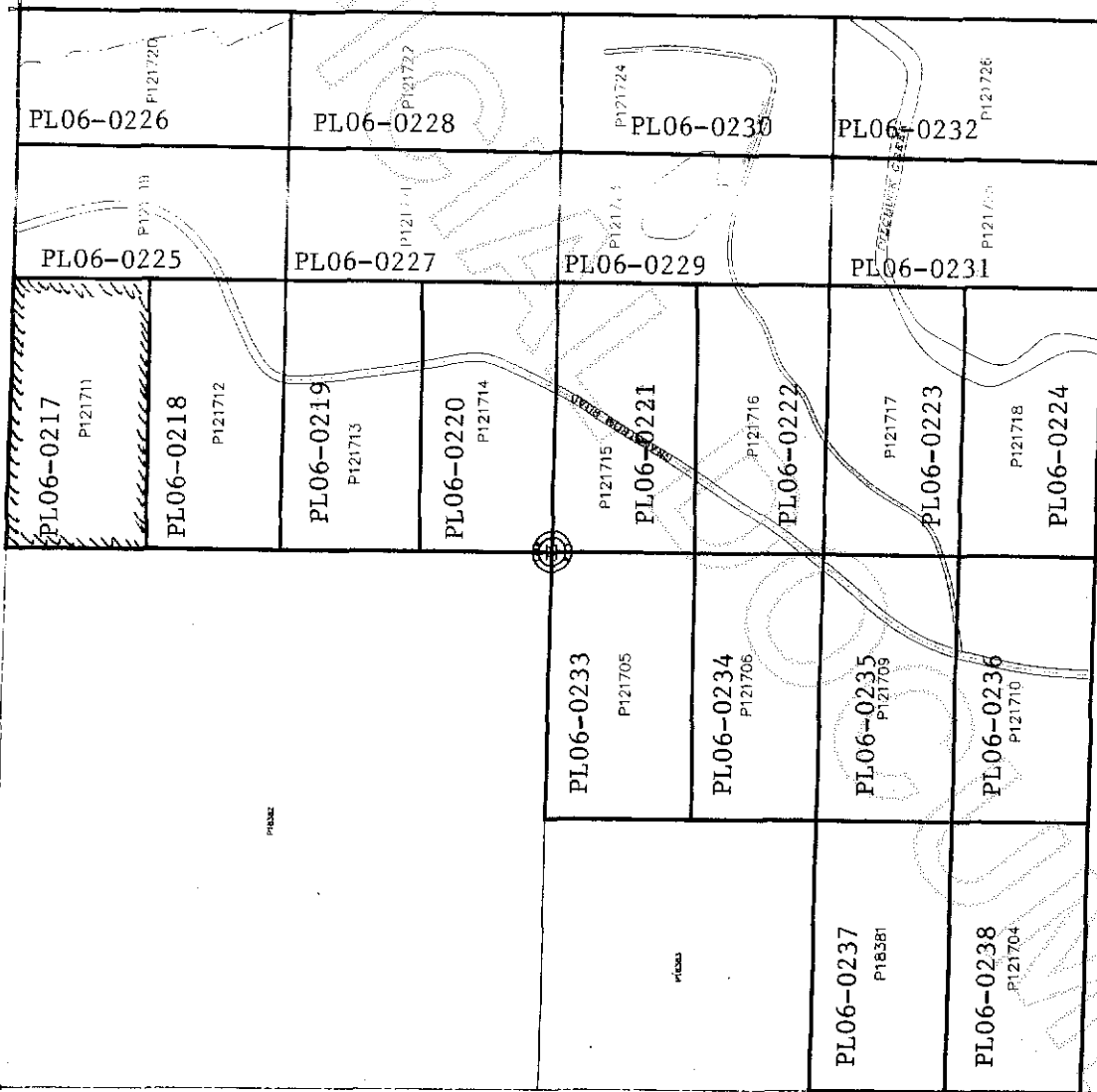

200605030139  
 Skagit County Auditor