

Return Name & Address:

Sanfi Acres LLC

103 N. Township Street

Sedro-Woolley, WA 98284



200605030138

Skagit County Auditor

5/3/2006 Page

1 of

2 2:53PM

SKAGIT COUNTY PLANNING & DEVELOPMENT SERVICES

LOT OF RECORD CERTIFICATION

File Number: PL 06 - 0229

Applicant Name: Sanfi Acres LLC

Property Owner Name: Sanfi Acres LLC

Having reviewed the information provided by the applicant, the Department hereby finds that the parcel(s) bearing Skagit County Parcel Number(s):

P#(s): 121723

Lot Size: 20 acres Description: W1/2 NE1/4 SE1/4 33-33-5

1. CONVEYANCE

- ☒ **IS**, a Lot of Record as defined in Skagit County Code (SCC) 14.04.020 or owned by an innocent purchaser who has met the requirements described in SCC 14.18.000(9) and RCW 58.17.210 and therefore IS eligible for conveyance. (*per AF#* 9011080054)
- ☐ **IS NOT**, a Lot of Record as defined in SCC 14.04.020 or owned by an innocent purchaser who has met the requirements described in SCC 14.18.000(9) and RCW 58.17.210 and therefore IS NOT eligible for conveyance or development.

2. DEVELOPMENT

- ☐ **IS**, the minimum lot size required for the _____ zoning district in which the lot is located and therefore IS eligible to be considered for development permits.
- ☐ **IS NOT**, the minimum lot size required for the _____ zoning district in which the lot is located, but does meet an exemption listed in SCC 14.16.850(4)(c) _____ and therefore IS eligible to be considered for development permits.
- ☒ **IS NOT**, the minimum lot size required for the IF-NRL zoning district in which the lot is located, does not meet an exemption listed in SCC 14.16.850(4)(c) _____ and therefore IS NOT eligible to be considered for certain development permits.

Authorized Signature: Acad Roeder

Date: 4/25/2006

See attached map for Lot of Record boundaries.

SKAGIT COUNTY

6	5	4	3	2	1
7	8	9	10	11	12
13	14	15	16	17	18
19	20	21	22	23	24
25	26	27	28	29	30
31	32	33	34	35	36

T 33 N R 05 E

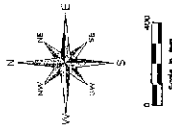

This map is not a substitute for field survey. It is a representation of the information provided to the County by the applicant. The County does not warrant the accuracy or completeness of the information. The County is not responsible for any errors or omissions. The County is not responsible for any damages, including consequential damages, arising from the use of this map. The County is not responsible for any claims, including attorney's fees, arising from the use of this map. The County is not responsible for any claims, including attorney's fees, arising from the use of this map.

DATE	INIT.
DRAWN BY	WJW
REVISED	WJW
PLOTTED	WJW
MADE AVAILABLE BY	WJW
REPLACING	REPLACING

Section 33
T 33 N R 05 E

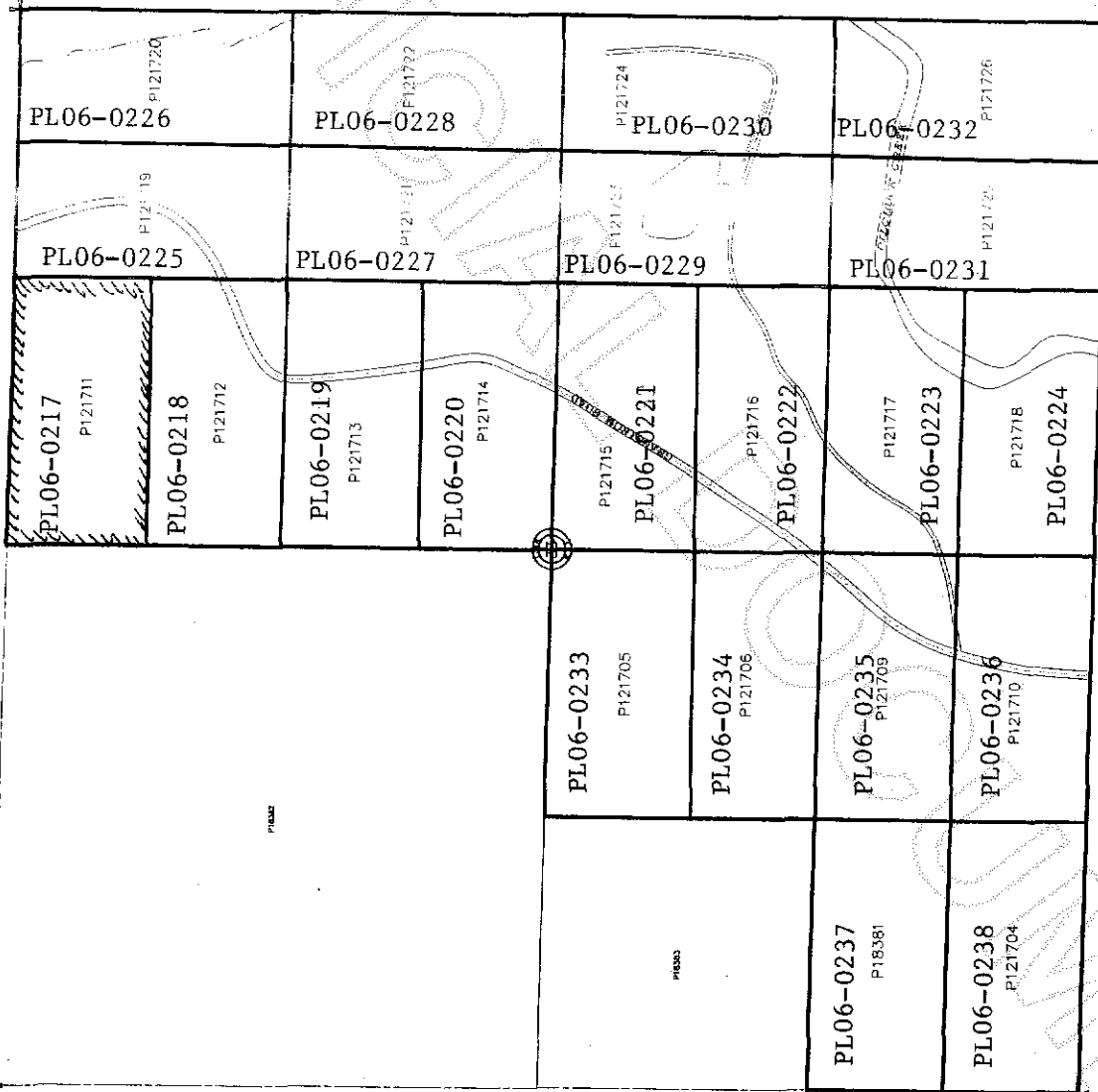

200605030138
Skagit County Auditor

5/3/2006 Page

2 of

2 2:53PM