

Return Name & Address:

Sanfi Acres LLC

103 N. Township Street

Sedro-Woolley, WA 98284



200605030135
Skagit County Auditor

5/3/2006 Page

1 of

2 2:53PM

SKAGIT COUNTY PLANNING & DEVELOPMENT SERVICES

LOT OF RECORD CERTIFICATION

File Number: PL 06 - 0226

Applicant Name: Sanfi Acres LLC

Property Owner Name: Sanfi Acres LLC

Having reviewed the information provided by the applicant, the Department hereby finds that the parcel(s) bearing Skagit County Parcel Number(s):

P#(s): 121720

Lot Size: 20 acres Description: E1/2 NE1/4 NE1/4 33-33-5

1. CONVEYANCE

- ☒ **IS**, a Lot of Record as defined in Skagit County Code (SCC) 14.04.020 or owned by an innocent purchaser who has met the requirements described in SCC 14.18.000(9) and RCW 58.17.210 and therefore IS eligible for conveyance. (*per AF#* 9011080054)
- ☐ **IS NOT**, a Lot of Record as defined in SCC 14.04.020 or owned by an innocent purchaser who has met the requirements described in SCC 14.18.000(9) and RCW 58.17.210 and therefore IS NOT eligible for conveyance or development.

2. DEVELOPMENT

- ☐ **IS**, the minimum lot size required for the _____ zoning district in which the lot is located and therefore IS eligible to be considered for development permits.
- ☐ **IS NOT**, the minimum lot size required for the _____ zoning district in which the lot is located, but does meet an exemption listed in SCC 14.16.850(4)(c) _____ and therefore IS eligible to be considered for development permits.
- ☒ **IS NOT**, the minimum lot size required for the IF-NRL zoning district in which the lot is located, does not meet an exemption listed in SCC 14.16.850(4)(c) and therefore IS NOT eligible to be considered for certain development permits.

Authorized Signature: *David Roeder*

Date: 4/25/2006

See attached map for Lot of Record boundaries.

SKAGIT COUNTY

6	5	4	3	2	1
7	8	9	10	11	12
13	14	15	16	17	18
19	20	21	22	23	24
25	26	27	28	29	30
31	32	33	34	35	36

T 33 N R 05 E

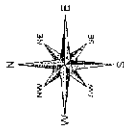

THIS MAP IS NOT A WARRANTY FOR THIS MAP. THE MAP IS PROVIDED AS IS. THE USER ASSUMES ALL LIABILITY FOR THE USE OF THE MAP. THE MAP IS NOT TO BE USED FOR ANY PURPOSE OTHER THAN THAT FOR WHICH IT WAS DESIGNED. THE MAP IS NOT TO BE USED FOR ANY PURPOSE OTHER THAN THAT FOR WHICH IT WAS DESIGNED.

DATE	INIT
DRAWN BY	11/2/04
REVISED	11/2/04
PLOTTED	11/2/04
DATE	11/2/04

Section 33
T 33 N R 05 E

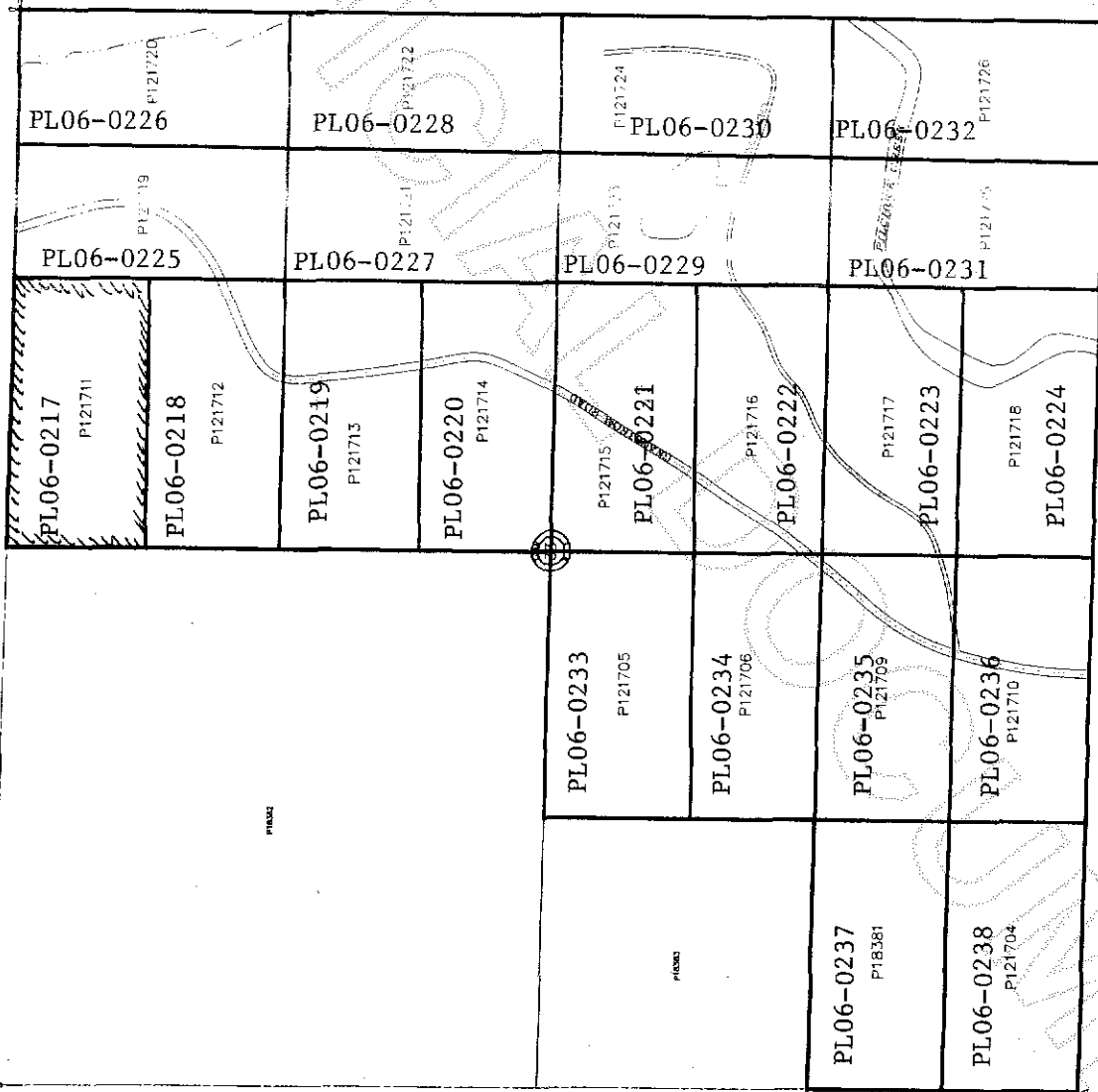

200605030135
Skagit County Auditor