

Return Name & Address:

Sanfi Acres LLC  
103 N. Township Street  
Sedro-Woolley, WA 98284



200605030128  
Skagit County Auditor

5/3/2006 Page 1 of 2 2:51PM

SKAGIT COUNTY PLANNING & DEVELOPMENT SERVICES

LOT OF RECORD CERTIFICATION

File Number: PL 06 - 0219

Applicant Name: Sanfi Acres LLC

Property Owner Name: Sanfi Acres LLC

Having reviewed the information provided by the applicant, the Department hereby finds that the parcel(s) bearing Skagit County Parcel Number(s):

P#(s): 121713

Lot Size: 20 acres Description: N1/2 SW1/4 NE1/4 33-33-5

1. CONVEYANCE

- IS**, a Lot of Record as defined in Skagit County Code (SCC) 14.04.020 or owned by an innocent purchaser who has met the requirements described in SCC 14.18.000(9) and RCW 58.17.210 and therefore IS eligible for conveyance. (*per AF#* 9011080054 )
- IS NOT**, a Lot of Record as defined in SCC 14.04.020 or owned by an innocent purchaser who has met the requirements described in SCC 14.18.000(9) and RCW 58.17.210 and therefore IS NOT eligible for conveyance or development.

2. DEVELOPMENT

- IS**, the minimum lot size required for the \_\_\_\_\_ zoning district in which the lot is located and therefore IS eligible to be considered for development permits.
- IS NOT**, the minimum lot size required for the IF-NRL zoning district in which the lot is located, but does meet an exemption listed in SCC 14.16.850(4)(c) and therefore IS eligible to be considered for development permits. viii (D)
- IS NOT**, the minimum lot size required for the \_\_\_\_\_ zoning district in which the lot is located, does not meet an exemption listed in SCC 14.16.850(4)(c) and therefore IS NOT eligible to be considered for certain development permits.

Authorized Signature: Graef Roeder Date: 4/25/2006

See attached map for Lot of Record boundaries.

# SKAGIT COUNTY

6	5	4	3	2	1
7	8	9	10	11	12
13	14	15	16	17	18
19	20	21	22	23	24
25	26	27	28	29	30
31	32	33	34	35	36

T 33 N R 05 E

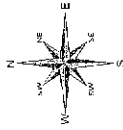

THIS MAP IS NOT A WARRANTY FOR FIELD SURVEY!  
 THE USER SHALL BE RESPONSIBLE FOR FIELD SURVEY!  
 THIS MAP IS NOT A WARRANTY FOR FIELD SURVEY!  
 THE USER SHALL BE RESPONSIBLE FOR FIELD SURVEY!

DATE	INIT.
DRAWN BY	W.S./A.N.
REVIEWED	W.S./A.N.
PLOTTED	W.S./A.N.
MADE PREPARED BY	W.S./A.N.
LOCALITY	WASHINGTON, WASHINGTON

Section 33  
T 33 N R 05 E

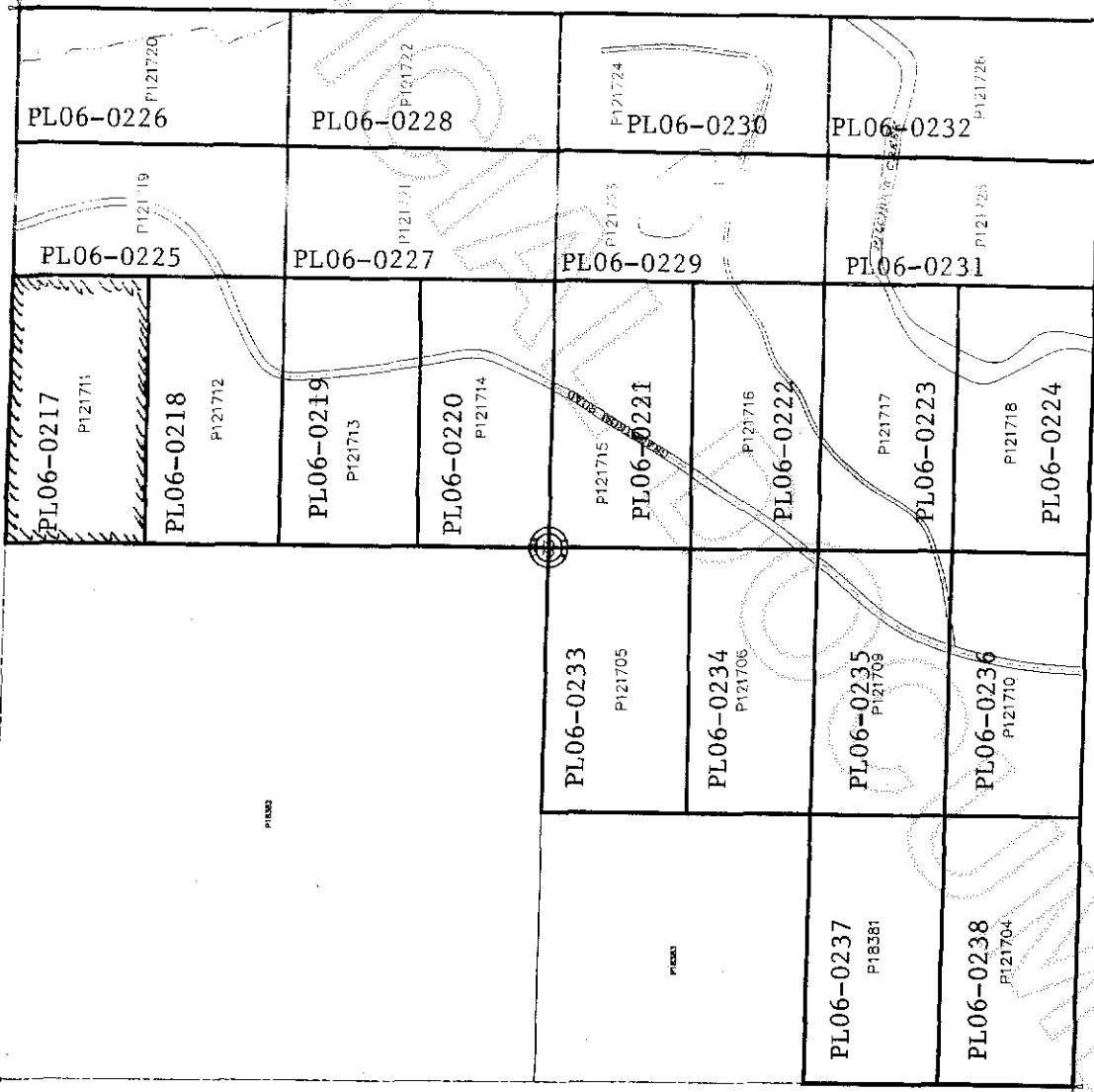

200605030128  
Skagit County Auditor