

Return Name & Address:

Sanfi Acres LLC

103 N. Township Street

Sedro-Woolley, WA 98284



200605030125

Skagit County Auditor

5/3/2006 Page

1 of

2 2:50PM

SKAGIT COUNTY PLANNING & DEVELOPMENT SERVICES

LOT OF RECORD CERTIFICATION

File Number: PL 06 - 0216

Applicant Name: Sanfi Acres LLC

Property Owner Name: Sanfi Acres LLC

Having reviewed the information provided by the applicant, the Department hereby finds that the parcel(s) bearing Skagit County Parcel Number(s):

P#(s): 121815

Lot Size: 20 acres Description: E1/2 SE1/4 SE1/4 28-33-5

1. CONVEYANCE

- ☒ **IS**, a Lot of Record as defined in Skagit County Code (SCC) 14.04.020 or owned by an innocent purchaser who has met the requirements described in SCC 14.18.000(9) and RCW 58.17.210 and therefore IS eligible for conveyance. (*per AF# 901080053*)
- ☐ **IS NOT**, a Lot of Record as defined in SCC 14.04.020 or owned by an innocent purchaser who has met the requirements described in SCC 14.18.000(9) and RCW 58.17.210 and therefore IS NOT eligible for conveyance or development.

2. DEVELOPMENT

- ☐ **IS**, the minimum lot size required for the _____ zoning district in which the lot is located and therefore IS eligible to be considered for development permits.
- ☐ **IS NOT**, the minimum lot size required for the _____ zoning district in which the lot is located, but does meet an exemption listed in SCC 14.16.850(4)(c) _____ and therefore IS eligible to be considered for development permits.
- ☒ **IS NOT**, the minimum lot size required for the IF-NRL zoning district in which the lot is located, does not meet an exemption listed in SCC 14.16.850(4)(c) and therefore IS NOT eligible to be considered for certain development permits.

Authorized Signature: Arac Roeder

Date: 4/25/2006

See attached map for Lot of Record boundaries.

6	5	4	3	2	1
7	6	9	10	11	12
18	17	16	15	14	13
19	20	21	22	23	24
30	29	28	27	26	25
31	32	33	34	35	36

T 33 N R 05 E

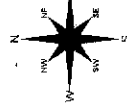

These miles were created from available public records and existing maps, sources not from field surveys. Map boundaries from insurance have been obtained by reference to a list of organizations in the county, and from maps. The data were then used to create the map. The map is not intended to be a replacement for a field survey, but it may assist in the identification of areas for further study. The map is not intended to be a replacement for a field survey, but it may assist in the identification of areas for further study. The map is not intended to be a replacement for a field survey, but it may assist in the identification of areas for further study.

	DATE	INIT.
DRAWN BY	10/17/91	KFM
REVISED	08/04/94	RS
PLOTTED	08/04/94	RS
MAP PROVIDED BY ELBERT COUNTY WASHINGTON SERVICES		

Section 28
T 33 N R 05 E

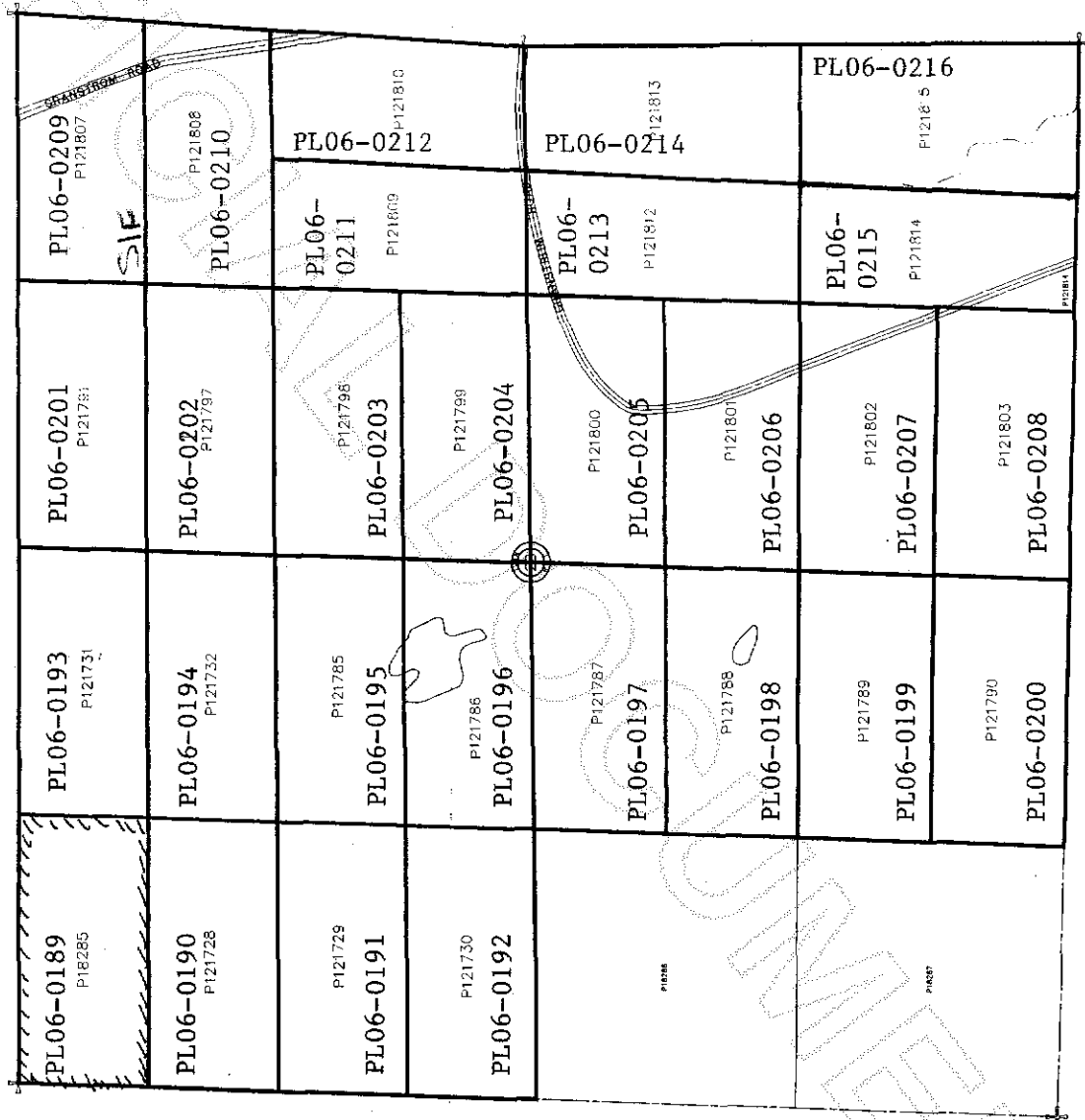

200605030125
Skagit County Auditor