

Return Name & Address:

Sanfi Acres LLC

103 N. Township Street

Sedro-Woolley, WA 98284



200605030104

Skagit County Auditor

5/3/2006 Page

1 of

2 2:45PM

SKAGIT COUNTY PLANNING & DEVELOPMENT SERVICES

LOT OF RECORD CERTIFICATION

File Number: PL 06 - 0195

Applicant Name: Sanfi Acres LLC

Property Owner Name: Sanfi Acres LLC

Having reviewed the information provided by the applicant, the Department hereby finds that the parcel(s) bearing Skagit County Parcel Number(s):

P#(s): 121785

Lot Size: 20 acres Description: N1/2 SE1/4 NW1/4 28-33-5

1. CONVEYANCE

- ☒ **IS**, a Lot of Record as defined in Skagit County Code (SCC) 14.04.020 or owned by an innocent purchaser who has met the requirements described in SCC 14.18.000(9) and RCW 58.17.210 and therefore IS eligible for conveyance. (*per AF# 9011080053*)
- ☐ **IS NOT**, a Lot of Record as defined in SCC 14.04.020 or owned by an innocent purchaser who has met the requirements described in SCC 14.18.000(9) and RCW 58.17.210 and therefore IS NOT eligible for conveyance or development.

2. DEVELOPMENT

- ☐ **IS**, the minimum lot size required for the _____ zoning district in which the lot is located and therefore IS eligible to be considered for development permits.
- ☐ **IS NOT**, the minimum lot size required for the _____ zoning district in which the lot is located, but does meet an exemption listed in SCC 14.16.850(4)(c) _____ and therefore IS eligible to be considered for development permits.
- ☒ **IS NOT**, the minimum lot size required for the IF-NRL zoning district in which the lot is located, does not meet an exemption listed in SCC 14.16.850(4)(c) and therefore IS NOT eligible to be considered for certain development permits.

Authorized Signature: *Mark Roeder*

Date: 4/25/2006

See attached map for Lot of Record boundaries.

6	5	4	3	2	1
7	8	9	10	11	12
18	17	16	15	14	13
19	20	21	22	23	24
30	29	28	27	26	25
31	32	33	34	35	36

33 N R 05 E

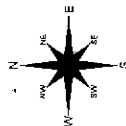

Scale in feet.

These new and improved models will be available in the near future. The new models will be available in the near future. The new models will be available in the near future.

	DATE	INIT.
DRAWN BY	10/17/91	KFM
REVISED	06/04/04	RS
PLOTTED	02/04/04	RS
MAP PRODUCED BY SKAGIT		

Section 28

T 33 N R 05 E

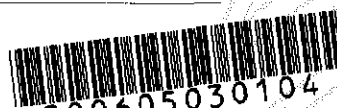
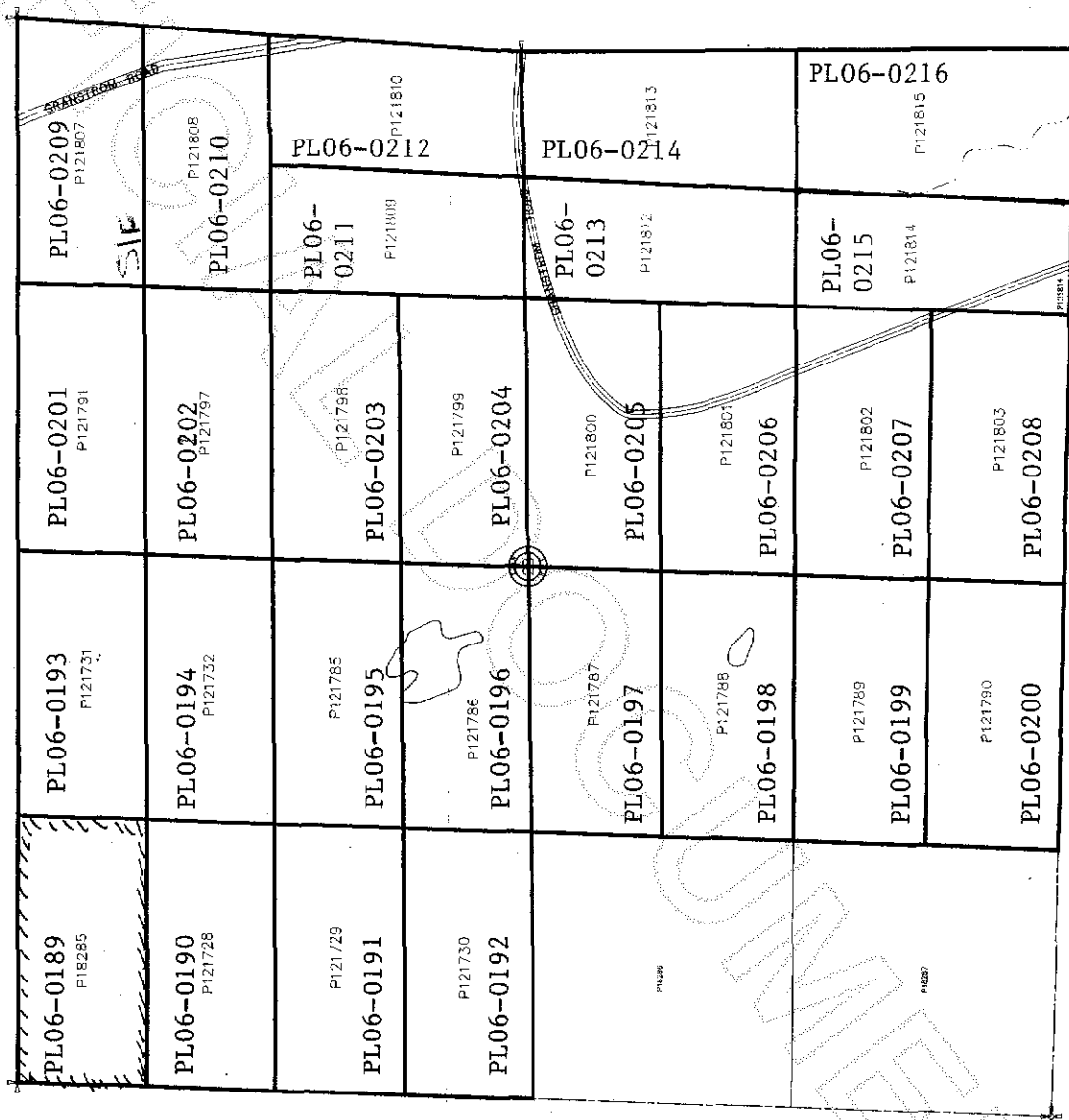

200605030104
Skagit County Auditor