

Return Name & Address:

Sanfi Acres LLC

103 N. Township Street

Sedro-Woolley, WA 98284



200605030098

Skagit County Auditor

5/3/2006 Page

1 of

2 2:44PM

SKAGIT COUNTY PLANNING & DEVELOPMENT SERVICES

LOT OF RECORD CERTIFICATION

File Number: PL 06 - 0189

Applicant Name: Sanfi Acres LLC

Property Owner Name: Sanfi Acres LLC

Having reviewed the information provided by the applicant, the Department hereby finds that the parcel(s) bearing Skagit County Parcel Number(s):

P#(s): 18285

Lot Size: 20 acres Description: N1/2 NW1/4 NW1/4 28-33-5

1. CONVEYANCE

- ☒ **IS**, a Lot of Record as defined in Skagit County Code (SCC) 14.04.020 or owned by an innocent purchaser who has met the requirements described in SCC 14.18.000(9) and RCW 58.17.210 and therefore IS eligible for conveyance. (*per AF# 901080053*)
- ☐ **IS NOT**, a Lot of Record as defined in SCC 14.04.020 or owned by an innocent purchaser who has met the requirements described in SCC 14.18.000(9) and RCW 58.17.210 and therefore IS NOT eligible for conveyance or development.

2. DEVELOPMENT

- ☐ **IS**, the minimum lot size required for the _____ zoning district in which the lot is located and therefore IS eligible to be considered for development permits.
- ☐ **IS NOT**, the minimum lot size required for the _____ zoning district in which the lot is located, but does meet an exemption listed in SCC 14.16.850(4)(c) _____ and therefore IS eligible to be considered for development permits.
- ☒ **IS NOT**, the minimum lot size required for the IF-NRL zoning district in which the lot is located, does not meet an exemption listed in SCC 14.16.850(4)(c) _____ and therefore IS NOT eligible to be considered for certain development permits.

Authorized Signature: Shad Roeder

Date: 4/25/2006

See attached map for Lot of Record boundaries.

SKAGIT COUNTY

6	5	4	3	2	1
7	8	9	10	11	12
13	14	15	16	17	18
19	20	21	22	23	24
25	26	27	28	29	30
31	32	33	34	35	36

T 33 N R 05 E

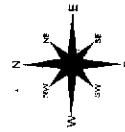

Scale in Feet

This map was created from aerial photography and is not a survey. It is for informational purposes only. The County does not warrant the accuracy of the information shown on this map. The County is not responsible for any errors or omissions on this map. The County is not responsible for any damages or losses resulting from the use of this map. The County is not responsible for any claims or liabilities resulting from the use of this map. The County is not responsible for any claims or liabilities resulting from the use of this map.

DATE	INIT.
5/3/2006	JJA
5/3/2006	RS
5/3/2006	RS
5/3/2006	RS

Section 28
T 33 N R 05 E

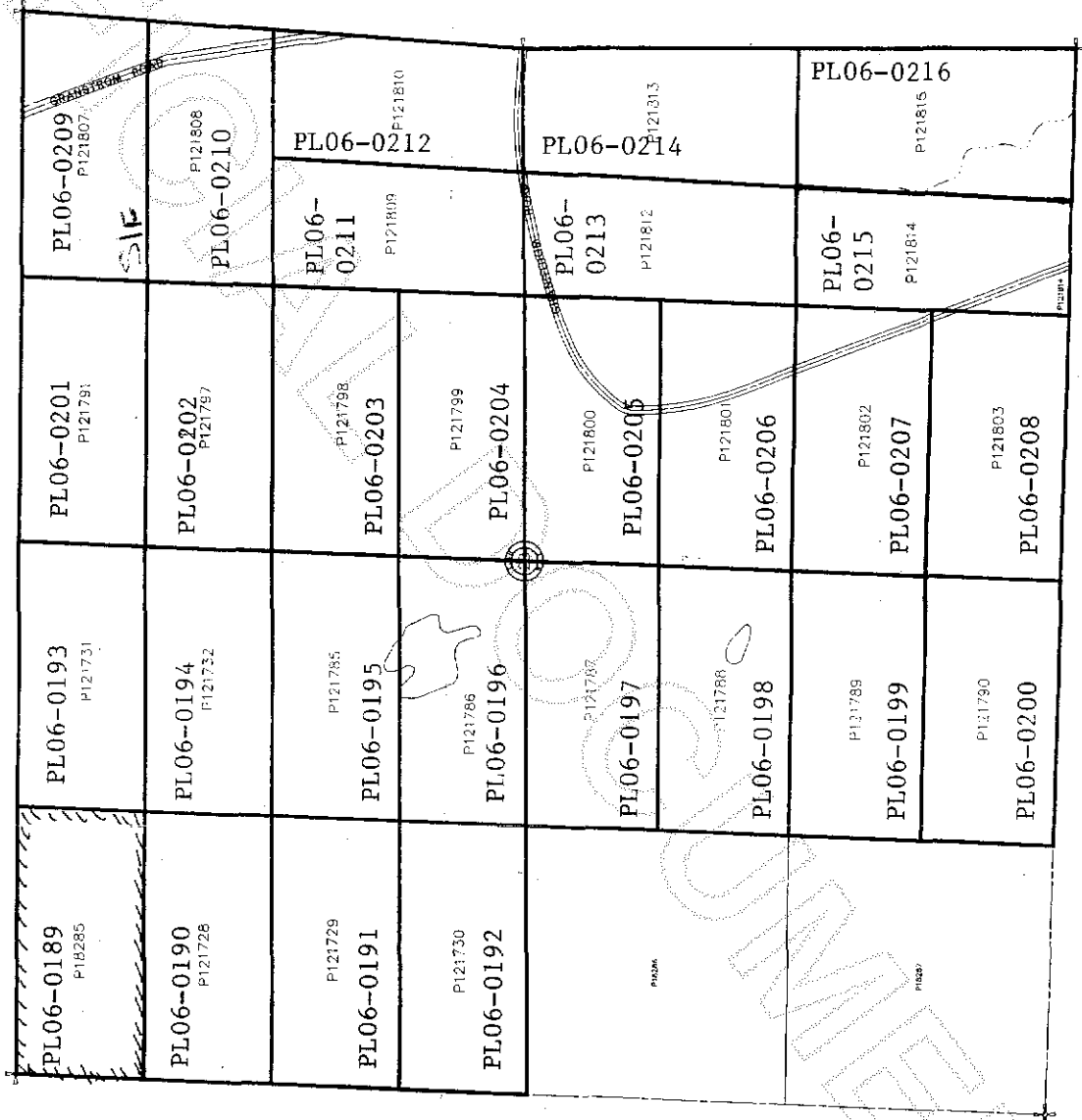

200605030098

Skagit County Auditor