

Auditor's Certificate

Examined by Wen Steadby  
Skagit County Auditor

Basis of Bearings  
N40°00'00"E  
531.90

Volume 7, Plats, Page 85

26th Street

corner is located on  
concrete driveway.  
Reference Monument Set  
Corner Bears  
500°00'00"W 5.26

Boat Nail in  
Concrete, 0.3'  
below grade

curb

aerial

utility line

curb

Survey Monument  
(Aluminum Disk)  
M. 00°00'00"E  
30.00

N40°00'00"E  
78.38

1" Diameter Pipe  
Corner Bears  
N89°41'45"W 1.46

N40°00'00"E  
78.38

1" Diameter Pipe  
Corner Bears  
S88°02'06"W 1.63

1.7'

N40°00'00"E  
78.38

sidewalk

House No. 1807

Driveway

concrete driveway

Avenue M

300°00'00"E  
887.42

Cased Monument  
24th St. & Ave. M

Lot 18

Lot 17  
9.445 sq. ft.  
0.22 acres

Lot 16

Corner obstructed by  
fences. Reference  
Monument Set.  
Corner Bears  
500°00'00"E 1.60

shed

concrete walk

Concrete  
Pad

Garage

Stone & Mortar Wall

Hedge

Corner Monument set  
north of and adjacent to  
5' high concrete retaining wall

Woven wire fence on line

Lot 18

Lot 9

Land Description

Auditor's File Number 200510180123

Lot 17, Replat of Lots 25 through 48, View Acres Addition to Anacortes, according to the  
plat thereof recorded in Volume 7 of Plats, Page 85, records of Skagit County, Washington  
Subject to easement as contained in the dedication of said plat for slopes, cuts, fills and  
continued drainage of roads.

Survey Notes

This survey has been prepared from a closed random traverse using an electronic instrument  
measuring angles to 5 seconds of arc and distances rounded to hundredths of feet.  
The purpose of this survey has been to locate and describe and to set monuments to mark  
the existing boundaries of the above described parcel.  
Improvements on the parcel adjoining the east boundary appear to be encroaching as noted  
above.

Surveyor's Certificate

This is to certify that this survey made at the request of Bart X. Pestarino and Chicago Title  
Company was prepared in accordance with the minimum standard detail requirements for  
ALTA/ACSM Land Title Surveys as jointly established and adopted by the American Land  
Title Association, the American Congress on Surveying and Mapping and the National Society  
of Professional Surveyors in 1997 pursuant to the accuracy standards for a Suburban survey.

January 28, 2006, Robert F. Parrish PLS License Number 24535

Robert F. Parrish

Graphic Scale

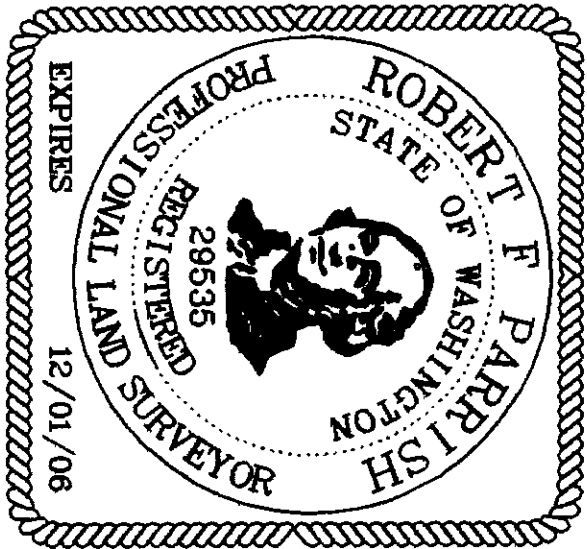
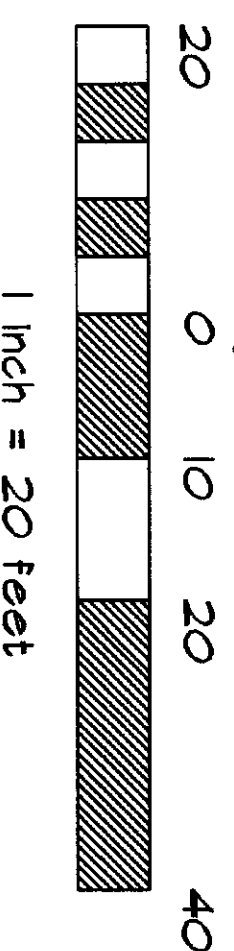

Parrish Land Surveying

142 BLOSSOM LANE, PORT TOWNSEND, WA. 98368  
Anacortes (360) 588-1467 - parrish@rockisland.com

Bart X. Pestarino

Located within the Northwest 1/4, Section 24, Township 35,  
North, Range 1 East, W1/4, City of Anacortes, Fladigo Island,  
Skagit County, Washington

JOB NO.: 601-248

CADD BY: RP

CHK BY:

BK REF: 11

SCALE: 1" = 20'

DATE: 1-21-06