

LEGAL DESCRIPTION

THAT PART OF LOT 37, "PLAT OF POTLATCH BEACH" ACCORDING TO THE PLAT RECORDED IN VOLUME 6 OF PLATS, PAGE 10, RECORDS OF SNAKE COUNTY, WASHINGTON, LYING ABOVE THE LINE OF EXTREME HIGH TIDE. TOGETHER WITH A 1/75 UNDIVIDED INTEREST IN: LOTS 19 TO 56 INCLUSIVE, "PLAT OF POTLATCH BEACH", LYING BELOW THE LINE OF EXTREME HIGH TIDE, AND TIDELANDS OF SECOND CLASS SITUATED IN FRONT OF OR ADJACENT TO AND ABUTTING UPON SAID LOTS 19 TO 56 INCLUSIVE.

NOTES:

1. CONTROLLING MONUMENTS WERE VISITED AS SHOWN
2. ● DENOTES 5/8" REBAR AND YELLOW CAP IMPRINTED "AZIMUTH NW 21591° SET THIS SURVEY."
△ DENOTES 2" X 2" WOODEN HUB SET
○ DENOTES EXISTING CORNER FOUND AS NOTED
—X— DENOTES EXISTING FENCE LINE.
3. THIS SURVEY PERFORMED BY FIELD TRAVERSE USING A 3-SECOND ELECTRONIC DISTANCE MEASURING THEODOLITE.
4. BASIS OF BEARING: N60°26'37"E ALONG MONUMENTED SALMON RUN RD. PER PLAT OF POTLATCH DN/2 (A.F.#758305)
5. LEGAL DESCRIPTION TAKEN FROM QUIT-CLAIM DEED RECORDED UNDER AUDITOR'S FILE NO. 9906300096 IN BOOK 2012 ON PAGE 559.
6. THIS SURVEY WAS PERFORMED WITHOUT BENEFIT OF A CURRENT TITLE REPORT.

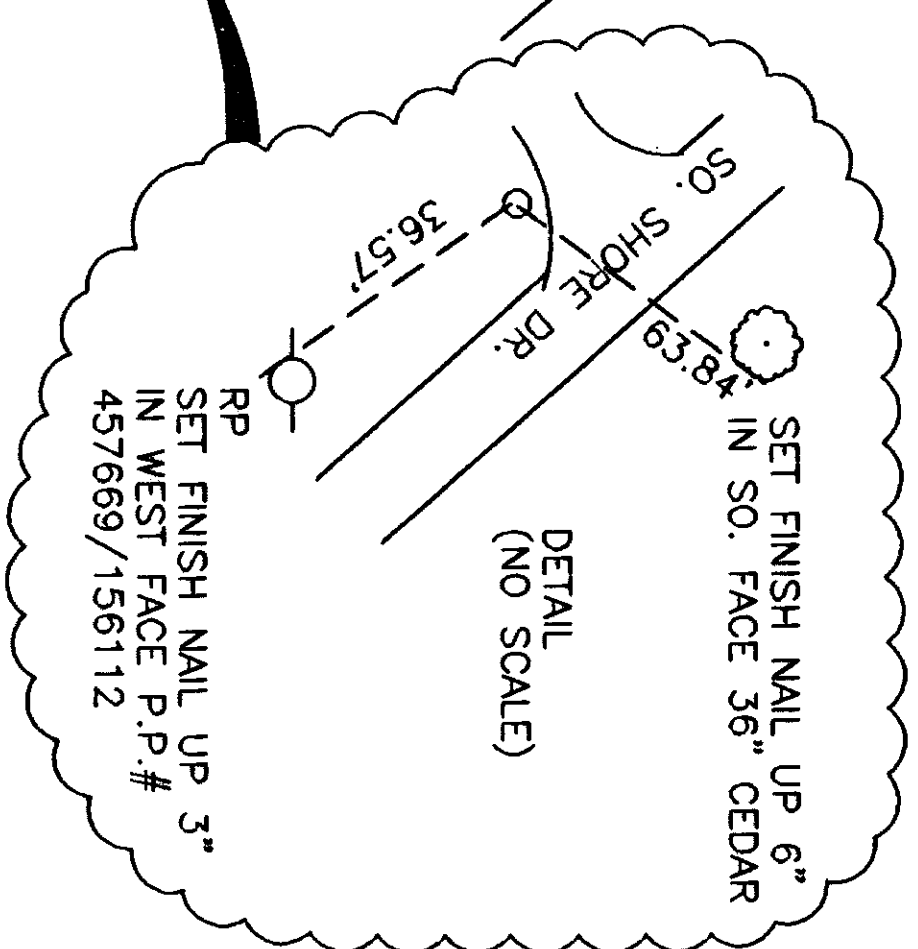

AUDITOR'S CERTIFICATE

Filed for Record at the request of AZIMUTH NORTHWEST, INC.

200604210106
Skagit County Auditor
4/21/2006 Page 1 of 1 1:17PM

J. Brummett
SKAGIT COUNTY AUDITOR

Debra Stetson
DEPUTY

SURVEYOR'S CERTIFICATE

This map correctly represents a survey made by me or under my direction in conformance with the requirements of the SURVEY RECORDING ACT at the request of OKANEETA SCHOFIELD
IN DEC 2005
Stuart B. VonBuren, Jr., P.L.S.
Certificate No. 21591

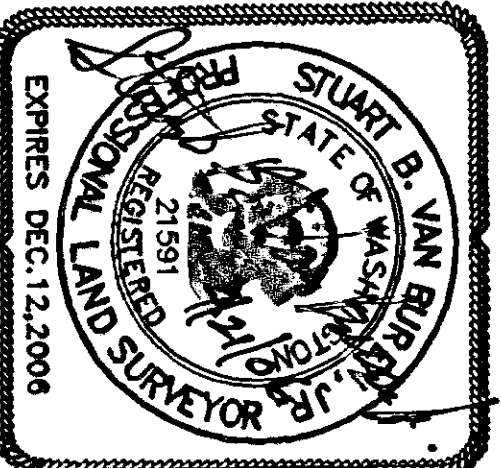

AZIMUTH NORTHWEST, INC.
17963 WOOD ROAD
BOW, WA, 98232
[360] 724-7320

SURVEY IN THE N.W. QUARTER
SECTION 35, T.36N., R.1E., W.M.
SKAGIT COUNTY, WASHINGTON
FOR
OKANEETA SCHOFIELD
DWG:0787ROS1.DWG DATE: DEC., 2005 SHEET 1 OF 1
CHECKED: SVB SCALE: 1" = 40' JOB NO. 05.0787