

Survey in the SW1/4 of the SE1/4, the NW1/4 of the SE1/4, the SE1/4 of the SW1/4 of Section 7, Twp. 35 N., Rng. 6 E., W.M.

FOUND CONCRETE MONUMENT WITH BRASS CAP ON 4/6/05.

S00°03'48"E 2638.97'

COMPUTED FROM SURVEY RECORDED IN VOLUME 1 OF SURVEYS AT PAGE 105.

FOUND 1" IRON PIPE WITH YELLOW CAP L.S.#5702

FOUND CONCRETE MONUMENT AND BRASS CAP ON 1/17/02

120.7' 1918.21'

S88°19'13"W 3253.78'

208.38' 144.81' 68.41' 159.77' 122.80' 1335.57'

394.25' 237.15'

S88°19'13"W 2674.58'

100.03' 100.02' 1337.29'

1260.87'

1260.87'

S00°14'04"W 2521.74'

Notes

1. Basis-of-bearings - Assumed S88°19'13"W on the north line of the southeast quarter of section 7.
2. This survey was accomplished by field traverse using: 3 second or better digital electronic total station, and meets or exceeds the standards contained in WAC 332-130-090.
3. Only those portions of the subject properties where reinforcing rods were set were visited during this survey.

Hamerski

Hamerski Legal Description

The Southeast Quarter of the Southwest Quarter of Section 7, Township 35 North, Range 6 East of the Willamette Meridian. TOGETHER WITH The Northeast Quarter of the Southwest Quarter of Section 7, Township 35 North, Range 6 East of the Willamette Meridian. EXCEPT North one-quarter of the Northeast Quarter of the Southwest Quarter of Section 7, Township 35 North, Range 6 East of the Willamette Meridian.

Blunt Legal Description

PARCEL A: Northeast Quarter of the Northeast Quarter of said Northwest Quarter of the Southeast Quarter of Section 7, Township 35 North, Range 6 East of the Willamette Meridian.

PARCEL B: The Northwest Quarter of the Southeast Quarter of Section 7, Township 35 North, Range 6 East of the Willamette Meridian, EXCEPT the Northeast Quarter of the Northwest Quarter of the Southeast Quarter.

PARCEL C: That portion of the Southwest Quarter of the Southeast Quarter of Section 7, Township 35 North, Range 6 East of the Willamette Meridian, lying Northerly of the following described line: Beginning at a point on the West line of said subdivision that lies 770 feet North of the Southwest corner thereof; Thence Southeasterly in a straight line a distance of 1,344.4 feet, more or less, to a point on the East line of said subdivision that lies 470 feet North of the Southeast corner thereof.

PARCEL D: The North one-quarter of the Northeast Quarter of the Southwest Quarter of Section 7, Township 35 North, Range 6 East of the Willamette Meridian.

Blunt 71.20 Acres

Legend

- Set 1/2" X 18" reinforcing rod with yellow plastic cap marked "SKA SURV 17651" and white 2" X 2" witness stake, except as noted.

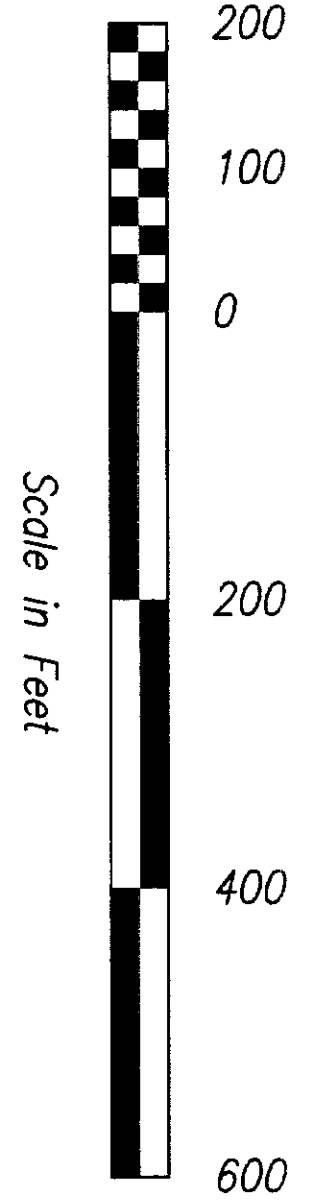

Scale in Feet

FOUND CONCRETE MONUMENT ON APRIL 30, 1979, (SET BY RADER AND LEONARD ON SURVEY FILED IN VOL. 1 OF SURVEYS AT PAGE 105). SEARCHED FOR AND NOT FOUND DURING SURVEY RECORDED UNDER A.F.#199912140015. APPARENTLY OBLITERATED BY SLOPE MOVEMENT

SOUTH QUARTER CORNER ESTABLISHED FROM FENCES ALONG THE NORTH-SOUTH CENTERLINE OF SECTION 18. SEE SURVEY OF SHORT PLAT NO. 97-0026 FILED IN AUDITORS FILE NUMBER 199912140015 FOR ADDITIONAL INFORMATION.

FOUND 2" IRON PIPE IN FENCE LINE ON 7/30/80. REVISITED ON 1/08/02.

N85°45'53"E 3254.46'

N85°45'53"E 2667.48'

Survey for William Blunt and Anthony Hamerski

skagit Surveyors & Engineers

806 Metcalf St., Sedro-Woolley, WA 98284 Phone: (360) 855-2121 FAX: (360) 855-1658

COPYRIGHT 2004 SKAGIT SURVEYORS, INC

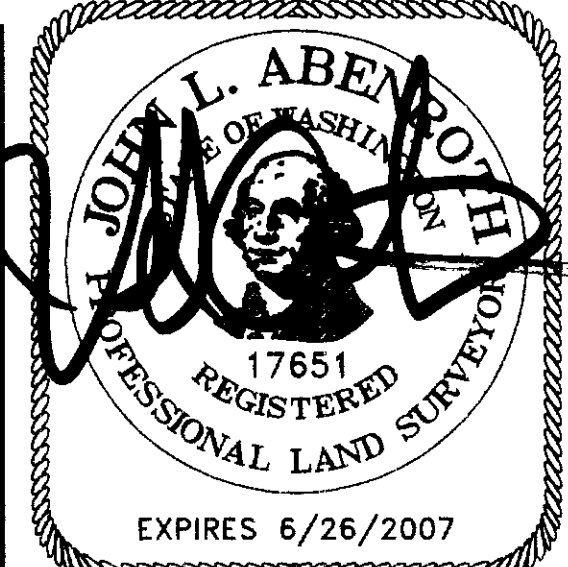

SURVEYOR'S CERTIFICATE
This map correctly represents a survey made by me or under my direction in conformance with the Survey Recording Act in July 2005 at the request of William Blunt.

John L. Abenroth CERT#17651
Date 3/20/06

AUDITOR'S CERTIFICATE



200604070095
Skagit County Auditor
4/7/2006 Page 1 of 1 1:38PM

County Auditor or Deputy Auditor