

Return Name & Address:

200601300219
Skagit County Auditor
1/30/2006 Page 1 of 2 2:05PM

SKAGIT COUNTY PLANNING & DEVELOPMENT SERVICES

LOT OF RECORD CERTIFICATION

File Number: PL00-0552

Applicant Name: Mark Frost

Property Owner Name: Mark S. Frost Sr.

Having reviewed the information provided by the applicant, the Department hereby finds that the parcel(s) bearing Skagit County Parcel Number(s): P73244

Lot Size: .28 Description: 4101-175-008-0002

1. CONVEYANCE

- ☒ **IS**, a Lot of Record as defined in Skagit County Code (SCC) 14.04.020 or owned by an innocent purchaser who has met the requirements described in SCC 14.18.000(9) and RCW 58.17.210 and therefore IS eligible for conveyance. (*per AF# AF#*)
- ☐ **IS NOT**, a Lot of Record as defined in SCC 14.04.020 or owned by an innocent purchaser who has met the requirements described in SCC 14.18.000(9) and RCW 58.17.210 and therefore IS NOT eligible for conveyance or development.

2. DEVELOPMENT

- ☐ **IS**, the minimum lot size required for the _____ zoning district in which the lot is located and therefore IS eligible to be considered for development permits.
- ☒ **IS NOT**, the minimum lot size required for the Rural Intermediate (RI) zoning district in which the lot is located, but does meet an exemption listed in SCC 14.16.850(4)(c) (iv) and therefore IS eligible to be considered for development permits.
- ☐ **IS NOT**, the minimum lot size required for the _____ zoning district in which the lot is located, does not meet an exemption listed in SCC 14.16.850(4)(c) and therefore IS NOT eligible to be considered for certain development permits.

Authorized Signature: _____

Jeanne Oatland

Date: July 26, 2005

See attached map for Lot of Record boundaries.

6	5	4	3	2	1
7	8	9	10	11	12
18	17	16	15	14	13
19	20	21	22	23	24
30	29	28	27	26	25
31	32	33	34	35	36

T 34 N R 02 E

ATTENTION

THIS MAP CONTAINS A PARCEL ACCOUNT THAT HAS BEEN PLACED WITH THE BEST AVAILABLE INFORMATION. THE EXACT LOCATION OF THIS PARCEL IS UNKNOWN.

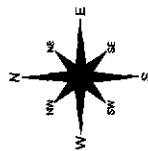

Scale in feet

These maps were created from available public records, including deed and farm data records. The features from all sources have been combined into a single map, and the data are self-referential to achieve a "best fit" registration to the Chesapeake Potomac map. While great care was taken in this process, maps from different sources taken in the same areas, maps from different sources rarely agree on the precise location of geographic features. The machine processing of map features to one another makes them "contaminating" different maps without the need for "best fit" matching.

	DATE	INIT.
DRAWN BY	6/16/96	LMS
REVISED	08/27/05	MS
PLOTTED	09/21/05	RS

MAP PRODUCED BY SHAGIT
 and its associated data files

Section 19
T 34 N R 02 E

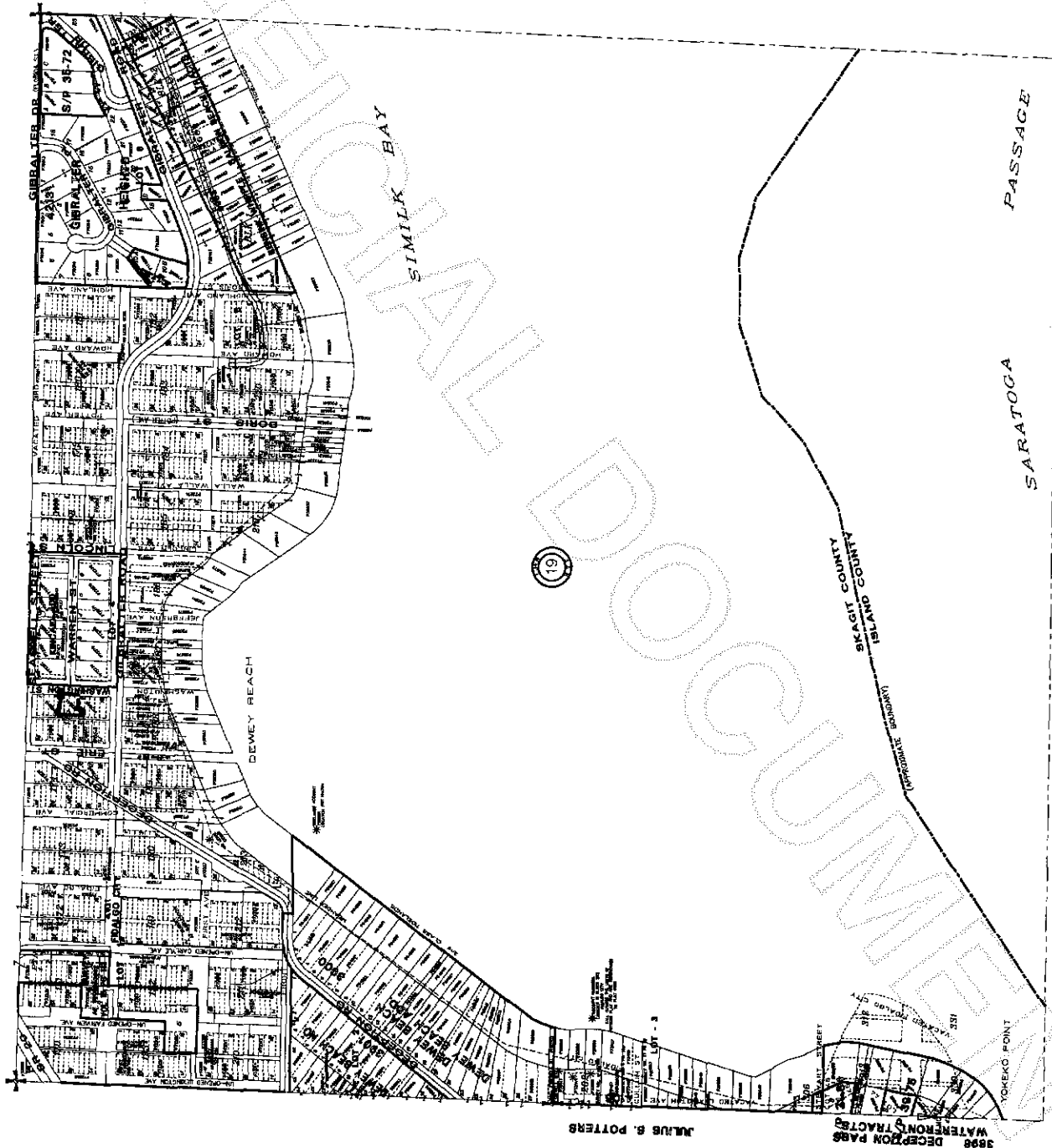

20060130221

200601300219
Skagit County Auditor