

AUDITOR'S CERTIFICATE

Filed for the record at the request of Legro & Associates.

200601200116  
Skagit County Auditor  
1/20/2006 Page 1 of 1 11:15:00AM

N. Bunnell  
Skagit County Auditor  
Deputy  
Queen Stodley

LEGAL DESCRIPTION

Lot 13 and the East 1/2 of Lot 14, "Samish Shores Plat, Skagit County, Washington," as per plat recorded in Volume 8 of Plats, pages 7 and 7A, records of Skagit County, Washington.

Situate in the County of Skagit, State of Washington.

NOTES

1. Legal Description for this survey is taken from that Statutory Warranty Deed from Barbara Wallen Williams, Judith Ann Moore and Kristine Louise Wallen, Grantors to Tom Theisen and Ann Reid, h & w, Grantees by that instrument dated September 9, 2003 and recorded September 16, 2003 under Auditor's File No. 200309160116, records of Skagit County, Washington.
2. For additional survey information refer to Plat of Samish Shores, and Record of Survey map recorded under Auditor's File no. 200406040039, all records of Skagit County, Washington.
3. Basis of Bearing — the monumented South line of Gov't Lots 3 and 4, Section 26, T. 36 N., R. 2 E.W.M. as being S 89°44'30" E.
4. Meridian — Assumed
5. Survey Method: Field Traverse  
Instrumentation: TOPCON GTS 2-B(20)  
Theodolite: Min. Horiz. Circle Reading of 20"  
E.D.M.: Accuracy  $\pm$  (5mm + 5ppm)

6. This survey has been performed without the benefit of a current Title Report and as such is subject to any Easements, Restrictions, Reservations, Covenants, Conditions or other instruments of record, if any.
7. Distance shown are in feet and decimals of a foot.

LEGEND

- Set 5/8" Diam. X 18" Length Steel Rebar w/ Yellow Plastic Cap Imprinted: "LEGRO 37532"
- FOUND R&L 0.13-S 0.02-W Found Old 1" Iron Pipe w/ Yellow plastic Cap Imprinted: "R & L 8992", 0.13' South and 0.02' West of calculated Position.
- FOUND PIPE Found Old 1 1/2" Iron Pipe
- FOUND REBAR CAP MISSING Found Rebar with Cap Missing
- ⊙ FOUND MON (+-19-2004) Found Monument — Cased. Date Last Visited April 19, 2004.

Found/Set Refers to the Date of this Survey Unless Otherwise Noted.

RECORD OF SURVEY

TOM THEISEN PROPERTY SURVEY

LOT 13 & E 1/2 LOT 14

SAMISH SHORES PLAT

PTN. OF GOV'T LOT 3, SECTION 26, T. 36 N., R. 2 E.W.M.

SKAGIT COUNTY, WASHINGTON

SURVEYOR'S CERTIFICATE

This map correctly represents a survey made by me or under my direction in conformance with the requirements of the Survey Recording Act in January 2006 at the request of Tom Theisen.

LEGRO & ASSOCIATES  
Engineer & Land Surveyors  
815 Cleveland Avenue  
Mount Vernon, WA 98273  
Phone: (360) 336-3220

DENNY D. LEGRO  
Registered Professional  
Land Surveyor  
Lic # 37532 Date: 1-18-06



DRAWN BY: TTH



SECTION CORNER  
FOUND 2" IRON PIPE -  
CASED  
(4-19-2004)

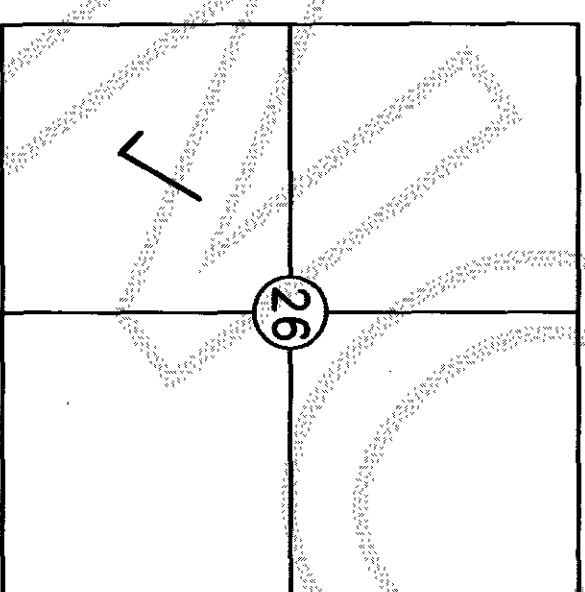

VICINITY MAP  
(Not to Scale)  
Sec. 26, T. 36 N., R. 2 E.



PLAN

S 1/4 COR.  
FOUND BRASS  
DISK IN CONC.  
MON. PLUNCHED  
& CASED

649.98 N 0°02'00" W (HELD PLAT)

HALLORAN ROAD  
842.87 (HELD PLAT)  
2667.61 S 89°44'30" E

MERCER ROAD

650.00 N 0°50'45" E (HELD PLAT)

WALLEN ROAD  
852.84 S 89°44'30" E (HELD PLAT)  
772.46

