

Short Plat No. PL05-0258

1. SHORT PLAT NUMBER AND DATE OF APPROVAL SHALL BE INCLUDED IN ALL DEEDS AND CONTRACTS.  
2. ALL PRIVATE ROADS, EASEMENTS, COMMUNITY UTILITIES AND PROPERTIES SHALL BE OWNED AND MAINTAINED BY SEPARATE CORPORATE ENTITY OR THE OWNERS OF PROPERTY SERVED BY THE FACILITY AND KEPT IN GOOD REPAIR AND ADEQUATE PROVISIONS SHALL BE MADE FOR APPROPRIATE PRO-RATA CONTRIBUTIONS FOR SUCH MAINTENANCE BY ANY FUTURE LAND DIVISIONS THAT WILL ALSO USE THE SAME PRIVATE ROAD.  
IN NO CASE SHALL THE COUNTY ACCEPT A DEDICATION OR ANY OBLIGATION AS TO ANY SUCH ROAD, STREET, AND/OR ALLEY UNTIL THE SAME AND ALL ROADS, STREETS, AND/OR ALLEYS CONNECTING THE SAME TO THE FULL, CURRENT COUNTY ROAD SYSTEM HAVE BEEN BROUGHT TO FULL, CURRENT COUNTY ROAD STANDARDS AND A RIGHT-OF-WAY DEED HAS BEEN TRANSFERRED TO AND ACCEPTED BY THE COUNTY.  
LOCATED APPROXIMATELY ON THE NORTH LINE OF THE COLLECTOR RIVERED OF SECTION 22

THAT PORTION OF THE NORTHEAST 1/4 OF THE SOUTHWEST 1/4 OF SECTION 22, TOWNSHIP 36 NORTH, RANGE 3 EAST, W.M., DESCRIBED AS FOLLOWS:

THE CORNER OF SAID SECTION 22; THENCE DUE WEST 80 RODS TO A STAKE ON THE RIGHT BANK OF THE MCLEARY SLOUGH; THENCE SOUTH 22 1/2° EAST 40 RODS AND 13 LINKS TO A STAKE LOCATED AT THE CORNER OF A DIKE ON THE RIGHT BANK OF SAID MCLEARY SLOUGH; THENCE NORTH 62 1/2° EAST A DISTANCE OF 75 RODS MORE OR LESS, TO THE POINT OF BEGINNING;

MOREOVER, THAT PORTION LYING WITHIN THE AS BUILT AND EXISTING FLUIN STREET,

KNOW ALL MEN BY THESE PRESENTS THAT WE THE UNDERSIGNED SUBMIDWERS HEREBY CERTIFY THAT THIS SHORT PLAT IS MADE AS OUR FREE AND VOLUNTARY ACT AND DEED.

*[Signature]*

DANIEL ALMAN  
Offic. & Bookkeeper  
CHICKSAUT MANOR, INC.  
*[Initials]*

WELLS FARGO BANK N/A.  
Loan Officer  
*[Signature]*  
Vice President

WELLS FARGO BANK N/A.  
Commercial Lending Services Division

STATE OF WASHINGTON, COUNTY OF SKagit  
I CERTIFY THAT I KNOW OR HAVE SATISFACTORY EVIDENCE THAT DAVID ALLAN SIGNED THIS INSTRUMENT AND  
ACKNOWLEDGED IT TO BE HIS FREE AND VOLUNTARY ACT FOR THE USES AND PURPOSES MENTIONED IN THE  
INSTRUMENT.

NOTARY SIGNATURE [Signature] TITLE NOTARY  
DATE 11/21/05 MY APPOINTMENT EXPIRES July, 2006

**Notary Public**  
**State of Washington**  
**LOUIS H. REOLA**  
**My Appointment Expires July 1, 2006**

I, LORENA L. SLAUGHTER, SIGNED THIS  
 STATEMENT BECAUSE OF MY SATISFACTORY EVIDENCE THAT LORENA L. SLAUGHTER  
 INSTRUMENT ON DATA STATED THAT HE/SHE WAS AUTHORIZED TO EXECUTE THE INSTRUMENT AND ACKNOWLEDGED IT  
 AS THE SOLE GRANTOR OF WELLS FARGO BANK TO BE THE FREE AND VOLUNTARY ACT OF SUCH  
 PARTY FOR THE USES AND PURPOSES MENTIONED IN THE INSTRUMENT.

NOTARY SIGNATURE Carol J. Grier TITLE Notary  
 DATE 12/26/05 MY APPOINTMENT EXPIRES 5/29/09



The seal of the Federal Bureau of Investigation (FBI) is located in the top right corner of the document. It features a circular design with the words "DEPARTMENT OF JUSTICE" and "FEDERAL BUREAU OF INVESTIGATION" around the perimeter, and a central shield with various symbols.

STATE OF WASHINGTON, COUNTY of Strasburg  
I CERTIFY THAT I KNOW OR HAVE SATISFACTORY EVIDENCE THAT Barrie A. Woodard SIGNED THIS INSTRUMENT, ON DATH KNOWN THAT HE/SHE WAS AUTHORIZED TO EXECUTE THE INSTRUMENT AND ACKNOWLEDGED IT AS THE President OF CHUCKANUT MANOR, INC., TO BE THE LEGAL VOLUNTARY ACT OF SUCH PARTY FOR THE USES AND PURPOSES MENTIONED IN THE INSTRUMENT.

NOTARY SIGNATURE David J. Boyes TITLE Notary Public  
DATE 12/20/03 MY APPOINTMENT EXPIRES 8-1-09

8  
COMMISSION EXPIRES  
NOTARY PUBLIC  
DAVID J. BOYES  
12-20-03

STATE OF  
TERRILL L. BOYES  
COMMISSION EXPIRES  
NOTARY PUBLIC  
8-17-2009

STATE OF Washington COUNTY OF Franklin **NOT**  
 I CERTIFY THAT I KNOW OR HAVE SATISFACTORY EVIDENCE THAT Calvernie, Cuba CHINSENGED THIS  
 INSTRUMENT, ON DATH STATED THAT HE/SHE WAS AUTHORIZED TO EXECUTE THE INSTRUMENT AND ACKNOWLEDGED IT  
 AS THE Assistant Secretary OF WELLS FARGO BANK TO BE THE RIGHT AND VOLUNTARY ACT OF SUCH  
 PARTY FOR THE USES AND PURPOSES MENTIONED IN THE INSTRUMENT.

THIS IS TO CERTIFY THAT ALL TAXES HERETOFORE LEVIED AND WHICH HAVE BECOME A LIEN ON THE LANDS HEREIN DESCRIBED HAVE BEEN FULLY PAID AND DISCHARGED ACCORDING TO THE RECORDS OF MY OFFICE UP TO AND INCLUDING THE YEAR 200..

12/28/05  
DATE

THE WITHIN AND FOREGOING SHORT PLAT IS APPROVED IN ACCORDANCE WITH THE PROVISIONS OF SKAGIT COUNTY  
CODE TITLE 74.18 (LAND DIVISIONS) THIS 15<sup>th</sup> DAY OF February 2006

Don Nolan  
SHORT PLAT ADMINISTRATOR

Steve Hulse  
COUNTY ENGINEER

THE WHINN AND FOREGOING SHORT PLAT IS APPROVED IN ACCORDANCE WITH THE PROVISIONS OF SKEGHT COUNTY  
CODE TITLE 12.05 (ON-SITE SEWAGE) AND 12.48 (WATER) THIS 3 DAY OF Jan 2006  
Edward M. S.  
SKEGHT COUNTY HEALTH OFFICER

Owner/Developer

DAVID ALLAN  
P.O. BOX 98  
BOW, WA. 98232

## Short Plat for David Allan

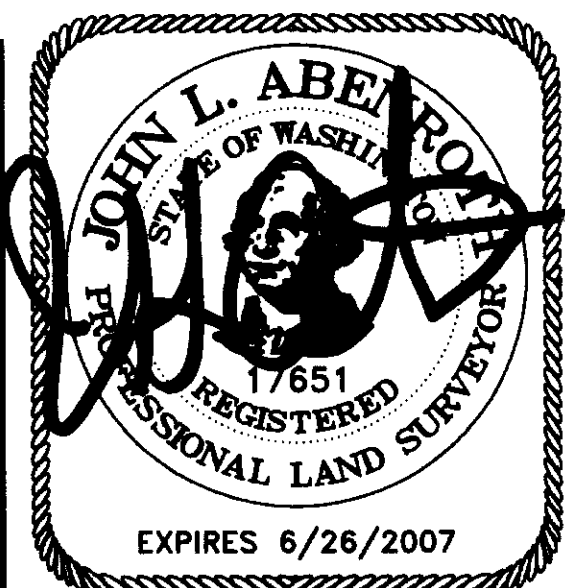

**SURVEYOR'S CERTIFICATE**  
This map correctly represents a survey made by me or under my direction in conformance with the Survey Recording Act in November 2005 at the request of David Allan.

John L. Abenroth CERT#17651  
Date 10/10/16

## AUDITOR'S CERTIFICATE



200601060080  
Snohomish County Auditor

1/6/2006 Page 1 of 2 10:29AM

Norma Bammert Quelly  
County Auditor or Deputy Auditor

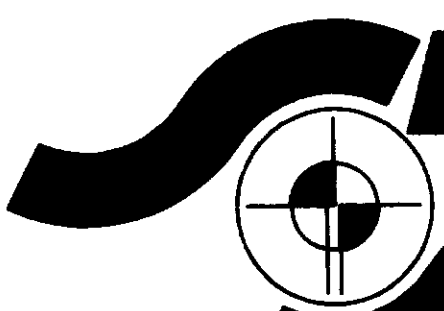

# Surveyors & Engineers

806 Metcalf St., Sedro-Woolley, WA 98284 Phone: (360) 855-2121 FAX: (360) 855-1658



FOUND CONCRETE MONUMENT WITH BRASS CAP 1.5' BELOW SURFACE AND 65' WEST OF CHICKENHUT DRIVE ON 3/30/98.

FENCE LINE ENCROACHES ONTO ADJACENT PROPERTY BY 23.8'

FENCE LINE ENCROACHES ONTO ADJACENT PROPERTY BY 29.7'

TOE OF SLOPE, ZONING BOUNDARY & FLOOD ZONE BOUNDARY

FOUND 3" ROUND CONCRETE MONUMENT WITH BRASS CAP ON 3/16/98.

FOUND REINFORCING ROD WITH YELLOW PLASTIC CAP L.S.#22960 ON 10/18/05.

FOUND 1" IRON PIPE WITH PLUG AND TACK ON 3/30/98.

NORTH OF ROAD - 350,025 S.F.  
SOUTH OF ROAD - 25 S.F.  
TOTAL - 350,050 S.F. 8.04 ACRES  
(AGRICULTURE-NRL)

### Legend

Set 1 1/2" X 18" reinforcing rod with yellow plastic cap marked "SKA SURV 17651", and 3/8" X 48" white fiberglass post with label marked "PCA".

Set 1 1/2" X 18" reinforcing rod with yellow plastic cap marked "SKA SURV 17651", and 3/8" X 48" white fiberglass post with label marked "PCA".

Edge of Ditch/Pond  
Edge of Gravel Roadway  
Top of Slope  
Protected Critical Area Boundary  
Toe of Slope (Zoning Boundary)

Soil Log Hole  
Proposed Access Locations.

### Rural Reserve Minimum Setback Requirements

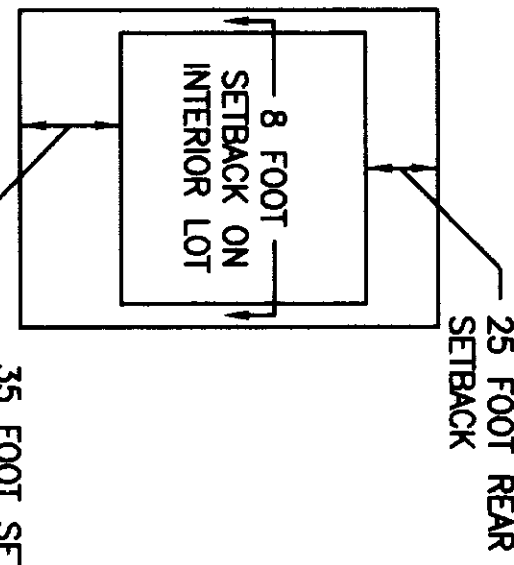

### Agriculture-NRL Minimum Setback Requirements

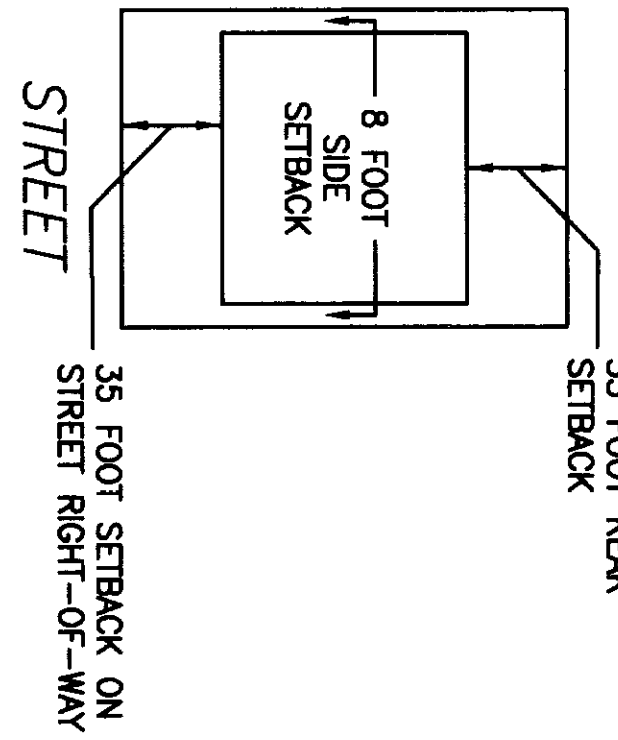

#	BEARING	DISTANCE	#	BEARING	DISTANCE
L1	N19°38'27"W	5.13'	L24	N67°14'14"W	64.32'
L2	N29°42'52"W	66.29'	L25	S89°55'45"E	155.09'
L3	N00°04'45"E	19.90'	L26	N23°35'19"E	94.75'
L4	N09°22'02"W	47.01'	L27	N12°55'22"E	41.65'
L5	N05°00'58"W	17.34'	L28	S39°55'45"E	185.89'
L6	N28°29'18"W	41.90'	L29	S45°08'11"W	77.58'
L7	N45°15'35"W	19.97'	L30	S21°36'46"W	60.51'
L8	N00°04'45"E	12.41'	L31	S21°36'46"W	15.41'
L9	S17°38'26"W	32.18'	L32	S21°36'46"W	25.01'
L10	S05°02'38"W	44.37'	L33	S21°36'46"W	58.59'
L11	S24°07'02"W	39.25'	L34	S60°39'18"W	58.59'
L12	S13°55'15"W	66.12'	L35	N70°26'26"E	87.02'
L13	S27°02'26"W	34.63'	L36	N74°36'07"E	106.11'
L14	S33°15'17"W	22.20'	L37	N76°41'56"E	15.16'
L15	S23°34'56"W	17.57'	L38	N05°00'58"W	15.63'
L16	S35°09'53"E	25.20'	L39	S83°56'18"E	16.53'
L17	N36°35'42"W	25.20'	L40	N40°38'33"E	27.27'
L18	S60°39'18"W	7.94'	L41	N03°47'40"E	37.38'
L19	N19°38'27"W	3.75'	L42	N60°48'55"E	25.69'
L20	N76°24'18"E	13.62'	L43	N29°49'06"E	118.24'
L21	S60°39'18"W	13.74'	L44	S77°47'05"E	49.22'
L22	N19°38'27"W	50.28'	L45	N66°06'39"E	90.31'
L23	S13°55'15"W	10.18'	L46	N24°31'18"E	52.84'

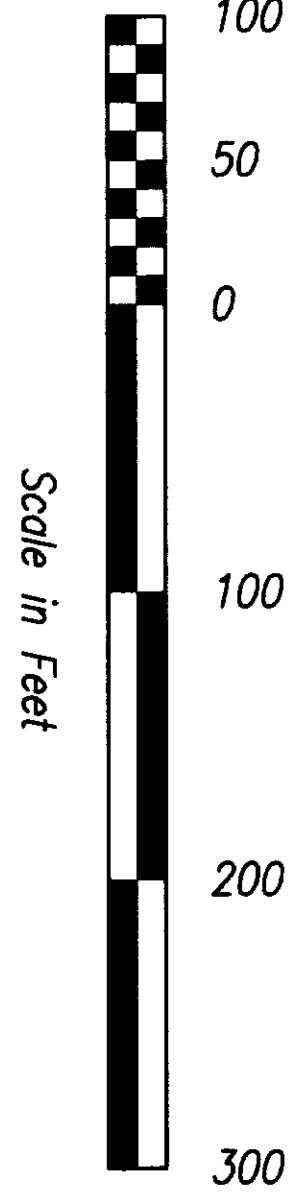

FOUND STONE MONUMENT WITH LEADED TACK 1.5' DEEP ON 3/10/89.

N89°36'53"E 2678.60'

FOUND 1.5" IRON PIPE AT GROUND LEVEL IN FIELD. HAS WHITE 2X2 STAKE MARKED "1/4" CORNER ON 8/1/97.

Short Plat for David Allan

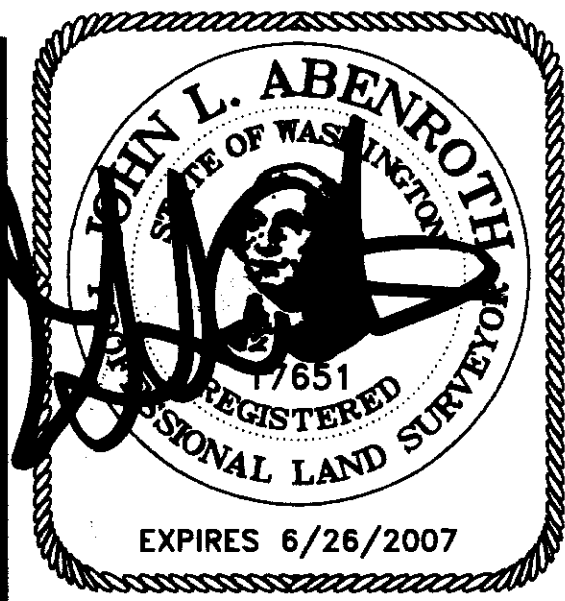

**SURVEYOR'S CERTIFICATE**  
This map correctly represents a survey made by me or under my direction in conformance with the Survey Recording Act in November 2005 at the request of David Allan.  
John L. Abenroth CERT#17651  
Date 12/21/06

**AUDITOR'S CERTIFICATE**  
200601060080  
Skagit County Auditor  
1/6/2008 Page 2 of 2 2:10:29AM  
County Auditor or Deputy Auditor