

Survey in the NE1/4 of the NE1/4 of Section 26, Twp. 34 N., Rng. 4 E., W.M.

FOUND 1" IRON PIPE WITH PLUG & TACK 0.6' ABOVE GROUND LEVEL ON 12/17/85. CORNER WAS LATER REPLACED WITH CONCRETE MONUMENT WITH BRASS CAP.

2335.27'

S87°07'29"E 2666.07'

66.44'

264.36'

FOUND CONCRETE MONUMENT WITH BRASS CAP, L.S.#17651, DATED 1986, ON 7/21/05.

23°24'

26°25'

110.00'

S01°25'49"W 456.98'

100.00'

2610.60'

123.69'

33.29'

102.28'

2051.34'

FOUND CONCRETE MONUMENT WITH BRASS CAP ON 1/2/86.

**Legal Description**  
A triangular piece of ground in Section Twenty-six (26), Township thirty-four (34), North, Range Four (4), East of the W.M. described as follows:  
Commencing at the northeast corner of said Section Twenty-six (26); thence south along the section line between Sections Twenty-five (25) and Twenty-six (26) to a point of intersection of said section line with the east line of the county road as now established; thence following said east line of said county road in a general northwesterly direction to a point where the east line of said county road intersects the section line between Sections Twenty-three (23) and Twenty-six (26); thence east along said section line to the point of beginning, containing about one acre, more or less.

TOGETHER WITH That portion, if any, of the Northeast 1/4 of the Northeast 1/4 of Section 26, Township 34 North, Range 4 E.W.M., which lies easterly of the southeasterly extension of the southwesterly right of way line of that certain 100 foot wide strip of land conveyed to the Seattle, Lake Shore and Eastern Railway Company by Deed dated December 29, 1890 and recorded January 7, 1891, in Volume 13 of Deeds, page 620, records of Skagit County, Washington.

**Notes**

1. Basis-of-bearings - Assumed S01°25'49"W on the east line of the northeast quarter of section 26.
2. This survey was accomplished by field traverse using: 3 second or better digital electronic total station, and meets or exceeds the standards contained in WAC 332-130-090.
3. Only the east line of the subject property was visited during this survey.
4. The owners of the subject property also own adjoining property to the north. The adjoining property was not included in this survey. Nothing herein should be construed to indicate that the property shown hereon is a separate legal lot as no investigation into that question has been made as a part of this survey.

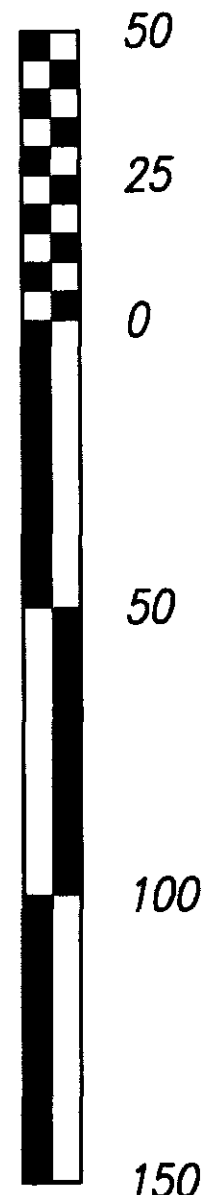

Scale in Feet

**Legend**

- Set 1/2" X 18" reinforcing rod with yellow plastic cap marked "SKA SURV 17651" and white 2" X 2" witness stake, except as noted.
- Gas valve servicing neighboring home to the east, the location of Gas line was not surveyed.

Survey for Carol Nersten

COPYRIGHT 2004 SKAGIT SURVEYORS, INC.



806 Metcalf St., Sedro-Woolley, WA 98284 Phone: (360) 855-2121 FAX: (360) 855-1658

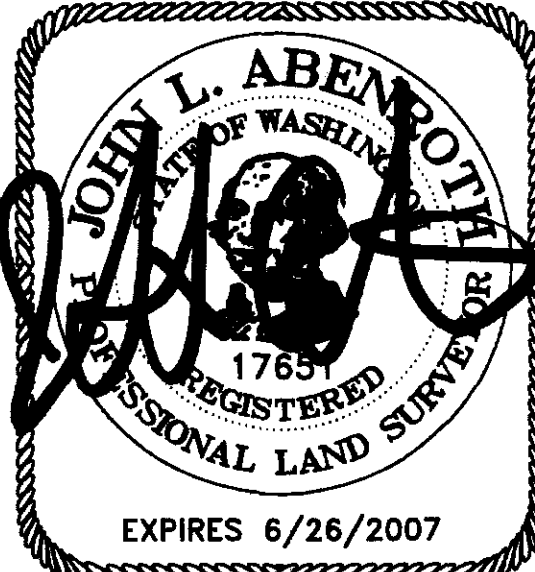

**SURVEYOR'S CERTIFICATE**  
This map correctly represents a survey made by me or under my direction in conformance with the Survey Recording Act in July 2005 at the request of Carol Nersten.

John L. Abenroth CERT#17651  
Date 11/04/05

**AUDITOR'S CERTIFICATE**

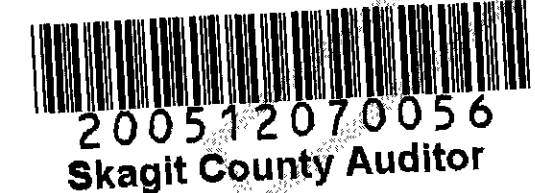

200512070056  
Skagit County Auditor  
12/7/2005 Page 1 of 111:15AM

Norma Bummert by  
County Auditor or Deputy Auditor  
Judy J. Smith