

LINE	BEARING	DISTANCE
L1	S25 05° 00' W	45.00'
L2	S40 56° 58' E	46.19'
L3	S40 56° 58' E	126.70'
L4	N43 32° 28' W	358.74'
L5	N26 25° 20' W	118.16'
L6	N47 19° 44' W	161.33'
L7	N65 07° 28' W	69.06'
L8	N46 27° 32' E	30.06'

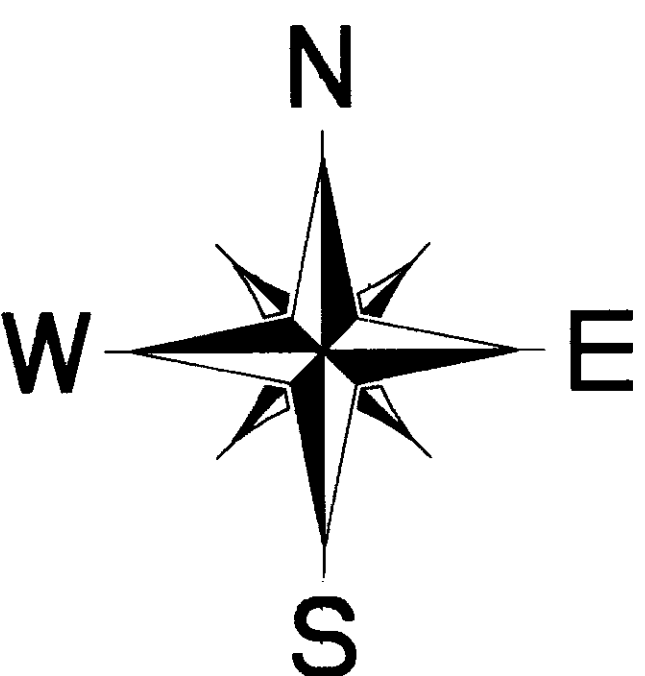

200512050043
Skagit County Auditor
12/15/2005 Page 1 of 2 2:10:24AM

NOTES:

1. ALL SECTION MONUMENTS AS DESCRIBED, WERE VISITED AS SHOWN.
2.
 - DENOTES 5/8" REBAR AND YELLOW CAP IMPRINTED "AZIMUTH NW 21591" SET THIS SURVEY
 - DENOTES CORNERS FOUND.
3. THIS SURVEY PERFORMED BY FIELD TRAVERSE USING A 3 SECOND ELECTRONIC DISTANCE MEASURING THEODOLITE
4. BASIS OF BEARING: NORTH 50 DEGREES 40'12" EAST ALONG THE MONUMENTED CENTERLINE OF HARTY LANE IN SURVEY OF ECHO HILL ADDITION UNDER SKAGIT COUNTY AUDITOR'S FILE NO. 817731.
5. LEGAL DESCRIPTION FOR SAID SURVEY FROM QUIT CLAIM DEED RECORDED UNDER AUDITOR'S FILE NO. 9704150028 AND STATUTORY WARRANTY DEED RECORDED UNDER AUDITOR'S FILE # 8709150026.
6. SKAGIT COUNTY TAX PARCELS INCLUDED IN THIS SURVEY: P49768, P50165, P49769, P50167, P102956, P50159

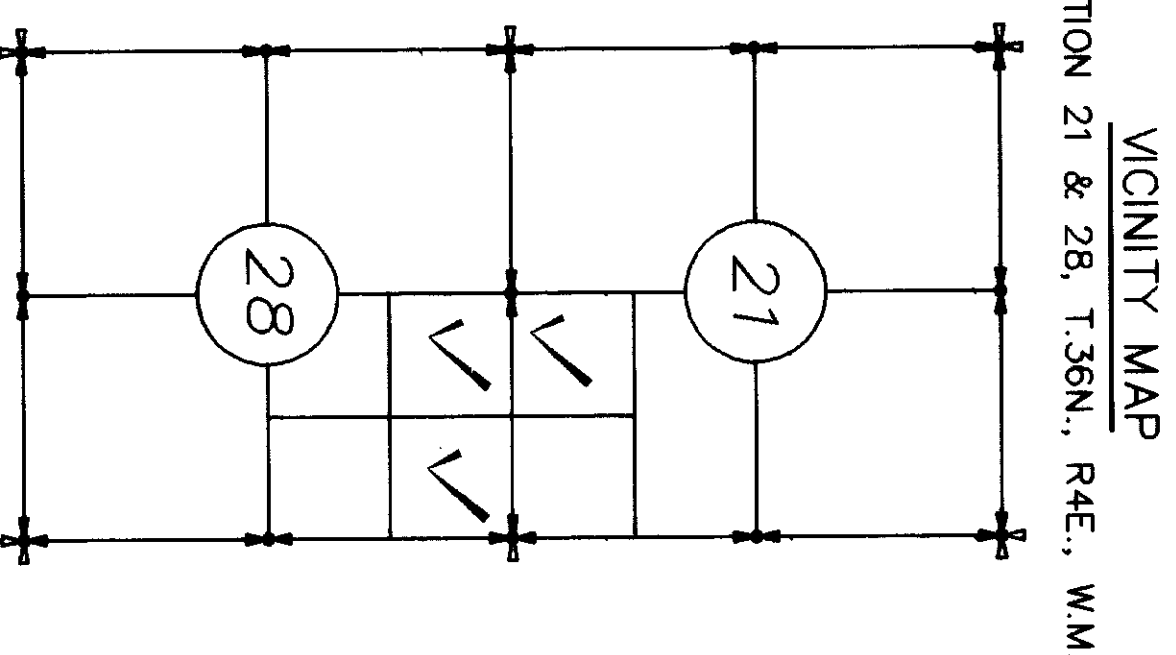

SURVEYOR'S CERTIFICATE

This map correctly represents a survey made by me or under my direction in conformance with the requirements of the SURVEY RECORDING ACT at the request of GORDON SOLMES
IN SEPT. 2005

Stuart B. VanBuren, Jr., P.L.S.
Certificate No. 21591

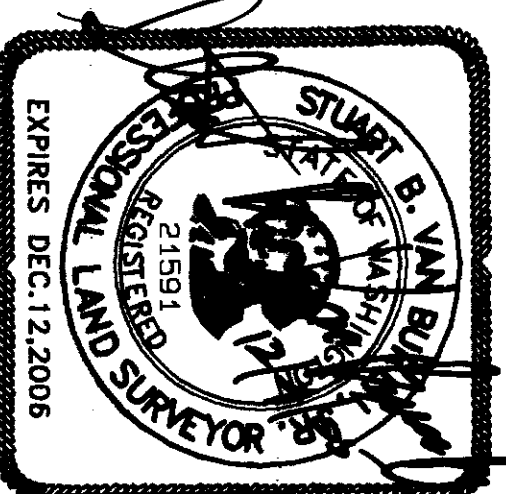

**AZIMUTH
ORTHWEST, INC.**
17963 WOOD ROAD
BOW, WA, 98232
[360] 724-7326

SURVEY IN THE N.E. 1/4 SEC. 28
AND S.E. 1/4 SEC. 21
TWN. 36 N. , RNG. 4 E., W.M.
SKAGIT COUNTY, WASHINGTON
FOR
GORDON SOLNES

DRWG: 0783.rost.dwg	DATE: SEPT. , 2005	SHEET 1 OF 2
CHECKED: SVB	SCALE: 1" = 200'	JOB NO. 05.0783

LEGAL DESCRIPTION

PARCEL A:

THAT PORTION OF THE SOUTHWEST OF THE SOUTHEAST OF SECTION 21, TOWNSHIP 36 NORTH, RANGE 4 EAST, W.M., LYING SOUTHWESTERLY OF, THE CCC ROAD (ALSO KNOWN AS THE WOODMAN MATHEWS ROAD NO. 30 AND THE PARSON CREEK ROAD NO. 474), AS THE SAME EXISTED ON SEPTEMBER 4, 1940.

PARCEL B:

THAT PORTION OF THE NORTHWEST OF THE NORTHEAST OF SECTION 28, TOWNSHIP 36 NORTH, RANGE 4 EAST, W.M., LYING SOUTHWESTERLY OF, THE CCC ROAD (ALSO KNOWN AS THE WOODMAN MATHEWS ROAD NO. 30 AND THE PARSON CREEK ROAD NO. 474), AS THE SAME EXISTED ON FEBRUARY 19, 1966.

PARCEL C:

THAT PORTION OF LOT 4 OF SHORT PLAT NO. 99-79 RECORDED IN BOOK 3 OF SHORT PLATS AT PAGE 189 UNDER AUDITOR'S FILE NO. 7910030044, RECORDS OF SKAGIT COUNTY, WASHINGTON, LYING WITHIN THE NORTHEAST QUARTER OF THE NORTHEAST QUARTER OF SECTION 28, TOWNSHIP 36 NORTH, RANGE 4 EAST, W.M., BEING MORE PARTICULARLY DESCRIBED AS FOLLOWS:

BEGINNING AT THE NORTHWESTERN MOST CORNER OF LOT 4 OF SAID SHORT PLAT BEING ALSO A POINT ON THE SOUTHERLY MARGIN OF THAT CERTAIN 50 FOOT WIDE TRACT OF LAND CONVERTED TO GORDON AND IRIS NOREEN SOLNES BY ERLAND E. AND ELLEN H. LOFOQUIST AND DESCRIBED AS PARCEL "C" IN STATUTORY WARRANTY DEED FILED IN VOLUME 724 AT PAGE 10, UNDER AUDITOR'S FILE NO. 8709150026, RECORDS OF SKAGIT COUNTY, WASHINGTON, SAID POINT BEING ON A CURVE HAVING A RADIUS POINT WHICH BEARS NORTH 47 DEGREES 57'39" EAST A DISTANCE OF 1512.50 FEET; THENCE SOUTHEASTERLY ALONG SAID CURVE TO THE LEFT THROUGH A CENTRAL ANGLE OF 5 DEGREES 28'56" AN ARC DISTANCE OF 144.72 FEET; THENCE SOUTH 1 DEGREE 03'06" EAST A DISTANCE OF 603.50 FEET TO A POINT ON THE BOUNDARY OF SAID LOT 4; THENCE SOUTH 88 DEGREES 06'13" WEST ALONG SAID BOUNDARY OF LOT 4 A DISTANCE OF 100.01 FEET TO A CORNER OF SAID LOT 4; THENCE NORTH 01 DEGREES 03'06" WEST ALONG THE WESTERMOST LINE OF SAID LOT 4 A DISTANCE OF 709.52 FEET TO THE POINT OF BEGINNING.

PARCEL D:

THE NORTHERLY 50 FEET OF THAT PORTION OF THE NORTHEAST OF THE NORTHEAST OF SECTION 28, TOWNSHIP 36 NORTH, RANGE 4 EAST, W.M., LYING SOUTHERLY OF THE CCC ROAD (ALSO KNOWN AS THE WOODMAN MATHEWS ROAD NO. 30 AND THE PARSON CREEK ROAD NO. 474), AS THE SAME EXISTED ON FEBRUARY 19, 1966; EXCEPT THAT PORTION THEREOF LYING WITHIN EAST 50 FEET OF SAID NORTHEAST OF THE NORTHEAST.

AND ALSO EXCEPT THAT PORTION OF THE NORTHEAST QUARTER OF THE NORTHEAST QUARTER OF SECTION 28, TOWNSHIP 36 NORTH, RANGE 4 EAST, W.M., BEING MORE PARTICULARLY DESCRIBED AS FOLLOWS:

COMMENCING AT THE NORTHWESTERN MOST CORNER OF LOT 4 OF SHORT PLAT NO. 99-79 RECORDED IN BOOK 3 OF SHORT PLATS AT PAGE 189 UNDER AUDITOR'S FILE NO. 7910030044, RECORDS OF SKAGIT COUNTY, WASHINGTON, SAID CORNER BEING A POINT ON THE SOUTHERLY MARGIN OF THAT CERTAIN 50 FOOT WIDE TRACT OF LAND CONVEYED TO GORDON AND IRIS NOREEN SOLNES BY ERLAND E. AND ELLEN H. LOFOQUIST AND DESCRIBED AS PARCEL "C" IN STATUTORY WARRANTY DEED FILED IN VOLUME 724 AT PAGE 10, UNDER AUDITOR'S FILE NO. 8709150026, RECORDS OF SKAGIT COUNTY, WASHINGTON, SAID POINT BEING ON A CURVE HAVING A RADIUS POINT WHICH BEARS NORTH 47 DEGREES 57'39" EAST A DISTANCE OF 1512.50 FEET; THENCE SOUTHEASTERLY ALONG SAID CURVE TO THE LEFT THROUGH A CENTRAL ANGLE OF 5 DEGREES 28'56" AN ARC DISTANCE OF 144.72 FEET TO THE TRUE POINT OF BEGINNING; THENCE CONTINUING ALONG THE SOUTHERLY MARGIN OF SAID 50 FOOT WIDE TRACT, THROUGH A CENTRAL ANGLE OF 11 DEGREES 16'10" AN ARC DISTANCE OF 297.50 FEET; THENCE SOUTH 58 DEGREES 47'28" EAST ALONG SAID SOUTHERLY MARGIN A DISTANCE OF 346.86 FEET; THENCE SOUTH 31 DEGREES 12'32" WEST ALONG SAID SOUTHERLY MARGIN A DISTANCE OF 10.00 FEET TO THE BEGINNING OF A CURVE HAVING A RADIUS POINT WHICH BEARS NORTH 31 DEGREES 12'32" EAST A DISTANCE OF 663.00 FEET; THENCE SOUTHEASTERLY ALONG SAID CURVE TO THE LEFT THROUGH A CENTRAL ANGLE OF 27 DEGREES 41'00" AN ARC DISTANCE OF 320.34 FEET; THENCE SOUTH 86 DEGREES 28'28" EAST ALONG SAID SOUTHERLY MARGIN A DISTANCE OF 321.07 FEET TO THE MOST NORTHEASTERLY CORNER OF SAID LOT 4; THENCE NORTH 0 DEGREES 46'54" WEST A DISTANCE OF 50.14 FEET TO THE SOUTHERLY RIGHT-OF-WAY LINE OF PARSON'S CREEK ROAD; THENCE NORTH 86 DEGREES 28'28" WEST ALONG SAID RIGHT-OF-WAY LINE A DISTANCE OF 317.30 FEET TO THE BEGINNING OF A CURVE TO THE RIGHT HAVING A RADIUS POINT WHICH BEARS NORTH 3 DEGREES 31'32" EAST A DISTANCE OF 613.00 FEET; THENCE NORTHWESTERLY ALONG SAID RIGHT-OF-WAY AND SAID CURVE THROUGH A CENTRAL ANGLE OF 27 DEGREES 41'00" AN ARC DISTANCE OF 296.18 FEET; THENCE NORTH 31 DEGREES 12'32" EAST A DISTANCE OF 10.00 FEET; THENCE NORTH 58 DEGREES 47'26" WEST ALONG SAID RIGHT-OF-WAY A DISTANCE OF 346.86 FEET TO THE BEGINNING OF A CURVE TO THE RIGHT HAVING A RADIUS POINT WHICH BEARS NORTH 31 DEGREES 12'32" EAST A DISTANCE OF 1462.50 FEET; THENCE NORTHWESTERLY ALONG SAID RIGHT-OF-WAY AND SAID CURVE THROUGH A CENTRAL ANGLE OF 13 DEGREES 09'37" AN ARC DISTANCE OF 335.92 FEET TO A POINT WHICH BEARS NORTH 1 DEGREE 03'06" WEST FROM THE TRUE POINT OF BEGINNING; THENCE SOUTH 1 DEGREE 03'06" EAST A DISTANCE OF 70.06 FEET TO THE TRUE POINT OF BEGINNING.

SURVEYOR'S CERTIFICATE

This map correctly represents a survey made by me or under my direction in conformance with the requirements of the SURVEY RECORDING ACT at the request of GORDON SOLNES IN SEPT. 2005

Stuart B. VanBuren, Jr., P.L.S.
Certificate No. 21591

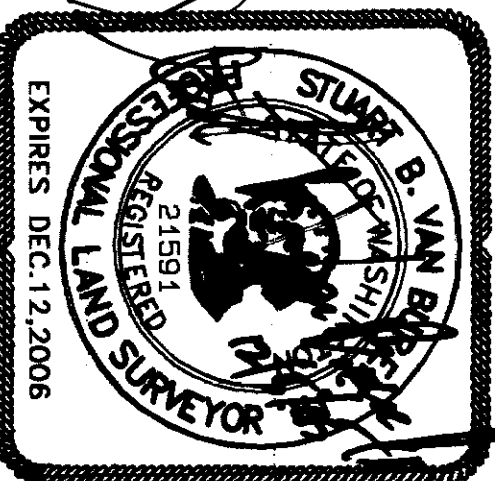

AZIMUTH
NORTHWEST, INC.
17963 WOOD ROAD
BOW, WA, 98232
[360] 724-7326

SURVEY IN THE N.E. 1/4 SEC. 28 AND S.E. 1/4 SEC. 21 TWN. 36 N. , RNG. 4 E., W.M. SKAGIT COUNTY, WASHINGTON FOR GORDON SOLNES			
DRWG: 0783rost1.dwg	DATE: SEPT. , 2005	SHEET 2	OF 2
CHECKED: SVB	SCALE: 1"= 200'	JOB NO. 05.0783	