

Return Name & Address:



200509080004

Skagit County Auditor

9/8/2005 Page

1 of

2 8:39AM

SKAGIT COUNTY PLANNING & DEVELOPMENT SERVICES

LOT OF RECORD CERTIFICATION

File Number: PL96-0392/BP05-1125

Applicant Name: Robert Schmitt

Property Owner Name: Robert J. & Cheryl L. Schmitt

Having reviewed the information provided by the applicant, the Department hereby finds that the parcel(s) bearing Skagit County Parcel Number(s): P68471 & P20499

Lot Size: .24 acres Description: 3983-002-006-0005 & 340219-0-015-0000

1. CONVEYANCE

- ☒ **IS**, a Lot of Record as defined in Skagit County Code (SCC) 14.04.020 or owned by an innocent purchaser who has met the requirements described in SCC 14.18.000(9) and RCW 58.17.210 and therefore IS eligible for conveyance. (per AF# AF#)
- ☐ **IS NOT**, a Lot of Record as defined in SCC 14.04.020 or owned by an innocent purchaser who has met the requirements described in SCC 14.18.000(9) and RCW 58.17.210 and therefore IS NOT eligible for conveyance or development.

2. DEVELOPMENT

- ☐ **IS**, the minimum lot size required for the _____ zoning district in which the lot is located and therefore IS eligible to be considered for development permits.
- ☒ **IS NOT**, the minimum lot size required for the Rural Intermediate (RI) zoning district in which the lot is located, but does meet an exemption listed in SCC 14.16.850(4)(c) (iv) and therefore IS eligible to be considered for development permits.
- ☐ **IS NOT**, the minimum lot size required for the _____ zoning district in which the lot is located, does not meet an exemption listed in SCC 14.16.850(4)(c) and therefore IS NOT eligible to be considered for certain development permits.

Authorized Signature: 

Date: September 7, 2005

See attached map for Lot of Record boundaries.

SKAGIT COUNTY

6	5	4	3	2	1
7	8	9	10	11	12
18	17	16	15	14	13
19	20	21	22	23	24
30	29	28	27	26	25
31	32	33	34	35	36

T 34 N R 02 E

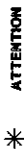

ATTENTION
THIS MAP WAS CREATED FROM AERIAL PHOTOGRAPHY AND THE BEST AVAILABLE INFORMATION. THE LOCATION OF THIS PARCEL IS UNKNOWN.

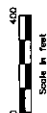
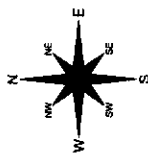

This map was created from aerial photography and the best available information. The location of this parcel is unknown. This map is not a substitute for field survey.

DATE	INIT.
DRAWN BY	W/LH/RE
REVISED	07/21/02
PLOTTED	07/09/02
MAP PRODUCED BY	SKAGIT COUNTY GIS/PLANNING SERVICES

Section 19
T 34 N R 02 E

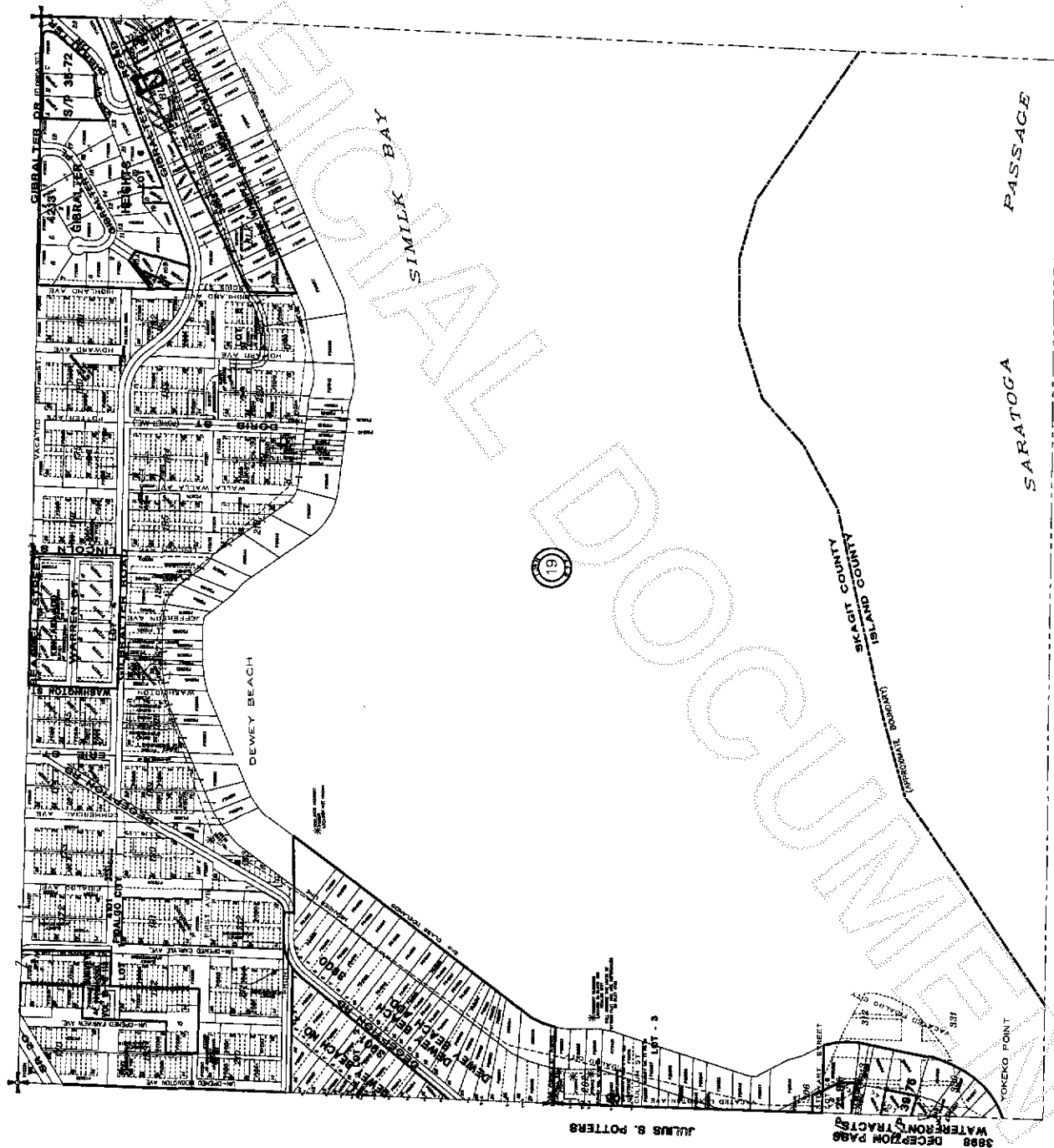

200509080004
Skagit County Auditor