

Return to:



200508080173

Skagit County Auditor

8/8/2005 Page

1 of

2 2:28PM



PROTECTED CRITICAL AREA SITE PLAN

Page 1 of 2

Grantor/Owner: Donald & Darlene Reese

Grantee: PUBLIC

Site Address: 7391 Skagit View Drive

Property ID #: P 79326 Assessors Tax Account #: 4332.000.078.0008

Legal Description: Sec. 8 Twp. 35 Rng. 8 / Plat Name Wildemex Village Lot 78

Permit/Activity #: BPOS.0577 DIV 2

The PROTECTED CRITICAL AREA (PCA) is to be left undisturbed in its natural state. "With the exception of activities identified as Allowed without Standard review under SCC 14.24.100, any land-use activity that can impair the functions and values of critical areas or their buffers through a development activity or by disturbance of the soil or water, and/or by removal of, or damage to, existing vegetation shall require critical areas review and written authorization pursuant to SCC 14.24." SCC 14.24.060 No clearing, grading, filling, logging or removal of woody material, building, construction or road construction of any kind, planting of non-native vegetation or grazing of livestock is allowed within the PCA areas except as specifically permitted by Skagit County on a case-by-case basis consistent with SCC 14.24.

Representations on this site plan may be approximations only and should not be used for purposes other than for determining general locations of critical areas. Development activities beyond the scope of this plan may require additional studies and approvals.

The above references to "Grantor" and "Grantee" shall not be construed as a transfer of property ownership and are used solely for filing with the County Auditor.

Owner: Donald & Darlene Reese Date: 8/5/05

On this day personally appeared before me Donald H Reese & Darlene Reese known to be the individual described herein and acknowledged to me that THEY signed the same as their free and voluntary act and deed for the uses and purposes therein mentioned.

ELAINE WRIGHT, Notary Public in and for the State of Washington, residing at SE DRO Woolley, WA Date: 8/5/05

UNOFFICIAL DOCUMENT

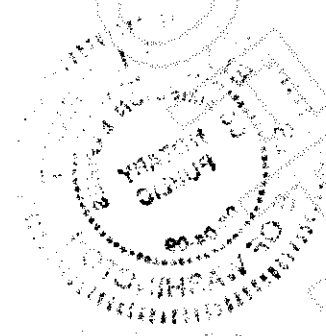

CRITICAL AREA SITE PLAN

CAO Approved

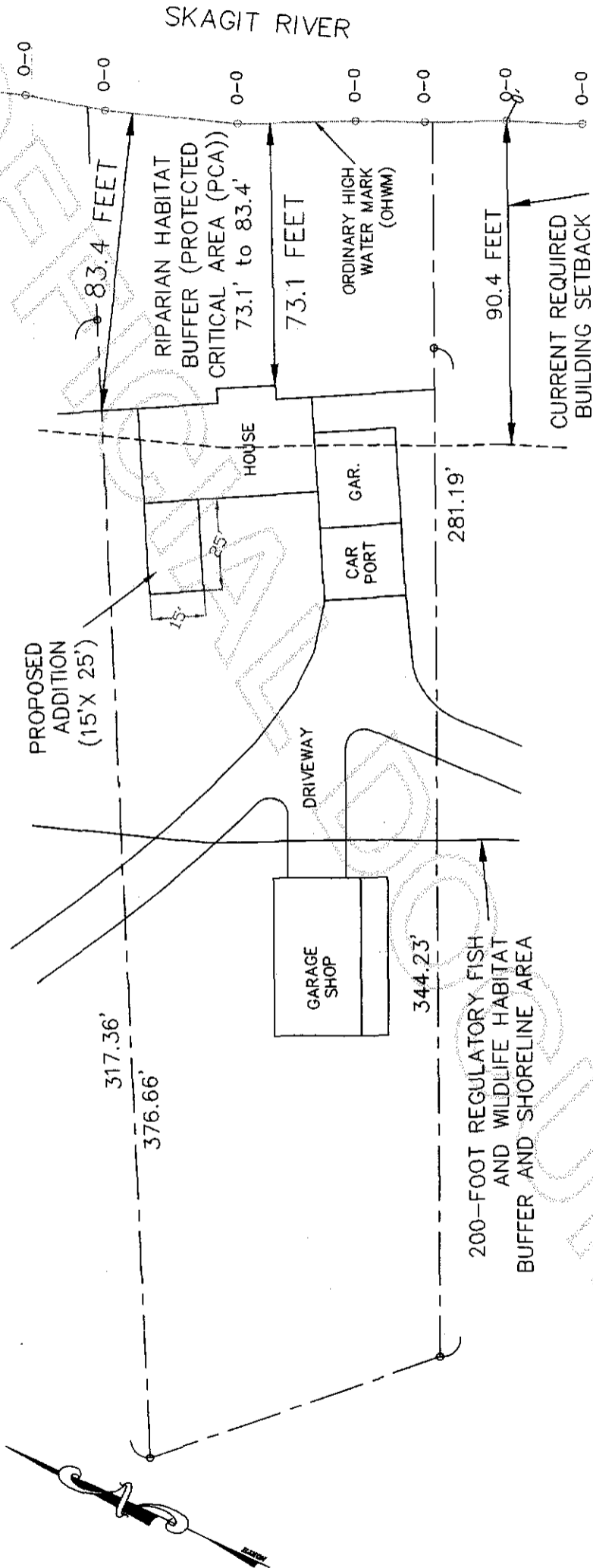

Owners: Don & Darlene Reese
 Address: 7391 Skagit View Dr.
 Parcel: P79326
 Permit: BP05-0577
 Preparer: Edison Engineering
 Date: June 2005

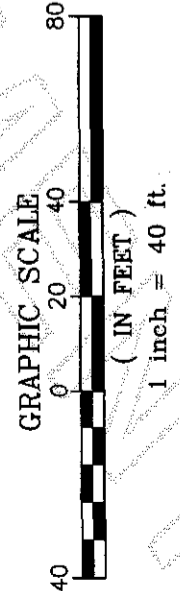

This drawing was created with a compass and tape measure and is approximate.
NOT A SURVEY



200508080173
 Skagit County Auditor