

Survey in the SE1/4 of the NW1/4 of Section 20, Twp. 34 N., Rng. 5 E., W.M.

S89°51'16"E 2623.25'

1311.62'

SET CONCRETE MONUMENT WITH BRASS CAP, ON 9/22/93, AT THE POSITION SHOWN ON SURVEY FILED IN VOLUME 2 OF SURVEYS AT PAGE 22.

1315.97'

S89°39'13"E

FOUND CONCRETE MONUMENT WITH 1/2" BRASS ROD AND PUNCH MARK, ON 9/9/93, AS SHOWN ON SURVEY FILED IN VOLUME 2 OF SURVEYS AT PAGE 22.

S89°39'13"E

FOUND CONCRETE MONUMENT WITH 1/2" BRASS ROD AND PUNCH MARK, ON 9/9/93, AS SHOWN ON SURVEY FILED IN VOLUME 2 OF SURVEYS AT PAGE 22.

FOUND CONCRETE MONUMENT WITH R.L. YELLOW PLASTIC CAP L.S.#6702, ON 9/9/93, AS SHOWN ON SURVEY FILED IN VOLUME 2 OF SURVEYS AT PAGE 22.

Legal Descriptions

PARCEL 1, (A.F.#200504120168) THAT PORTION OF THE SOUTHEAST QUARTER OF THE NORTHWEST QUARTER OF SECTION 20, TOWNSHIP 34 NORTH, RANGE 5 EAST, W.M. DESCRIBED AS FOLLOWS:
COMMENCING AT THE NORTHWEST CORNER OF THE SOUTHEAST QUARTER OF SAID SECTION 20; THENCE S01°01'05" W ALONG THE WEST LINE OF SAID SUBDIVISION, A DISTANCE OF 122.53 FEET TO THE POINT OF BEGINNING OF THIS DESCRIPTION; THENCE CONTINUING S01°01'05" W ALONG SAID WEST LINE, A DISTANCE OF 234.46 FEET TO THE NORTH LINE OF THE HEREMASTER DESCRIBED EASEMENT; THENCE CONTINUING S01°01'05" W ALONG SAID WEST LINE, A DISTANCE OF 46.04 FEET TO THE CENTERLINE OF SAID EASEMENT AND THE POINT OF CURVATURE OF A NON-TANGENT CURVE TO THE LEFT FROM WHICH THE RADIUS POINT BEARS N45°33'01"E, A DISTANCE OF 54.83 FEET; THENCE SOUTHEASTERLY, EASTERLY AND NORTHEASTERLY ALONG SAID EASEMENT CENTERLINE CURVE THROUGH A CENTRAL ANGLE OF 88°18'31" AND AN ARC DISTANCE OF 84.50 FEET; THENCE N47°14'30" E ALONG SAID EASEMENT CENTERLINE, A DISTANCE OF 84.72 FEET; THENCE N52°16'51" E ALONG SAID EASEMENT CENTERLINE, A DISTANCE OF 121.80 FEET; THENCE N01°01'05" E, A DISTANCE OF 95.69 FEET; THENCE N84°26'55" W, A DISTANCE OF 233.29 FEET TO THE POINT OF BEGINNING OF THIS DESCRIPTION.

TOGETHER WITH AND SUBJECT TO A NON-EXCLUSIVE EASEMENT FOR INGRESS, EGRESS AND UTILITIES, OVER, UNDER AND THROUGH A STRIP OF LAND 50 FEET WIDE DESCRIBED AS FOLLOWS:
COMMENCING AT THE NORTHWEST CORNER OF THE SOUTHEAST QUARTER OF THE NORTHWEST QUARTER OF SAID SECTION 20; THENCE S01°01'05" W ALONG THE WEST LINE OF SAID SUBDIVISION, A DISTANCE OF 356.99 FEET TO THE POINT OF BEGINNING OF THIS EASEMENT DESCRIPTION WHICH POINT IS THE POINT OF CURVATURE OF A NON-TANGENT CURVE TO THE LEFT FROM WHICH THE RADIUS POINT BEARS N64°49'20" E, A DISTANCE OF 198.69 FEET; THENCE SOUTHEASTERLY ALONG SAID CURVE THROUGH A CENTRAL ANGLE OF 75°44'09" AND AN ARC DISTANCE OF 27.40 FEET TO THE POINT OF COMPOUND CURVATURE WITH A CURVE TO THE LEFT HAVING A RADIUS OF 29.83 FEET; THENCE EASTERLY AND NORTHEASTERLY ALONG SAID CURVE THROUGH A CENTRAL ANGLE OF 99°40'42" AND AN ARC DISTANCE OF 51.89 FEET; THENCE N47°14'30" E, A DISTANCE OF 85.82 FEET; THENCE N52°16'51" E, A DISTANCE OF 142.95 FEET; THENCE S01°01'05" W, A DISTANCE OF 64.10 FEET; THENCE S52°16'51" W, A DISTANCE OF 100.64 FEET; THENCE S47°14'30" W, A DISTANCE OF 83.62 FEET TO THE POINT OF CURVATURE OF A CURVE TO THE RIGHT HAVING A RADIUS OF 79.83 FEET; THENCE SOUTHWESTERLY, WESTERLY AND NORTHWESTERLY ALONG SAID CURVE THROUGH A CENTRAL ANGLE OF 72°34'17" AND AN ARC DISTANCE OF 101.11 FEET TO THE WEST LINE OF THE SOUTHEAST QUARTER OF THE NORTHWEST QUARTER OF SAID SECTION 20; THENCE N01°01'05" E ALONG SAID WEST LINE, A DISTANCE OF 76.91 FEET TO THE POINT OF BEGINNING OF THIS EASEMENT DESCRIPTION.

PARCEL 2, (A.F.#200504120168) THAT PORTION OF THE SOUTHEAST QUARTER OF THE NORTHWEST QUARTER OF SECTION 20, TOWNSHIP 34 NORTH, RANGE 5 EAST, W.M. DESCRIBED AS FOLLOWS:
COMMENCING AT THE NORTHWEST CORNER OF THE SOUTHEAST QUARTER OF SAID SECTION 20; THENCE S01°01'05" W ALONG THE WEST LINE OF SAID SUBDIVISION, A DISTANCE OF 403.03 FEET TO THE POINT OF BEGINNING OF THIS DESCRIPTION WHICH POINT IS THE POINT OF CURVATURE OF A NON-TANGENT CURVE TO THE LEFT ON THE HEREMASTER DESCRIBED EASEMENT FROM WHICH THE RADIUS POINT BEARS N45°33'01" E, A DISTANCE OF 54.83 FEET; THENCE SOUTHEASTERLY, EASTERLY AND NORTHEASTERLY ALONG SAID EASEMENT CENTERLINE CURVE THROUGH A CENTRAL ANGLE OF 88°18'31" AND AN ARC DISTANCE OF 84.50 FEET; THENCE N47°14'30" E ALONG SAID EASEMENT CENTERLINE, A DISTANCE OF 84.72 FEET; THENCE N52°16'51" E ALONG SAID EASEMENT CENTERLINE, A DISTANCE OF 121.80 FEET; THENCE S01°01'05" W, A DISTANCE OF 30.06 FEET; THENCE S01°01'05" W, A DISTANCE OF 32.05 FEET TO THE SOUTH LINE OF SAID EASEMENT; THENCE S01°01'05" W, A DISTANCE OF 292.98 FEET; THENCE S56°28'31" W, A DISTANCE OF 176.99 FEET TO THE WEST LINE OF THE SOUTHEAST QUARTER OF THE NORTHWEST QUARTER OF SAID SECTION 20; THENCE N01°01'05" E ALONG SAID WEST LINE, A DISTANCE OF 290.76 FEET TO THE SOUTH LINE OF THE HEREMASTER DESCRIBED EASEMENT; THENCE N01°01'05" E, A DISTANCE OF 30.87 FEET TO THE POINT OF BEGINNING OF THIS DESCRIPTION.

TOGETHER WITH AND SUBJECT TO A NON-EXCLUSIVE EASEMENT FOR INGRESS, EGRESS AND UTILITIES, OVER, UNDER AND THROUGH A STRIP OF LAND 50 FEET WIDE DESCRIBED AS FOLLOWS:
COMMENCING AT THE NORTHWEST CORNER OF THE SOUTHEAST QUARTER OF THE NORTHWEST QUARTER OF SAID SECTION 20; THENCE S01°01'05" W ALONG THE WEST LINE OF SAID SUBDIVISION, A DISTANCE OF 356.99 FEET TO THE POINT OF BEGINNING OF THIS EASEMENT DESCRIPTION WHICH POINT IS THE POINT OF CURVATURE OF A NON-TANGENT CURVE TO THE LEFT FROM WHICH THE RADIUS POINT BEARS N64°49'20" E, A DISTANCE OF 198.69 FEET; THENCE SOUTHEASTERLY ALONG SAID CURVE THROUGH A CENTRAL ANGLE OF 75°44'09" AND AN ARC DISTANCE OF 27.40 FEET TO THE POINT OF COMPOUND CURVATURE WITH A CURVE TO THE LEFT HAVING A RADIUS OF 29.83 FEET; THENCE EASTERLY AND NORTHEASTERLY ALONG SAID CURVE THROUGH A CENTRAL ANGLE OF 99°40'42" AND AN ARC DISTANCE OF 51.89 FEET; THENCE N47°14'30" E, A DISTANCE OF 85.82 FEET; THENCE N52°16'51" E, A DISTANCE OF 142.95 FEET; THENCE S01°01'05" W, A DISTANCE OF 64.10 FEET; THENCE S52°16'51" W, A DISTANCE OF 100.64 FEET; THENCE S47°14'30" W, A DISTANCE OF 83.62 FEET TO THE POINT OF CURVATURE OF A CURVE TO THE RIGHT HAVING A RADIUS OF 79.83 FEET; THENCE SOUTHWESTERLY, WESTERLY AND NORTHWESTERLY ALONG SAID CURVE THROUGH A CENTRAL ANGLE OF 72°34'17" AND AN ARC DISTANCE OF 101.11 FEET TO THE WEST LINE OF THE SOUTHEAST QUARTER OF THE NORTHWEST QUARTER OF SAID SECTION 20; THENCE N01°01'05" E ALONG SAID WEST LINE, A DISTANCE OF 76.91 FEET TO THE POINT OF BEGINNING OF THIS EASEMENT DESCRIPTION.

Notes

1. BASIS-OF-BEARINGS - ASSUMED N00°33'16"E ON THE WEST LINE OF THE NORTHWEST QUARTER OF SECTION 20.
2. THIS SURVEY WAS ACCOMPLISHED BY FIELD TRAVERSE USING: 3 SECOND OR BETTER DIGITAL ELECTRONIC TOTAL STATION, AND MEETS OR EXCEEDS THE STANDARDS CONTAINED IN WAC 332-130-090.
3. SEE BOUNDARY LINE ADJUSTMENT FILED IN A.F.#200504120168.

Legend
● SET 1/2" X 18" REINFORCING ROD WITH YELLOW PLASTIC CAP MARKED "SKA SURV 17651" AND WHITE 2" X 2" WITNESS STAKE, EXCEPT AS NOTED.
..... EXISTING DRIVEWAY

LINE TABLE		
#	BEARING	DISTANCE
L1	S01°01'05" W	46.04'
L2	N01°01'05" E	32.05'
L3	N52°16'51" E	30.06'
L4	S01°01'05" W	32.05'
L5	N01°01'05" E	30.87'
L6	N52°16'51" E	8.90'

CURVE TABLE		
#	RADIUS	DELTA
C1	54.83'	88°18'31"
C2	198.69'	07°54'09"
C3	29.83'	99°40'42"
C4	79.83'	72°34'17"

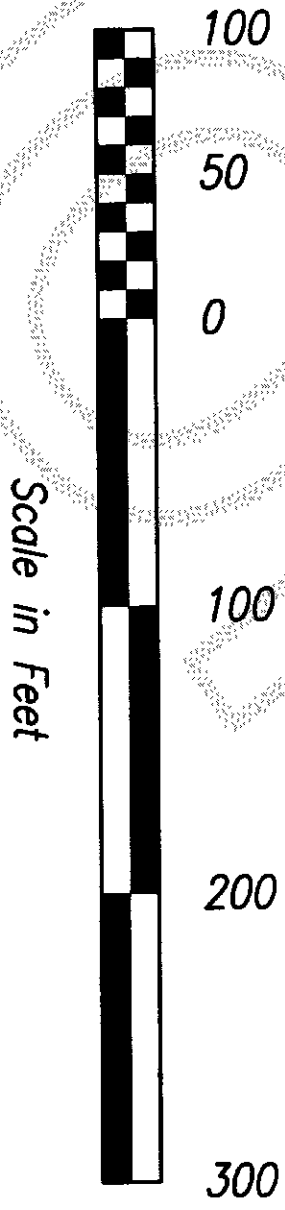

COMPUTED POSITION FROM SURVEY FILED IN VOLUME 2 OF SURVEYS AT PAGE 22

1290.23'

595.98'

1290.23'

COMPUTED POSITION FROM SURVEY FILED IN VOLUME 2 OF SURVEYS AT PAGE 22

20

COPYRIGHT 2004 SKAGIT SURVEYORS, INC.



806 Metcalf St., Sedro-Woolley, WA 98284 Phone: (360) 855-2121 FAX: (360) 855-1658

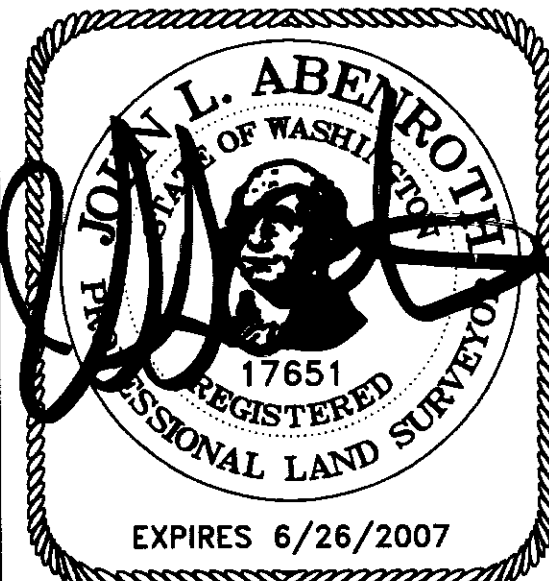

SURVEYOR'S CERTIFICATE
This map correctly represents a survey made by me or under my direction in conformance with the Survey Recording Act in March 2005 at the request of Jeff Benham.

John L. Abenroth CERT#17651
Date 6/15/05

AUDITOR'S CERTIFICATE



6/20/2005 Page 1 of 1 3:37PM

County Auditor or Deputy Auditor