

Return to:



200502230029
Skagit County Auditor

2/23/2005 Page 1 of 2 10:20AM

Purchasing property

PROTECTED CRITICAL AREA SITE PLAN

Page 1 of 2

Grantor/Owner: Jane Sullivan

Grantee: PUBLIC

Site Address: 13730 Sullivan Rd, Bow, WA 98232

Property ID #: P 33909 Assessors Tax Account #: 350308-0-012-0004

Legal Description: Sec. 8 Twp. 35 Rng. 3 / Plat Name _____ Lot _____

Permit/Activity #: BP05-0113

PROTECTED CRITICAL AREA (PCA) is to be left undisturbed in a natural state. No clearing, grading, filling, logging or removal of woody material, building, construction or road construction of any kind or planting of non-native vegetation is allowed within the PCA areas except as specifically permitted by Skagit County on a case-by-case basis consistent with Skagit County Code 14.24.

Representations on this site plan may be approximations only and should not be used for purposes other than for determining general locations of critical areas. Development activities beyond the scope of this plan may require additional studies and approvals.

The above references to "Grantor" and "Grantee" shall not be construed as a transfer of property ownership and are used solely for filing with the County Auditor.

Grantor Owner: Jane Sullivan Date: 2/23/05

On this day personally appeared before me Jane Sullivan known to be the individual described herein and acknowledged to me that JS signed the same as JS free and voluntary act and deed for the uses and purposes therein mentioned.

Donald E. [Signature], Notary Public in and for the State of Washington, residing at WV Date: 2-23-05

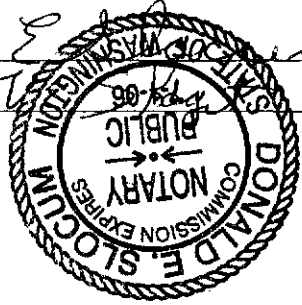

PROTECTED CRITICAL AREA SITE PLAN

Page 2 of 2

Applicant: Jane Sullivan

Permit #: _____

Parcel #: _____

Site Address: _____

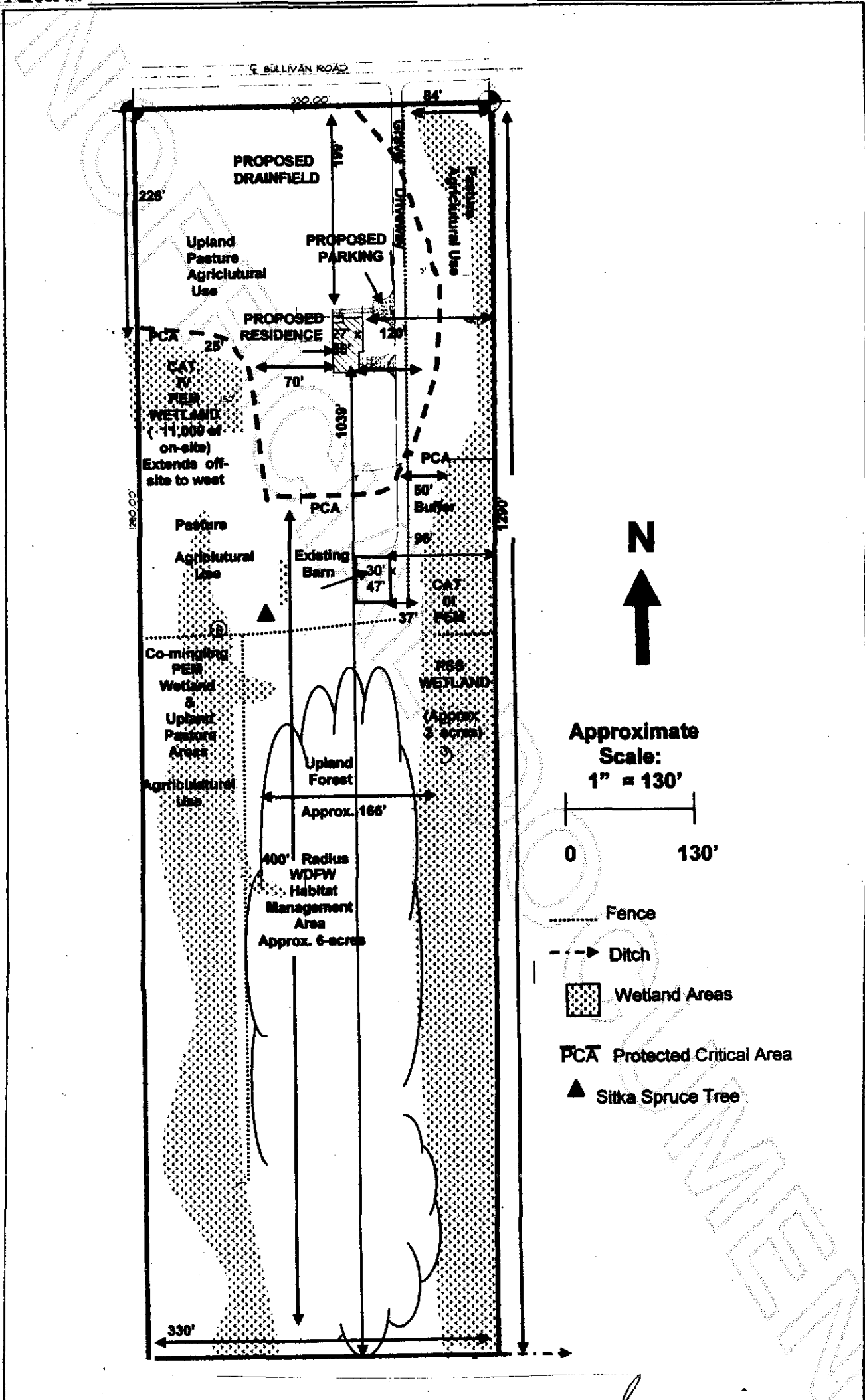

Skagit County CAO Staff Signature

~~2/23/05~~
Date

Jane Sullivan
Applicant Signature

2/23/05
Date



200502230029
Skagit County Auditor