

Closed Monument

N89°45'38" W

Basis of Bearing - AFN 200412270151

Fidalgo Avenue (40th St.)

Closed Monument

Filed for record at the request of Parrish Land Surveying

Norma Blumett by *[Signature]*
Skagit County Auditor

2005021700001
Skagit County Auditor
2/17/2005 Page 1 of 1 8:29AM

Survey Notes

This survey has been prepared from a closed random traverse using an electronic instrument measuring angles to 3 second of arc and distances rounded to hundredths of feet.

The purpose of this survey has been to locate, describe and set monuments to mark the existing boundaries of the below described property.

For additional information, pertaining to block boundaries refer to Record of Survey recorded under Auditor's File Number 200412270151.

Land Description

A Portion of the property described under Auditor's File Number 200103060006, Skagit County, Washington.

Lots 20, 21 and the south ten feet of lot 22, Block 9, "Seattle Syndicate's First Addition to the City of Anacortes", according to the plat thereof recorded in Volume 1 of Plats, Page 25, records of Skagit County, Washington.

Together with that portion of the East Half of vacated alley in said Block debuting upon said lots, and that portion of the vacated West 10 feet of "R" Avenue debuting upon said lots which upon vacation reverted to said premises by operation of law.

Subject to an easement for utilities reserved for the benefit of the City of Anacortes in the east half of said alley as described in City of Anacortes Ordinance 1247A.

"Q" Avenue (unopened)

Block 9

Alley

"R" Avenue

Total Area
8,208 sq. ft.
0.19 acres

Alley vacated by City of Anacortes Ordinance 1247A

Utility easement reserved for the City of Anacortes in the vacated alley

Boundary Corner obstructed by fence and shed roof Corner Bears S04°47'15" W 111.11

Cedar tree at boundary Corner Bears N89°17'39" W 4.35

East 10 feet of "R" Ave. vacated by City of Anacortes Ordinance 1222

Surveyor's Certificate

This map correctly represents a survey made by me or under my direction in conformance with the requirements of the survey recording act at the request of Randy Click of Skagit County, in February, 2005

Certificate no.
LS 24535

[Signature]
Robert F. Parrish

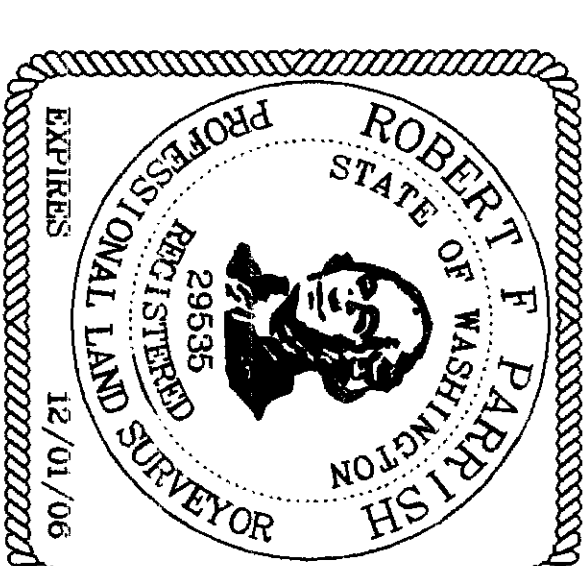

Record of Survey

Prepared at the request of

Randy Click

A Portion of Tax Parcel No. 50036
Portions of the Southwest Quarter, Sect. 30, T. 35N., R. 2E., W.M.,
Fidalgo Island, City of Anacortes, Skagit County, Washington

Plat of Mountain View Park

Lot 32

Graphic Scale

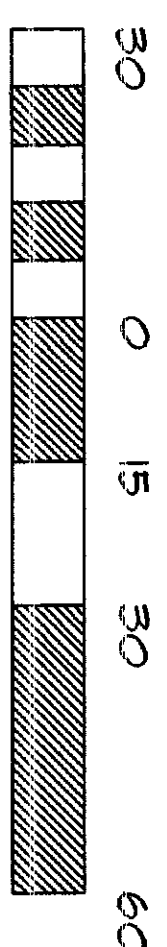

1 inch = 30 feet

Parrish Land Surveying

142 BLOSSOM LANE, PORT TOWNSEND, WA 98368
ANACORTES (360) 588-1467 - parrish@ockisland.com

JOB NO.: 502-184

CADD BY: RP

CHK BY: *[Signature]*

BK REF: 13

SCALE: 1" = 30'

DATE: 2-11-05