

Government Lot 2

Direction of this course determined by prior survey recorded under AFN 893393

Course ends 12± into lake no monument found on or near high water line

Government Lot 4

Lake Erie



Parcel B
1.21 acres±

Tax Parcel Number 19142

12453 Record
12468 Recent Measure

3/4" Pipe reported as set by Gilkey, 1954 See survey, AFN 893393

Rebar & Cap (LS 8492, assumed)

See Short Plat AFN 9512080097

N04°09'00"E
200.00

Parcel A
2.00 acres±

Tax Parcel Number 19124

Drainfield (see design for precise size and location)

Rebar & Cap LS 29535, by 1/2" Conduit with orange flagging

585°51'00"E
49.68
Rebar & Cap LS 8492
Corner Bears 585°31'44"W 0.36

Center of Section per Survey AFN 893393

Graphic Scale

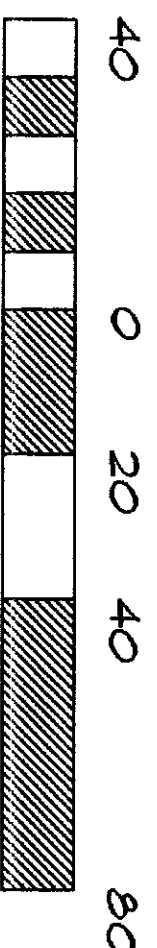

1 inch = 40 feet

Auditor's Certificate

Recorded at the request of Parrish Land Surveying.

Auditor's File Number (AFN) 200408120138 Statutory Warranty Deed and 200412030106 (Corrected Description)

Parcel A
A tract of land in Government Lot 4, Section 11, Range 1 East, N.M., described as follows: Beginning at a point on the West line of said Lot 4, 1553.93 feet North of the Southwest corner thereof; thence N04°09'E, along the west line of said Lot 4, 200.0 feet; thence 585°51'E, 379.17 feet to the shore of Lake Erie; thence Southerly along the shore of said Lake Erie to a point which bears 585°51'E, 487.13 feet from the point of beginning; thence N85°51'W, 487.13 feet to the point of beginning.

TOGETHER WITH a non-exclusive easement for ingress and egress over a 40 foot strip of land, the centerline of which is described as follows: Beginning at a point in Government Lot 4, Section 11, Township 34 North, Range 1 East, N.M., at a point 1653.93 feet and 585°51'E 271.24 feet to the true point of beginning and from said true point of beginning (verbally) West 82 degrees 42' North across property of the grantors, as granted by Darrell D. Deane and Gwendolyn Deane, his wife, by instrument dated April 24, 1958 and recorded under Auditor's File No. 564929.

TOGETHER WITH a non-exclusive easement of ingress and egress over a 40 foot strip of land, the centerline of which is described as follows: Beginning at a point in Government Lot 4, Section 11, Township 34 North, Range 1 East, N.M., at a point 1553.93 feet North (verbally) and 284 feet South 85 degrees 51' East 284 feet from the Southwest corner of the aforesaid Lot 4 and from said point of beginning West 82 degrees 42' North across the property of the grantors as granted by Lavern M. Deane and Lila Jane Deane, his wife, instrument dated April 24, 1958 and recorded under Auditor's File No. 564930.

Parcel B
That portion of Government Lot 4, Section 11, Township 34 North, Range 1 East, N.M., lying Northerly of the following described line:

Beginning at a point on the West line of said Government Lot 4, 2053.93 feet North of the Southwest corner thereof; thence N04°09'E, along the west line of said Government Lot 4, 196.84 feet; thence 585°51'E to the shore of Lake Erie; thence Southeast along the shore of said Lake Erie to a point which bears 585°51'E from the point of beginning; thence N85°51'W to the point of beginning.

Parcel C (Indeterminate description)
That portion of Government Lot 4, Section 11, Township 34 North, Range 1 E, N.M., if any, lying Northerly of the following described line:

Beginning at a point on the West line of said Government Lot 4, 2250.82 feet North of the Southwest corner thereof; thence 585°51'E to the shore of Lake Erie.

Survey Notes

This survey has been prepared from a closed random traverse using an electronic instrument measuring angles to 3 seconds of arc and distances rounded to hundredths of feet.

The purpose of this survey has been to locate, describe and set or recover monuments as required to mark the principal corners and lines of the above described parcels.

Surveyor's Certificate

This map correctly represents a survey made by me or under my direction in conformance with the requirements of the survey recording act at the request of Sherry J. Hill, of Skagit County, in November, 2004.

Certificate no.
LS 24535

Robert F. Parrish
Robert F. Parrish

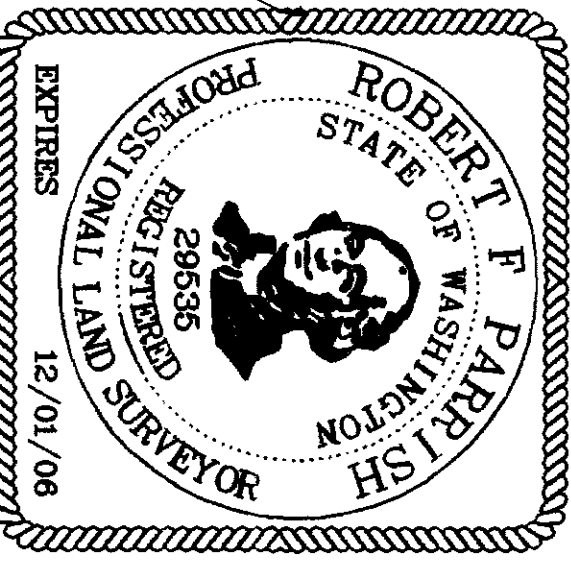

Record of Survey

Prepared at the request of

Sherry J. Hill

A portion of Government Lot 4, Section 11, Township 34 North, Range 1 East, N.M.,
Fidalgo Island, Skagit County, Washington

PO BOX 2874, RIDGAY HARBOR, WASHINGTON 98250
ANACORTES (360) 588-1467 - parrish@rockisland.com

Parrish Land Surveying

JOB NO.: 411-112
CADD BY: RP
CHK BY: RP
BK REF: 13
SCALE: 1" = 40'
DATE: 12-02-04