

AUDITOR'S CERTIFICATE

200410110012
Skiagit County Auditor
10/11/2004 Page 1 of 1 10:09AM
AT THE REQUEST OF SEMRAU ENGINEERING & SURVEYING P.L.L.C.
Nima Burnett
SKAGIT COUNTY AUDITOR
DEPUTY

NOTES

- INDICATES IRON REBAR SET WITH YELLOW CAP - SURVEY NUMBER SEMRAU 28626.
- INDICATES EXISTING REBAR OR IRON PIPE FOUND.
- THE DESCRIPTION FOR THIS SURVEY IS FROM STATUTORY WARRANTY DEED RECORDED UNDER AUDITOR'S FILE NO. 20020710047, RECORDS OF SKAGIT COUNTY, WASHINGTON.
- BASIS OF BEARING: PLAT OF CRATER LAKE BEACH CLUB DIV NO. 1.
- ALL DISTANCES ARE SHOWN IN FEET.
- INSTRUMENTATION: LEICA TCA 1105 THEODOLITE DISTANCE METER.
- SURVEY PROCEDURE: STANDARD FIELD TRAVERSE ON 8/20/03.
- ON 8/20/03 A DOCK OWNED BY LOT 27 WAS FOUND TO ENCROACH ONTO LOT 26 OVER CRATER LAKE. ON 10/8/04 THE DOCK WAS OBSERVED TO HAVE BEEN RELOCATED SOUTH OF THE COMMON LINE BETWEEN LOT 26 AND LOT 27.
- THIS SURVEY MAY SHOW OCCUPATIONAL INDICATORS AS PER W.A.C. CHAPTER 332.130. LINES OF OCCUPATION MAY INDICATE AREAS FOR POTENTIAL CLAIMS OF UNWRITTEN OWNERSHIP. THIS BOUNDARY SURVEY HAS ONLY SHOWN THE RELATIONSHIP OF LINES OF OCCUPATION TO THE DEEDED LINES OF RECORD. NO RESOLUTION OF OWNERSHIP BASED ON UNWRITTEN RIGHTS HAS BEEN MADE OR IMPLIED BY THIS SURVEY.
- EXCEPT AS SPECIFICALLY STATED OR SHOWN ON THIS SURVEY MAP, THIS SURVEY DOES NOT PURPORT TO REFLECT ALL OF THE FOLLOWING WHICH MAY BE APPLICABLE TO THE SUBJECT REAL ESTATE: EASEMENTS, BUILDING SETBACKS LINES, RESTRICTIVE COVENANTS, SUBDIVISION RESTRICTIONS, ZONING OR OTHER LAND-USE REGULATIONS AND ANY OTHER FACTS THAT AN ACCURATE AND CURRENT TITLE SEARCH MAY DISCLOSE.

DESCRIPTION

LOT 26, "CRATER LAKE BEACH CLUB, DIVISION 1" AS RECORDED IN VOLUME 8 OF PLATS, PAGES 51 AND 52, RECORDS OF SKAGIT COUNTY.

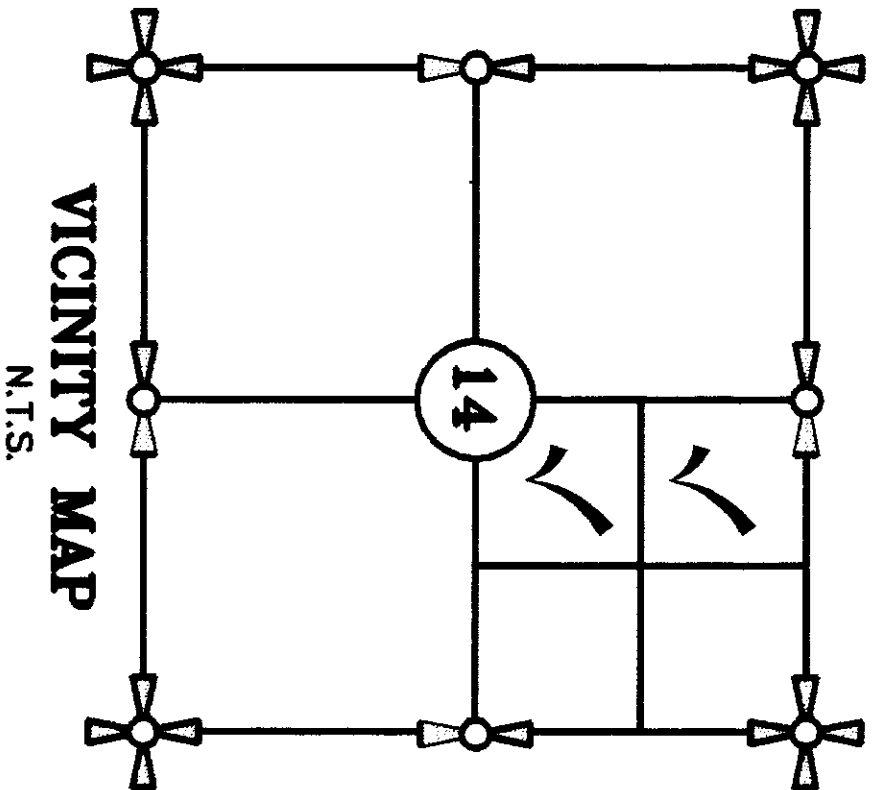

SHEET 1 OF 1

SURVEYOR'S CERTIFICATE

THIS MAP CORRECTLY REPRESENTS A SURVEY MADE BY ME OR UNDER MY DIRECTION IN CONFORMANCE WITH THE REQUIREMENTS OF THE SURVEY RECORDING ACT AT THE REQUEST OF LANCE CAMPBELL.

JOHN B. SEMRAU, P.E., P.L.S.
SEMRU ENGINEERING & SURVEYING, P.L.L.C.
2118 RIVERSIDE DRIVE, SUITE 104
MOUNT VERNON, WA 98273
PHONE 360-424-9566

DATE: 10-8-04

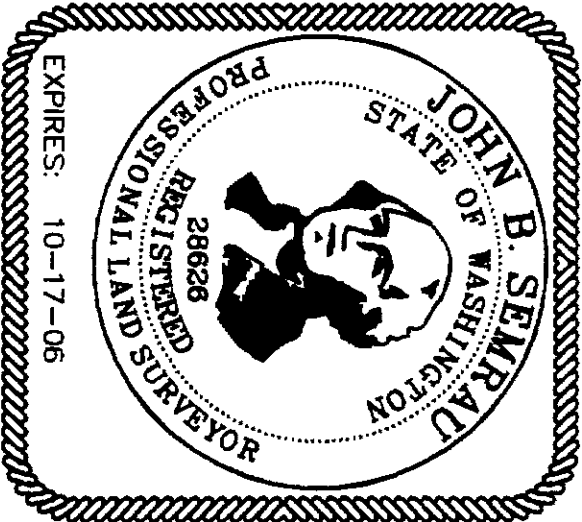

SURVEY OF LOT 26
CRATER LAKE BEACH CLUB DIV. NO. 1
SECTION 11 & 14, T. 34 N., R. 1 E., W.M.
SKAGIT COUNTY, WASHINGTON
FOR: LANCE CAMPBELL