

Return to:



200409080079

Skagit County Auditor

9/8/2004 Page

1 of

3 11:12AM

PROTECTED CRITICAL AREA SITE PLAN

Page 1 of 2

Grantor/Owner:

Robert GARA

Grantee: PUBLIC

Site Address:

6914 Salmon Beach Road

Property ID #: P

68468

Assessors Tax Account #:

3983-002-003-0008

Legal Description: Sec. 19

Twp. 34

Rng. 2

/ Plat Name

Bensink & Whipple

Lot 3

Permit/Activity #:

BP 03-0452

Tracts

The PROTECTED CRITICAL AREA (PCA) is to be left undisturbed in its natural state. "With the exception of activities identified as Allowed without Standard review under SCC 14.24.100, any land-use activity that can impair the functions and values of critical areas or their buffers through a development activity or by disturbance of the soil or water, and/or by removal of, or damage to, existing vegetation shall require critical areas review and written authorization pursuant to SCC 14.24." SCC 14.24.060 No clearing, grading, filling, logging or removal of woody material, building, construction or road construction of any kind, planting of non-native vegetation or grazing of livestock is allowed within the PCA areas except as specifically permitted by Skagit County on a case-by-case basis consistent with SCC 14.24.

Representations on this site plan may be approximations only and should not be used for purposes other than for determining general locations of critical areas. Development activities beyond the scope of this plan may require additional studies and approvals.

The above references to "Grantor" and "Grantee" shall not be construed as a transfer of property ownership and are used solely for filing with the County Auditor.

Owner:

Robert I. Gara

Date:

3 May 2004

On this day personally appeared before me Robert I. Gara known to be the individual described herein and acknowledged to me that he signed the same as his free and voluntary act and deed for the uses and purposes therein mentioned.

residing at

Seattle

John Lester H. [Signature], Notary Public in and for the State of Washington

Date:

5/3/04

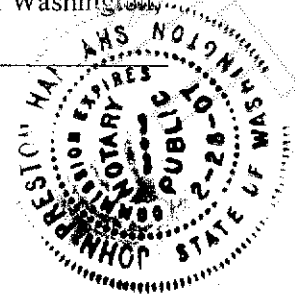

6	5	4	3	2	1
7	8	9	10	11	12
18	17	16	15	14	13
19	20	21	22	23	24
30	29	28	27	26	25
31	32	33	34	35	36

T 34 N R 02 E

*** ATTENTION**
THIS MAP CONTAINS A PARCEL ACCIDENT
THAT HAS BEEN PLACED WITH THE
BEST AVAILABLE INFORMATION. THE
EXACT LOCATION OF THIS PARCEL
IS UNKNOWN.



These maps have created both positive and negative reactions among some groups. The maps are being used by some groups to plan and coordinate their activities. They are also being used by some groups to plan and coordinate their activities. They are also being used by some groups to plan and coordinate their activities.

	DATE	INIT.
DRAWN BY	6/18/98	LNS
REVISED	03/04/04	RS
PLOTTED	03/04/04	RS
MAP PRODUCED BY BRACKLEY COUNTY MAPPING SERVICES		

Section 19
T 34 N R 02 E

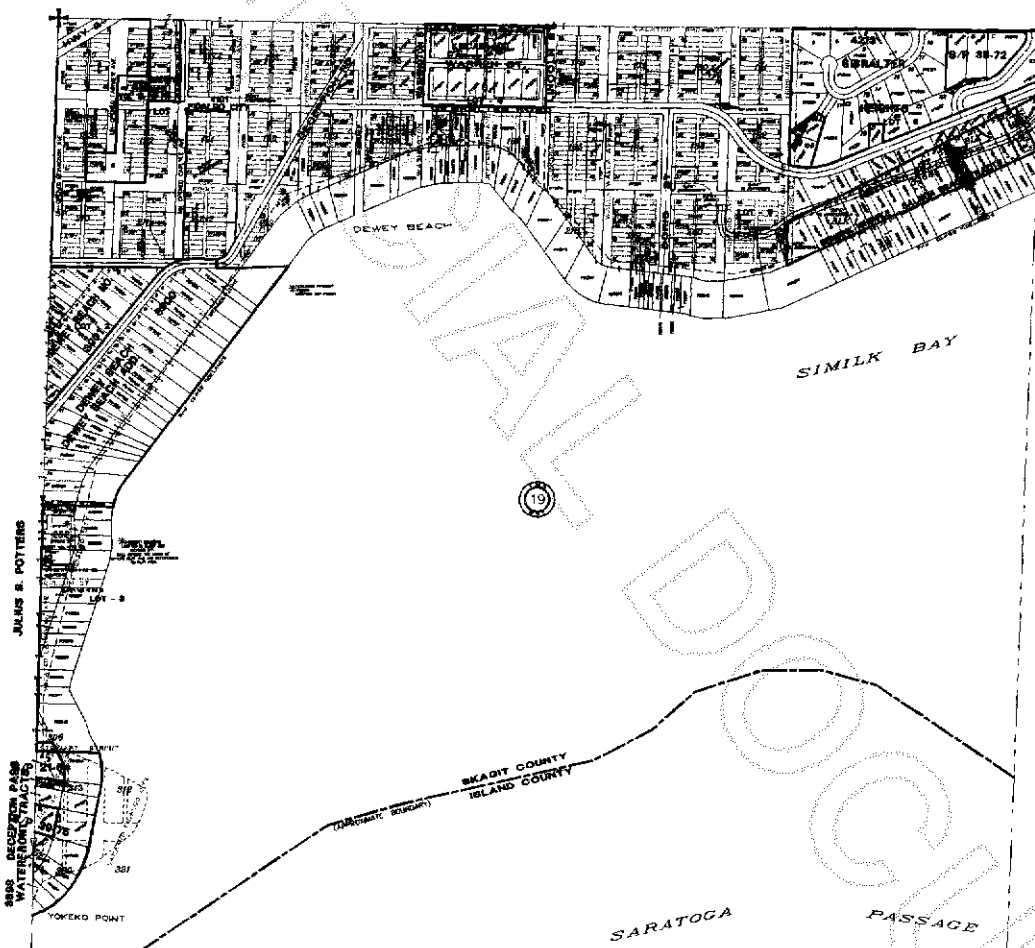

200409080079
Skagit County Auditor

9/8/2004 Page

2 of

3 11:12AM

CRITICAL AREA SITE PLAN

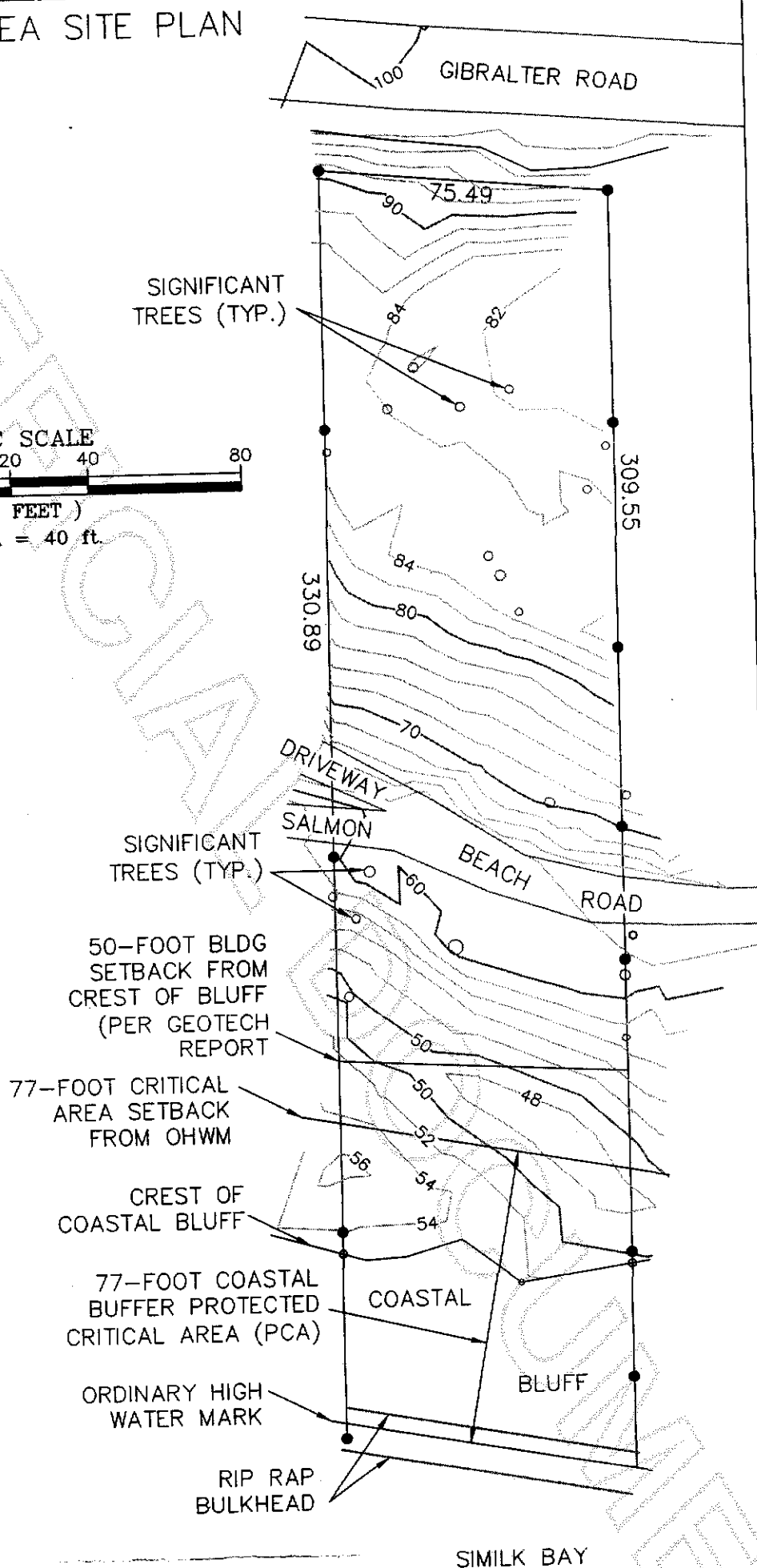
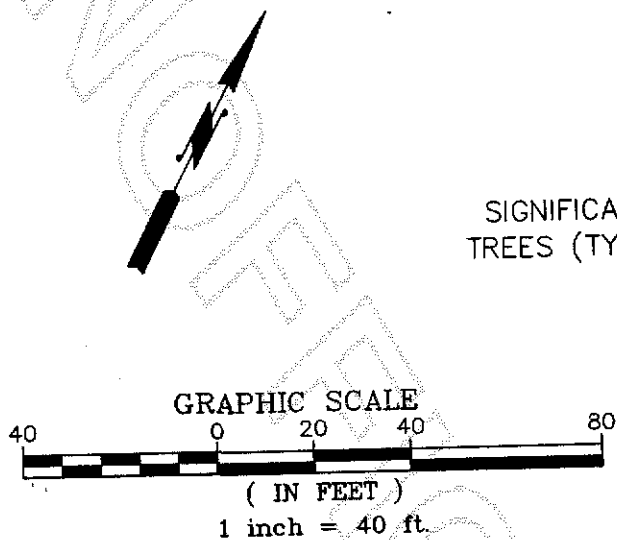

Owners: Robert Gara
Address: 6914 Salmon Beach Rd.
Parcel: P68468
Permit: BP03-0452
Preparer: Edison Engineering
Date: December, 2003

This drawing was created by
modifying a topographic survey
and is approximate.
NOT A SURVEY



200409080079
Skagit County Auditor