

BASE MERIDIAN

N40°00'00"E 374.94 (350 per plat)

Cased Mont



200407260006
Skagit County Auditor

7/26/2004 Page 1 of 1 8:37AM

22nd Street

"PK" Nail

Edge of Pavement

Graphic Scale



1 inch = 10 feet

"R" Avenue

Rebar & Cap LS 24535 (typical)

S40°00'00"E 60.00

23.25

36.75

Lot 1

Lot 2

Lot 3

Land Description

Description prior to Revision
Auditor's File Number 200406150210
Lots 1 and 2, Nelson's Addition to Anacortes, according to the plat thereof recorded in Volume 2 of Plats, Page 102, records of Skagit County, Washington.

Survey Notes

This survey has been prepared from a closed random traverse using an electronic instrument measuring angles to 3 second of arc and distances rounded to hundredths of feet.

The purpose of this survey has been to locate, describe and set monuments as required to mark the existing boundaries of Lots 1 and 2 and to revise the boundary common to these lots as shown.

For additional information pertaining to the boundaries shown refer to Record of Survey recorded under Auditor's File Number 20040520005.

"Q" Avenue

S00°02'48"E
295.88

40'

S00°02'48"E
49.98

S00°02'48"E
49.98

Building Setback Line

5 1/2 Lots 1 & 2

3,000 sq. ft.
0.07 acres

3,000 sq. ft.
0.07 acres

S40°00'00"E 60.00

S00°02'48"E
49.98

Board Fence

certificate no.
LS 24535

This map correctly represents a survey made by me or under my direction in conformance with the requirements of the survey recording act at the request of
Dickman Home Builders, Inc. of Skagit County, in July, 2004.

Robert F. Parrish
Robert F. Parrish

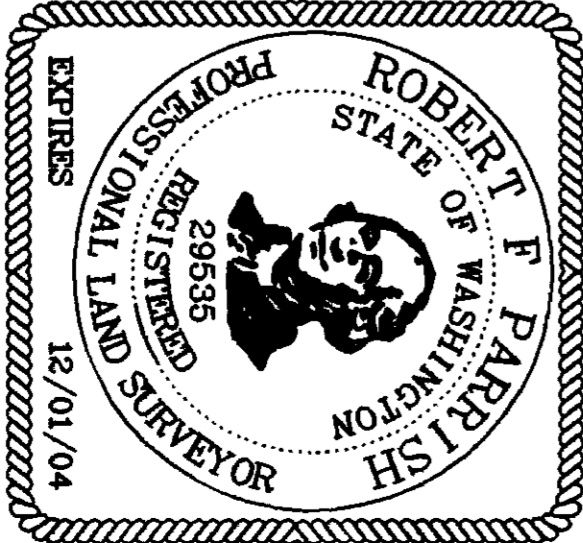

Auditor's Certificate

Filed for record this 26th day of July, 2004 at 8:37am
at the request of Parish Land Surveying.

Paula M. Brown
Deputy County Auditor

Norma Brummett
County Auditor

Auditor's File Number

Alley

16'

S40°00'00"E 60.00

38.25

21.75

Record of Survey

Parish Land Surveying

PO Box 2874, FRIDAY HARBOR, WASHINGTON 98250
(360) 588-1467 - parish@rockisland.com

Dickman Home Builders, Inc.

Lots 1 & 2, Plat of Nelson's Addition to Anacortes
City of Anacortes, Skagit County, Washington

JOB NO.: 407-145

CADD BY: JP

CHK BY: *JP*

BK REF: II

SCALE: 1" = 10'

DATE: 07-16-04