

Return to:



200403310115  
Skagit County Auditor

3/31/2004 Page 1 of 2 11:43AM

PROTECTED CRITICAL AREA SITE PLAN

Page 1 of 2

Grantor/Owner: David A. Harrison

Grantee: PUBLIC

Site Address: 33152 W. Shore Dr. Mt. Vernon, WA 98274 Lake Cavanaugh

Property ID #: P 66889 Assessors Tax Account #: \_\_\_\_\_

Legal Description: Sec. 22 Twp. 33 Rng. 06 / Plat Name \_\_\_\_\_ Lot \_\_\_\_\_

Permit/Activity #: PL04-0066

The PROTECTED CRITICAL AREA (PCA) is to be left undisturbed in its natural state. "With the exception of activities identified as Allowed without Standard review under SCC 14.24.100, any land-use activity that can impair the functions and values of critical areas or their buffers through a development activity or by disturbance of the soil or water, and/or by removal of, or damage to, existing vegetation shall require critical areas review and written authorization pursuant to SCC 14.24." SCC 14.24.060 No clearing, grading, filling, logging or removal of woody material, building, construction or road construction of any kind, planting of non-native vegetation or grazing of livestock is allowed within the PCA areas except as specifically permitted by Skagit County on a case-by-case basis consistent with SCC 14.24.

Representations on this site plan may be approximations only and should not be used for purposes other than for determining general locations of critical areas. Development activities beyond the scope of this plan may require additional studies and approvals.

The above references to "Grantor" and "Grantee" shall not be construed as a transfer of property ownership and are used solely for filing with the County Auditor.

Owner: Warren A. Otterson Date: 3/31/04

On this day personally appeared before me WARREN OTT known to be the individual described herein and acknowledged to me that he signed the same as WARREN OTT free and voluntary act and deed for the uses and purposes therein mentioned.

Robert J. Chambers, Notary Public in and for the State of Washington, residing at MOUNT VERNON Date: 3/31/04

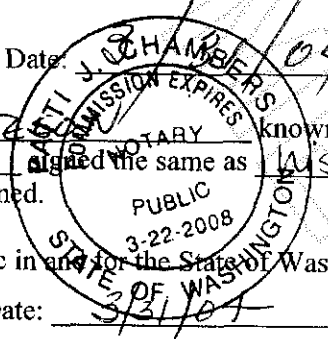

# CRITICAL AREA SITE PLAN

TREES WITHIN 50' OF OHWM

NUM	TYPE	IN	DIA
1	CEDAR	20	48"
2	CEDAR	14	
3	CEDAR	17	
4	HEMLOCK	09	
5	CEDAR	19	
6	HEMLOCK	12	
7	HEMLOCK	10	
8	CEDAR	13	
9	CEDAR	10	
10	CEDAR	19	
11	CEDAR	15	
12	CEDAR	22	
13	HEMLOCK	08	
14	HEMLOCK	09	
15	HEMLOCK	11	
16	CEDAR	17	
17	HEMLOCK	10	
18	CEDAR	16	
19	CEDAR	12	
20	HEMLOCK	10	
21	HEMLOCK	15	
22	ALDER	14	
23	CEDAR	12	
24	D-FIR	28	
25	CEDAR	11	
26	CEDAR	19	
27	HEMLOCK	11	
28	CEDAR	15	

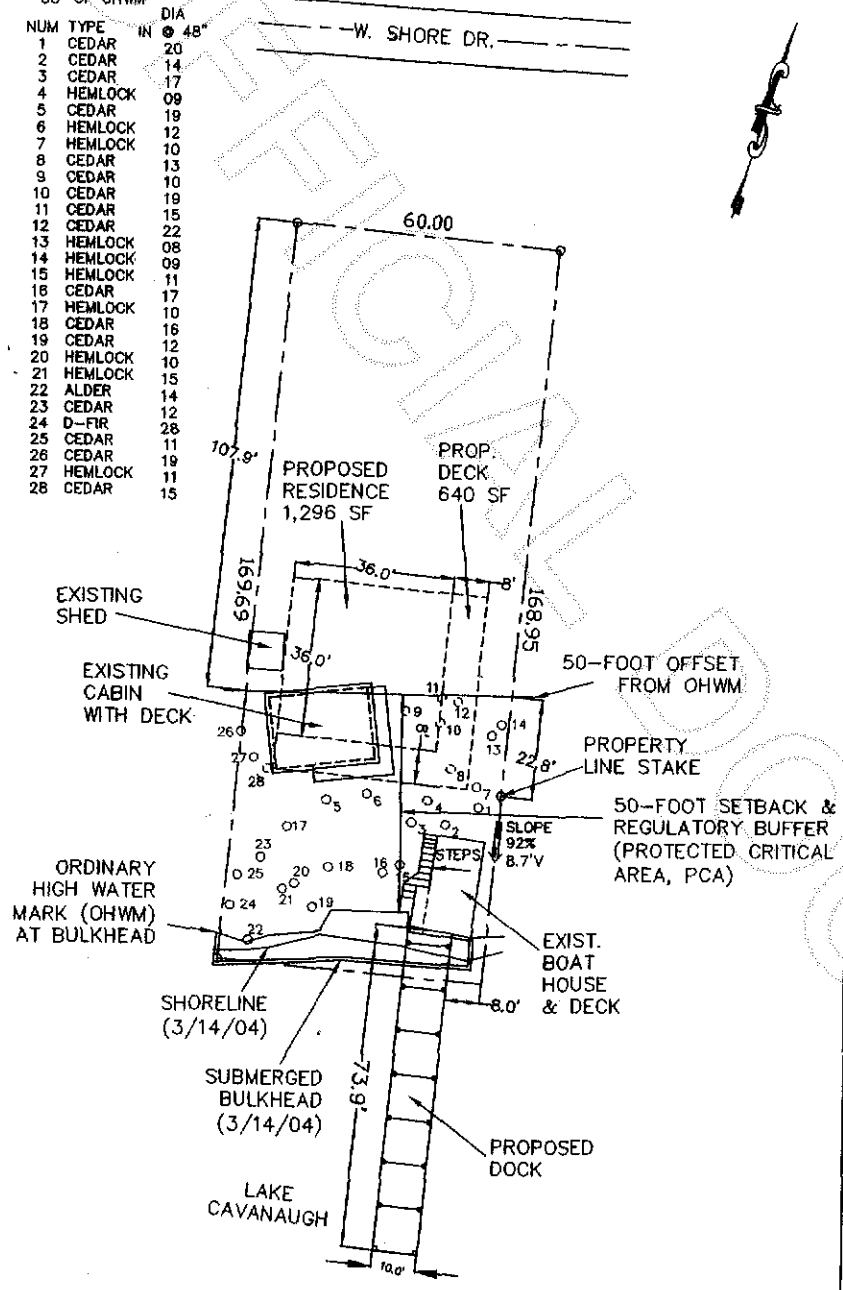

3-31-04  
 JPM  
 PLO 4-0066

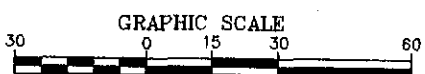

Owners: David & Ann Harrison  
 Address: 33152 W. Shore Dr.  
 Parcel: P66889  
 Permit:  
 Preparer: Edison Engineering  
 Date: March 2004

This drawing was created with a compass and tape measure and is approximate.  
**NOT A SURVEY**



200403310115  
 Skagit County Auditor